

KERR-MCGEE OIL & GAS ONSHORE LP

Location: COLORADO Slot: SLOT#02 MARRS 28C-28HZ (275'FSL & 1898'FEL, SEC.28)
 Field: WELD COUNTY (KERR MCGEE) Well: MARRS 28C-28HZ
 Facility: SEC.28-T1N-R66W Wellbore: MARRS 28C-28HZ PWB

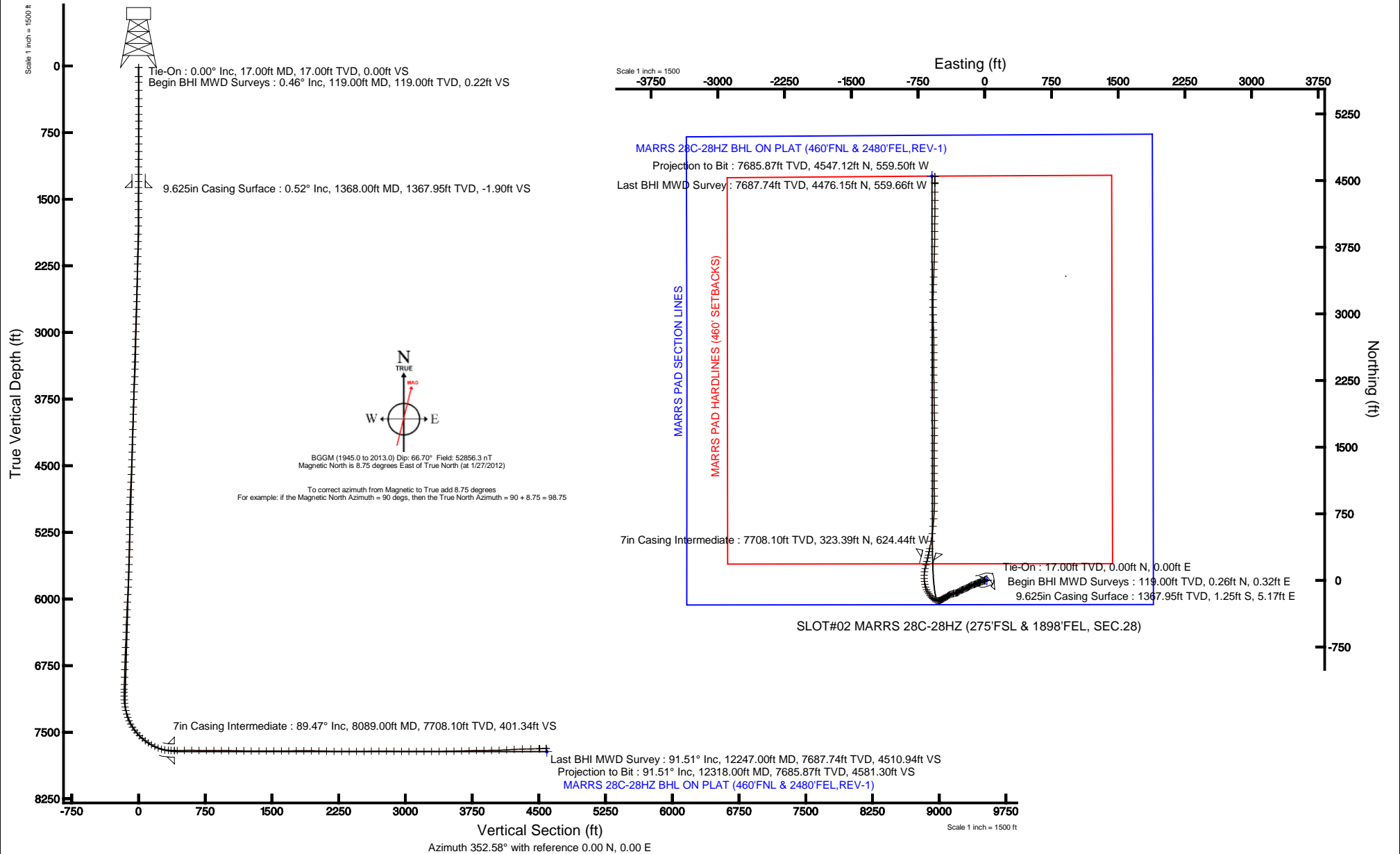

Plot reference wellpath is MARRS 28C-28HZ (REV-A.2) PWP	
True vertical depths are referenced to XTREME 6 (RKB)	Grid System: NAD83 / Lambert Colorado SP, Northern Zone (501), US feet
Measured depths are referenced to XTREME 6 (RKB)	North Reference: True north
XTREME 6 (RKB) to Mean Sea Level: 5122 feet	Scale: True distance
Mean Sea Level to Mad line (At Slot: SLOT#02 MARRS 28C-28HZ (275'FSL & 1898'FEL, SEC.28)): 0 feet	Depths are in feet
Coordinates are in feet referenced to Slot	Created by: wiljef02 on 2/27/2012





Actual Wellpath Report

MARRS 28C-28HZ AWP

Page 1 of 6



REFERENCE WELLPATH IDENTIFICATION			
Operator	KERR-MCGEE OIL & GAS ONSHORE LP	Slot	SLOT#02 MARRS 28C-28HZ (275'FSL & 1898'FEL, SEC.28)
Area	COLORADO	Well	MARRS 28C-28HZ
Field	WELD COUNTY (KERR MCGEE)	Wellbore	MARRS 28C-28HZ AWP
Facility	SEC.28-T1N-R66W		

REPORT SETUP INFORMATION			
Projection System	NAD83 / Lambert Colorado SP, Northern Zone (501), US feet	Software System	WellArchitect® 3.0.2
North Reference	True	User	Wilsjef02
Scale	0.999965	Report Generated	2/27/2012 at 15:37:37
Convergence at slot	0.47° East	Database/Source file	WellArchitectDB/MARRS_28C-28HZ_AWP.xml

WELLPATH LOCATION						
	Local coordinates		Grid coordinates		Geographic coordinates	
	North[ft]	East[ft]	Easting[US ft]	Northing[US ft]	Latitude	Longitude
Slot Location	0.20	-24.04	3201808.64	1249389.07	40°00'56.552"N	104°46'46.114"W
Facility Reference Pt			3201832.68	1249389.06	40°00'56.550"N	104°46'45.805"W
Field Reference Pt			3197771.84	1268891.29	40°04'09.600"N	104°47'36.000"W

WELLPATH DATUM			
Calculation method	Minimum curvature	XTREME 6 (RKB) to Facility Vertical Datum	5122.00ft
Horizontal Reference Pt	Slot	XTREME 6 (RKB) to Mean Sea Level	5122.00ft
Vertical Reference Pt	XTREME 6 (RKB)	XTREME 6 (RKB) to Mud Line at Slot (SLOT#02 MARRS 28C-28HZ (275'FSL & 1898'FEL, SEC.28))	5122.00ft
MD Reference Pt	XTREME 6 (RKB)	Section Origin	N 0.00, E 0.00 ft
Field Vertical Reference	Mean Sea Level	Section Azimuth	352.58°



Actual Wellpath Report

MARRS 28C-28HZ AWP

Page 2 of 6



REFERENCE WELLPATH IDENTIFICATION			
Operator	KERR-MCGEE OIL & GAS ONSHORE LP	Slot	SLOT#02 MARRS 28C-28HZ (275'FSL & 1898'FEL, SEC.28)
Area	COLORADO	Well	MARRS 28C-28HZ
Field	WELD COUNTY (KERR MCGEE)	Wellbore	MARRS 28C-28HZ AWP
Facility	SEC.28-T1N-R66W		

WELLPATH DATA (160 stations) † = interpolated/extrapolated station

MD [ft]	Inclination [°]	Azimuth [°]	TVD [ft]	Vert Sect [ft]	North [ft]	East [ft]	Latitude	Longitude	DLS [°/100ft]	Comments
0.00†	0.000	50.570	0.00	0.00	0.00	0.00	40°00'56.552"N	104°46'46.114"W	0.00	
17.00	0.000	50.570	17.00	0.00	0.00	0.00	40°00'56.552"N	104°46'46.114"W	0.00	Tie-On
119.00	0.460	50.570	119.00	0.22	0.26	0.32	40°00'56.555"N	104°46'46.110"W	0.45	Begin BHI MWD Surveys
180.00	1.050	42.900	179.99	0.70	0.83	0.89	40°00'56.560"N	104°46'46.103"W	0.98	
274.00	0.270	59.010	273.99	1.34	1.57	1.66	40°00'56.568"N	104°46'46.093"W	0.84	
366.00	0.400	64.910	365.98	1.53	1.82	2.14	40°00'56.570"N	104°46'46.087"W	0.15	
457.00	0.460	42.520	456.98	1.86	2.22	2.67	40°00'56.574"N	104°46'46.080"W	0.19	
543.00	0.650	85.620	542.98	2.05	2.51	3.39	40°00'56.577"N	104°46'46.070"W	0.52	
619.00	0.380	92.380	618.98	1.99	2.54	4.07	40°00'56.577"N	104°46'46.062"W	0.36	
707.00	0.590	116.800	706.97	1.68	2.32	4.77	40°00'56.575"N	104°46'46.053"W	0.33	
793.00	0.260	122.420	792.97	1.31	2.02	5.33	40°00'56.572"N	104°46'46.045"W	0.39	
878.00	0.260	121.450	877.97	1.07	1.81	5.66	40°00'56.570"N	104°46'46.041"W	0.01	
963.00	0.540	146.000	962.97	0.59	1.38	6.05	40°00'56.566"N	104°46'46.036"W	0.38	
1049.00	0.210	152.050	1048.96	0.08	0.90	6.35	40°00'56.561"N	104°46'46.032"W	0.39	
1134.00	0.710	188.570	1133.96	-0.58	0.24	6.34	40°00'56.554"N	104°46'46.032"W	0.65	
1219.00	0.220	221.660	1218.96	-1.19	-0.40	6.15	40°00'56.548"N	104°46'46.035"W	0.63	
1300.00	0.650	232.860	1299.96	-1.52	-0.79	5.68	40°00'56.544"N	104°46'46.041"W	0.54	
1433.00	0.410	208.730	1432.95	-2.28	-1.66	4.85	40°00'56.536"N	104°46'46.052"W	0.24	
1525.00	0.110	86.160	1524.95	-2.55	-1.95	4.78	40°00'56.533"N	104°46'46.053"W	0.52	
1616.00	1.040	271.440	1615.95	-2.43	-1.92	4.05	40°00'56.533"N	104°46'46.062"W	1.26	
1708.00	2.090	257.290	1707.91	-2.45	-2.27	1.57	40°00'56.530"N	104°46'46.094"W	1.21	
1800.00	2.570	236.290	1799.84	-3.52	-3.78	-1.78	40°00'56.515"N	104°46'46.137"W	1.06	
1892.00	3.770	247.260	1891.69	-5.23	-6.10	-6.28	40°00'56.492"N	104°46'46.195"W	1.46	
1975.00	5.170	247.820	1974.44	-6.91	-8.56	-12.26	40°00'56.467"N	104°46'46.272"W	1.69	
2061.00	6.160	249.760	2060.02	-8.92	-11.62	-20.18	40°00'56.437"N	104°46'46.373"W	1.17	
2146.00	6.190	252.710	2144.53	-10.71	-14.56	-28.83	40°00'56.408"N	104°46'46.485"W	0.37	
2231.00	6.870	251.500	2228.97	-12.48	-17.54	-38.03	40°00'56.379"N	104°46'46.603"W	0.82	
2316.00	6.480	254.810	2313.40	-14.10	-20.41	-47.48	40°00'56.350"N	104°46'46.724"W	0.64	
2402.00	5.720	249.670	2398.91	-15.72	-23.17	-56.18	40°00'56.323"N	104°46'46.836"W	1.09	
2487.00	5.370	254.490	2483.51	-17.22	-25.70	-63.99	40°00'56.298"N	104°46'46.936"W	0.69	
2577.00	4.770	248.890	2573.16	-18.70	-28.18	-71.54	40°00'56.274"N	104°46'47.033"W	0.86	
2657.00	5.160	247.020	2652.86	-20.45	-30.78	-77.95	40°00'56.248"N	104°46'47.116"W	0.53	
2742.00	5.320	247.730	2737.51	-22.49	-33.76	-85.12	40°00'56.218"N	104°46'47.208"W	0.20	
2828.00	7.070	246.830	2823.00	-24.94	-37.36	-93.67	40°00'56.183"N	104°46'47.318"W	2.04	
2913.00	5.910	247.180	2907.45	-27.53	-41.11	-102.52	40°00'56.146"N	104°46'47.432"W	1.37	
2998.00	5.740	239.570	2992.02	-30.35	-44.96	-110.22	40°00'56.108"N	104°46'47.531"W	0.93	
3083.00	6.120	253.250	3076.57	-32.75	-48.42	-118.22	40°00'56.073"N	104°46'47.633"W	1.72	
3168.00	6.720	256.810	3161.03	-33.98	-50.86	-127.40	40°00'56.049"N	104°46'47.751"W	0.85	
3254.00	7.250	251.630	3246.40	-35.52	-53.72	-137.45	40°00'56.021"N	104°46'47.881"W	0.96	
3339.00	6.600	250.250	3330.77	-37.58	-57.06	-147.14	40°00'55.988"N	104°46'48.005"W	0.79	
3424.00	6.540	242.740	3415.22	-40.26	-60.93	-156.04	40°00'55.950"N	104°46'48.119"W	1.01	
3509.00	6.850	235.860	3499.64	-44.18	-65.99	-164.54	40°00'55.900"N	104°46'48.229"W	1.01	
3595.00	6.470	235.600	3585.06	-48.69	-71.61	-172.78	40°00'55.844"N	104°46'48.335"W	0.44	
3680.00	6.130	241.540	3669.55	-52.49	-76.48	-180.72	40°00'55.796"N	104°46'48.437"W	0.86	
3765.00	6.490	246.810	3754.03	-55.42	-80.53	-189.13	40°00'55.756"N	104°46'48.545"W	0.80	
3850.00	6.320	247.510	3838.50	-57.95	-84.21	-197.86	40°00'55.720"N	104°46'48.657"W	0.22	
3935.00	6.420	242.130	3922.98	-60.82	-88.22	-206.39	40°00'55.680"N	104°46'48.767"W	0.71	
4021.00	6.350	250.090	4008.45	-63.53	-92.09	-215.11	40°00'55.642"N	104°46'48.879"W	1.03	
4106.00	7.180	245.530	4092.85	-66.10	-95.89	-224.37	40°00'55.604"N	104°46'48.998"W	1.16	
4191.00	6.460	245.760	4177.25	-69.05	-100.06	-233.56	40°00'55.563"N	104°46'49.116"W	0.85	
4276.00	7.000	250.090	4261.67	-71.55	-103.78	-242.79	40°00'55.526"N	104°46'49.234"W	0.87	
4362.00	5.440	246.780	4347.16	-73.79	-107.17	-251.46	40°00'55.493"N	104°46'49.346"W	1.86	
4447.00	5.650	246.360	4431.76	-76.06	-110.44	-259.00	40°00'55.461"N	104°46'49.443"W	0.25	
4532.00	6.740	248.290	4516.26	-78.46	-113.96	-267.47	40°00'55.426"N	104°46'49.552"W	1.31	
4617.00	7.830	239.330	4600.58	-81.97	-118.76	-277.08	40°00'55.378"N	104°46'49.675"W	1.85	
4702.00	7.150	235.570	4684.85	-86.66	-124.71	-286.43	40°00'55.320"N	104°46'49.795"W	0.99	
4787.00	5.370	235.780	4769.34	-90.86	-129.94	-294.08	40°00'55.268"N	104°46'49.894"W	2.09	
4873.00	4.600	228.990	4855.02	-94.58	-134.46	-300.01	40°00'55.223"N	104°46'49.970"W	1.13	
4957.00	4.780	243.730	4938.74	-97.57	-138.22	-305.69	40°00'55.186"N	104°46'50.043"W	1.45	
5042.00	5.690	253.160	5023.39	-99.41	-141.01	-312.90	40°00'55.158"N	104°46'50.136"W	1.47	



Actual Wellpath Report

MARRS 28C-28HZ AWP

Page 3 of 6



REFERENCE WELLPATH IDENTIFICATION			
Operator	KERR-MCGEE OIL & GAS ONSHORE LP	Slot	SLOT#02 MARRS 28C-28HZ (275'FSL & 1898'FEL, SEC.28)
Area	COLORADO	Well	MARRS 28C-28HZ
Field	WELD COUNTY (KERR MCGEE)	Wellbore	MARRS 28C-28HZ AWP
Facility	SEC.28-T1N-R66W		

WELLPATH DATA (160 stations) † = interpolated/extrapolated station										
MD [ft]	Inclination [°]	Azimuth [°]	TVD [ft]	Vert Sect [ft]	North [ft]	East [ft]	Latitude	Longitude	DLS [°/100ft]	Comments
5127.00	6.920	256.970	5107.87	-100.60	-143.38	-321.92	40°00'55.135"N	104°46'50.251"W	1.53	
5212.00	6.750	263.020	5192.27	-101.06	-145.15	-331.87	40°00'55.118"N	104°46'50.379"W	0.87	
5297.00	7.260	258.250	5276.63	-101.43	-146.85	-342.08	40°00'55.101"N	104°46'50.511"W	0.91	
5383.00	7.230	252.470	5361.95	-102.79	-149.58	-352.56	40°00'55.074"N	104°46'50.645"W	0.85	
5467.00	6.610	253.660	5445.33	-104.46	-152.54	-362.24	40°00'55.045"N	104°46'50.770"W	0.76	
5552.00	6.850	255.690	5529.75	-105.83	-155.17	-371.85	40°00'55.019"N	104°46'50.893"W	0.40	
5637.00	6.830	248.560	5614.15	-107.66	-158.27	-381.47	40°00'54.988"N	104°46'51.017"W	1.00	
5722.00	7.650	249.020	5698.47	-110.21	-162.14	-391.45	40°00'54.950"N	104°46'51.145"W	0.97	
5808.00	6.620	243.540	5783.80	-113.17	-166.40	-401.24	40°00'54.908"N	104°46'51.271"W	1.43	
5893.00	6.100	232.910	5868.28	-117.00	-171.30	-409.23	40°00'54.859"N	104°46'51.374"W	1.51	
5978.00	6.420	230.190	5952.77	-121.79	-177.07	-416.48	40°00'54.802"N	104°46'51.467"W	0.51	
6063.00	6.760	233.020	6037.21	-126.80	-183.12	-424.13	40°00'54.742"N	104°46'51.565"W	0.55	
6149.00	5.940	237.090	6122.68	-131.21	-188.58	-431.91	40°00'54.688"N	104°46'51.665"W	1.09	
6234.00	5.590	242.740	6207.26	-134.51	-192.87	-439.28	40°00'54.646"N	104°46'51.760"W	0.78	
6319.00	6.110	243.940	6291.81	-137.36	-196.75	-447.02	40°00'54.608"N	104°46'51.859"W	0.63	
6406.00	5.780	243.960	6378.34	-140.24	-200.71	-455.12	40°00'54.568"N	104°46'51.963"W	0.38	
6489.00	6.310	238.640	6460.88	-143.42	-204.92	-462.77	40°00'54.527"N	104°46'52.062"W	0.93	
6575.00	6.680	240.820	6546.33	-147.19	-209.82	-471.17	40°00'54.478"N	104°46'52.170"W	0.52	
6658.00	5.640	237.300	6628.85	-150.72	-214.38	-478.82	40°00'54.433"N	104°46'52.268"W	1.33	
6743.00	6.130	239.310	6713.40	-154.30	-218.95	-486.24	40°00'54.388"N	104°46'52.363"W	0.63	
6828.00	5.210	245.060	6797.99	-157.26	-222.89	-493.64	40°00'54.349"N	104°46'52.458"W	1.27	
6914.00	5.500	246.320	6883.61	-159.58	-226.19	-500.95	40°00'54.317"N	104°46'52.552"W	0.36	
6997.00	5.960	250.030	6966.20	-161.63	-229.26	-508.65	40°00'54.286"N	104°46'52.651"W	0.71	
7051.00	5.250	253.130	7019.94	-162.65	-230.94	-513.64	40°00'54.270"N	104°46'52.716"W	1.43	
7084.00	4.690	253.060	7052.81	-163.12	-231.77	-516.38	40°00'54.262"N	104°46'52.751"W	1.70	
7127.00	6.940	265.270	7095.59	-163.29	-232.50	-520.65	40°00'54.254"N	104°46'52.806"W	5.94	
7169.00	11.010	276.150	7137.07	-162.23	-232.27	-527.17	40°00'54.257"N	104°46'52.889"W	10.46	
7211.00	15.810	288.020	7177.92	-158.83	-230.07	-536.61	40°00'54.278"N	104°46'53.011"W	13.12	
7253.00	19.430	295.970	7217.95	-152.52	-225.24	-548.33	40°00'54.326"N	104°46'53.161"W	10.33	
7295.00	20.570	297.910	7257.42	-144.41	-218.73	-561.13	40°00'54.390"N	104°46'53.326"W	3.14	
7338.00	23.010	300.480	7297.34	-134.88	-210.93	-575.06	40°00'54.467"N	104°46'53.505"W	6.09	
7380.00	25.010	310.950	7335.73	-123.19	-200.94	-588.84	40°00'54.566"N	104°46'53.682"W	11.19	
7423.00	28.350	317.300	7374.15	-108.05	-187.47	-602.64	40°00'54.699"N	104°46'53.859"W	10.20	
7465.00	31.790	323.370	7410.50	-90.25	-171.26	-616.01	40°00'54.859"N	104°46'54.031"W	10.92	
7507.00	35.390	328.180	7445.49	-69.50	-152.04	-629.03	40°00'55.049"N	104°46'54.199"W	10.65	
7549.00	39.470	330.920	7478.83	-46.01	-130.03	-641.94	40°00'55.267"N	104°46'54.364"W	10.49	
7592.00	42.090	337.060	7511.41	-19.41	-104.79	-654.20	40°00'55.516"N	104°46'54.522"W	11.13	
7634.00	45.710	342.650	7541.67	8.98	-77.46	-664.18	40°00'55.786"N	104°46'54.650"W	12.62	
7677.00	49.190	347.430	7570.76	40.37	-46.87	-672.31	40°00'56.089"N	104°46'54.755"W	11.51	
7720.00	53.000	352.760	7597.77	73.78	-13.93	-678.02	40°00'56.414"N	104°46'54.828"W	13.09	
7762.00	56.990	357.200	7621.87	108.13	20.32	-681.00	40°00'56.753"N	104°46'54.867"W	12.85	
7805.00	60.690	3.460	7644.13	144.55	57.08	-680.75	40°00'57.116"N	104°46'54.863"W	15.14	
7848.00	64.130	8.330	7664.05	181.60	94.97	-676.81	40°00'57.490"N	104°46'54.813"W	12.83	
7890.00	69.410	13.190	7680.62	218.23	132.85	-669.58	40°00'57.865"N	104°46'54.720"W	16.46	
7933.00	75.020	13.810	7693.75	256.46	172.65	-660.02	40°00'58.258"N	104°46'54.597"W	13.12	
7974.00	81.710	13.830	7702.01	293.87	211.62	-650.44	40°00'58.643"N	104°46'54.474"W	16.32	
8016.00	87.070	13.060	7706.12	332.91	252.26	-640.72	40°00'59.045"N	104°46'54.349"W	12.89	
8048.00	88.460	13.080	7707.36	362.87	283.40	-633.49	40°00'59.353"N	104°46'54.256"W	4.34	
8089.00†	89.474	12.438	7708.10	401.34	323.39	-624.44	40°00'59.748"N	104°46'54.140"W	2.93	7" Casing Point
8124.00	90.340	11.890	7708.16	434.32	357.60	-617.06	40°01'00.086"N	104°46'54.045"W	2.93	
8207.00	91.020	9.040	7707.17	513.29	439.20	-601.99	40°01'00.892"N	104°46'53.851"W	3.53	
8293.00	89.510	6.990	7706.78	596.18	524.36	-590.00	40°01'01.734"N	104°46'53.697"W	2.96	
8378.00	88.830	5.430	7708.01	678.77	608.84	-580.81	40°01'02.569"N	104°46'53.579"W	2.00	
8463.00	89.750	4.710	7709.06	761.75	693.50	-573.30	40°01'03.405"N	104°46'53.483"W	1.37	
8548.00	90.620	2.540	7708.79	845.17	778.33	-567.92	40°01'04.244"N	104°46'53.413"W	2.75	
8634.00	89.720	0.360	7708.53	930.14	864.29	-565.75	40°01'05.093"N	104°46'53.386"W	2.74	
8718.00	89.140	359.200	7709.37	1013.47	948.29	-566.07	40°01'05.923"N	104°46'53.390"W	1.54	
8803.00	89.010	359.420	7710.74	1097.87	1033.27	-567.09	40°01'06.763"N	104°46'53.403"W	0.30	
8888.00	89.010	359.590	7712.21	1182.24	1118.25	-567.83	40°01'07.603"N	104°46'53.412"W	0.20	
8973.00	89.910	359.860	7713.01	1266.57	1203.25	-568.23	40°01'08.443"N	104°46'53.418"W	1.11	



Actual Wellpath Report

MARRS 28C-28HZ AWP

Page 4 of 6



REFERENCE WELLPATH IDENTIFICATION

Operator	KERR-MCGEE OIL & GAS ONSHORE LP	Slot	SLOT#02 MARRS 28C-28HZ (275'FSL & 1898'FEL, SEC.28)
Area	COLORADO	Well	MARRS 28C-28HZ
Field	WELD COUNTY (KERR MCGEE)	Wellbore	MARRS 28C-28HZ AWP
Facility	SEC.28-T1N-R66W		

WELLPATH DATA (160 stations)

MD [ft]	Inclination [°]	Azimuth [°]	TVD [ft]	Vert Sect [ft]	North [ft]	East [ft]	Latitude	Longitude	DLS [°/100ft]	Comments
9059.00	90.220	0.010	7712.91	1351.86	1289.25	-568.33	40°01'09.293"N	104°46'53.419"W	0.40	
9144.00	89.850	0.180	7712.86	1436.13	1374.25	-568.19	40°01'10.133"N	104°46'53.417"W	0.48	
9229.00	89.720	0.180	7713.18	1520.38	1459.25	-567.92	40°01'10.973"N	104°46'53.414"W	0.15	
9314.00	90.060	0.550	7713.34	1604.60	1544.24	-567.38	40°01'11.813"N	104°46'53.407"W	0.59	
9399.00	90.650	1.120	7712.81	1688.72	1629.23	-566.14	40°01'12.652"N	104°46'53.391"W	0.97	
9484.00	90.340	359.820	7712.08	1772.91	1714.23	-565.45	40°01'13.492"N	104°46'53.382"W	1.57	
9570.00	90.000	359.410	7711.83	1858.26	1800.22	-566.02	40°01'14.342"N	104°46'53.389"W	0.62	
9655.00	89.850	359.480	7711.94	1942.65	1885.22	-566.85	40°01'15.182"N	104°46'53.400"W	0.19	
9741.00	89.140	359.080	7712.69	2028.06	1971.21	-567.93	40°01'16.032"N	104°46'53.414"W	0.95	
9826.00	87.840	359.130	7714.93	2112.47	2056.17	-569.25	40°01'16.872"N	104°46'53.431"W	1.53	
9912.00	88.370	359.310	7717.78	2197.85	2142.11	-570.42	40°01'17.721"N	104°46'53.446"W	0.65	
9997.00	89.880	359.390	7719.08	2282.24	2227.09	-571.39	40°01'18.561"N	104°46'53.458"W	1.78	
10081.00	90.000	359.590	7719.16	2365.63	2311.09	-572.14	40°01'19.391"N	104°46'53.468"W	0.28	
10166.00	89.910	0.250	7719.23	2449.94	2396.09	-572.26	40°01'20.231"N	104°46'53.470"W	0.78	
10252.00	90.990	359.830	7718.56	2535.20	2482.08	-572.20	40°01'21.081"N	104°46'53.469"W	1.35	
10335.00	91.450	0.430	7716.79	2617.46	2565.06	-572.01	40°01'21.901"N	104°46'53.467"W	0.91	
10420.00	90.000	359.230	7715.71	2701.77	2650.05	-572.26	40°01'22.741"N	104°46'53.470"W	2.21	
10505.00	89.350	358.420	7716.19	2786.27	2735.03	-574.00	40°01'23.580"N	104°46'53.492"W	1.22	
10590.00	89.140	358.770	7717.31	2870.79	2820.00	-576.09	40°01'24.420"N	104°46'53.519"W	0.48	
10675.00	89.420	358.840	7718.38	2955.28	2904.98	-577.86	40°01'25.260"N	104°46'53.542"W	0.34	
10760.00	89.940	359.290	7718.86	3039.74	2989.96	-579.25	40°01'26.100"N	104°46'53.560"W	0.81	
10845.00	90.370	359.910	7718.63	3124.10	3074.96	-579.84	40°01'26.940"N	104°46'53.567"W	0.89	
10930.00	89.850	0.180	7718.46	3208.38	3159.96	-579.77	40°01'27.780"N	104°46'53.567"W	0.69	
11016.00	90.000	1.030	7718.58	3293.53	3245.95	-578.86	40°01'28.629"N	104°46'53.555"W	1.00	
11101.00	90.370	1.770	7718.30	3377.53	3330.93	-576.79	40°01'29.469"N	104°46'53.528"W	0.97	
11186.00	91.360	1.770	7717.02	3461.42	3415.87	-574.16	40°01'30.309"N	104°46'53.494"W	1.16	
11272.00	91.200	1.890	7715.10	3546.28	3501.81	-571.42	40°01'31.158"N	104°46'53.459"W	0.23	
11357.00	91.910	1.820	7712.79	3630.14	3586.73	-568.67	40°01'31.997"N	104°46'53.424"W	0.84	
11443.00	91.320	1.220	7710.37	3715.06	3672.67	-566.39	40°01'32.846"N	104°46'53.395"W	0.98	
11528.00	91.170	1.510	7708.52	3799.04	3757.62	-564.36	40°01'33.686"N	104°46'53.369"W	0.38	
11613.00	90.400	0.200	7707.36	3883.15	3842.60	-563.09	40°01'34.526"N	104°46'53.352"W	1.79	
11699.00	89.910	359.870	7707.12	3968.42	3928.60	-563.04	40°01'35.376"N	104°46'53.352"W	0.69	
11784.00	91.790	0.440	7705.86	4052.66	4013.59	-562.81	40°01'36.215"N	104°46'53.349"W	2.31	
11870.00	93.790	1.530	7701.68	4137.63	4099.47	-561.34	40°01'37.064"N	104°46'53.330"W	2.65	
11955.00	93.110	0.660	7696.56	4221.54	4184.30	-559.71	40°01'37.902"N	104°46'53.309"W	1.30	
12050.00	91.850	359.690	7692.45	4315.62	4279.21	-559.43	40°01'38.840"N	104°46'53.305"W	1.67	
12144.00	91.050	359.810	7690.07	4408.85	4373.17	-559.84	40°01'39.769"N	104°46'53.311"W	0.86	
12239.00	91.510	0.360	7687.95	4503.01	4468.15	-559.69	40°01'40.707"N	104°46'53.309"W	0.75	
12247.00	91.510	0.130	7687.74	4510.94	4476.15	-559.66	40°01'40.787"N	104°46'53.308"W	2.87	Last BHI MWD Survey
12318.00	91.510	0.130	7685.87	4581.30	4547.12	-559.50	40°01'41.488"N	104°46'53.306"W	0.00	Projection to Bit

HOLE & CASING SECTIONS - Ref Wellbore: MARRS 28C-28HZ AWP Ref Wellpath: MARRS 28C-28HZ AWP

String/Diameter	Start MD [ft]	End MD [ft]	Interval [ft]	Start TVD [ft]	End TVD [ft]	Start N/S [ft]	Start E/W [ft]	End N/S [ft]	End E/W [ft]
13.5in Open Hole	17.00	1368.00	1351.00	17.00	1367.95	0.00	0.00	-1.25	5.17
9.625in Casing Surface	17.00	1368.00	1351.00	17.00	1367.95	0.00	0.00	-1.25	5.17
8.75in Open Hole	1368.00	8100.00	6732.00	1367.95	7708.18	-1.25	5.17	334.13	-622.08
7in Casing Intermediate	17.00	8089.00	8072.00	17.00	7708.10	0.00	0.00	323.39	-624.44
6.125in Open Hole	8089.00	12318.00	4229.00	7708.10	7685.87	323.39	-624.44	4547.12	-559.50



Actual Wellpath Report

MARRS 28C-28HZ AWP

Page 5 of 6



REFERENCE WELLPATH IDENTIFICATION			
Operator	KERR-MCGEE OIL & GAS ONSHORE LP	Slot	SLOT#02 MARRS 28C-28HZ (275'FSL & 1898'FEL, SEC.28)
Area	COLORADO	Well	MARRS 28C-28HZ
Field	WELD COUNTY (KERR MCGEE)	Wellbore	MARRS 28C-28HZ AWP
Facility	SEC.28-T1N-R66W		

TARGETS									
Name	MD [ft]	TVD [ft]	North [ft]	East [ft]	Grid East [US ft]	Grid North [US ft]	Latitude	Longitude	Shape
MARRS PAD SECTION LINES		0.00	-0.30	24.12	3201832.76	1249388.96	40°00'56.549"N	104°46'45.804"W	polygon
MARRS PAD HARDLINES (460' SETBACKS)		7462.00	-0.30	24.12	3201832.76	1249388.96	40°00'56.549"N	104°46'45.804"W	polygon
MARRS 28C-28HZ BHL ON PLAT (460'FNL & 2480'FEL,REV-2)		7720.00	4552.60	-593.08	3201178.61	1253936.53	40°01'41.542"N	104°46'53.738"W	point
MARRS 28C-28HZ BHL ON PLAT (460'FNL & 2480'FEL,REV-1)		7722.00	4552.60	-593.08	3201178.61	1253936.53	40°01'41.542"N	104°46'53.738"W	point

WELLPATH COMPOSITION - Ref Wellbore: MARRS 28C-28HZ AWP Ref Wellpath: MARRS 28C-28HZ AWP				
Start MD [ft]	End MD [ft]	Positional Uncertainty Model	Log Name/Comment	Wellbore
17.00	1300.00	NaviTrak (Standard)	BHI MWD SURVEYS 13 1/2" HOLE <119-1300>	MARRS 28C-28HZ AWP
1300.00	8048.00	NaviTrak (Standard)	BHI MWD SURVEYS 8 3/4" HOLE <1433-8048>	MARRS 28C-28HZ AWP
8048.00	12247.00	NaviTrak (Standard)	BHI MWD SURVEYS 6 1/8" HOLE <8124-12247>	MARRS 28C-28HZ AWP
12247.00	12318.00	Blind Drilling (std)	Projection to bit	MARRS 28C-28HZ AWP



Actual Wellpath Report

MARRS 28C-28HZ AWP

Page 6 of 6



REFERENCE WELLPATH IDENTIFICATION

Operator	KERR-MCGEE OIL & GAS ONSHORE LP	Slot	SLOT#02 MARRS 28C-28HZ (275'FSL & 1898'FEL, SEC.28)
Area	COLORADO	Well	MARRS 28C-28HZ
Field	WELD COUNTY (KERR MCGEE)	Wellbore	MARRS 28C-28HZ AWP
Facility	SEC.28-T1N-R66W		

WELLPATH COMMENTS

MD [ft]	Inclination [°]	Azimuth [°]	TVD [ft]	Comment
17.00	0.000	50.570	17.00	Tie-On
119.00	0.460	50.570	119.00	Begin BHI MWD Surveys
8089.00	89.474	12.438	7708.10	7" Casing Point
12247.00	91.510	0.130	7687.74	Last BHI MWD Survey
12318.00	91.510	0.130	7685.87	Projection to Bit