

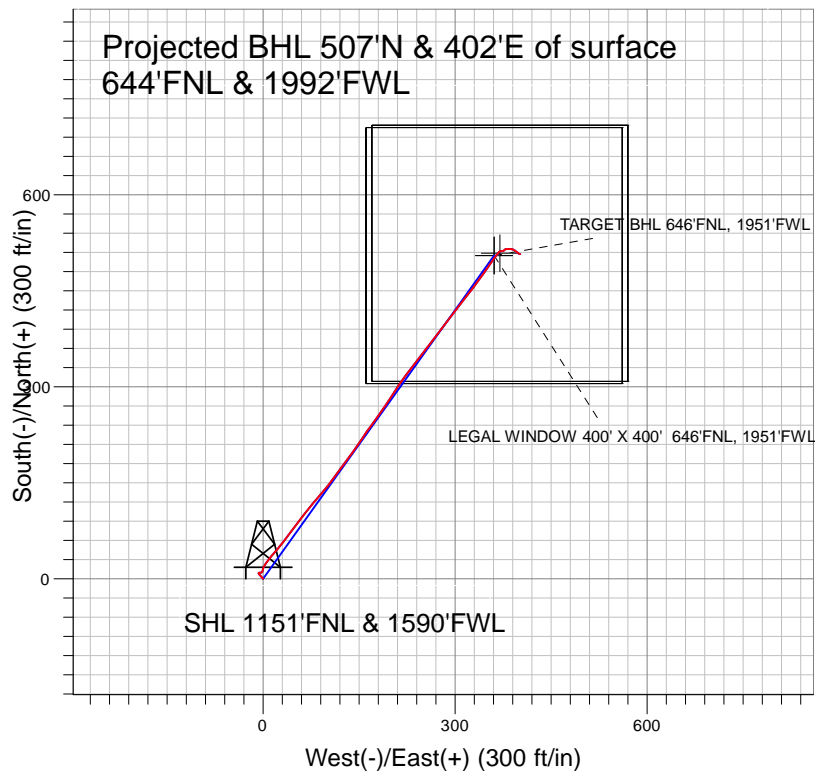



Mineral Resources Inc



LEGEND

-  Vetting #2, Vetting #2, Vetting #2 V0
-  Vetting #2
-  Survey #1

Final Survey Plot

Projected Final Survey -
7195'MD & 7131'TVD @ 646' VS
0.8 deg Inc 112.7 deg AZ

Project: SEC.23-T5N-R65W
Site: Vetting Pad Sec.23-T5N-R65W
Well: Vetting #2
Plan: Vetting #2



Mineral Resources Inc

SEC.23-T5N-R65W

Vetting Pad Sec.23-T5N-R65W

Vetting #2

Vetting #2

Survey: Survey #1

Standard Survey Report

12 November, 2008

Company:	Mineral Resources Inc	Local Co-ordinate Reference:	Well Vetting #2
Project:	SEC.23-T5N-R65W	TVD Reference:	WELL @ 4643.0ft (Original Well Elev)
Site:	Vetting Pad Sec.23-T5N-R65W	MD Reference:	WELL @ 4643.0ft (Original Well Elev)
Well:	Vetting #2	North Reference:	True
Wellbore:	Vetting #2	Survey Calculation Method:	Minimum Curvature
Design:	Vetting #2	Database:	EDM den0-adp01 Server Data

Project	SEC.23-T5N-R65W, Weld County, Colorado		
Map System:	US State Plane 1983	System Datum:	Mean Sea Level
Geo Datum:	North American Datum 1983		Using Well Reference Point
Map Zone:	Colorado Northern Zone		Using geodetic scale factor

Site	Vetting Pad Sec.23-T5N-R65W		
Site Position:		Northing:	1,385,642.83ft
From:	Lat/Long	Easting:	3,241,145.35ft
Position Uncertainty:	0.0 ft	Slot Radius:	"
		Latitude:	40° 23' 19.536 N
		Longitude:	104° 38' 3.444 W
		Grid Convergence:	0.56 °

Well	Vetting #2		
Well Position	+N/-S	0.0 ft	Northing:
	+E/-W	0.0 ft	Easting:
Position Uncertainty		0.0 ft	Wellhead Elevation:
			Latitude:
			Longitude:
			Ground Level:

Wellbore	Vetting #2		
Magnetics	Model Name	Sample Date	Declination (°)
	IGRF200510	10/31/2008	9.11
			Dip Angle (°)
			67.16
			Field Strength (nT)
			53,435

Design	Vetting #2		
Audit Notes:			
Version:	1.0	Phase:	ACTUAL
		Tie On Depth:	0.0
Vertical Section:	Depth From (TVD) (ft)	+N/-S (ft)	+E/-W (ft)
	0.0	0.0	0.0
			Direction (°)
			38.40

Survey Program	Date	11/12/2008		
From (ft)	To (ft)	Survey (Wellbore)	Tool Name	Description
555.0	7,195.0	Survey #1 (Vetting #2)	MWD	MWD - Standard

Survey										
Measured Depth (ft)	Inclination (°)	Azimuth (°)	Vertical Depth (ft)	+N/-S (ft)	+E/-W (ft)	Vertical Section (ft)	Dogleg Rate (°/100ft)	Build Rate (°/100ft)	Turn Rate (°/100ft)	
0.0	0.00	0.00	0.0	0.0	0.0	0.0	0.00	0.00	0.00	
40.0	0.13	319.00	40.0	0.0	0.0	0.0	0.32	0.32	0.00	
80.0	0.26	319.00	80.0	0.1	-0.1	0.0	0.32	0.32	0.00	
120.0	0.39	319.00	120.0	0.3	-0.3	0.1	0.32	0.32	0.00	
160.0	0.52	319.00	160.0	0.5	-0.5	0.1	0.32	0.32	0.00	
200.0	0.65	319.00	200.0	0.9	-0.7	0.2	0.32	0.32	0.00	
240.0	0.78	319.00	240.0	1.2	-1.1	0.3	0.32	0.32	0.00	
280.0	0.91	319.00	280.0	1.7	-1.5	0.4	0.32	0.32	0.00	
320.0	1.04	319.00	320.0	2.2	-1.9	0.5	0.32	0.32	0.00	
360.0	1.17	319.00	360.0	2.8	-2.4	0.7	0.32	0.32	0.00	
400.0	1.30	319.00	400.0	3.4	-3.0	0.8	0.32	0.32	0.00	
440.0	1.43	319.00	440.0	4.1	-3.6	1.0	0.32	0.32	0.00	
480.0	1.56	319.00	479.9	4.9	-4.3	1.2	0.32	0.32	0.00	

Company:	Mineral Resources Inc	Local Co-ordinate Reference:	Well Vetting #2
Project:	SEC.23-T5N-R65W	TVD Reference:	WELL @ 4643.0ft (Original Well Elev)
Site:	Vetting Pad Sec.23-T5N-R65W	MD Reference:	WELL @ 4643.0ft (Original Well Elev)
Well:	Vetting #2	North Reference:	True
Wellbore:	Vetting #2	Survey Calculation Method:	Minimum Curvature
Design:	Vetting #2	Database:	EDM den0-adp01 Server Data

Survey										
Measured Depth (ft)	Inclination (°)	Azimuth (°)	Vertical Depth (ft)	+N/-S (ft)	+E/-W (ft)	Vertical Section (ft)	Dogleg Rate (°/100ft)	Build Rate (°/100ft)	Turn Rate (°/100ft)	
520.0	1.69	319.00	519.9	5.8	-5.0	1.4	0.32	0.32	0.00	
560.0	1.74	319.67	559.9	6.7	-5.8	1.6	0.15	0.14	1.69	
600.0	1.29	327.24	599.9	7.5	-6.5	1.9	1.24	-1.14	18.92	
640.0	0.88	342.38	639.9	8.2	-6.8	2.2	1.24	-1.02	37.84	
680.0	0.61	358.96	679.9	8.7	-6.9	2.6	0.86	-0.68	41.45	
720.0	0.43	26.76	719.9	9.1	-6.8	2.9	0.76	-0.45	69.51	
760.0	0.42	60.08	759.9	9.3	-6.6	3.1	0.61	-0.02	83.29	
800.0	0.50	77.85	799.9	9.4	-6.3	3.4	0.40	0.20	44.44	
840.0	0.59	89.01	839.9	9.4	-5.9	3.7	0.35	0.23	27.89	
880.0	0.46	85.62	879.9	9.4	-5.6	3.9	0.33	-0.32	-8.46	
920.0	0.33	79.63	919.9	9.4	-5.3	4.1	0.33	-0.32	-14.98	
960.0	0.30	82.75	959.9	9.5	-5.1	4.3	0.10	-0.09	7.81	
1,000.0	0.30	90.64	999.9	9.5	-4.9	4.4	0.10	0.00	19.71	
1,040.0	0.27	95.49	1,039.9	9.5	-4.7	4.5	0.09	-0.07	12.15	
1,080.0	0.18	95.47	1,079.9	9.5	-4.5	4.6	0.21	-0.21	-0.07	
1,120.0	0.10	94.61	1,119.9	9.5	-4.4	4.7	0.20	-0.20	-2.14	
1,160.0	0.23	80.70	1,159.9	9.5	-4.3	4.7	0.33	0.31	-34.78	
1,200.0	0.36	76.74	1,199.9	9.5	-4.1	4.9	0.33	0.32	-9.92	
1,240.0	0.37	78.27	1,239.9	9.6	-3.8	5.1	0.04	0.03	3.84	
1,280.0	0.33	82.38	1,279.9	9.6	-3.6	5.3	0.12	-0.11	10.27	
1,320.0	0.33	85.06	1,319.9	9.6	-3.4	5.4	0.04	0.00	6.71	
1,360.0	0.41	83.41	1,359.9	9.7	-3.1	5.6	0.21	0.21	-4.13	
1,400.0	0.50	82.32	1,399.9	9.7	-2.8	5.9	0.21	0.21	-2.72	
1,440.0	0.44	69.32	1,439.9	9.8	-2.5	6.1	0.30	-0.15	-32.50	
1,480.0	0.40	52.73	1,479.9	9.9	-2.2	6.4	0.31	-0.09	-41.49	
1,520.0	0.40	48.84	1,519.9	10.1	-2.0	6.7	0.07	-0.01	-9.72	
1,560.0	0.40	53.40	1,559.9	10.3	-1.8	6.9	0.08	0.00	11.41	
1,600.0	0.42	51.72	1,599.9	10.4	-1.6	7.2	0.05	0.04	-4.22	
1,640.0	0.49	36.82	1,639.9	10.7	-1.4	7.5	0.35	0.19	-37.24	
1,680.0	0.59	26.43	1,679.9	11.0	-1.2	7.9	0.35	0.25	-25.96	
1,720.0	0.64	22.83	1,719.9	11.4	-1.0	8.3	0.15	0.12	-9.02	
1,760.0	0.68	20.00	1,759.9	11.8	-0.8	8.7	0.13	0.11	-7.08	
1,800.0	0.74	14.88	1,799.8	12.3	-0.7	9.2	0.22	0.16	-12.78	
1,840.0	0.83	8.98	1,839.8	12.8	-0.6	9.7	0.29	0.21	-14.76	
1,880.0	0.92	5.35	1,879.8	13.4	-0.5	10.2	0.26	0.22	-9.08	
1,920.0	1.00	5.94	1,919.8	14.1	-0.4	10.8	0.21	0.21	1.48	
1,960.0	1.09	6.44	1,959.8	14.8	-0.4	11.4	0.21	0.21	1.25	
2,000.0	1.34	16.25	1,999.8	15.6	-0.2	12.1	0.81	0.63	24.52	
2,040.0	1.65	23.68	2,039.8	16.6	0.2	13.1	0.91	0.77	18.57	
2,080.0	2.18	27.02	2,079.8	17.8	0.7	14.4	1.36	1.33	8.35	
2,120.0	2.90	27.86	2,119.7	19.4	1.6	16.1	1.81	1.81	2.12	
2,160.0	3.61	29.28	2,159.7	21.4	2.6	18.4	1.79	1.78	3.55	
2,200.0	4.29	33.87	2,199.6	23.7	4.1	21.1	1.85	1.68	11.48	
2,240.0	4.98	37.21	2,239.5	26.3	6.0	24.3	1.85	1.73	8.34	
2,280.0	5.73	38.25	2,279.3	29.3	8.3	28.1	1.90	1.89	2.60	
2,320.0	6.50	38.77	2,319.1	32.6	10.9	32.3	1.92	1.92	1.31	
2,360.0	7.32	39.64	2,358.8	36.3	13.9	37.1	2.08	2.06	2.18	
2,400.0	8.22	40.79	2,398.4	40.5	17.4	42.5	2.27	2.23	2.85	
2,440.0	9.11	41.24	2,437.9	45.0	21.4	48.6	2.25	2.25	1.12	
2,480.0	10.04	38.62	2,477.4	50.1	25.7	55.2	2.56	2.32	-6.55	
2,520.0	10.99	36.44	2,516.7	55.9	30.1	62.5	2.56	2.36	-5.44	
2,560.0	12.06	36.87	2,555.9	62.3	34.9	70.5	2.68	2.67	1.07	
2,600.0	13.16	37.82	2,594.9	69.2	40.1	79.2	2.82	2.77	2.38	
2,640.0	13.93	38.19	2,633.8	76.7	46.0	88.6	1.92	1.91	0.92	

Company:	Mineral Resources Inc	Local Co-ordinate Reference:	Well Vetting #2
Project:	SEC.23-T5N-R65W	TVD Reference:	WELL @ 4643.0ft (Original Well Elev)
Site:	Vetting Pad Sec.23-T5N-R65W	MD Reference:	WELL @ 4643.0ft (Original Well Elev)
Well:	Vetting #2	North Reference:	True
Wellbore:	Vetting #2	Survey Calculation Method:	Minimum Curvature
Design:	Vetting #2	Database:	EDM den0-adp01 Server Data

Survey									
Measured Depth (ft)	Inclination (°)	Azimuth (°)	Vertical Depth (ft)	+N/-S (ft)	+E/-W (ft)	Vertical Section (ft)	Dogleg Rate (°/100ft)	Build Rate (°/100ft)	Turn Rate (°/100ft)
2,680.0	14.22	37.93	2,672.6	84.3	52.0	98.4	0.76	0.74	-0.64
2,720.0	14.45	37.66	2,711.4	92.2	58.1	108.3	0.58	0.55	-0.67
2,760.0	13.72	37.14	2,750.2	99.9	64.0	118.0	1.84	-1.81	-1.30
2,800.0	13.00	36.57	2,789.1	107.3	69.5	127.3	1.84	-1.81	-1.44
2,840.0	12.82	38.29	2,828.1	114.4	74.9	136.1	1.06	-0.46	4.30
2,880.0	12.86	40.89	2,867.1	121.2	80.5	145.0	1.45	0.11	6.49
2,920.0	12.96	42.07	2,906.1	127.9	86.5	153.9	0.71	0.26	2.97
2,960.0	13.13	40.96	2,945.0	134.6	92.5	163.0	0.76	0.42	-2.79
3,000.0	13.28	39.85	2,984.0	141.6	98.4	172.1	0.74	0.38	-2.78
3,040.0	12.54	37.64	3,023.0	148.6	104.0	181.0	2.22	-1.84	-5.52
3,080.0	11.83	35.17	3,062.1	155.4	109.0	189.5	2.22	-1.79	-6.18
3,120.0	11.74	34.86	3,101.2	162.0	113.6	197.6	0.26	-0.21	-0.77
3,160.0	11.96	35.67	3,140.4	168.7	118.4	205.8	0.67	0.53	2.02
3,200.0	12.17	36.56	3,179.5	175.5	123.3	214.1	0.71	0.53	2.22
3,240.0	12.38	37.63	3,218.6	182.3	128.4	222.6	0.78	0.53	2.69
3,280.0	12.59	38.67	3,257.6	189.1	133.8	231.3	0.78	0.54	2.60
3,320.0	12.63	36.37	3,296.7	196.0	139.1	240.0	1.26	0.08	-5.77
3,360.0	12.68	33.99	3,335.7	203.1	144.1	248.7	1.31	0.12	-5.95
3,400.0	12.54	33.23	3,374.7	210.5	148.9	257.5	0.54	-0.34	-1.90
3,440.0	12.29	33.44	3,413.8	217.6	153.7	266.0	0.65	-0.64	0.53
3,480.0	11.97	33.99	3,452.9	224.7	158.3	274.4	0.84	-0.79	1.37
3,520.0	11.50	35.47	3,492.1	231.3	163.0	282.5	1.40	-1.18	3.70
3,560.0	11.03	37.07	3,531.3	237.6	167.6	290.3	1.40	-1.16	4.01
3,600.0	11.31	36.58	3,570.5	243.8	172.2	298.1	0.74	0.70	-1.22
3,640.0	11.65	35.96	3,609.7	250.3	176.9	306.0	0.91	0.85	-1.57
3,680.0	11.85	35.28	3,648.9	256.9	181.7	314.2	0.59	0.48	-1.69
3,720.0	11.93	34.55	3,688.0	263.6	186.4	322.4	0.43	0.21	-1.81
3,760.0	12.04	33.89	3,727.2	270.5	191.1	330.7	0.43	0.26	-1.66
3,800.0	12.21	33.42	3,766.3	277.5	195.7	339.1	0.49	0.42	-1.18
3,840.0	12.38	32.96	3,805.4	284.6	200.4	347.5	0.49	0.43	-1.15
3,880.0	12.25	33.23	3,844.4	291.8	205.1	356.0	0.35	-0.32	0.68
3,920.0	12.08	33.61	3,883.5	298.8	209.7	364.4	0.47	-0.43	0.96
3,960.0	11.86	34.34	3,922.7	305.7	214.3	372.7	0.66	-0.54	1.81
4,000.0	11.61	35.39	3,961.8	312.4	219.0	380.8	0.84	-0.64	2.64
4,040.0	11.50	36.55	4,001.0	318.9	223.7	388.8	0.64	-0.28	2.88
4,080.0	12.05	37.88	4,040.2	325.4	228.6	397.0	1.53	1.38	3.33
4,120.0	12.60	39.10	4,079.3	332.0	233.9	405.5	1.53	1.39	3.04
4,160.0	12.59	38.30	4,118.3	338.9	239.4	414.3	0.44	-0.03	-2.00
4,200.0	12.46	37.06	4,157.3	345.7	244.7	422.9	0.74	-0.32	-3.09
4,240.0	12.44	36.60	4,196.4	352.6	249.8	431.5	0.25	-0.06	-1.14
4,280.0	12.53	37.03	4,235.5	359.5	255.0	440.2	0.31	0.21	1.07
4,320.0	12.59	37.45	4,274.5	366.5	260.3	448.9	0.29	0.17	1.05
4,360.0	12.55	37.88	4,313.5	373.4	265.6	457.6	0.25	-0.11	1.06
4,400.0	12.51	38.30	4,352.6	380.2	271.0	466.3	0.25	-0.11	1.07
4,440.0	12.80	37.78	4,391.6	387.1	276.4	475.0	0.77	0.72	-1.31
4,480.0	13.18	37.02	4,430.6	394.2	281.8	484.0	1.05	0.96	-1.90
4,520.0	13.20	36.58	4,469.5	401.6	287.3	493.2	0.25	0.06	-1.09
4,560.0	12.73	36.54	4,508.5	408.8	292.7	502.2	1.17	-1.17	-0.10
4,600.0	12.32	36.55	4,547.6	415.8	297.8	510.8	1.03	-1.03	0.02
4,640.0	12.62	37.21	4,586.6	422.7	303.0	519.4	0.82	0.74	1.64
4,680.0	12.92	37.83	4,625.6	429.7	308.4	528.3	0.82	0.75	1.57
4,720.0	13.25	38.10	4,664.6	436.8	314.0	537.3	0.84	0.82	0.66
4,760.0	13.59	38.22	4,703.5	444.1	319.7	546.6	0.85	0.85	0.32
4,800.0	13.45	38.04	4,742.4	451.5	325.5	556.1	0.36	-0.35	-0.46

Company:	Mineral Resources Inc	Local Co-ordinate Reference:	Well Vetting #2
Project:	SEC.23-T5N-R65W	TVD Reference:	WELL @ 4643.0ft (Original Well Elev)
Site:	Vetting Pad Sec.23-T5N-R65W	MD Reference:	WELL @ 4643.0ft (Original Well Elev)
Well:	Vetting #2	North Reference:	True
Wellbore:	Vetting #2	Survey Calculation Method:	Minimum Curvature
Design:	Vetting #2	Database:	EDM den0-adp01 Server Data

Survey									
Measured Depth (ft)	Inclination (°)	Azimuth (°)	Vertical Depth (ft)	+N/-S (ft)	+E/-W (ft)	Vertical Section (ft)	Dogleg Rate (°/100ft)	Build Rate (°/100ft)	Turn Rate (°/100ft)
4,840.0	12.51	37.27	4,781.3	458.6	331.0	565.0	2.38	-2.34	-1.92
4,880.0	11.59	36.38	4,820.5	465.3	336.0	573.4	2.35	-2.30	-2.21
4,920.0	11.16	35.70	4,859.7	471.7	340.7	581.3	1.12	-1.07	-1.72
4,960.0	10.74	34.95	4,898.9	477.9	345.1	588.9	1.12	-1.06	-1.85
5,000.0	9.96	34.55	4,938.3	483.8	349.2	596.1	1.95	-1.94	-1.00
5,040.0	9.01	34.30	4,977.7	489.3	352.9	602.7	2.37	-2.37	-0.64
5,080.0	8.00	34.53	5,017.3	494.2	356.3	608.6	2.55	-2.55	0.57
5,120.0	6.84	36.01	5,057.0	498.4	359.2	613.7	2.92	-2.88	3.72
5,160.0	5.70	38.10	5,096.7	501.9	361.9	618.1	2.92	-2.86	5.21
5,200.0	4.93	37.26	5,136.5	504.8	364.1	621.8	1.93	-1.92	-2.10
5,240.0	4.17	36.11	5,176.4	507.4	366.0	625.0	1.93	-1.91	-2.87
5,280.0	3.16	40.14	5,216.3	509.4	367.6	627.6	2.59	-2.51	10.09
5,320.0	2.10	53.21	5,256.3	510.7	368.9	629.4	3.03	-2.65	32.68
5,360.0	1.37	72.44	5,296.3	511.2	369.9	630.4	2.31	-1.82	48.06
5,400.0	0.95	71.04	5,336.3	511.5	370.7	631.1	1.07	-1.07	-3.50
5,440.0	0.52	67.35	5,376.3	511.6	371.2	631.5	1.07	-1.06	-9.22
5,480.0	0.58	72.94	5,416.3	511.8	371.5	631.8	0.19	0.14	13.99
5,520.0	0.66	77.65	5,456.3	511.9	371.9	632.2	0.25	0.22	11.76
5,560.0	0.78	80.81	5,496.3	512.0	372.4	632.6	0.30	0.28	7.90
5,563.6	0.79	81.02	5,499.8	512.0	372.5	632.6	0.33	0.32	5.97
TARGET BHL 646'FNL, 1951'FWL									
5,600.0	0.90	82.89	5,536.3	512.1	373.0	633.0	0.33	0.32	5.12
5,640.0	1.02	83.71	5,576.2	512.1	373.7	633.5	0.30	0.29	2.06
5,680.0	1.11	82.31	5,616.2	512.2	374.4	634.0	0.22	0.21	-3.50
5,720.0	1.19	81.11	5,656.2	512.3	375.2	634.6	0.22	0.21	-3.00
5,760.0	0.98	68.46	5,696.2	512.5	376.0	635.2	0.79	-0.52	-31.64
5,800.0	0.83	47.97	5,736.2	512.8	376.5	635.8	0.89	-0.39	-51.23
5,840.0	0.85	37.10	5,776.2	513.3	376.9	636.3	0.40	0.05	-27.16
5,880.0	0.93	37.58	5,816.2	513.8	377.2	637.0	0.21	0.21	1.19
5,920.0	0.97	40.92	5,856.2	514.3	377.6	637.6	0.17	0.10	8.35
5,960.0	0.89	58.21	5,896.2	514.7	378.1	638.3	0.73	-0.22	43.23
6,000.0	0.89	77.15	5,936.2	515.0	378.7	638.8	0.73	0.01	47.36
6,040.0	1.15	84.12	5,976.2	515.1	379.4	639.3	0.72	0.65	17.41
6,080.0	1.45	87.19	6,016.2	515.1	380.3	639.9	0.77	0.75	7.70
6,120.0	1.66	88.40	6,056.2	515.2	381.4	640.6	0.54	0.54	3.01
6,160.0	1.79	88.57	6,096.1	515.2	382.6	641.4	0.32	0.32	0.43
6,200.0	1.91	88.89	6,136.1	515.2	383.9	642.2	0.29	0.29	0.81
6,240.0	1.95	90.16	6,176.1	515.2	385.2	643.1	0.15	0.11	3.16
6,280.0	1.99	91.36	6,216.1	515.2	386.6	643.9	0.15	0.11	3.02
6,320.0	1.48	93.76	6,256.1	515.2	387.9	644.7	1.29	-1.28	5.98
6,360.0	0.84	100.19	6,296.0	515.1	388.7	645.1	1.63	-1.60	16.08
6,400.0	0.60	109.58	6,336.0	515.0	389.1	645.2	0.67	-0.61	23.47
6,440.0	0.81	108.03	6,376.0	514.8	389.5	645.4	0.53	0.53	-3.87
6,480.0	1.00	107.79	6,416.0	514.6	390.2	645.6	0.48	0.48	-0.61
6,520.0	0.99	113.70	6,456.0	514.4	390.8	645.9	0.26	-0.02	14.79
6,560.0	1.00	119.63	6,496.0	514.1	391.4	646.0	0.26	0.01	14.82
6,600.0	1.06	122.47	6,536.0	513.7	392.0	646.1	0.21	0.17	7.09
6,640.0	1.15	124.06	6,576.0	513.3	392.7	646.1	0.23	0.21	3.97
6,680.0	1.25	125.72	6,616.0	512.8	393.4	646.2	0.27	0.26	4.15
6,720.0	1.38	127.49	6,656.0	512.2	394.1	646.2	0.33	0.32	4.44
6,760.0	1.49	128.75	6,696.0	511.6	394.9	646.2	0.30	0.29	3.14
6,800.0	1.36	125.41	6,736.0	511.0	395.7	646.3	0.39	-0.33	-8.35
6,840.0	1.24	121.37	6,776.0	510.5	396.4	646.3	0.39	-0.31	-10.09
6,880.0	1.20	121.43	6,815.9	510.1	397.2	646.4	0.09	-0.09	0.14

Company:	Mineral Resources Inc	Local Co-ordinate Reference:	Well Vetting #2
Project:	SEC.23-T5N-R65W	TVD Reference:	WELL @ 4643.0ft (Original Well Elev)
Site:	Vetting Pad Sec.23-T5N-R65W	MD Reference:	WELL @ 4643.0ft (Original Well Elev)
Well:	Vetting #2	North Reference:	True
Wellbore:	Vetting #2	Survey Calculation Method:	Minimum Curvature
Design:	Vetting #2	Database:	EDM den0-adp01 Server Data

Survey										
Measured Depth (ft)	Inclination (°)	Azimuth (°)	Vertical Depth (ft)	+N/-S (ft)	+E/-W (ft)	Vertical Section (ft)	Dogleg Rate (°/100ft)	Build Rate (°/100ft)	Turn Rate (°/100ft)	
6,920.0	1.20	123.47	6,855.9	509.6	397.9	646.5	0.11	0.00	5.11	
6,960.0	1.18	125.50	6,895.9	509.2	398.6	646.6	0.11	-0.04	5.08	
7,000.0	1.14	127.62	6,935.9	508.7	399.2	646.6	0.15	-0.11	5.29	
7,040.0	1.10	129.90	6,975.9	508.2	399.8	646.6	0.15	-0.10	5.70	
7,080.0	0.96	123.90	7,015.9	507.8	400.4	646.6	0.44	-0.34	-15.01	
7,120.0	0.84	116.01	7,055.9	507.4	400.9	646.7	0.44	-0.31	-19.71	
7,160.0	0.80	112.70	7,095.9	507.2	401.5	646.9	0.15	-0.10	-8.28	
LEGAL WINDOW 400' X 400' 646'FNL, 1951'FWL - LEGAL WINDOW 400' X 400' 646'FNL, 1951'FWL										

Checked By: _____ Approved By: _____ Date: _____