

LOCATION DRAWING

WESTERN PC K15-79HN

SECTION: 10
TOWNSHIP: 4N
RANGE: 66W

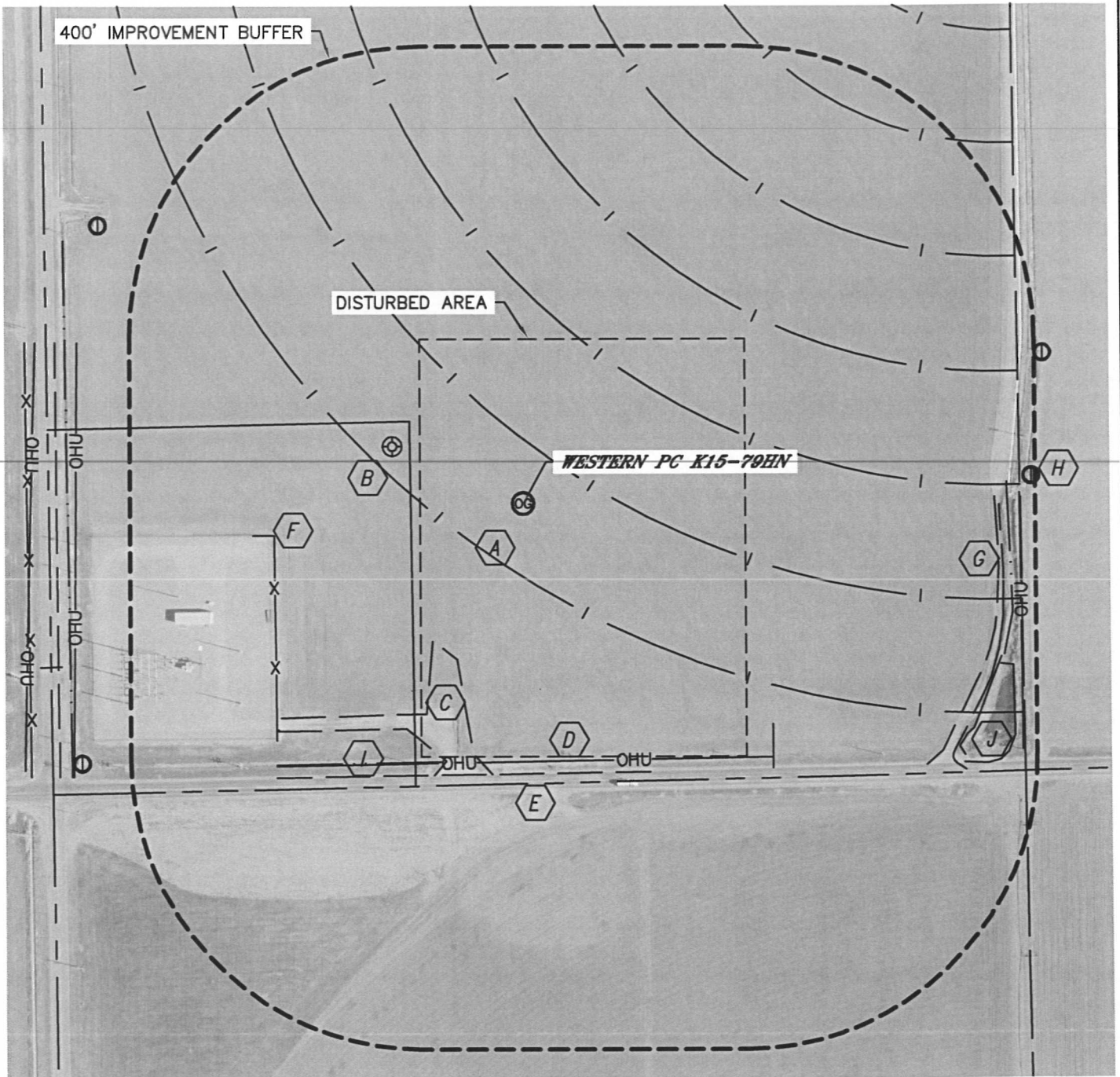

IMPROVEMENTS:

- | | | | |
|----------|---|----------|---------------------------------|
| A | PIVOT TRACK 85' SW, 72', 228', 384', 541' & 696' NE | F | FENCE AROUND SUBSTATION 346' SW |
| B | EX. O&G WELL 197' NW | G | FIELD ROAD 650' E |
| C | GRAVEL DRIVE 228' SW | H | IRRIGATION WELL 703' & 746' NE |
| D | OVERHEAD UTILITY 354' S, 685' E | I | DITCH 371' SW, 669' E, 629' W |
| E | COUNTY ROAD 46 370' S | J | IRRIGATION POND 691' SE |

NEAREST: BUILDING 1335' SE, PUBLIC ROAD 370' S (CR 46),
ABOVE GROUND UTILITY 354' S, RAILROAD 5280'+ SE, PROPERTY LINE 155' W

