



MARATHON OIL COMPANY

Location: COLORADO Slot: SLOT#02 CROW VALLEY 7-62-26-2H (342°FNL & 1819°FWL, SEC.35)
Field: WELD COUNTY (NAD 83, GRID NORTH) Well: CROW VALLEY 7-62-26-2H
Facility: SEC.35-T7N-R62W Wellbore: CROW VALLEY 7-62-26-2H PWB



| | |
|---|--|
| Plot reference wellpath is CROW VALLEY 7-62-26-2H (REV-E.0) PWP | |
| True vertical depths are referenced to Rig on SLOT#02 CROW VALLEY 7-62-26-2H (342°FNL & 1819°FWL, SEC.35) (RKB) | Grid System: NAD83 / Lambert Colorado SP, Northern Zone (501), US feet |
| Measured depths are referenced to Rig on SLOT#02 CROW VALLEY 7-62-26-2H (342°FNL & 1819°FWL, SEC.35) (RKB) | North Reference: Grid north |
| Rig on SLOT#02 CROW VALLEY 7-62-26-2H (342°FNL & 1819°FWL, SEC.35) (RKB) to Mean Sea Level: 4837 feet | Scale: True distance |
| Mean Sea Level to Mud line (At Slot: SLOT#02 CROW VALLEY 7-62-26-2H (342°FNL & 1819°FWL, SEC.35)): 0 feet | Depths are in feet |
| Coordinates are in feet referenced to Slot | Created by: cookdam on 4/18/2012 |

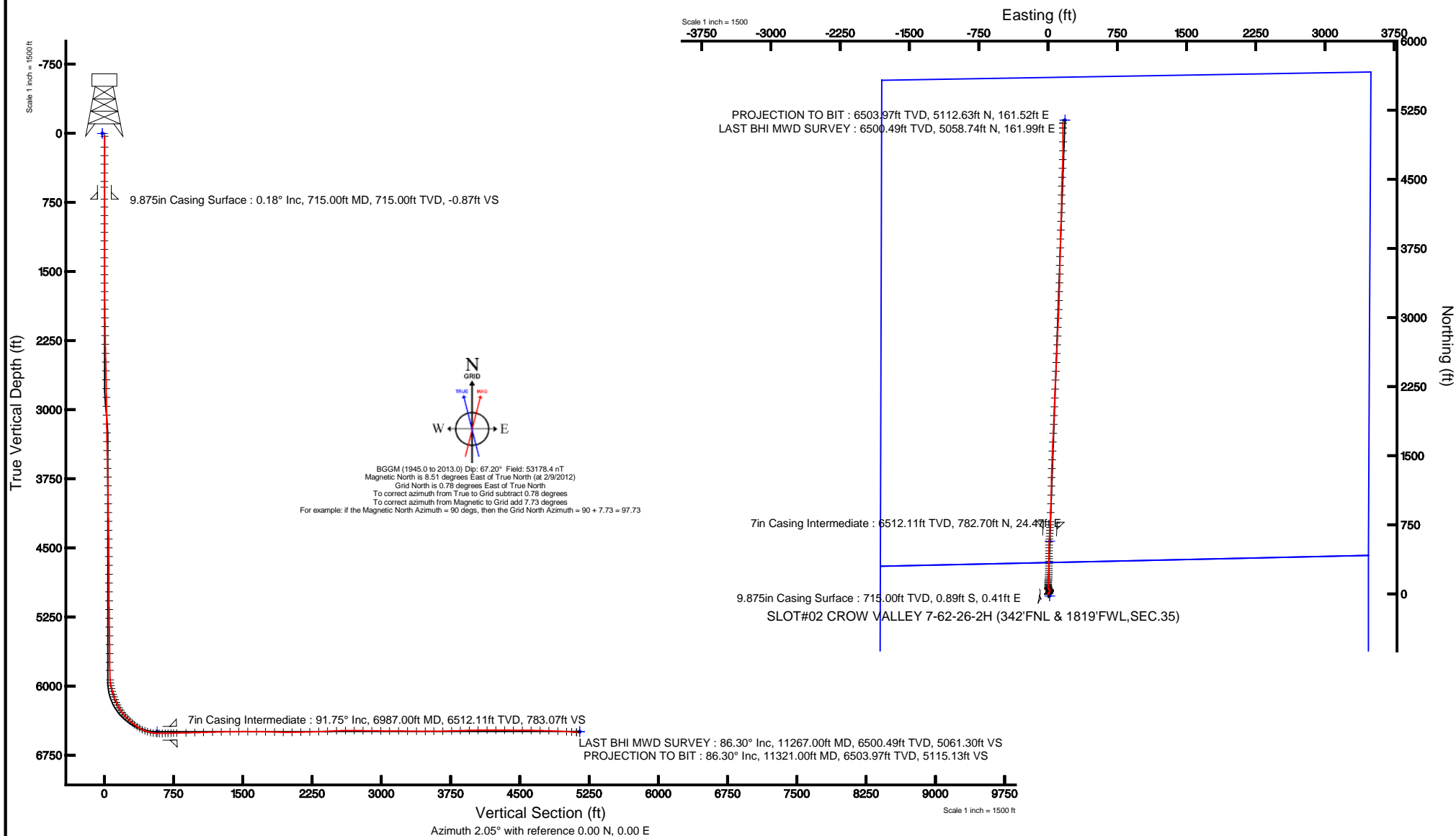



Actual Wellpath Report

CROW VALLEY 7-62-26-2H awp

Page 1 of 6



REFERENCE WELLPATH IDENTIFICATION

| | | | |
|----------|----------------------------------|----------|--|
| Operator | MARATHON OIL COMPANY | Slot | SLOT#02 CROW VALLEY 7-62-26-2H (342'FNL & 1819'FWL,SEC.35) |
| Area | COLORADO | Well | CROW VALLEY 7-62-26-2H |
| Field | WELD COUNTY (NAD 83, GRID NORTH) | Wellbore | CROW VALLEY 7-62-26-2H awb |
| Facility | SEC.35-T7N-R62W | | |

REPORT SETUP INFORMATION

| | | | |
|---------------------|---|----------------------|--|
| Projection System | NAD83 / Lambert Colorado SP, Northern Zone (501), US feet | Software System | WellArchitect® 4.0.0 |
| North Reference | Grid | User | Cookdanm |
| Scale | 0.999969 | Report Generated | 4/18/2012 at 4:40:51 PM |
| Convergence at slot | 0.78° East | Database/Source file | WA_Denver/CROW_VALLEY_7-62-26-2H_awb.xml |

WELLPATH LOCATION

| | Local coordinates | | Grid coordinates | | Geographic coordinates | |
|-----------------------|-------------------|----------|------------------|-----------------|------------------------|-----------------|
| | North[ft] | East[ft] | Easting[US ft] | Northing[US ft] | Latitude | Longitude |
| Slot Location | 23.99 | -18.00 | 3335709.27 | 1440795.00 | 40°32'13.583"N | 104°17'31.724"W |
| Facility Reference Pt | | | 3335727.27 | 1440771.01 | 40°32'13.343"N | 104°17'31.495"W |
| Field Reference Pt | | | 3476081.76 | 1512960.14 | 40°43'43.704"N | 103°46'55.829"W |

WELLPATH DATUM

| | | |
|--------------------------|---|---|
| Calculation method | Minimum curvature | Rig on SLOT#02 CROW VALLEY 7-62-26-2H (342'FNL & 1819'FWL,SEC.35) (RKB) to Facility Vertical Datum |
| Horizontal Reference Pt | Slot | Rig on SLOT#02 CROW VALLEY 7-62-26-2H (342'FNL & 1819'FWL,SEC.35) (RKB) to Mean Sea Level |
| Vertical Reference Pt | Rig on SLOT#02 CROW VALLEY 7-62-26-2H (342'FNL & 1819'FWL,SEC.35) (RKB) | Rig on SLOT#02 CROW VALLEY 7-62-26-2H (342'FNL & 1819'FWL,SEC.35) (RKB) to Mud Line at Slot (SLOT#0 |
| MD Reference Pt | Rig on SLOT#02 CROW VALLEY 7-62-26-2H (342'FNL & 1819'FWL,SEC.35) (RKB) | Section Origin |
| Field Vertical Reference | Mean Sea Level | Section Azimuth |



Actual Wellpath Report

CROW VALLEY 7-62-26-2H awp

Page 2 of 6



REFERENCE WELLPATH IDENTIFICATION

| | | | |
|----------|----------------------------------|----------|--|
| Operator | MARATHON OIL COMPANY | Slot | SLOT#02 CROW VALLEY 7-62-26-2H (342°FNL & 1819°FWL,SEC.35) |
| Area | COLORADO | Well | CROW VALLEY 7-62-26-2H |
| Field | WELD COUNTY (NAD 83, GRID NORTH) | Wellbore | CROW VALLEY 7-62-26-2H awb |
| Facility | SEC.35-T7N-R62W | | |

WELLPATH DATA (141 stations) † = interpolated/extrapolated station

| MD [ft] | Inclination [°] | Azimuth [°] | TVD [ft] | Vert Sect [ft] | North [ft] | East [ft] | Grid East [US ft] | Grid North [US ft] | Latitude | Longitude | DLS [°/100ft] | Comments |
|---------|-----------------|-------------|----------|----------------|------------|-----------|-------------------|--------------------|----------------|-----------------|---------------|----------|
| 0.00† | 0.000 | 167.900 | 0.00 | 0.00 | 0.00 | 0.00 | 3335709.27 | 1440795.00 | 40°32'13.583"N | 104°17'31.724"W | 0.00 | |
| 31.00 | 0.000 | 167.900 | 31.00 | 0.00 | 0.00 | 0.00 | 3335709.27 | 1440795.00 | 40°32'13.583"N | 104°17'31.724"W | 0.00 | |
| 149.00 | 0.040 | 167.900 | 149.00 | -0.04 | -0.04 | 0.01 | 3335709.28 | 1440794.96 | 40°32'13.582"N | 104°17'31.723"W | 0.03 | |
| 241.00 | 0.040 | 195.200 | 241.00 | -0.10 | -0.10 | 0.01 | 3335709.28 | 1440794.90 | 40°32'13.582"N | 104°17'31.724"W | 0.02 | |
| 334.00 | 0.200 | 181.300 | 334.00 | -0.30 | -0.30 | -0.01 | 3335709.26 | 1440794.70 | 40°32'13.580"N | 104°17'31.724"W | 0.17 | |
| 428.00 | 0.200 | 159.900 | 428.00 | -0.61 | -0.61 | 0.05 | 3335709.32 | 1440794.39 | 40°32'13.577"N | 104°17'31.723"W | 0.08 | |
| 521.00 | 0.100 | 107.300 | 521.00 | -0.78 | -0.79 | 0.18 | 3335709.45 | 1440794.21 | 40°32'13.575"N | 104°17'31.721"W | 0.17 | |
| 584.00 | 0.030 | 18.200 | 584.00 | -0.78 | -0.79 | 0.24 | 3335709.51 | 1440794.21 | 40°32'13.575"N | 104°17'31.721"W | 0.17 | |
| 799.00 | 0.300 | 132.400 | 799.00 | -1.09 | -1.12 | 0.67 | 3335709.94 | 1440793.88 | 40°32'13.572"N | 104°17'31.715"W | 0.15 | |
| 891.00 | 0.100 | 110.000 | 891.00 | -1.27 | -1.31 | 0.92 | 3335710.19 | 1440793.69 | 40°32'13.570"N | 104°17'31.712"W | 0.23 | |
| 983.00 | 0.100 | 29.100 | 983.00 | -1.23 | -1.26 | 1.04 | 3335710.31 | 1440793.74 | 40°32'13.570"N | 104°17'31.710"W | 0.14 | |
| 1075.00 | 0.100 | 87.100 | 1075.00 | -1.15 | -1.19 | 1.16 | 3335710.43 | 1440793.81 | 40°32'13.571"N | 104°17'31.709"W | 0.11 | |
| 1166.00 | 0.300 | 121.800 | 1166.00 | -1.26 | -1.31 | 1.44 | 3335710.71 | 1440793.69 | 40°32'13.570"N | 104°17'31.705"W | 0.25 | |
| 1259.00 | 0.300 | 85.100 | 1259.00 | -1.35 | -1.42 | 1.89 | 3335711.16 | 1440793.58 | 40°32'13.568"N | 104°17'31.699"W | 0.20 | |
| 1350.00 | 0.100 | 167.800 | 1349.99 | -1.40 | -1.48 | 2.14 | 3335711.41 | 1440793.52 | 40°32'13.568"N | 104°17'31.696"W | 0.33 | |
| 1443.00 | 0.100 | 163.200 | 1442.99 | -1.55 | -1.63 | 2.18 | 3335711.45 | 1440793.37 | 40°32'13.566"N | 104°17'31.696"W | 0.01 | |
| 1534.00 | 1.200 | 72.300 | 1533.99 | -1.31 | -1.42 | 3.12 | 3335712.39 | 1440793.58 | 40°32'13.568"N | 104°17'31.683"W | 1.32 | |
| 1626.00 | 1.400 | 51.900 | 1625.96 | -0.26 | -0.43 | 4.92 | 3335714.19 | 1440794.57 | 40°32'13.578"N | 104°17'31.660"W | 0.54 | |
| 1718.00 | 0.900 | 48.100 | 1717.95 | 0.97 | 0.74 | 6.34 | 3335715.61 | 1440795.74 | 40°32'13.589"N | 104°17'31.641"W | 0.55 | |
| 1811.00 | 0.800 | 34.500 | 1810.94 | 2.02 | 1.76 | 7.25 | 3335716.52 | 1440796.76 | 40°32'13.599"N | 104°17'31.629"W | 0.24 | |
| 1907.00 | 1.100 | 66.900 | 1906.92 | 2.98 | 2.68 | 8.48 | 3335717.75 | 1440797.68 | 40°32'13.608"N | 104°17'31.613"W | 0.63 | |
| 2003.00 | 1.200 | 43.800 | 2002.90 | 4.12 | 3.77 | 10.02 | 3335719.29 | 1440798.77 | 40°32'13.619"N | 104°17'31.593"W | 0.49 | |
| 2099.00 | 1.100 | 44.500 | 2098.88 | 5.55 | 5.15 | 11.36 | 3335720.63 | 1440800.15 | 40°32'13.632"N | 104°17'31.576"W | 0.11 | |
| 2195.00 | 1.300 | 27.600 | 2194.86 | 7.21 | 6.77 | 12.51 | 3335721.78 | 1440801.77 | 40°32'13.648"N | 104°17'31.560"W | 0.42 | |
| 2291.00 | 1.400 | 14.800 | 2290.84 | 9.34 | 8.87 | 13.32 | 3335722.59 | 1440803.87 | 40°32'13.669"N | 104°17'31.550"W | 0.33 | |
| 2388.00 | 1.100 | 15.300 | 2387.81 | 11.40 | 10.91 | 13.87 | 3335723.14 | 1440805.91 | 40°32'13.689"N | 104°17'31.542"W | 0.31 | |
| 2484.00 | 1.400 | 1.600 | 2483.79 | 13.47 | 12.97 | 14.14 | 3335723.41 | 1440807.97 | 40°32'13.709"N | 104°17'31.538"W | 0.44 | |
| 2580.00 | 1.200 | 6.500 | 2579.77 | 15.65 | 15.15 | 14.29 | 3335723.56 | 1440810.15 | 40°32'13.730"N | 104°17'31.536"W | 0.24 | |
| 2677.00 | 1.000 | 25.000 | 2676.75 | 17.44 | 16.92 | 14.76 | 3335724.03 | 1440811.92 | 40°32'13.748"N | 104°17'31.529"W | 0.42 | |
| 2772.00 | 0.900 | 15.600 | 2771.74 | 18.93 | 18.39 | 15.31 | 3335724.58 | 1440813.39 | 40°32'13.762"N | 104°17'31.522"W | 0.19 | |
| 2867.00 | 0.900 | 19.700 | 2866.72 | 20.36 | 19.81 | 15.76 | 3335725.03 | 1440814.81 | 40°32'13.776"N | 104°17'31.516"W | 0.07 | |
| 2963.00 | 0.900 | 18.600 | 2962.71 | 21.81 | 21.24 | 16.26 | 3335725.53 | 1440816.24 | 40°32'13.790"N | 104°17'31.509"W | 0.02 | |
| 3060.00 | 0.700 | 27.000 | 3059.70 | 23.07 | 22.49 | 16.77 | 3335726.04 | 1440817.49 | 40°32'13.803"N | 104°17'31.502"W | 0.24 | |
| 3156.00 | 0.800 | 31.600 | 3155.70 | 24.19 | 23.58 | 17.39 | 3335726.66 | 1440818.58 | 40°32'13.813"N | 104°17'31.494"W | 0.12 | |
| 3252.00 | 0.900 | 12.900 | 3251.68 | 25.51 | 24.89 | 17.91 | 3335727.18 | 1440819.89 | 40°32'13.826"N | 104°17'31.487"W | 0.31 | |
| 3348.00 | 1.000 | 6.700 | 3347.67 | 27.09 | 26.45 | 18.17 | 3335727.44 | 1440821.45 | 40°32'13.842"N | 104°17'31.484"W | 0.15 | |
| 3444.00 | 1.200 | 9.100 | 3443.65 | 28.92 | 28.28 | 18.43 | 3335727.70 | 1440823.28 | 40°32'13.860"N | 104°17'31.480"W | 0.21 | |
| 3540.00 | 1.100 | 359.500 | 3539.63 | 30.84 | 30.19 | 18.58 | 3335727.85 | 1440825.19 | 40°32'13.879"N | 104°17'31.478"W | 0.23 | |
| 3637.00 | 1.200 | 3.800 | 3636.62 | 32.78 | 32.14 | 18.64 | 3335727.91 | 1440827.14 | 40°32'13.898"N | 104°17'31.477"W | 0.14 | |
| 3733.00 | 1.200 | 6.100 | 3732.59 | 34.79 | 34.14 | 18.81 | 3335728.08 | 1440829.14 | 40°32'13.917"N | 104°17'31.474"W | 0.05 | |
| 3829.00 | 1.200 | 5.300 | 3828.57 | 36.80 | 36.14 | 19.01 | 3335728.28 | 1440831.14 | 40°32'13.937"N | 104°17'31.471"W | 0.02 | |
| 3925.00 | 0.900 | 351.400 | 3924.56 | 38.54 | 37.89 | 18.99 | 3335728.26 | 1440832.88 | 40°32'13.954"N | 104°17'31.471"W | 0.41 | |
| 4022.00 | 1.000 | 354.300 | 4021.54 | 40.13 | 39.48 | 18.80 | 3335728.07 | 1440834.48 | 40°32'13.970"N | 104°17'31.473"W | 0.11 | |
| 4118.00 | 0.800 | 350.000 | 4117.53 | 41.61 | 40.98 | 18.60 | 3335727.87 | 1440835.97 | 40°32'13.985"N | 104°17'31.476"W | 0.22 | |
| 4214.00 | 0.800 | 344.000 | 4213.52 | 42.91 | 42.28 | 18.30 | 3335727.56 | 1440837.28 | 40°32'13.998"N | 104°17'31.479"W | 0.09 | |



Actual Wellpath Report

CROW VALLEY 7-62-26-2H awp

Page 3 of 6



REFERENCE WELLPATH IDENTIFICATION

| | | | |
|----------|----------------------------------|----------|--|
| Operator | MARATHON OIL COMPANY | Slot | SLOT#02 CROW VALLEY 7-62-26-2H (342°FNL & 1819°FWL,SEC.35) |
| Area | COLORADO | Well | CROW VALLEY 7-62-26-2H |
| Field | WELD COUNTY (NAD 83, GRID NORTH) | Wellbore | CROW VALLEY 7-62-26-2H awb |
| Facility | SEC.35-T7N-R62W | | |

WELLPATH DATA (141 stations)

| MD [ft] | Inclination [°] | Azimuth [°] | TVD [ft] | Vert Sect [ft] | North [ft] | East [ft] | Grid East [US ft] | Grid North [US ft] | Latitude | Longitude | DLS [°/100ft] | Comments |
|------------|--------------------|----------------|-------------|-------------------|---------------|--------------|----------------------|-----------------------|----------------|-----------------|------------------|----------|
| 4310.00 | 0.800 | 321.500 | 4309.51 | 44.05 | 43.45 | 17.69 | 3335726.96 | 1440838.45 | 40°32'14.010"N | 104°17'31.487"W | 0.33 | |
| 4407.00 | 0.700 | 329.900 | 4406.50 | 45.07 | 44.49 | 16.97 | 3335726.24 | 1440839.49 | 40°32'14.020"N | 104°17'31.496"W | 0.15 | |
| 4502.00 | 1.200 | 311.300 | 4501.49 | 46.19 | 45.65 | 15.94 | 3335725.21 | 1440840.65 | 40°32'14.032"N | 104°17'31.509"W | 0.61 | |
| 4597.00 | 0.900 | 293.300 | 4596.48 | 47.09 | 46.60 | 14.50 | 3335723.77 | 1440841.60 | 40°32'14.041"N | 104°17'31.528"W | 0.47 | |
| 4692.00 | 1.100 | 293.900 | 4691.46 | 47.70 | 47.27 | 12.98 | 3335722.25 | 1440842.26 | 40°32'14.048"N | 104°17'31.547"W | 0.21 | |
| 4789.00 | 1.200 | 298.900 | 4788.44 | 48.50 | 48.13 | 11.24 | 3335720.51 | 1440843.13 | 40°32'14.057"N | 104°17'31.569"W | 0.15 | |
| 4884.00 | 1.100 | 285.900 | 4883.42 | 49.17 | 48.86 | 9.50 | 3335718.77 | 1440843.86 | 40°32'14.064"N | 104°17'31.592"W | 0.29 | |
| 4980.00 | 0.900 | 276.100 | 4979.41 | 49.45 | 49.20 | 7.86 | 3335717.13 | 1440844.20 | 40°32'14.068"N | 104°17'31.613"W | 0.27 | |
| 5076.00 | 1.100 | 281.900 | 5075.39 | 49.66 | 49.47 | 6.21 | 3335715.48 | 1440844.47 | 40°32'14.071"N | 104°17'31.634"W | 0.23 | |
| 5172.00 | 0.800 | 283.500 | 5171.38 | 49.95 | 49.81 | 4.66 | 3335713.93 | 1440844.81 | 40°32'14.074"N | 104°17'31.654"W | 0.31 | |
| 5267.00 | 1.000 | 324.200 | 5266.37 | 50.73 | 50.64 | 3.53 | 3335712.80 | 1440845.64 | 40°32'14.083"N | 104°17'31.669"W | 0.69 | |
| 5362.00 | 1.100 | 339.100 | 5361.35 | 52.23 | 52.16 | 2.72 | 3335711.99 | 1440847.16 | 40°32'14.098"N | 104°17'31.679"W | 0.31 | |
| 5458.00 | 0.900 | 347.600 | 5457.34 | 53.81 | 53.76 | 2.23 | 3335711.50 | 1440848.76 | 40°32'14.114"N | 104°17'31.685"W | 0.26 | |
| 5553.00 | 0.700 | 352.400 | 5552.33 | 55.10 | 55.07 | 1.99 | 3335711.26 | 1440850.06 | 40°32'14.127"N | 104°17'31.688"W | 0.22 | |
| 5650.00 | 0.500 | 355.100 | 5649.32 | 56.11 | 56.07 | 1.87 | 3335711.14 | 1440851.07 | 40°32'14.137"N | 104°17'31.689"W | 0.21 | |
| 5746.00 | 0.500 | 18.100 | 5745.32 | 56.92 | 56.89 | 1.97 | 3335711.24 | 1440851.89 | 40°32'14.145"N | 104°17'31.688"W | 0.21 | |
| 5832.00 | 0.200 | 35.300 | 5831.32 | 57.41 | 57.37 | 2.17 | 3335711.44 | 1440852.37 | 40°32'14.149"N | 104°17'31.685"W | 0.37 | |
| 5935.00 | 3.300 | 359.800 | 5934.26 | 60.52 | 60.48 | 2.27 | 3335711.54 | 1440855.48 | 40°32'14.180"N | 104°17'31.684"W | 3.05 | |
| 5969.00 | 7.800 | 357.700 | 5968.09 | 63.80 | 63.77 | 2.17 | 3335711.44 | 1440858.77 | 40°32'14.212"N | 104°17'31.684"W | 13.25 | |
| 5999.00 | 11.300 | 356.900 | 5997.67 | 68.76 | 68.74 | 1.93 | 3335711.20 | 1440863.74 | 40°32'14.262"N | 104°17'31.686"W | 11.67 | |
| 6031.00 | 14.300 | 359.100 | 6028.87 | 75.83 | 75.82 | 1.70 | 3335710.97 | 1440870.82 | 40°32'14.332"N | 104°17'31.688"W | 9.50 | |
| 6063.00 | 15.300 | 359.300 | 6059.81 | 84.00 | 83.99 | 1.58 | 3335710.85 | 1440878.99 | 40°32'14.412"N | 104°17'31.688"W | 3.13 | |
| 6096.00 | 18.000 | 358.600 | 6091.42 | 93.44 | 93.45 | 1.41 | 3335710.68 | 1440888.44 | 40°32'14.506"N | 104°17'31.689"W | 8.20 | |
| 6127.00 | 20.200 | 1.800 | 6120.72 | 103.57 | 103.59 | 1.46 | 3335710.73 | 1440898.58 | 40°32'14.606"N | 104°17'31.686"W | 7.86 | |
| 6158.00 | 22.100 | 3.200 | 6149.63 | 114.76 | 114.76 | 1.95 | 3335711.22 | 1440909.76 | 40°32'14.716"N | 104°17'31.678"W | 6.34 | |
| 6190.00 | 24.700 | 4.000 | 6178.99 | 127.46 | 127.44 | 2.75 | 3335712.02 | 1440922.44 | 40°32'14.842"N | 104°17'31.665"W | 8.19 | |
| 6222.00 | 26.100 | 3.800 | 6207.90 | 141.18 | 141.14 | 3.69 | 3335712.96 | 1440936.13 | 40°32'14.977"N | 104°17'31.651"W | 4.38 | |
| 6254.00 | 29.500 | 4.400 | 6236.20 | 156.09 | 156.02 | 4.76 | 3335714.03 | 1440951.01 | 40°32'15.124"N | 104°17'31.634"W | 10.66 | |
| 6285.00 | 32.800 | 4.400 | 6262.73 | 172.11 | 172.01 | 5.99 | 3335715.26 | 1440967.00 | 40°32'15.281"N | 104°17'31.616"W | 10.65 | |
| 6317.00 | 36.300 | 3.500 | 6289.08 | 190.24 | 190.11 | 7.23 | 3335716.50 | 1440985.10 | 40°32'15.460"N | 104°17'31.596"W | 11.05 | |
| 6349.00 | 40.200 | 2.400 | 6314.21 | 210.05 | 209.89 | 8.24 | 3335717.51 | 1441004.88 | 40°32'15.655"N | 104°17'31.580"W | 12.37 | |
| 6381.00 | 43.000 | 1.600 | 6338.13 | 231.29 | 231.12 | 8.98 | 3335718.25 | 1441026.11 | 40°32'15.865"N | 104°17'31.567"W | 8.91 | |
| 6413.00 | 45.500 | 1.700 | 6361.05 | 253.62 | 253.44 | 9.62 | 3335718.89 | 1441048.43 | 40°32'16.085"N | 104°17'31.554"W | 7.82 | |
| 6445.00 | 48.700 | 1.100 | 6382.83 | 277.06 | 276.87 | 10.19 | 3335719.46 | 1441071.86 | 40°32'16.317"N | 104°17'31.543"W | 10.09 | |
| 6477.00 | 51.400 | 359.800 | 6403.38 | 301.57 | 301.40 | 10.38 | 3335719.65 | 1441096.39 | 40°32'16.559"N | 104°17'31.536"W | 8.99 | |
| 6509.00 | 52.900 | 1.100 | 6423.01 | 326.83 | 326.66 | 10.58 | 3335719.85 | 1441121.65 | 40°32'16.809"N | 104°17'31.529"W | 5.68 | |
| 6542.00 | 55.200 | 0.500 | 6442.39 | 353.54 | 353.37 | 10.95 | 3335720.22 | 1441148.36 | 40°32'17.073"N | 104°17'31.519"W | 7.12 | |
| 6574.00 | 58.800 | 359.600 | 6459.81 | 380.35 | 380.20 | 10.97 | 3335720.24 | 1441175.19 | 40°32'17.338"N | 104°17'31.514"W | 11.49 | |
| 6605.00 | 63.300 | 359.700 | 6474.81 | 407.45 | 407.32 | 10.81 | 3335720.07 | 1441202.31 | 40°32'17.606"N | 104°17'31.512"W | 14.52 | |
| 6638.00 | 68.900 | 359.600 | 6488.18 | 437.58 | 437.48 | 10.62 | 3335719.89 | 1441232.47 | 40°32'17.904"N | 104°17'31.509"W | 16.97 | |
| 6669.00 | 73.700 | 0.800 | 6498.12 | 466.92 | 466.83 | 10.73 | 3335720.00 | 1441261.82 | 40°32'18.194"N | 104°17'31.502"W | 15.91 | |
| 6701.00 | 77.400 | 0.800 | 6506.10 | 497.89 | 497.81 | 11.16 | 3335720.43 | 1441292.80 | 40°32'18.500"N | 104°17'31.491"W | 11.56 | |
| 6733.00 | 81.700 | 2.000 | 6511.90 | 529.35 | 529.26 | 11.93 | 3335721.20 | 1441324.25 | 40°32'18.811"N | 104°17'31.476"W | 13.93 | |
| 6765.00 | 86.700 | 2.800 | 6515.13 | 561.18 | 561.06 | 13.26 | 3335722.53 | 1441356.04 | 40°32'19.125"N | 104°17'31.453"W | 15.82 | |
| 6797.00 | 89.500 | 2.600 | 6516.20 | 593.16 | 593.01 | 14.77 | 3335724.04 | 1441387.99 | 40°32'19.440"N | 104°17'31.428"W | 8.77 | |



Actual Wellpath Report

CROW VALLEY 7-62-26-2H awp

Page 4 of 6



| REFERENCE WELLPATH IDENTIFICATION | | | |
|-----------------------------------|----------------------------------|----------|--|
| Operator | MARATHON OIL COMPANY | Slot | SLOT#02 CROW VALLEY 7-62-26-2H (342°FNL & 1819°FWL,SEC.35) |
| Area | COLORADO | Well | CROW VALLEY 7-62-26-2H |
| Field | WELD COUNTY (NAD 83, GRID NORTH) | Wellbore | CROW VALLEY 7-62-26-2H awb |
| Facility | SEC.35-T7N-R62W | | |

| WELLPATH DATA (141 stations) | | | | | | | | | | | | |
|------------------------------|-----------------|-------------|----------|----------------|------------|-----------|-------------------|--------------------|----------------|-----------------|---------------|----------|
| MD [ft] | Inclination [°] | Azimuth [°] | TVD [ft] | Vert Sect [ft] | North [ft] | East [ft] | Grid East [US ft] | Grid North [US ft] | Latitude | Longitude | DLS [°/100ft] | Comments |
| 6829.00 | 90.700 | 3.400 | 6516.14 | 625.15 | 624.96 | 16.45 | 3335725.71 | 1441419.94 | 40°32'19.755"N | 104°17'31.400"W | 4.51 | |
| 6861.00 | 91.200 | 3.400 | 6515.61 | 657.14 | 656.90 | 18.34 | 3335727.61 | 1441451.88 | 40°32'20.071"N | 104°17'31.370"W | 1.56 | |
| 6893.00 | 91.300 | 2.900 | 6514.91 | 689.12 | 688.84 | 20.10 | 3335729.37 | 1441483.82 | 40°32'20.386"N | 104°17'31.342"W | 1.59 | |
| 6924.00 | 91.700 | 2.900 | 6514.10 | 720.11 | 719.79 | 21.67 | 3335730.94 | 1441514.77 | 40°32'20.692"N | 104°17'31.316"W | 1.29 | |
| 6953.00 | 91.900 | 2.500 | 6513.19 | 749.09 | 748.75 | 23.03 | 3335732.30 | 1441543.72 | 40°32'20.978"N | 104°17'31.293"W | 1.54 | |
| 7086.00 | 91.300 | 1.900 | 6509.48 | 882.04 | 881.60 | 28.14 | 3335737.41 | 1441676.57 | 40°32'22.290"N | 104°17'31.204"W | 0.64 | |
| 7181.00 | 90.800 | 2.100 | 6507.73 | 977.02 | 976.52 | 31.45 | 3335740.72 | 1441771.49 | 40°32'23.227"N | 104°17'31.144"W | 0.57 | |
| 7277.00 | 92.000 | 1.700 | 6505.39 | 1072.99 | 1072.44 | 34.63 | 3335743.90 | 1441867.40 | 40°32'24.174"N | 104°17'31.086"W | 1.32 | |
| 7373.00 | 91.700 | 1.200 | 6502.29 | 1168.94 | 1168.36 | 37.06 | 3335746.33 | 1441963.32 | 40°32'25.122"N | 104°17'31.037"W | 0.61 | |
| 7468.00 | 91.400 | 0.400 | 6499.72 | 1263.88 | 1263.31 | 38.39 | 3335747.66 | 1442058.27 | 40°32'26.060"N | 104°17'31.004"W | 0.90 | |
| 7564.00 | 90.900 | 2.600 | 6497.79 | 1359.85 | 1359.25 | 40.90 | 3335750.17 | 1442154.21 | 40°32'27.007"N | 104°17'30.954"W | 2.35 | |
| 7659.00 | 90.600 | 1.900 | 6496.55 | 1454.84 | 1454.17 | 44.63 | 3335753.90 | 1442249.13 | 40°32'27.945"N | 104°17'30.889"W | 0.80 | |
| 7756.00 | 89.700 | 2.400 | 6496.30 | 1551.84 | 1551.10 | 48.27 | 3335757.54 | 1442346.05 | 40°32'28.902"N | 104°17'30.825"W | 1.06 | |
| 7852.00 | 89.400 | 2.500 | 6497.05 | 1647.83 | 1647.01 | 52.37 | 3335761.64 | 1442441.96 | 40°32'29.849"N | 104°17'30.755"W | 0.33 | |
| 7949.00 | 88.800 | 3.000 | 6498.57 | 1744.81 | 1743.89 | 57.03 | 3335766.29 | 1442538.83 | 40°32'30.805"N | 104°17'30.677"W | 0.81 | |
| 8045.00 | 88.000 | 2.200 | 6501.25 | 1840.77 | 1839.75 | 61.38 | 3335770.65 | 1442634.69 | 40°32'31.752"N | 104°17'30.604"W | 1.18 | |
| 8141.00 | 88.800 | 2.400 | 6503.93 | 1936.73 | 1935.63 | 65.23 | 3335774.50 | 1442730.57 | 40°32'32.699"N | 104°17'30.537"W | 0.86 | |
| 8236.00 | 91.000 | 2.400 | 6504.10 | 2031.72 | 2030.54 | 69.21 | 3335778.48 | 1442825.48 | 40°32'33.636"N | 104°17'30.469"W | 2.32 | |
| 8332.00 | 91.600 | 2.400 | 6501.92 | 2127.69 | 2126.44 | 73.23 | 3335782.49 | 1442921.37 | 40°32'34.583"N | 104°17'30.400"W | 0.62 | |
| 8428.00 | 91.300 | 1.900 | 6499.49 | 2223.66 | 2222.34 | 76.83 | 3335786.10 | 1443017.26 | 40°32'35.530"N | 104°17'30.336"W | 0.61 | |
| 8526.00 | 92.300 | 3.200 | 6496.41 | 2321.61 | 2320.19 | 81.19 | 3335790.45 | 1443115.11 | 40°32'36.496"N | 104°17'30.263"W | 1.67 | |
| 8622.00 | 92.500 | 2.800 | 6492.39 | 2417.51 | 2415.97 | 86.20 | 3335795.47 | 1443210.89 | 40°32'37.442"N | 104°17'30.181"W | 0.47 | |
| 8718.00 | 92.700 | 2.600 | 6488.04 | 2513.40 | 2511.77 | 90.72 | 3335799.99 | 1443306.68 | 40°32'38.388"N | 104°17'30.105"W | 0.29 | |
| 8815.00 | 91.200 | 2.900 | 6484.74 | 2610.34 | 2608.60 | 95.37 | 3335804.64 | 1443403.51 | 40°32'39.344"N | 104°17'30.028"W | 1.58 | |
| 8910.00 | 89.400 | 2.200 | 6484.24 | 2705.33 | 2703.50 | 99.60 | 3335808.87 | 1443498.41 | 40°32'40.281"N | 104°17'29.957"W | 2.03 | |
| 9006.00 | 88.000 | 2.500 | 6486.42 | 2801.30 | 2799.39 | 103.54 | 3335812.80 | 1443594.30 | 40°32'41.228"N | 104°17'29.889"W | 1.49 | |
| 9102.00 | 89.700 | 2.800 | 6488.35 | 2897.27 | 2895.26 | 107.97 | 3335817.24 | 1443690.17 | 40°32'42.175"N | 104°17'29.814"W | 1.80 | |
| 9199.00 | 89.500 | 2.700 | 6489.02 | 2994.26 | 2992.15 | 112.63 | 3335821.89 | 1443787.05 | 40°32'43.131"N | 104°17'29.737"W | 0.23 | |
| 9294.00 | 89.600 | 2.300 | 6489.77 | 3089.26 | 3087.06 | 116.77 | 3335826.04 | 1443881.95 | 40°32'44.069"N | 104°17'29.667"W | 0.43 | |
| 9391.00 | 89.700 | 1.800 | 6490.36 | 3186.25 | 3183.99 | 120.24 | 3335829.51 | 1443978.89 | 40°32'45.026"N | 104°17'29.604"W | 0.53 | |
| 9488.00 | 89.100 | 1.200 | 6491.38 | 3283.24 | 3280.95 | 122.78 | 3335832.04 | 1444075.84 | 40°32'45.984"N | 104°17'29.554"W | 0.87 | |
| 9585.00 | 88.800 | 0.600 | 6493.16 | 3380.21 | 3377.92 | 124.30 | 3335833.57 | 1444172.81 | 40°32'46.941"N | 104°17'29.518"W | 0.69 | |
| 9680.00 | 90.500 | 1.700 | 6493.74 | 3475.19 | 3472.90 | 126.21 | 3335835.47 | 1444267.78 | 40°32'47.880"N | 104°17'29.476"W | 2.13 | |
| 9774.00 | 89.800 | 0.900 | 6493.49 | 3569.18 | 3566.87 | 128.34 | 3335837.61 | 1444361.75 | 40°32'48.808"N | 104°17'29.432"W | 1.13 | |
| 9870.00 | 92.000 | 2.000 | 6491.98 | 3665.15 | 3662.82 | 130.77 | 3335840.04 | 1444457.70 | 40°32'49.756"N | 104°17'29.384"W | 2.56 | |
| 9965.00 | 91.700 | 0.900 | 6488.91 | 3760.10 | 3757.74 | 133.17 | 3335842.44 | 1444552.62 | 40°32'50.693"N | 104°17'29.336"W | 1.20 | |
| 10061.00 | 91.600 | 1.400 | 6486.15 | 3856.05 | 3853.68 | 135.10 | 3335844.36 | 1444648.55 | 40°32'51.641"N | 104°17'29.294"W | 0.53 | |
| 10157.00 | 91.500 | 2.300 | 6483.55 | 3952.01 | 3949.59 | 138.20 | 3335847.46 | 1444744.46 | 40°32'52.588"N | 104°17'29.237"W | 0.94 | |
| 10253.00 | 91.500 | 2.000 | 6481.04 | 4047.98 | 4045.49 | 141.80 | 3335851.06 | 1444840.36 | 40°32'53.535"N | 104°17'29.173"W | 0.31 | |
| 10349.00 | 90.500 | 1.800 | 6479.36 | 4143.96 | 4141.42 | 144.98 | 3335854.24 | 1444936.29 | 40°32'54.482"N | 104°17'29.115"W | 1.06 | |
| 10444.00 | 89.400 | 0.400 | 6479.45 | 4238.94 | 4236.40 | 146.80 | 3335856.07 | 1445031.26 | 40°32'55.421"N | 104°17'29.075"W | 1.87 | |
| 10539.00 | 89.200 | 0.700 | 6480.61 | 4333.90 | 4331.39 | 147.71 | 3335856.98 | 1445126.25 | 40°32'56.359"N | 104°17'29.046"W | 0.38 | |
| 10636.00 | 89.500 | 1.200 | 6481.71 | 4430.88 | 4428.37 | 149.32 | 3335858.59 | 1445223.23 | 40°32'57.317"N | 104°17'29.008"W | 0.60 | |
| 10732.00 | 89.600 | 2.700 | 6482.46 | 4526.87 | 4524.31 | 152.59 | 3335861.85 | 1445319.16 | 40°32'58.264"N | 104°17'28.949"W | 1.57 | |
| 10828.00 | 89.000 | 2.400 | 6483.64 | 4622.86 | 4620.21 | 156.86 | 3335866.12 | 1445415.06 | 40°32'59.211"N | 104°17'28.877"W | 0.70 | |



| WELLPATH COMPOSITION - Ref Wellbore: CROW VALLEY 7-62-26-2H awb | | | Ref Wellpath: CROW VALLEY 7-62-26-2H awp | |
|---|----------------|------------------------------|--|----------------------------|
| Start MD [ft] | End MD [ft] | Positional Uncertainty Model | Log Name/Comment | Wellbore |
| 31.00 | 6953.00 | NaviTrak (Standard) | BHI/NAVITRAK MWD 8.75" - <149-6953> | CROW VALLEY 7-62-26-2H awb |
| 6953.00 | 11267.00 | NaviTrak (Standard) | BHI/NAVITRAK MWD 6" - <7086-11267> | CROW VALLEY 7-62-26-2H awb |
| 11267.00 | 11321.00 | Blind Drilline (std) | Projection to bit | CROW VALLEY 7-62-26-2H awb |

**Actual Wellpath Report**

CROW VALLEY 7-62-26-2H awp

Page 6 of 6

**REFERENCE WELLPATH IDENTIFICATION**

| | | | |
|----------|----------------------------------|----------|--|
| Operator | MARATHON OIL COMPANY | Slot | SLOT#02 CROW VALLEY 7-62-26-2H (342'FNL & 1819'FWL,SEC.35) |
| Area | COLORADO | Well | CROW VALLEY 7-62-26-2H |
| Field | WELD COUNTY (NAD 83, GRID NORTH) | Wellbore | CROW VALLEY 7-62-26-2H awb |
| Facility | SEC.35-T7N-R62W | | |

WELLPATH COMMENTS

| MD [ft] | Inclination [°] | Azimuth [°] | TVD [ft] | Comment |
|------------|--------------------|----------------|-------------|---------------------|
| 11267.00 | 86.300 | 359.500 | 6500.49 | LAST BHI MWD SURVEY |
| 11321.00 | 86.300 | 359.500 | 6503.97 | PROJECTION TO BIT |