

AXIA ENERGY
ADDENDUM TO LEGAL PLAT FOR
BULLDOG #1-22H-791
SECTION 1, T7N, R19W, 6th P.M.
2207' FNL 2666' FEL

SCALE: 1" = 200'
DATE: 03-12-12
DRAWN BY: Z.L.
REV: 03-12-12 Z.L.

LINE TABLE		
LINE	DIRECTION	LENGTH
L1	S20°W	89'
L2	S20°W	117'
L3	S20°W	131'
L4	S20°W	151'
L5	S20°W	181'
L6	N48°E	50'

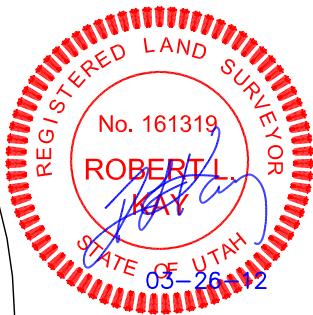

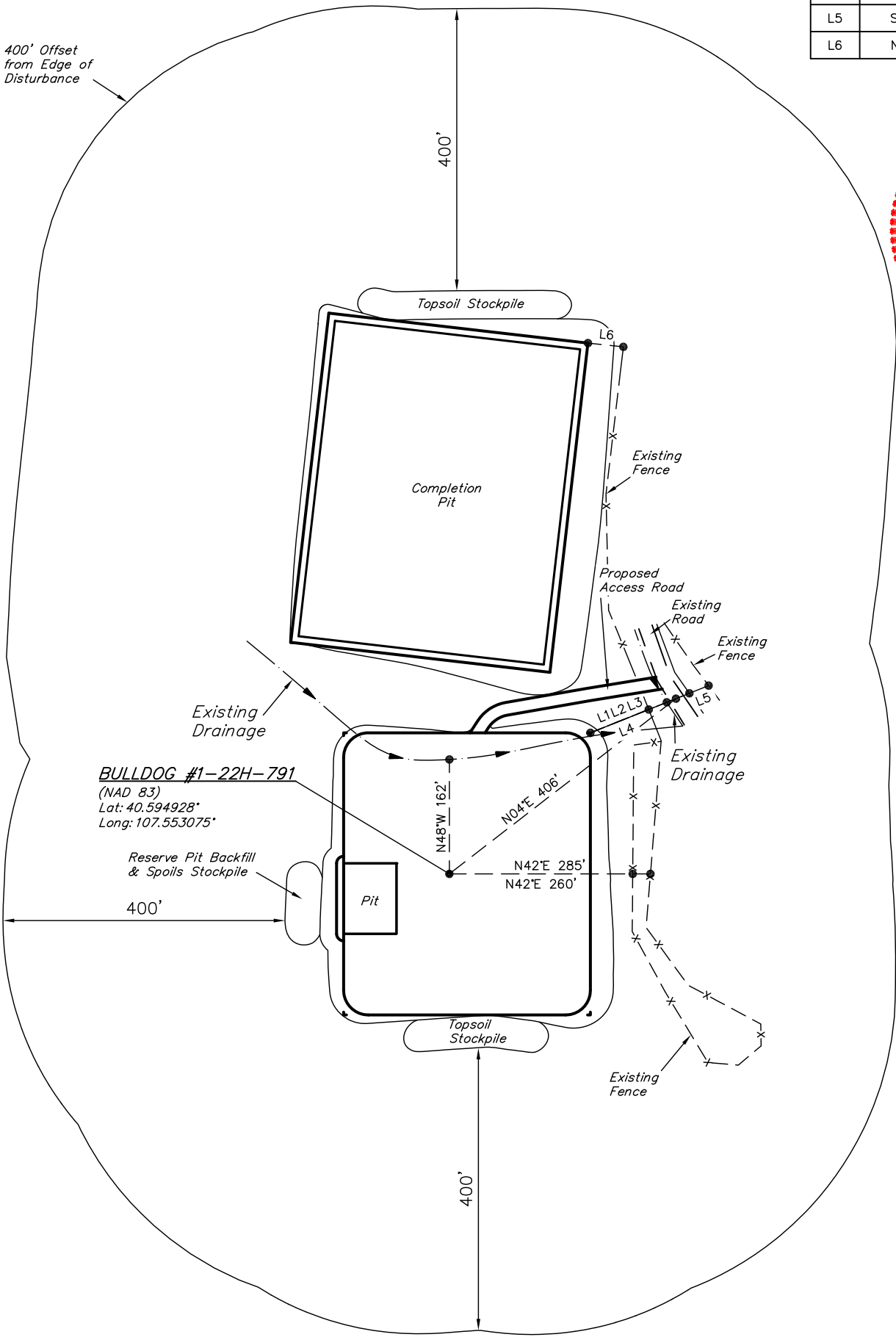
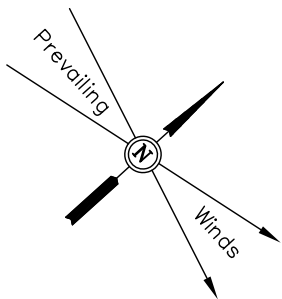

AXIA ENERGY
LOCATION LAYOUT FOR
BULLDOG #1-22H-791
SECTION 1, T7N, R19W, 6th P.M.
2207' FNL 2666' FEL

FIGURE #1

SCALE: 1" = 100'
DATE: 02-14-12
DRAWN BY: Z.L.
REV: 03-12-12 Z.L.

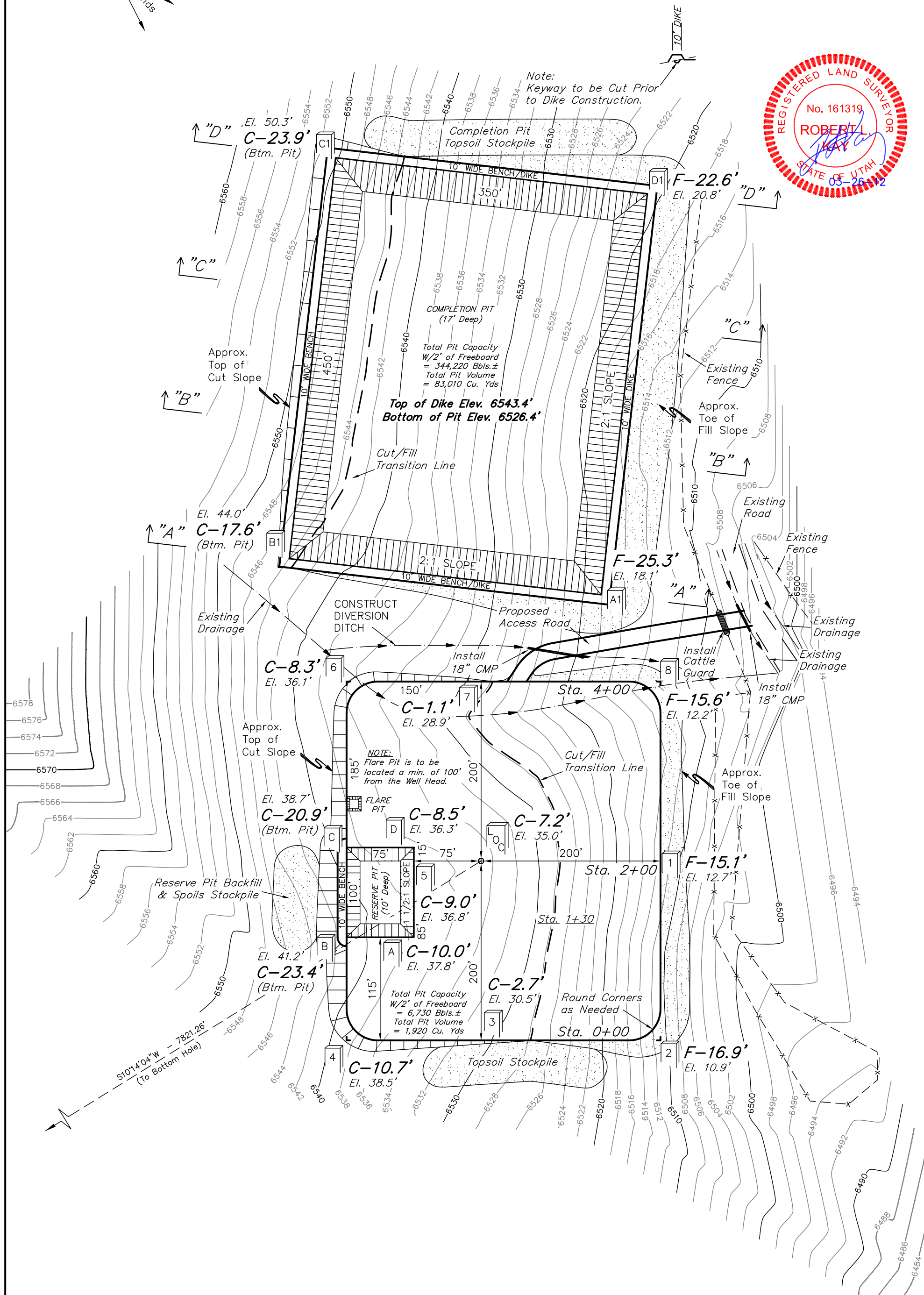
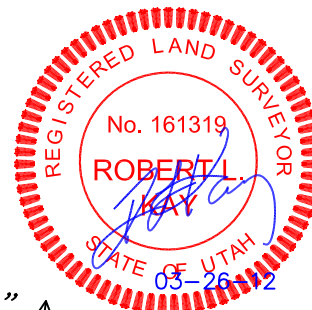

Elev. Ungraded Ground At Loc. Stake = 6535.0'
FINISHED GRADE ELEV. AT LOC. STAKE = 6527.8'

UINTAH ENGINEERING & LAND SURVEYING
85 So. 200 East * Vernal, Utah 84078 * (435) 789-1017

1" = 40'
X-Section
Scale
1" = 100'

DATE: 03-12-12
DRAWN BY: Z.L.
REV: 03-12-12 Z.L.

AXIA ENERGY
TYPICAL CROSS SECTIONS FOR
BULLDOG #1-22H-791
SECTION 1, T7N, R19W, 6th P.M.
2207' FNL 2666' FEL

FIGURE #2

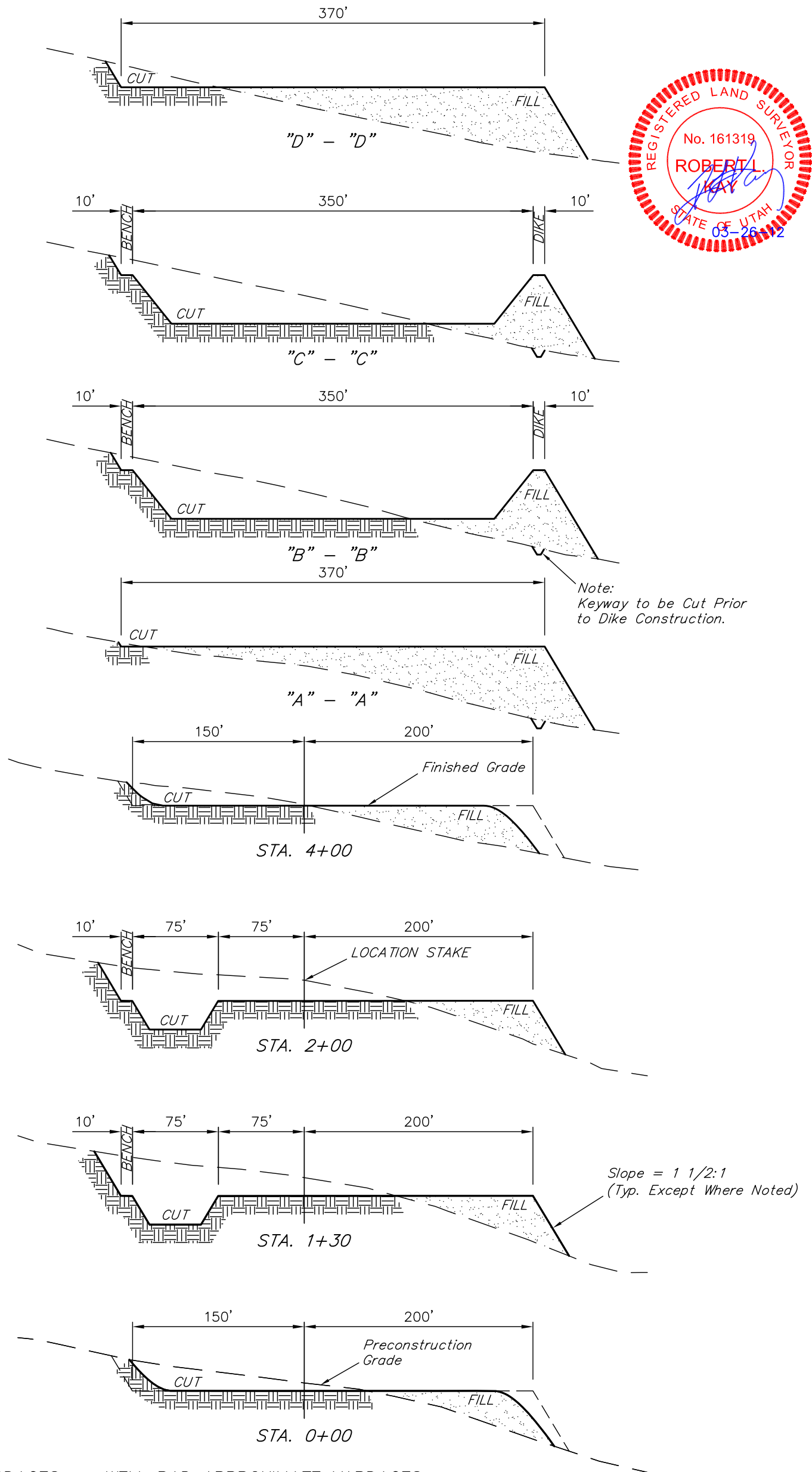

* NOTE:
FILL QUANTITY INCLUDES
5% FOR COMPACTION

NOTE:
Topsoil should not be
Stripped Below Finished
Grade on Substructure Area.

COMPLETION PIT APPROXIMATE YARDAGES

(6") Topsoil Stripping	=	3,960 Cu. Yds.
Remaining Location	=	39,160 Cu. Yds.
TOTAL CUT	=	43,120 CU. YDS.
FILL	=	39,160 CU. YDS.
EXCESS MATERIAL	=	3,960 Cu. Yds.
Topsoil	=	3,960 Cu. Yds.
EXCESS UNBALANCE (After Interim Rehabilitation)	=	0 Cu. Yds.

WELL PAD APPROXIMATE YARDAGES

(6") Topsoil Stripping	=	3,080 Cu. Yds.
Remaining Location	=	22,030 Cu. Yds.
TOTAL CUT	=	25,110 CU. YDS.
FILL	=	21,070 CU. YDS.
EXCESS MATERIAL	=	4,040 Cu. Yds.
Topsoil & Pit Backfill (1/2 Pit Vol.)	=	4,040 Cu. Yds.
EXCESS UNBALANCE (After Interim Rehabilitation)	=	0 Cu. Yds.

APPROXIMATE ACREAGES
WELL SITE DISTURBANCE = ± 9.298 ACRES
ACCESS ROAD DISTURBANCE = ± 1.833 ACRES
TOTAL = ± 11.131 ACRES

UINTAH ENGINEERING & LAND SURVEYING
85 So. 200 East * Vernal, Utah 84078 * (435) 789-1017

FIGURE #3

SCALE: 1" = 100'
DATE: 03-12-12
DRAWN BY: Z.L.
REV: 03-12-12 Z.L.

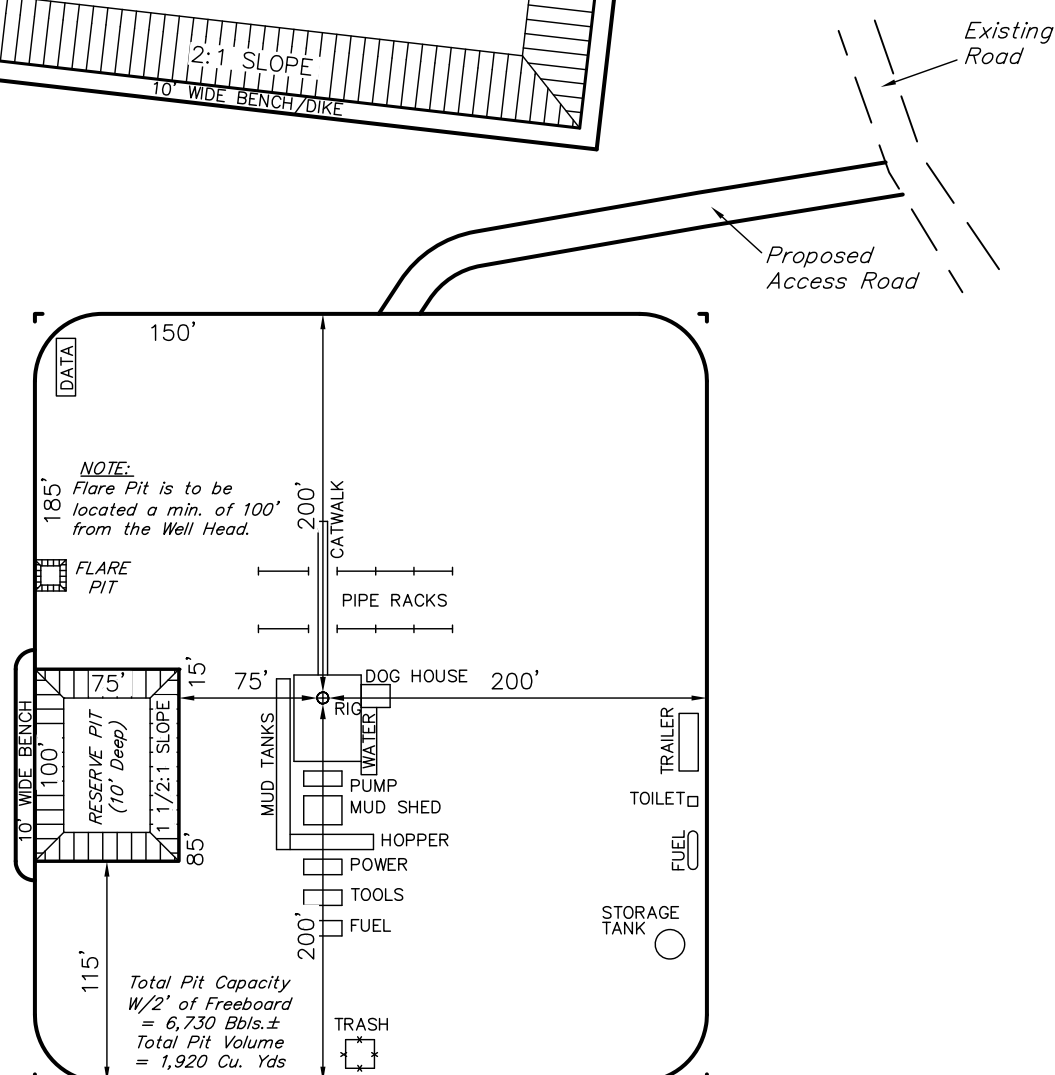
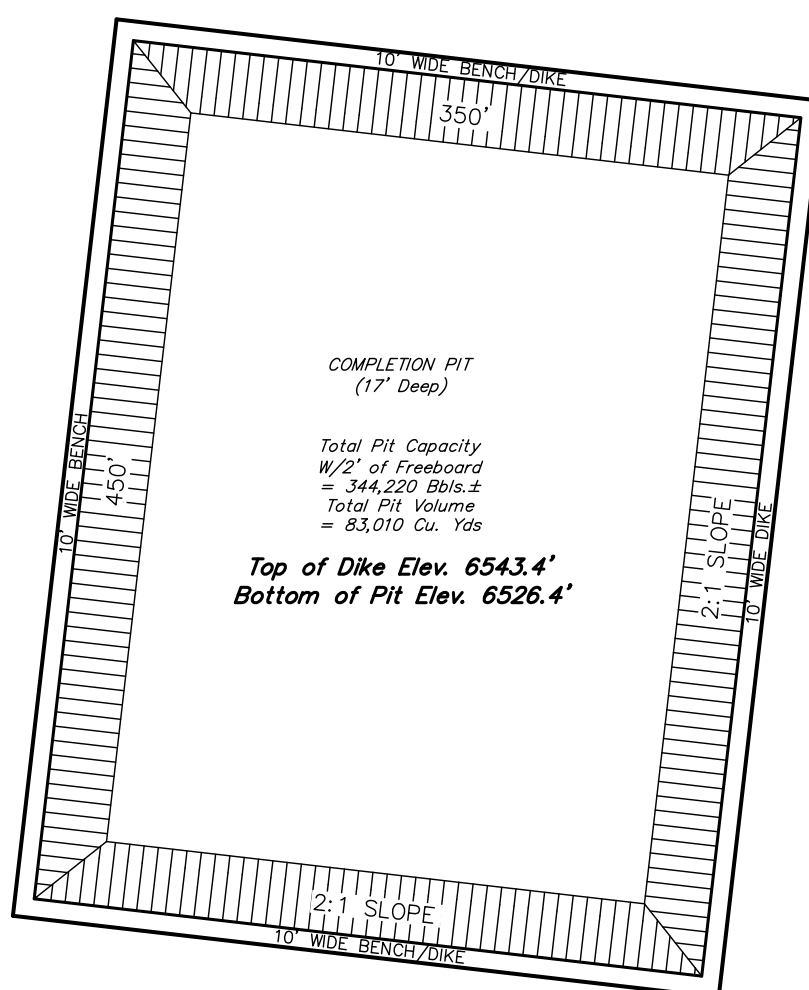
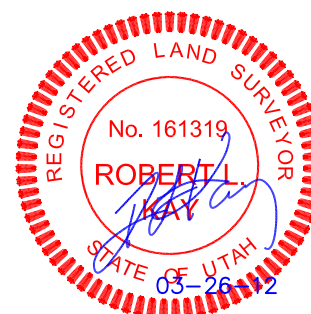



AXIA ENERGY
PRODUCTION FACILITY LAYOUT FOR
BULLDOG #1-22H-791
SECTION 1, T7N, R19W, 6th P.M.
2207' FNL 2666' FEL

FIGURE #4

SCALE: 1" = 100'
DATE: 03-12-12
DRAWN BY: Z.L.
REV: 03-12-12 Z.L.

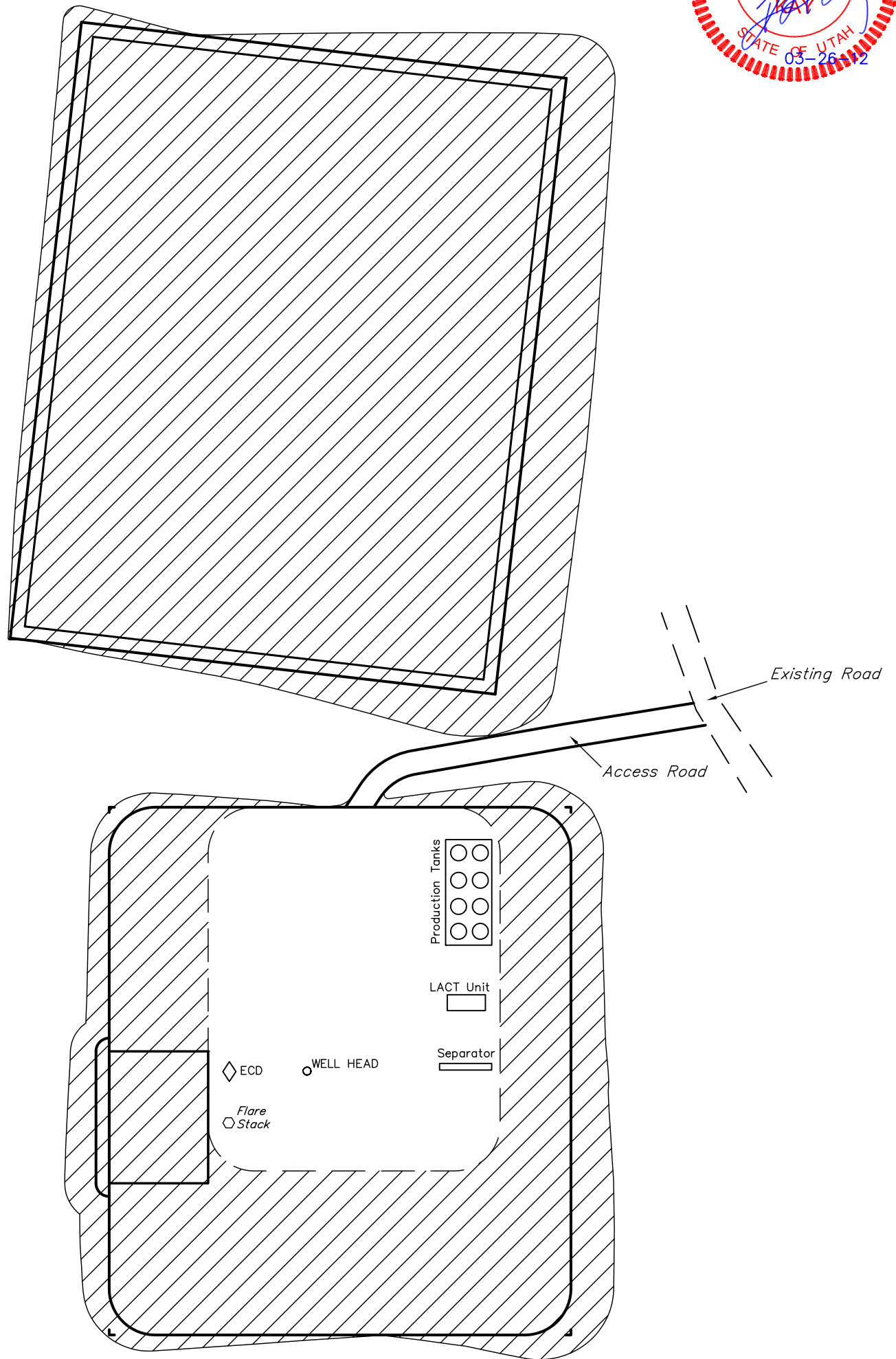
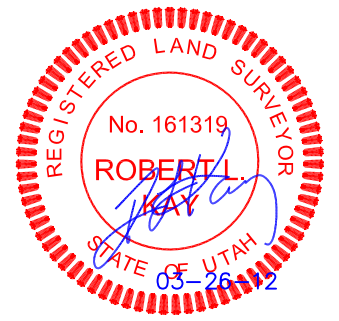

RECLAIMED AREA

APPROXIMATE ACREAGES
UN-RECLAIMED = ± 1.377 ACRES

UINTAH ENGINEERING & LAND SURVEYING
85 So. 200 East * Vernal, Utah 84078 * (435) 789-1017