

ANADARKO E&P COMPANY LP

Location: COLORADO Slot: SLOT#02 COLFER 13C-34HZ (480'FNL & 580'FWL,SEC.34)
Field: WELD COUNTY (KERR MCGEE) Well: COLFER 13C-34HZ
Facility: SEC.34-T2N-R65W Wellbore: COLFER 13C-34HZ PWB

Plot reference wellpath is COLFER 13C-34HZ (REV-B.0) PWP

True vertical depths are referenced to ENSIGN 145 (RKB)

Grid System: NAD83 / Lambert Colorado SP, Northern Zone (501), US feet

Measured depths are referenced to ENSIGN 145 (RKB)

North Reference: True north

ENSGN 145 (RKB) to Mean Sea Level: 4956 feet

Scale: True distance

Mean Sea Level to Mud line (At Slot: SLOT#02 COLFER 13C-34HZ (480'FNL & 580'FWL,SEC.34)): 0 feet

Depths are in feet

Coordinates are in feet referenced to Slot

Created by: wilsjef02 on 1/27/2012

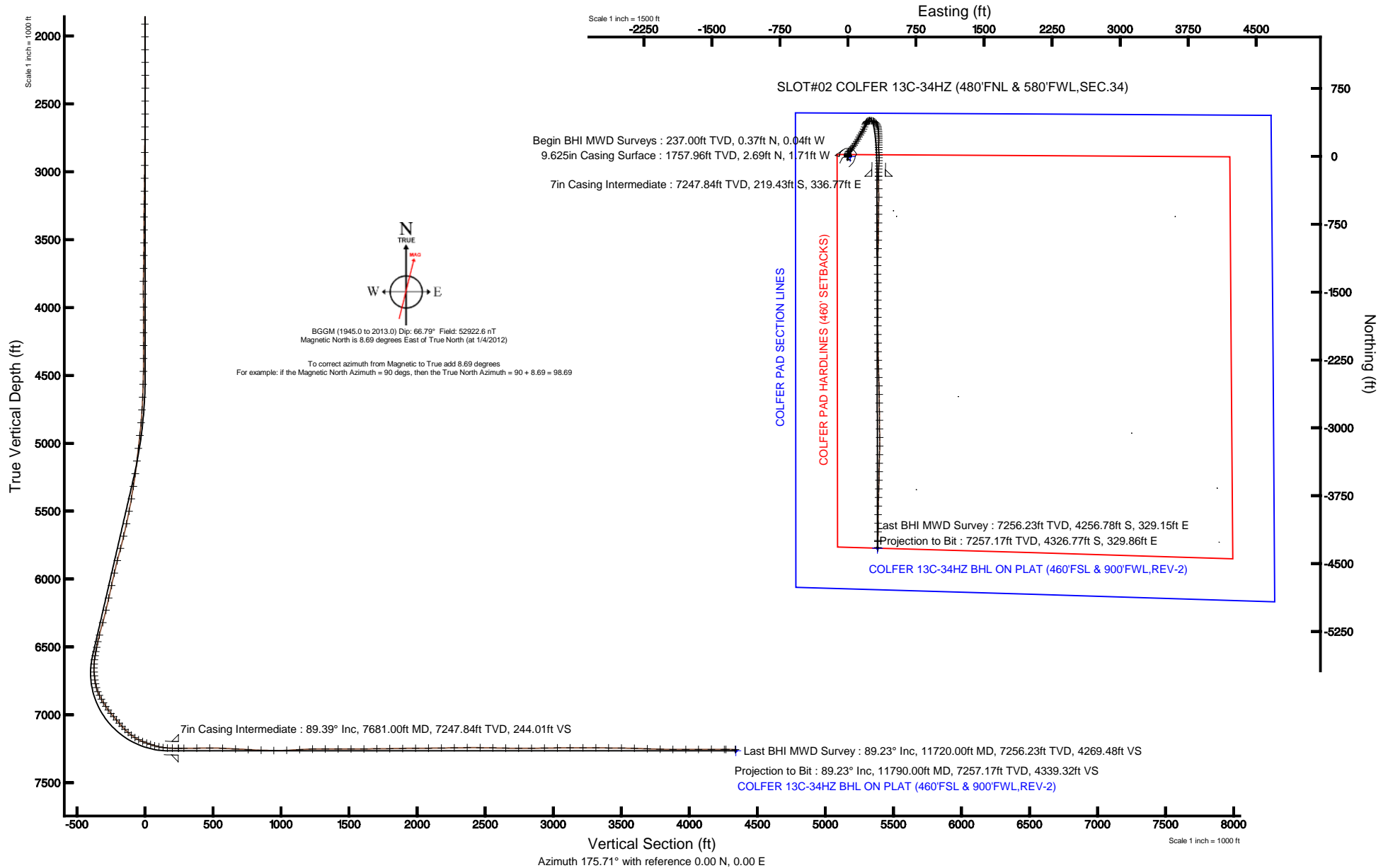



Actual Wellpath Report

COLFER 13C-34HZ AWP

Page 1 of 6



REFERENCE WELLPATH IDENTIFICATION

Operator	ANADARKO E&P COMPANY LP	Slot	SLOT#02 COLFER 13C-34HZ (480'FNL & 580'FWL,SEC.34)
Area	COLORADO	Well	COLFER 13C-34HZ
Field	WELD COUNTY (KERR MCGEE)	Wellbore	COLFER 13C-34HZ AWB
Facility	SEC.34-T2N-R65W		

REPORT SETUP INFORMATION

Projection System	NAD83 / Lambert Colorado SP, Northern Zone (501), US feet	Software System	WellArchitect@ 3.0.2
North Reference	True	User	Wilsjef02
Scale	0.99996	Report Generated	1/27/2012 at 11:45:45 AM
Convergence at slot	0.54° East	Database/Source file	WA_ANADARKO/COLFER_13C-34HZ_AWB.xml

WELLPATH LOCATION

	Local coordinates		Grid coordinates		Geographic coordinates	
	North[ft]	East[ft]	Easting[US ft]	Northing[US ft]	Latitude	Longitude
Slot Location	0.10	-24.01	3235765.82	1280758.02	40°06'03.589"N	104°39'25.848"W
Facility Reference Pt			3235789.83	1280758.14	40°06'03.588"N	104°39'25.539"W
Field Reference Pt			3197771.84	1268891.29	40°04'09.600"N	104°47'36.000"W

WELLPATH DATUM

Calculation method	Minimum curvature	ENSIGN 145 (RKB) to Facility Vertical Datum	4956.00ft
Horizontal Reference Pt	Slot	ENSIGN 145 (RKB) to Mean Sea Level	4956.00ft
Vertical Reference Pt	ENSIGN 145 (RKB)	ENSIGN 145 (RKB) to Mud Line at Slot (SLOT#02 COLFER 13C-34HZ (480'FNL & 580'FWL,SEC.34))	4956.00ft
MD Reference Pt	ENSIGN 145 (RKB)	Section Origin	N 0.00, E 0.00 ft
Field Vertical Reference	Mean Sea Level	Section Azimuth	175.71°



Actual Wellpath Report

COLFER 13C-34HZ AWP

Page 2 of 6



REFERENCE WELLPATH IDENTIFICATION

Operator	ANADARKO E&P COMPANY LP	Slot	SLOT#02 COLFER 13C-34HZ (480'FNL & 580'FWL,SEC.34)
Area	COLORADO	Well	COLFER 13C-34HZ
Field	WELD COUNTY (KERR MCGEE)	Wellbore	COLFER 13C-34HZ AWB
Facility	SEC.34-T2N-R65W		

WELLPATH DATA (151 stations) † = interpolated/extrapolated station

MD [ft]	Inclination [°]	Azimuth [°]	TVD [ft]	Vert Sect [ft]	North [ft]	East [ft]	Latitude	Longitude	DLS [°/100ft]	Comments
0.00†	0.000	353.860	0.00	0.00	0.00	0.00	40°06'03.589"N	104°39'25.848"W	0.00	
13.00	0.000	353.860	13.00	0.00	0.00	0.00	40°06'03.589"N	104°39'25.848"W	0.00	
237.00	0.190	353.860	237.00	-0.37	0.37	-0.04	40°06'03.593"N	104°39'25.849"W	0.08	Begin BHI MWD Surveys
329.00	0.410	335.740	329.00	-0.83	0.82	-0.19	40°06'03.597"N	104°39'25.850"W	0.26	
421.00	0.680	6.930	420.99	-1.68	1.66	-0.26	40°06'03.605"N	104°39'25.851"W	0.43	
513.00	0.760	14.020	512.99	-2.79	2.80	-0.05	40°06'03.617"N	104°39'25.849"W	0.13	
605.00	0.420	55.030	604.98	-3.54	3.58	0.38	40°06'03.624"N	104°39'25.843"W	0.57	
697.00	0.640	84.460	696.98	-3.73	3.83	1.16	40°06'03.627"N	104°39'25.833"W	0.37	
789.00	0.470	336.690	788.98	-4.10	4.22	1.53	40°06'03.631"N	104°39'25.828"W	0.98	
881.00	0.500	241.270	880.97	-4.29	4.37	1.03	40°06'03.632"N	104°39'25.835"W	0.78	
973.00	0.260	221.310	972.97	-3.97	4.03	0.54	40°06'03.629"N	104°39'25.841"W	0.29	
1065.00	0.320	294.100	1064.97	-3.95	3.97	0.16	40°06'03.628"N	104°39'25.846"W	0.38	
1157.00	0.330	309.370	1156.97	-4.25	4.25	-0.28	40°06'03.631"N	104°39'25.852"W	0.09	
1249.00	0.190	129.520	1248.97	-4.33	4.32	-0.36	40°06'03.632"N	104°39'25.853"W	0.57	
1341.00	0.200	226.820	1340.97	-4.13	4.11	-0.36	40°06'03.630"N	104°39'25.853"W	0.32	
1433.00	0.170	279.830	1432.97	-4.06	4.02	-0.61	40°06'03.629"N	104°39'25.856"W	0.18	
1525.00	0.200	212.330	1524.97	-3.96	3.91	-0.83	40°06'03.628"N	104°39'25.859"W	0.23	
1617.00	0.480	225.460	1616.97	-3.58	3.51	-1.19	40°06'03.624"N	104°39'25.863"W	0.31	
1709.00	0.380	210.610	1708.96	-3.09	2.97	-1.62	40°06'03.618"N	104°39'25.869"W	0.16	
1847.00	0.440	136.450	1846.96	-2.30	2.19	-1.49	40°06'03.611"N	104°39'25.867"W	0.36	
1911.00	0.600	118.350	1910.96	-1.93	1.86	-1.03	40°06'03.607"N	104°39'25.861"W	0.36	
2004.00	0.470	122.100	2003.95	-1.44	1.42	-0.28	40°06'03.603"N	104°39'25.852"W	0.14	
2099.00	0.440	116.810	2098.95	-1.02	1.05	0.38	40°06'03.599"N	104°39'25.843"W	0.05	
2193.00	0.620	161.050	2192.95	-0.34	0.41	0.87	40°06'03.593"N	104°39'25.837"W	0.46	
2288.00	0.540	149.090	2287.94	0.56	-0.46	1.26	40°06'03.584"N	104°39'25.832"W	0.15	
2383.00	0.680	61.450	2382.94	0.72	-0.58	1.99	40°06'03.583"N	104°39'25.822"W	0.90	
2478.00	0.580	44.170	2477.93	0.17	0.04	2.82	40°06'03.589"N	104°39'25.812"W	0.22	
2573.00	0.400	30.260	2572.93	-0.42	0.67	3.32	40°06'03.596"N	104°39'25.805"W	0.23	
2668.00	0.730	12.630	2667.93	-1.27	1.55	3.62	40°06'03.604"N	104°39'25.801"W	0.39	
2762.00	0.850	304.610	2761.92	-2.28	2.53	3.18	40°06'03.614"N	104°39'25.807"W	0.95	
2857.00	0.490	321.500	2856.91	-3.06	3.24	2.34	40°06'03.621"N	104°39'25.818"W	0.43	
2952.00	0.490	316.160	2951.91	-3.71	3.86	1.81	40°06'03.627"N	104°39'25.825"W	0.05	
3047.00	0.570	324.850	3046.90	-4.43	4.53	1.26	40°06'03.634"N	104°39'25.832"W	0.12	
3142.00	0.940	319.970	3141.90	-5.47	5.52	0.48	40°06'03.644"N	104°39'25.842"W	0.39	
3237.00	1.160	325.170	3236.88	-6.93	6.90	-0.57	40°06'03.657"N	104°39'25.855"W	0.25	
3332.00	0.310	286.350	3331.87	-7.85	7.77	-1.36	40°06'03.666"N	104°39'25.866"W	0.99	
3427.00	0.260	304.750	3426.87	-8.07	7.96	-1.79	40°06'03.668"N	104°39'25.871"W	0.11	
3522.00	0.610	332.320	3521.87	-8.67	8.53	-2.20	40°06'03.673"N	104°39'25.876"W	0.42	
3617.00	1.050	46.450	3616.86	-9.69	9.58	-1.80	40°06'03.684"N	104°39'25.871"W	1.12	
3712.00	1.460	29.000	3711.84	-11.25	11.24	-0.59	40°06'03.700"N	104°39'25.856"W	0.59	
3806.00	0.700	336.090	3805.82	-12.79	12.81	-0.24	40°06'03.716"N	104°39'25.851"W	1.25	
3901.00	0.790	227.280	3900.82	-12.93	12.90	-0.95	40°06'03.716"N	104°39'25.860"W	1.28	
3996.00	0.690	226.270	3995.81	-12.16	12.06	-1.85	40°06'03.708"N	104°39'25.872"W	0.11	
4091.00	0.290	345.300	4090.81	-12.03	11.89	-2.32	40°06'03.707"N	104°39'25.878"W	0.91	
4186.00	0.410	135.220	4185.81	-12.01	11.88	-2.14	40°06'03.706"N	104°39'25.876"W	0.71	
4281.00	0.540	129.980	4280.80	-11.44	11.36	-1.56	40°06'03.701"N	104°39'25.868"W	0.14	
4376.00	0.500	317.350	4375.80	-11.45	11.37	-1.50	40°06'03.701"N	104°39'25.867"W	1.09	
4470.00	1.700	297.210	4469.78	-12.50	12.31	-3.02	40°06'03.711"N	104°39'25.887"W	1.32	
4565.00	1.750	334.780	4564.74	-14.59	14.27	-4.89	40°06'03.730"N	104°39'25.911"W	1.17	
4660.00	2.560	3.890	4659.68	-18.05	17.70	-5.36	40°06'03.764"N	104°39'25.917"W	1.41	
4755.00	3.890	12.700	4754.53	-23.23	22.96	-4.51	40°06'03.816"N	104°39'25.906"W	1.49	
4849.00	5.180	15.970	4848.23	-30.26	30.15	-2.64	40°06'03.887"N	104°39'25.882"W	1.40	
4944.00	6.580	14.970	4942.73	-39.42	39.53	-0.06	40°06'03.980"N	104°39'25.849"W	1.48	
5039.00	7.770	29.900	5036.99	-49.88	50.36	4.55	40°06'04.087"N	104°39'25.789"W	2.32	
5134.00	9.910	43.050	5130.87	-60.73	61.90	13.34	40°06'04.201"N	104°39'25.676"W	3.08	
5229.00	11.720	44.050	5224.17	-72.68	74.81	25.63	40°06'04.328"N	104°39'25.518"W	1.92	
5324.00	12.710	40.240	5317.02	-86.55	89.72	39.09	40°06'04.476"N	104°39'25.345"W	1.34	
5419.00	13.090	39.570	5409.63	-101.76	105.99	52.69	40°06'04.636"N	104°39'25.170"W	0.43	
5513.00	14.400	35.880	5500.93	-118.36	123.67	66.32	40°06'04.811"N	104°39'24.995"W	1.68	
5608.00	15.210	33.090	5592.78	-137.29	143.68	80.05	40°06'05.009"N	104°39'24.818"W	1.14	



Actual Wellpath Report

COLFER 13C-34HZ AWP

Page 3 of 6



REFERENCE WELLPATH IDENTIFICATION			
Operator	ANADARKO E&P COMPANY LP	Slot	SLOT#02 COLFER 13C-34HZ (480'FNL & 580'FWL,SEC.34)
Area	COLORADO	Well	COLFER 13C-34HZ
Field	WELD COUNTY (KERR MCGEE)	Wellbore	COLFER 13C-34HZ AWB
Facility	SEC.34-T2N-R65W		

WELLPATH DATA (151 stations) † = interpolated/extrapolated station										
MD [ft]	Inclination [°]	Azimuth [°]	TVD [ft]	Vert Sect [ft]	North [ft]	East [ft]	Latitude	Longitude	DLS [°/100ft]	Comments
5703.00	17.000	31.090	5684.05	-158.52	166.02	94.03	40°06'05.230"N	104°39'24.638"W	1.97	
5798.00	17.360	30.100	5774.81	-181.54	190.17	108.30	40°06'05.468"N	104°39'24.454"W	0.49	
5893.00	16.760	28.990	5865.63	-204.69	214.42	122.05	40°06'05.708"N	104°39'24.277"W	0.72	
5988.00	15.600	30.530	5956.87	-226.62	237.40	135.18	40°06'05.935"N	104°39'24.108"W	1.30	
6083.00	15.390	31.270	6048.41	-247.37	259.18	148.21	40°06'06.150"N	104°39'23.941"W	0.30	
6178.00	14.750	29.810	6140.15	-267.63	280.45	160.77	40°06'06.360"N	104°39'23.779"W	0.78	
6272.00	15.310	24.000	6230.93	-288.47	302.17	171.76	40°06'06.575"N	104°39'23.638"W	1.71	
6367.00	16.800	18.690	6322.23	-312.16	326.63	181.27	40°06'06.817"N	104°39'23.515"W	2.20	
6462.00	15.640	22.480	6413.45	-336.23	351.47	190.56	40°06'07.062"N	104°39'23.396"W	1.65	
6512.00	13.820	23.250	6461.81	-347.55	363.19	195.50	40°06'07.178"N	104°39'23.332"W	3.66	
6556.00	13.560	26.190	6504.56	-356.65	372.65	199.85	40°06'07.272"N	104°39'23.276"W	1.69	
6588.00	13.930	36.470	6535.65	-362.80	379.11	203.79	40°06'07.335"N	104°39'23.225"W	7.71	
6619.00	15.320	48.550	6565.65	-368.10	384.82	209.08	40°06'07.392"N	104°39'23.157"W	10.79	
6651.00	17.070	61.940	6596.39	-372.55	389.83	216.40	40°06'07.441"N	104°39'23.063"W	12.85	
6683.00	19.740	74.190	6626.76	-375.53	393.52	225.75	40°06'07.478"N	104°39'22.943"W	14.64	
6714.00	20.900	85.390	6655.84	-376.60	395.39	236.30	40°06'07.496"N	104°39'22.807"W	13.07	
6746.00	22.950	93.920	6685.53	-375.74	395.42	248.22	40°06'07.497"N	104°39'22.654"W	11.82	
6777.00	23.590	97.660	6714.01	-373.60	394.18	260.40	40°06'07.484"N	104°39'22.497"W	5.19	
6809.00	22.920	104.000	6743.42	-370.31	391.82	272.79	40°06'07.461"N	104°39'22.337"W	8.09	
6841.00	23.100	115.730	6772.89	-365.22	387.58	284.50	40°06'07.419"N	104°39'22.187"W	14.32	
6872.00	23.590	128.830	6801.37	-357.93	381.05	294.82	40°06'07.355"N	104°39'22.054"W	16.79	
6904.00	25.750	137.220	6830.45	-348.11	371.93	304.53	40°06'07.264"N	104°39'21.929"W	12.84	
6935.00	28.450	146.460	6858.06	-336.39	360.83	313.19	40°06'07.155"N	104°39'21.818"W	16.11	
6967.00	31.050	153.100	6885.85	-322.11	347.11	321.14	40°06'07.019"N	104°39'21.715"W	13.11	
6999.00	31.740	162.670	6913.18	-306.28	331.70	327.38	40°06'06.867"N	104°39'21.635"W	15.71	
7030.00	33.660	167.970	6939.27	-289.82	315.51	331.60	40°06'06.707"N	104°39'21.581"W	11.12	
7062.00	36.200	175.270	6965.52	-271.57	297.41	334.23	40°06'06.528"N	104°39'21.547"W	15.27	
7094.00	39.180	176.760	6990.84	-252.01	277.90	335.58	40°06'06.335"N	104°39'21.529"W	9.74	
7125.00	41.050	177.720	7014.54	-232.05	257.95	336.54	40°06'06.138"N	104°39'21.517"W	6.35	
7157.00	41.040	176.430	7038.68	-211.04	236.96	337.61	40°06'05.931"N	104°39'21.503"W	2.65	
7188.00	40.690	178.770	7062.12	-190.77	216.70	338.46	40°06'05.730"N	104°39'21.492"W	5.07	
7220.00	41.710	180.160	7086.20	-169.74	195.62	338.66	40°06'05.522"N	104°39'21.490"W	4.28	
7252.00	44.140	179.870	7109.63	-148.01	173.83	338.65	40°06'05.307"N	104°39'21.490"W	7.62	
7283.00	48.650	182.000	7131.01	-125.67	151.40	338.27	40°06'05.085"N	104°39'21.495"W	15.37	
7315.00	53.140	180.980	7151.18	-100.97	126.58	337.63	40°06'04.840"N	104°39'21.503"W	14.25	
7347.00	57.600	179.350	7169.37	-74.72	100.26	337.57	40°06'04.580"N	104°39'21.504"W	14.55	
7378.00	62.390	177.940	7184.86	-47.92	73.43	338.21	40°06'04.315"N	104°39'21.496"W	15.95	
7410.00	67.190	176.200	7198.49	-18.99	44.52	339.70	40°06'04.029"N	104°39'21.477"W	15.79	
7442.00	70.790	177.600	7209.96	10.87	14.70	341.31	40°06'03.734"N	104°39'21.456"W	11.97	
7473.00	71.590	179.440	7219.96	40.18	-14.63	342.07	40°06'03.444"N	104°39'21.446"W	6.18	
7505.00	74.130	183.550	7229.39	70.59	-45.19	341.26	40°06'03.142"N	104°39'21.456"W	14.62	
7537.00	77.690	182.810	7237.18	101.36	-76.17	339.54	40°06'02.836"N	104°39'21.479"W	11.35	
7568.00	81.740	181.680	7242.72	131.66	-106.65	338.35	40°06'02.535"N	104°39'21.494"W	13.55	
7600.00	87.000	181.380	7245.85	163.33	-138.47	337.50	40°06'02.221"N	104°39'21.505"W	16.46	
7636.00	88.860	180.450	7247.15	199.15	-174.44	336.92	40°06'01.865"N	104°39'21.512"W	5.78	
7681.00†	89.394	179.937	7247.84	244.01	-219.43	336.77	40°06'01.421"N	104°39'21.514"W	1.64	7" Casing Point
7722.00	89.880	179.470	7248.10	284.91	-260.43	336.99	40°06'01.015"N	104°39'21.512"W	1.64	
7817.00	91.170	179.850	7247.23	379.68	-355.42	337.55	40°06'00.077"N	104°39'21.504"W	1.42	
7912.00	90.250	179.780	7246.05	474.43	-450.42	337.86	40°05'59.138"N	104°39'21.500"W	0.97	
8007.00	87.290	181.180	7248.09	569.06	-545.38	337.06	40°05'58.199"N	104°39'21.511"W	3.45	
8102.00	87.200	180.240	7252.66	663.59	-640.26	335.88	40°05'57.262"N	104°39'21.526"W	0.99	
8197.00	86.690	180.650	7257.72	758.13	-735.12	335.15	40°05'56.324"N	104°39'21.535"W	0.69	
8291.00	87.720	179.590	7262.30	851.74	-829.01	334.95	40°05'55.397"N	104°39'21.538"W	1.57	
8386.00	89.200	181.410	7264.86	946.37	-923.96	334.12	40°05'54.458"N	104°39'21.548"W	2.47	
8481.00	93.080	182.340	7262.97	1040.78	-1018.87	331.02	40°05'53.520"N	104°39'21.588"W	4.20	
8576.00	93.360	181.580	7257.63	1135.07	-1113.67	327.77	40°05'52.584"N	104°39'21.630"W	0.85	
8671.00	91.260	180.400	7253.80	1229.58	-1208.57	326.13	40°05'51.646"N	104°39'21.651"W	2.54	
8766.00	90.340	179.210	7252.48	1324.32	-1303.56	326.46	40°05'50.707"N	104°39'21.647"W	1.58	
8861.00	89.320	178.360	7252.76	1419.18	-1398.53	328.47	40°05'49.768"N	104°39'21.621"W	1.40	
8956.00	90.060	179.950	7253.27	1514.01	-1493.52	329.87	40°05'48.830"N	104°39'21.603"W	1.85	



Actual Wellpath Report

COLFER 13C-34HZ AWP

Page 4 of 6



REFERENCE WELLPATH IDENTIFICATION

Operator	ANADARKO E&P COMPANY LP	Slot	SLOT#02 COLFER 13C-34HZ (480'FNL & 580'FWL,SEC.34)
Area	COLORADO	Well	COLFER 13C-34HZ
Field	WELD COUNTY (KERR MCGEE)	Wellbore	COLFER 13C-34HZ AWB
Facility	SEC.34-T2N-R65W		

WELLPATH DATA (151 stations)

MD [ft]	Inclination [°]	Azimuth [°]	TVD [ft]	Vert Sect [ft]	North [ft]	East [ft]	Latitude	Longitude	DLS [°/100ft]	Comments
9051.00	90.710	180.590	7252.63	1608.70	-1588.51	329.42	40°05'47.891"N	104°39'21.609"W	0.96	
9146.00	90.430	180.220	7251.69	1703.38	-1683.50	328.75	40°05'46.952"N	104°39'21.618"W	0.49	
9241.00	90.950	180.620	7250.54	1798.05	-1778.49	328.06	40°05'46.014"N	104°39'21.627"W	0.69	
9336.00	90.860	180.050	7249.04	1892.73	-1873.48	327.50	40°05'45.075"N	104°39'21.634"W	0.61	
9431.00	90.590	179.040	7247.84	1987.51	-1968.47	328.25	40°05'44.136"N	104°39'21.624"W	1.10	
9526.00	90.150	178.490	7247.23	2082.37	-2063.44	330.30	40°05'43.198"N	104°39'21.598"W	0.74	
9621.00	91.230	179.940	7246.08	2177.18	-2158.42	331.60	40°05'42.259"N	104°39'21.581"W	1.90	
9716.00	90.460	178.450	7244.68	2271.99	-2253.40	332.94	40°05'41.321"N	104°39'21.564"W	1.77	
9811.00	90.650	178.630	7243.76	2366.87	-2348.37	335.36	40°05'40.382"N	104°39'21.533"W	0.28	
9906.00	89.100	177.860	7243.97	2461.78	-2443.32	338.27	40°05'39.444"N	104°39'21.495"W	1.82	
10000.00	89.290	179.050	7245.29	2555.66	-2537.27	340.80	40°05'38.515"N	104°39'21.463"W	1.28	
10095.00	88.620	178.540	7247.02	2650.50	-2632.23	342.80	40°05'37.577"N	104°39'21.437"W	0.89	
10190.00	89.970	179.720	7248.19	2745.32	-2727.21	344.24	40°05'36.638"N	104°39'21.419"W	1.89	
10285.00	90.430	179.050	7247.86	2840.13	-2822.21	345.26	40°05'35.700"N	104°39'21.405"W	0.86	
10380.00	91.110	180.040	7246.58	2934.90	-2917.19	346.02	40°05'34.761"N	104°39'21.396"W	1.26	
10475.00	90.310	178.640	7245.41	3029.70	-3012.18	347.11	40°05'33.822"N	104°39'21.382"W	1.70	
10569.00	90.180	179.590	7245.00	3123.53	-3106.16	348.56	40°05'32.893"N	104°39'21.363"W	1.02	
10664.00	90.550	180.540	7244.40	3218.26	-3201.16	348.45	40°05'31.955"N	104°39'21.364"W	1.07	
10759.00	89.380	181.470	7244.46	3312.85	-3296.14	346.79	40°05'31.016"N	104°39'21.386"W	1.57	
10854.00	89.320	181.510	7245.54	3407.36	-3391.10	344.32	40°05'30.078"N	104°39'21.418"W	0.08	
10949.00	89.480	180.780	7246.53	3501.93	-3486.08	342.42	40°05'29.139"N	104°39'21.442"W	0.79	
11044.00	88.060	181.430	7248.57	3596.48	-3581.04	340.59	40°05'28.201"N	104°39'21.466"W	1.64	
11139.00	88.060	181.420	7251.79	3690.95	-3675.95	338.23	40°05'27.263"N	104°39'21.496"W	0.01	
11234.00	88.340	181.640	7254.77	3785.42	-3770.87	335.69	40°05'26.325"N	104°39'21.529"W	0.37	
11329.00	89.450	181.200	7256.60	3879.93	-3865.82	333.34	40°05'25.386"N	104°39'21.559"W	1.26	
11423.00	90.280	180.670	7256.82	3973.54	-3959.81	331.80	40°05'24.458"N	104°39'21.579"W	1.05	
11518.00	90.650	180.540	7256.05	4068.19	-4054.80	330.80	40°05'23.519"N	104°39'21.592"W	0.41	
11613.00	90.000	179.920	7255.51	4162.89	-4149.80	330.42	40°05'22.580"N	104°39'21.597"W	0.95	
11708.00	89.320	181.500	7256.08	4257.52	-4244.78	329.24	40°05'21.641"N	104°39'21.612"W	1.81	
11720.00	89.230	179.420	7256.23	4269.48	-4256.78	329.15	40°05'21.523"N	104°39'21.613"W	17.35	Last BHI MWD Survey
11790.00	89.230	179.420	7257.17	4339.32	-4326.77	329.86	40°05'20.831"N	104°39'21.604"W	0.00	Projection to Bit

HOLE & CASING SECTIONS - Ref Wellbore: COLFER 13C-34HZ AWB Ref Wellpath: COLFER 13C-34HZ AWP

String/Diameter	Start MD [ft]	End MD [ft]	Interval [ft]	Start TVD [ft]	End TVD [ft]	Start N/S [ft]	Start E/W [ft]	End N/S [ft]	End E/W [ft]
13.5in Open Hole	13.00	1758.00	1745.00	13.00	1757.96	0.00	0.00	2.69	-1.71
9.625in Casing Surface	13.00	1758.00	1745.00	13.00	1757.96	0.00	0.00	2.69	-1.71
8.75in Open Hole	1758.00	7691.00	5933.00	1757.96	7247.94	2.69	-1.71	-229.43	336.79
7in Casing Intermediate	13.00	7681.00	7668.00	13.00	7247.84	0.00	0.00	-219.43	336.77
6.125in Open Hole	7681.00	11790.00	4109.00	7247.84	7257.17	-219.43	336.77	-4326.77	329.86



Actual Wellpath Report

COLFER 13C-34HZ AWP

Page 5 of 6



REFERENCE WELLPATH IDENTIFICATION

Operator	ANADARKO E&P COMPANY LP	Slot	SLOT#02 COLFER 13C-34HZ (480'FNL & 580'FWL,SEC.34)
Area	COLORADO	Well	COLFER 13C-34HZ
Field	WELD COUNTY (KERR MCGEE)	Wellbore	COLFER 13C-34HZ AWB
Facility	SEC.34-T2N-R65W		

TARGETS

Name	MD [ft]	TVD [ft]	North [ft]	East [ft]	Grid East [US ft]	Grid North [US ft]	Latitude	Longitude	Shape
COLFER PAD SECTION LINES		-2.00	0.00	24.09	3235789.91	1280758.25	40°06'03.589"N	104°39'25.538"W	polygon
COLFER PAD HARDLINES (460' SETBACKS)		7026.00	0.00	24.09	3235789.91	1280758.25	40°06'03.589"N	104°39'25.538"W	polygon
COLFER 13C-34HZ BHL ON PLAT (460'FSL & 900'FWL,REV-1)		7264.00	-4330.73	324.88	3236131.83	1276430.75	40°05'20.792"N	104°39'21.668"W	point
COLFER 13C-34HZ BHL ON PLAT (460'FSL & 900'FWL,REV-2)		7267.00	-4330.73	324.88	3236131.83	1276430.75	40°05'20.792"N	104°39'21.668"W	point

WELLPATH COMPOSITION - Ref Wellbore: COLFER 13C-34HZ AWB Ref Wellpath: COLFER 13C-34HZ AWP

Start MD [ft]	End MD [ft]	Positional Uncertainty Model	Log Name/Comment	Wellbore
13.00	1709.00	NaviTrak (Standard)	BHI MWD SURVEYS 13 1/2" HOLE <237-1709>	COLFER 13C-34HZ AWB
1709.00	7636.00	NaviTrak (Standard)	BHI MWD SURVEYS 8 3/4" HOLE <1847-7636>	COLFER 13C-34HZ AWB
7636.00	11720.00	NaviTrak (Standard)	BHI MWD SURVEYS 6 1/8" HOLE <7722-11720>	COLFER 13C-34HZ AWB
11720.00	11790.00	Blind Drilling (std)	Projection to bit	COLFER 13C-34HZ AWB



Actual Wellpath Report

COLFER 13C-34HZ AWP

Page 6 of 6



REFERENCE WELLPATH IDENTIFICATION

Operator	ANADARKO E&P COMPANY LP	Slot	SLOT#02 COLFER 13C-34HZ (480'FNL & 580'FWL,SEC.34)
Area	COLORADO	Well	COLFER 13C-34HZ
Field	WELD COUNTY (KERR MCGEE)	Wellbore	COLFER 13C-34HZ AWB
Facility	SEC.34-T2N-R65W		

WELLPATH COMMENTS

MD [ft]	Inclination [°]	Azimuth [°]	TVD [ft]	Comment
237.00	0.190	353.860	237.00	Begin BHI MWD Surveys
7681.00	89.394	179.937	7247.84	7" Casing Point
11720.00	89.230	179.420	7256.23	Last BHI MWD Survey
11790.00	89.230	179.420	7257.17	Projection to Bit