

AXIA ENERGY
CONSTRUCTION LAYOUT FOR
BULLDOG #20-12H-892
SECTION 20, T8N, R92W, 6th P.M.
1641' FNL 712' FWL

FIGURE #1
SCALE: 1" = 60'
DATE: 03-23-12
DRAWN BY: Z.L.
REVISED: 04-11-12
REVISED: 04-18-12

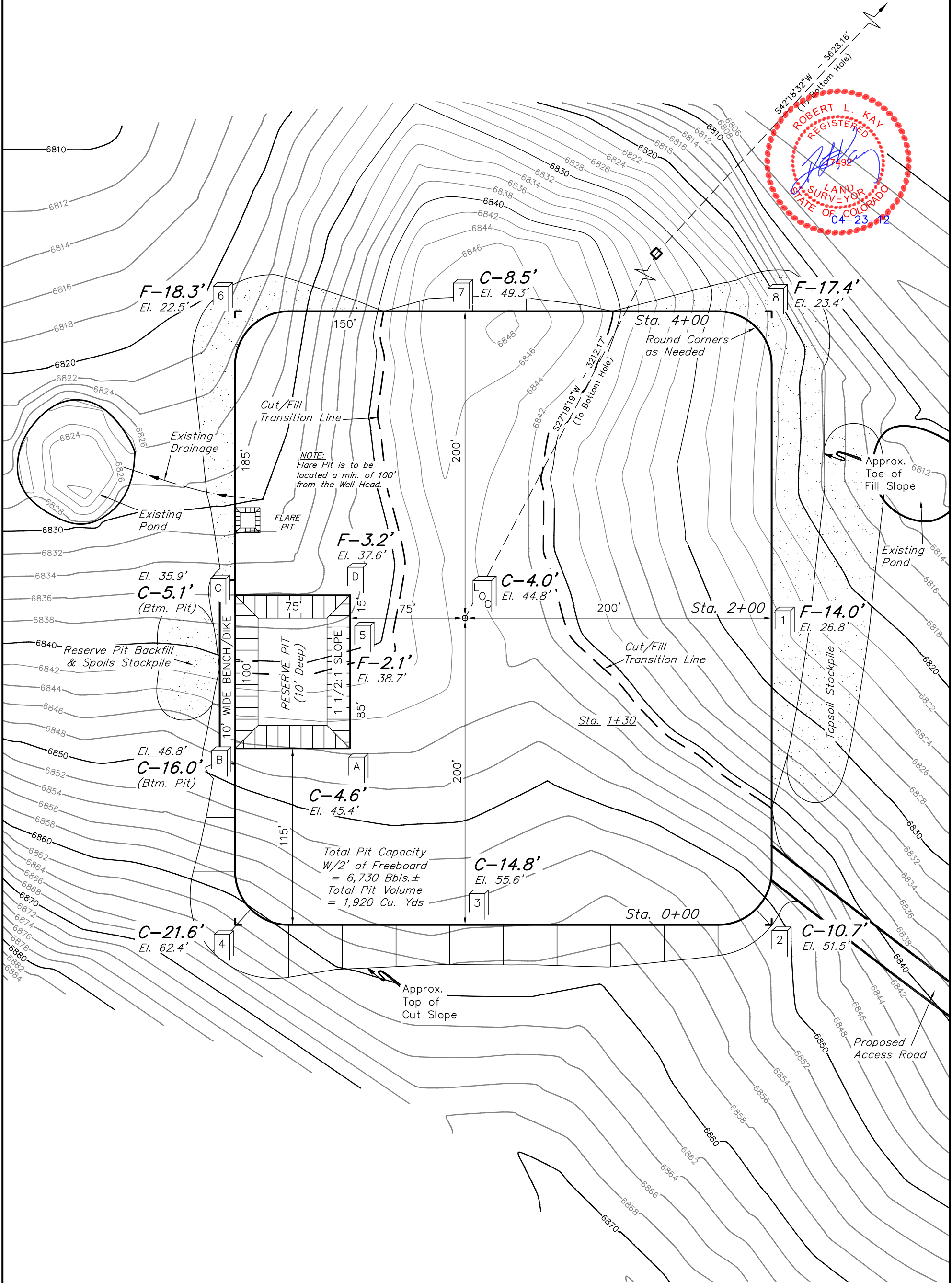
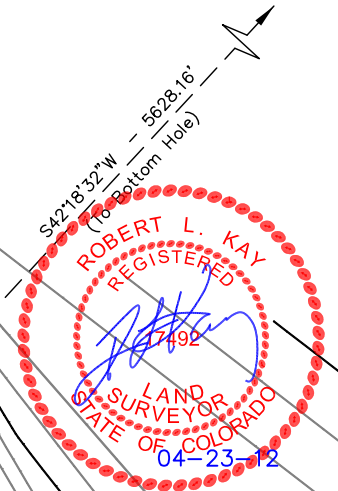

Elev. Ungraded Ground At Loc. Stake = 6844.8'
FINISHED GRADE ELEV. AT LOC. STAKE = 6840.8'

UINTAH ENGINEERING & LAND SURVEYING
85 So. 200 East * Vernal, Utah 84078 * (435) 789-1017

1" = 40'
X-Section
Scale
1" = 100'

DATE: 03-23-12
DRAWN BY: Z.L.
REVISED: 04-11-12
REVISED: 04-18-12

AXIA ENERGY
CONSTRUCTION LAYOUT CROSS SECTIONS FOR
BULLDOG #20-12H-892
SECTION 20, T8N, R92W, 6th P.M.
1641' FNL 712' FWL

FIGURE #2

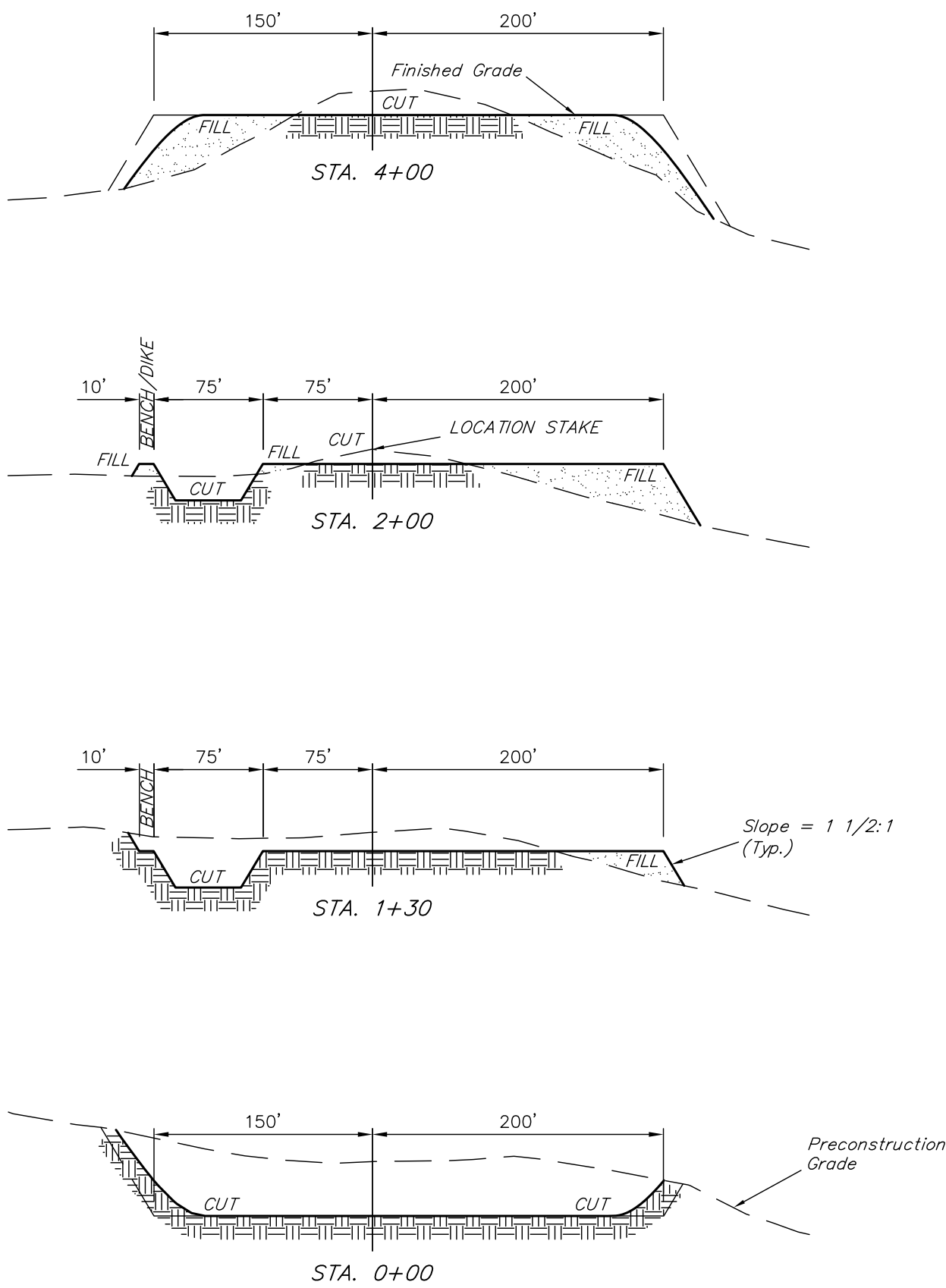

* NOTE:
FILL QUANTITY INCLUDES
5% FOR COMPACTION

WELL PAD APPROXIMATE YARDAGES

(6") Topsoil Stripping = 3,190 Cu. Yds.
Remaining Location = 23,000 Cu. Yds.
TOTAL CUT = 26,190 CU. YDS.
FILL = 22,040 CU. YDS.

EXCESS MATERIAL = 4,150 Cu. Yds.
Topsoil & Pit Backfill = 4,150 Cu. Yds.
(1/2 Pit Vol.)
EXCESS UNBALANCE = 0 Cu. Yds.
(After Interim Rehabilitation)

APPROXIMATE ACREAGES

WELL SITE DISTURBANCE = ± 4.208 ACRES
ACCESS ROAD DISTURBANCE = ± 5.928 ACRES
TOTAL = ± 10.136 ACRES

UINTAH ENGINEERING & LAND SURVEYING
85 So. 200 East * Vernal, Utah 84078 * (435) 789-1017



AXIA ENERGY
RECLAMATION DIAGRAM FOR
BULLDOG #20-12H-892
SECTION 20, T8N, R92W, 6th P.M.
1641' FNL 712' FWL

FIGURE #4

SCALE: 1" = 60'
DATE: 03-23-12
DRAWN BY: Z.L.
REVISED: 04-11-12
REVISED: 04-18-12

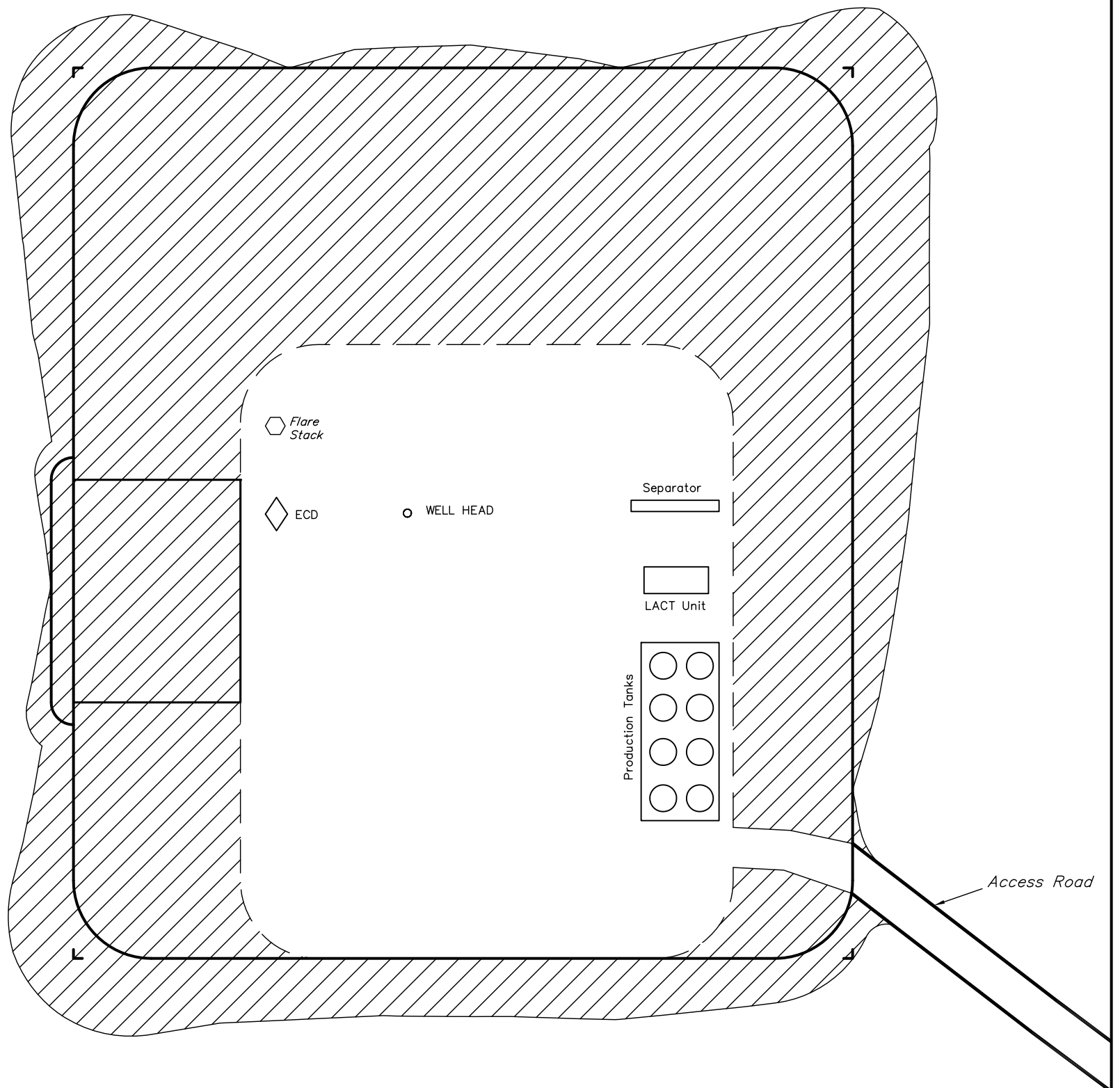

RECLAIMED AREA

APPROXIMATE ACREAGES
UN-RECLAIMED = ± 1.401 ACRES

UINTAH ENGINEERING & LAND SURVEYING
85 So. 200 East * Vernal, Utah 84078 * (435) 789-1017