

MONITOR WELL (AS-DRILLED)

GEOGRAPHIC	LAT.	40.834102°
DEC. DEG.	LONG.	105.008026°
DEC. MIN. SEC.	LAT.	40.834119°
DEC. MIN. SEC.	LONG.	105.007498°
DEC. MIN. SEC.	LAT.	40°50'02.77"
DEC. MIN. SEC.	LONG.	105°00'28.89"
DEC. MIN. SEC.	LAT.	40°50'02.83"
DEC. MIN. SEC.	LONG.	105°00'26.99"
STATE PLANE	NORTH	1547089.11
CO. NORTH	EAST	3136141.71
NAD 27	NORTH	547086.41
NAD 27	EAST	2136291.56

FOOTAGE: 2151' FEL - 2622' FSL
 GROUND ELEV. 5578.5'
 INST. OPTR. ALLEN BLATTEL
 MEASURE DATE: 3/26/2012
 PDOP: 1.4

I, Rodney A. Walters, Professional Land Surveyor, CO. LS # 16847 hereby certify that (in accordance with a request from Erin Bibeau with Marathon Oil Co, 5555 San Felipe, Houston, TX 77056) I and or personnel under my direction made a survey on the 26th day of March 2012, for the Monitoring Well Location and Elevation of Marathon Oil Co. RAWHIDE FLATS 10-68-16-1M being located within the NW1/4 SE1/4 Section 16, T10N, R68W, of the 6th P.M., Larimer County, State of Colorado.

- All bearings and distances are **GRID** based on the Colorado State Plane Coordinate System, North Zone, North American Datum 1983 from GPS observations occupying a WHS control point (5/8" rebar) and having the Location and Elevation derived from an Opus Solution.
- Vertical Datum used is of NAVD 88.
- Record Bearings and Distances as shown are based on the General Land Office Survey plat approved on the 16th day of December 1872.

CONFIDENTIALITY NOTES:

The information contained in this plot is legally privileged and confidential information intended only for the use of the recipients. If you are not the intended recipients, you are hereby notified that any use, dissemination, distribution or copying of this information is strictly prohibited.

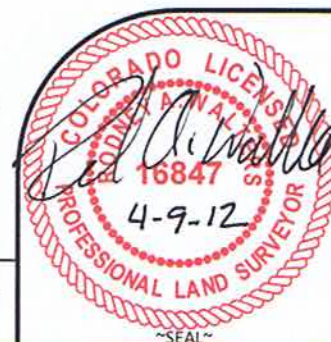

WILLIAM H. SMITH & ASSOCIATES P.C.
 SURVEYING CONSULTANTS
 350 EAST SECOND NORTH PHONE: 307-875-3638
 GREEN RIVER, WY 307-875-3639
 www.wsmithpc.com

DRAWN BY: LAL CHECKED BY: RAW
 PROJECT NO: 1068161M JOB NO: 2011001
 REVISIONS:

LEGEND

- FOUND CORNER
- CALCULATED CORNER
- NOTHING FOUND

LOCATION:

RAWHIDE FLATS 10-68-16-1M
 WITHIN THE NW/4
 SE/4 SECTION 16,
 T 10 N, R 68 W,
 6TH PM.
 LARIMER COUNTY,
 COLORADO

MARATHON OIL COMPANY
 PO BOX 3128, HOUSTON TX, 77253
 5555 SAN FELIPE, HOUSTON TX, 77056

AS-DRILLED MONITORING WELL PLAT

SCALE: 1"=1000' EXHIBIT "A"
 DATE: 4/5/2012 SHEET 1 OF 1