

**ConocoPhillips Company**  
**GRIMM #34-4H**  
**LOCATED IN ARAPAHOE COUNTY, COLORADO**  
**SECTION 34, T4S, R64W, 6th P.M.**



**PHOTO: VIEW FROM CORNER #1 TO LOCATION STAKE**

**CAMERA ANGLE: WESTERLY**



**PHOTO: VIEW OF PROPOSED ACCESS**

**CAMERA ANGLE: WESTERLY**



- Since 1964 -

**U  
E  
L  
S**

**Uintah Engineering & Land Surveying**  
85 South 200 East Vernal, Utah 84078  
(435) 789-1017 \* FAX (435) 789-1813

**LOCATION PHOTOS**

**12 02 11**  
MONTH DAY YEAR

**PHOTO  
P1**

TAKEN BY: J.H. DRAWN BY: C.I. REVISED: 03-06-12



# ConocoPhillips Company

**GRIMM #34-4H**

LOCATED IN ARAPAHOE COUNTY, COLORADO  
SECTION 34, T4S, R64W, 6th P.M.



PHOTO: VIEW OF LOCATION STAKE

CAMERA ANGLE: NORTHERLY

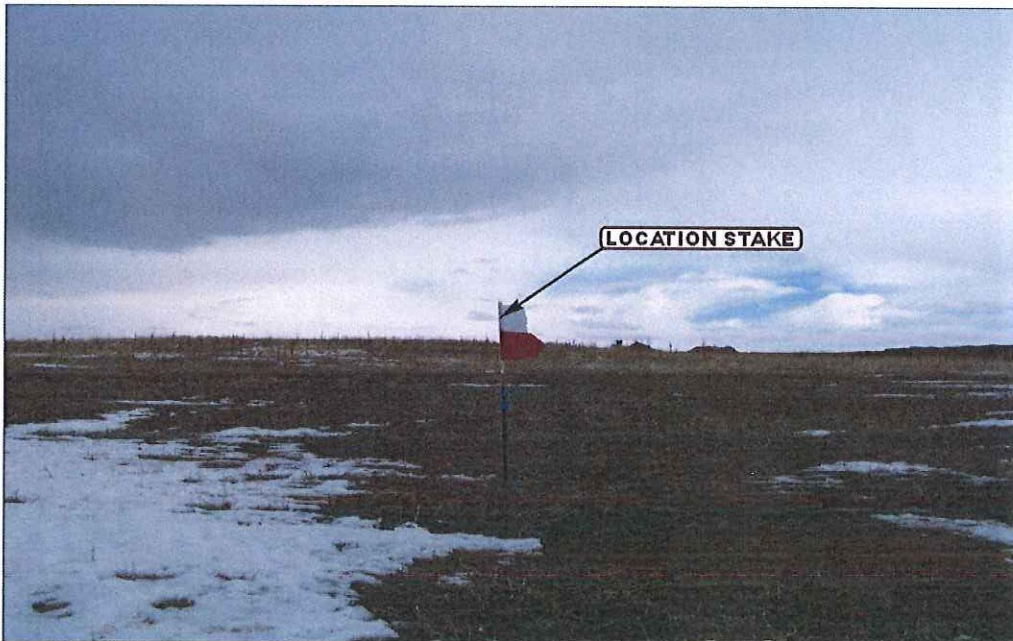

PHOTO: VIEW OF LOCATION STAKE

CAMERA ANGLE: EASTERLY



**UELS**

Uintah Engineering & Land Surveying  
85 South 200 East Vernal, Utah 84078  
(435) 789-1017 \* FAX (435) 789-1813

**LOCATION PHOTOS**

**12 02 11**  
MONTH DAY YEAR

**PHOTO  
P2**

TAKEN BY: J.H. | DRAWN BY: C.I. | REVISED: 03-06-12



# ConocoPhillips Company

**GRIMM #34-4H**

LOCATED IN ARAPAHOE COUNTY, COLORADO  
SECTION 34, T4S, R64W, 6th P.M.

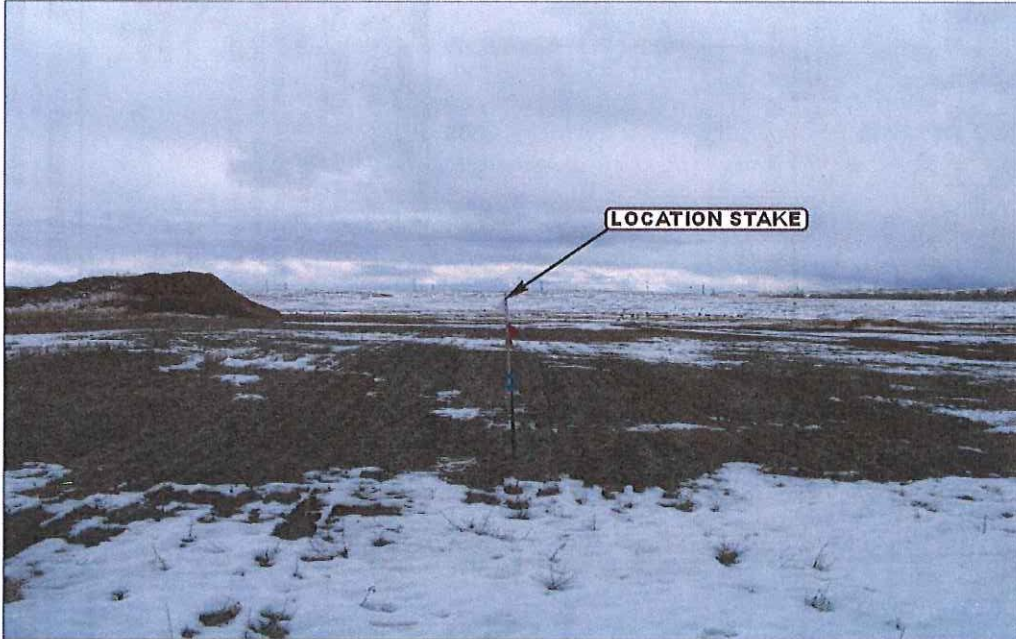

PHOTO: VIEW OF LOCATION STAKE

CAMERA ANGLE: SOUTHERLY



PHOTO: VIEW OF LOCATION STAKE

CAMERA ANGLE: WESTERLY



**U  
E  
S**

Uintah Engineering & Land Surveying

85 South 200 East Vernal, Utah 84078  
(435) 789-1017 \* FAX (435) 789-1813

**LOCATION PHOTOS**

**12 02 11**  
MONTH DAY YEAR

PHOTO  
**P3**

TAKEN BY: J.H. DRAWN BY: C.I. REVISED: 03-06-12