

# ConocoPhillips Company

## CONSTRUCTION LAYOUT FOR

GRIMM #34-4H

SECTION 34, T4S, R64W, 6th P.M.

386' FSL 1245' FWL

FIGURE #1

SCALE: 1" = 60'

DATE: 12-09-11

DRAWN BY: J.J.

REVISED: 12-19-11

REVISED: 02-16-12

REVISED: 03-05-12

REVISED: 03-08-12

REVISED: 03-13-12

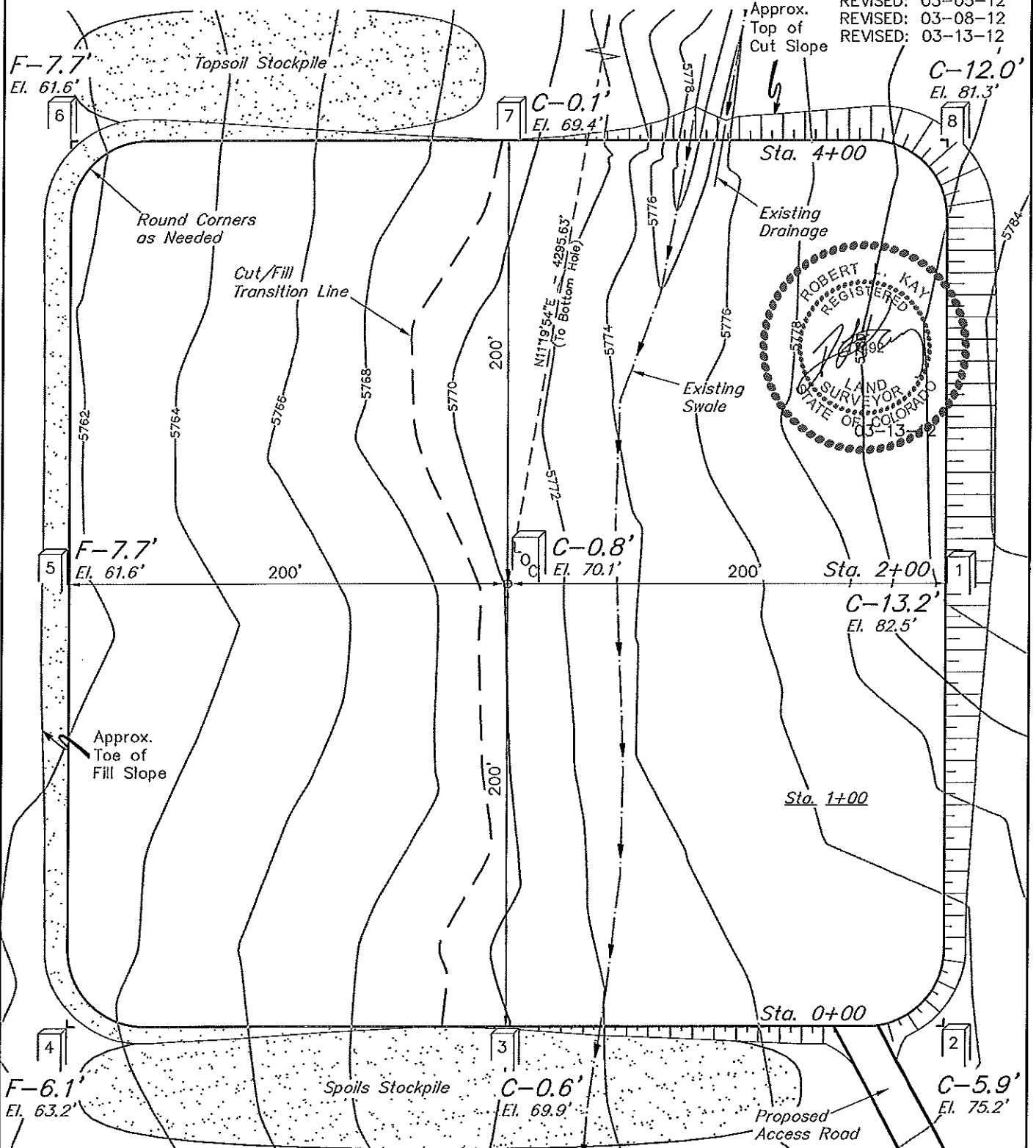
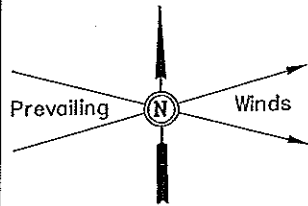

Elev. Ungraded Ground At Loc. Stake = 5770.1'  
FINISHED GRADE ELEV. AT LOC. STAKE = 5769.3'

UINTAH ENGINEERING & LAND SURVEYING  
85 So. 200 East \* Vernal, Utah 84078 \* (435) 789-1017

# ConocoPhillips Company

## CONSTRUCTION LAYOUT FOR

GRIMM #34-4H

SECTION 34, T4S, R64W, 6th P.M.

386' FSL 1245' FWL

FIGURE #1

SCALE: 1" = 60'

DATE: 12-09-11

DRAWN BY: J.J.

REVISED: 12-19-11

REVISED: 02-16-12

REVISED: 03-05-12

REVISED: 03-08-12

REVISED: 03-13-12

REVISED: 03-27-12

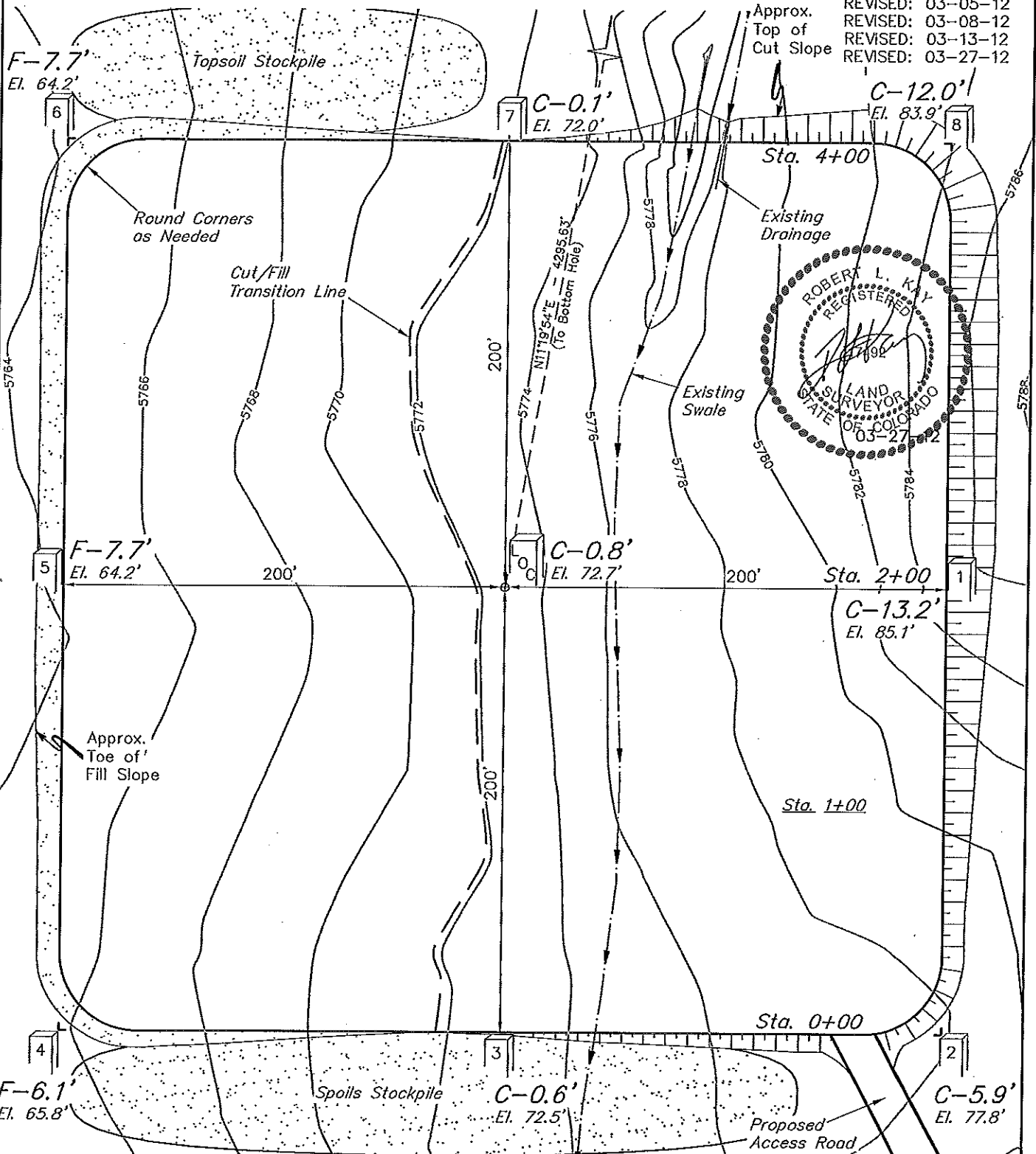
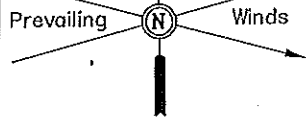

Elev. Ungraded Ground At Loc. Stake = 5772.7'  
FINISHED GRADE ELEV. AT LOC. STAKE = 5771.9'

UINTAH ENGINEERING & LAND SURVEYING  
85 So. 200 East \* Vernal, Utah 84078 \* (435) 789-1017

# ConocoPhillips Company

## CONSTRUCTION LAYOUT CROSS SECTIONS FOR

GRIMM #34-4H

SECTION 34, T4S, R64W, 6th P.M.

386' FSL 1245' FWL

FIGURE #2

1" = 40'

X-Section  
Scale

1" = 100'

DATE: 12-09-11

DRAWN BY: J.J.

REVISED: 02-16-12

REVISED: 03-05-12

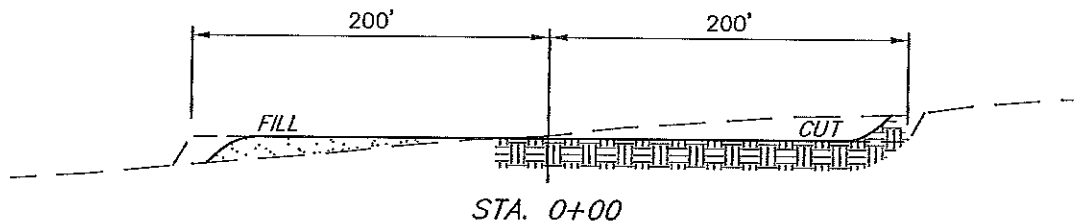
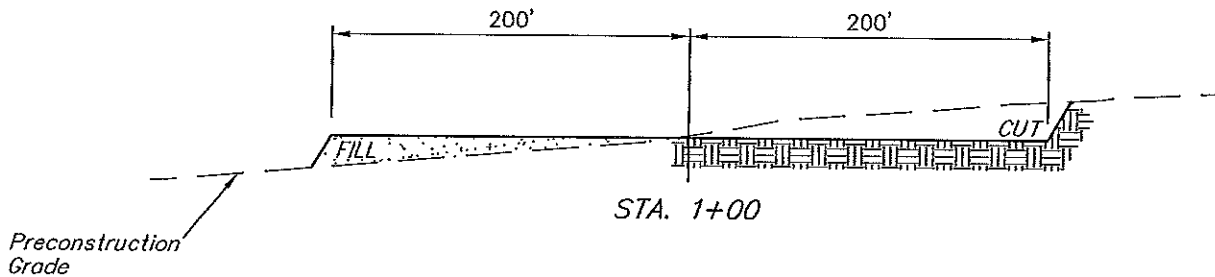
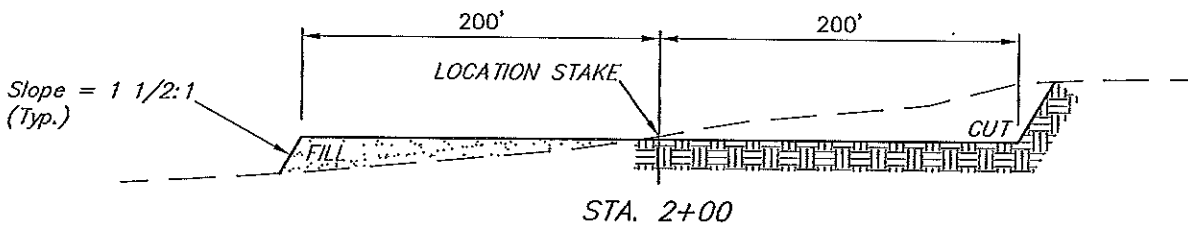
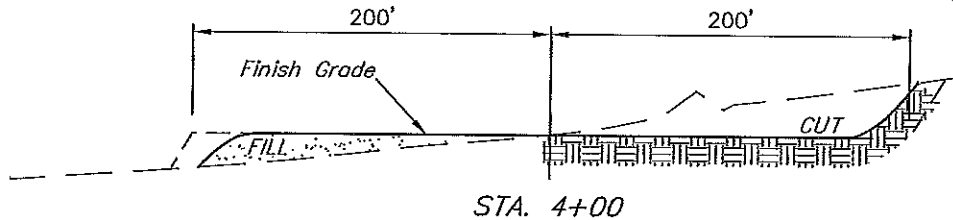
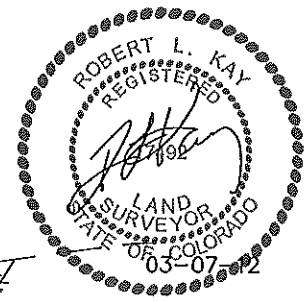

### NOTE:

Topsoil should not be Stripped Below Finished Grade on Substructure Area.

### APPROXIMATE ACREAGES

WELL SITE DISTURBANCE = ± 2.404 ACRES  
ACCESS ROAD DISTURBANCE = ± 6.261 ACRES  
TOTAL = ± 8.665 ACRES

### \* NOTE:

FILL QUANTITY INCLUDES 5% FOR COMPACTION

### APPROXIMATE YARDAGES

(6") Topsoil Stripping = 3,310 Cu. Yds.  
Remaining Location = 18,230 Cu. Yds.  
TOTAL CUT = 21,540 CU. YDS.  
FILL = 12,710 CU. YDS.

EXCESS MATERIAL = 8,830 Cu. Yds.  
Topsoil = 3,310 Cu. Yds.

EXCESS UNBALANCE = 5,520 Cu. Yds.  
(After Interim Rehabilitation)

UINTAH ENGINEERING & LAND SURVEYING  
85 So. 200 East \* Vernal, Utah 84078 \* (435) 789-1017