

ROBERT L. BAYLESS, PRODUCER LLC.
 PROPOSED PRODUCTION SCHEMATIC AND INTERIM RECLAMATION PLAN
 WEAVER RIDGE 14-15H
 Pad Location: SWSE Section 14, T1S, R104W, 6th P.M.

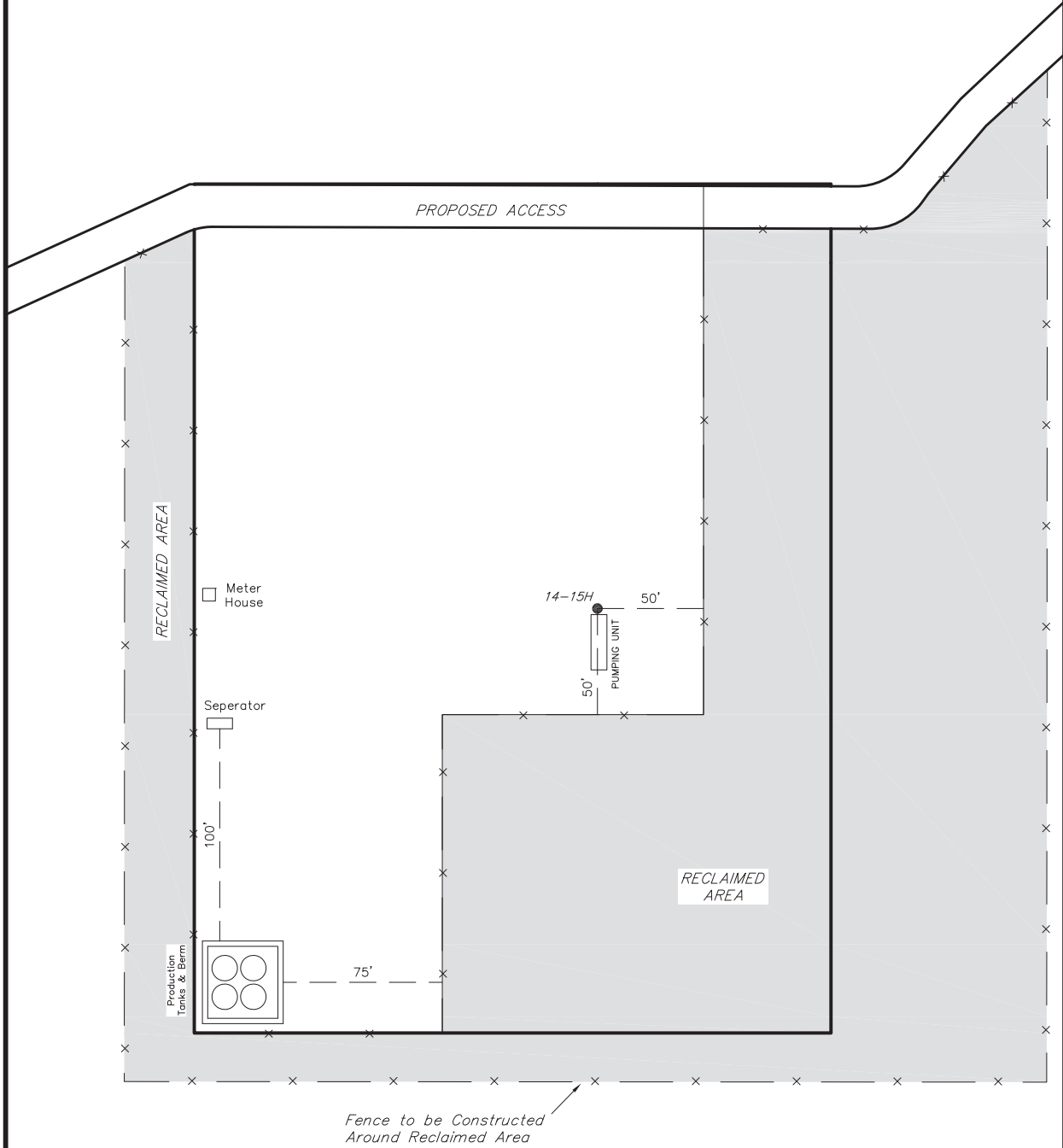
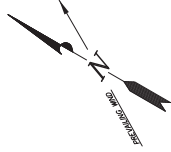

- Notes:
1. Reclaimed area to include seeding of approved vegetation and sufficient storm water management system.
 2. Actual Equipment Layout and Reclaimed Pad Surface Area May Change do to Production Requirements or Site Conditions.

DISTURBED AREA: _____
 TOTAL DISTURBED AREA = 4.99 ACRES
 TOTAL RECLAIMED AREA = 2.41 ACRES
 UNRECLAIMED AREA = 2.58 ACRES

SURVEYED BY:	C.D.S.	DATE SURVEYED:	10-03-11
DRAWN BY:	F.T.M.	DATE DRAWN:	10-06-11
SCALE:	1" = 50'	REVISED:	M.W. - 03-27-12

Tri State
 Land Surveying, Inc.
 (435) 781-2501
 180 NORTH VERNAL AVE. VERNAL, UTAH 84078