

ROBERT L. BAYLESS, PRODUCER LLC.

PROPOSED SCHEMATIC

WEAVER RIDGE 23-10 (Existing Well)

WEAVER RIDGE 23-7H (Proposed Well)

Pad Location: SWNE Section 23, T1S, R104W, 6th P.M.

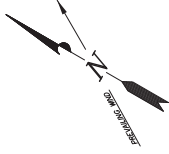

Fence to be Constructed Around Reclaimed Area

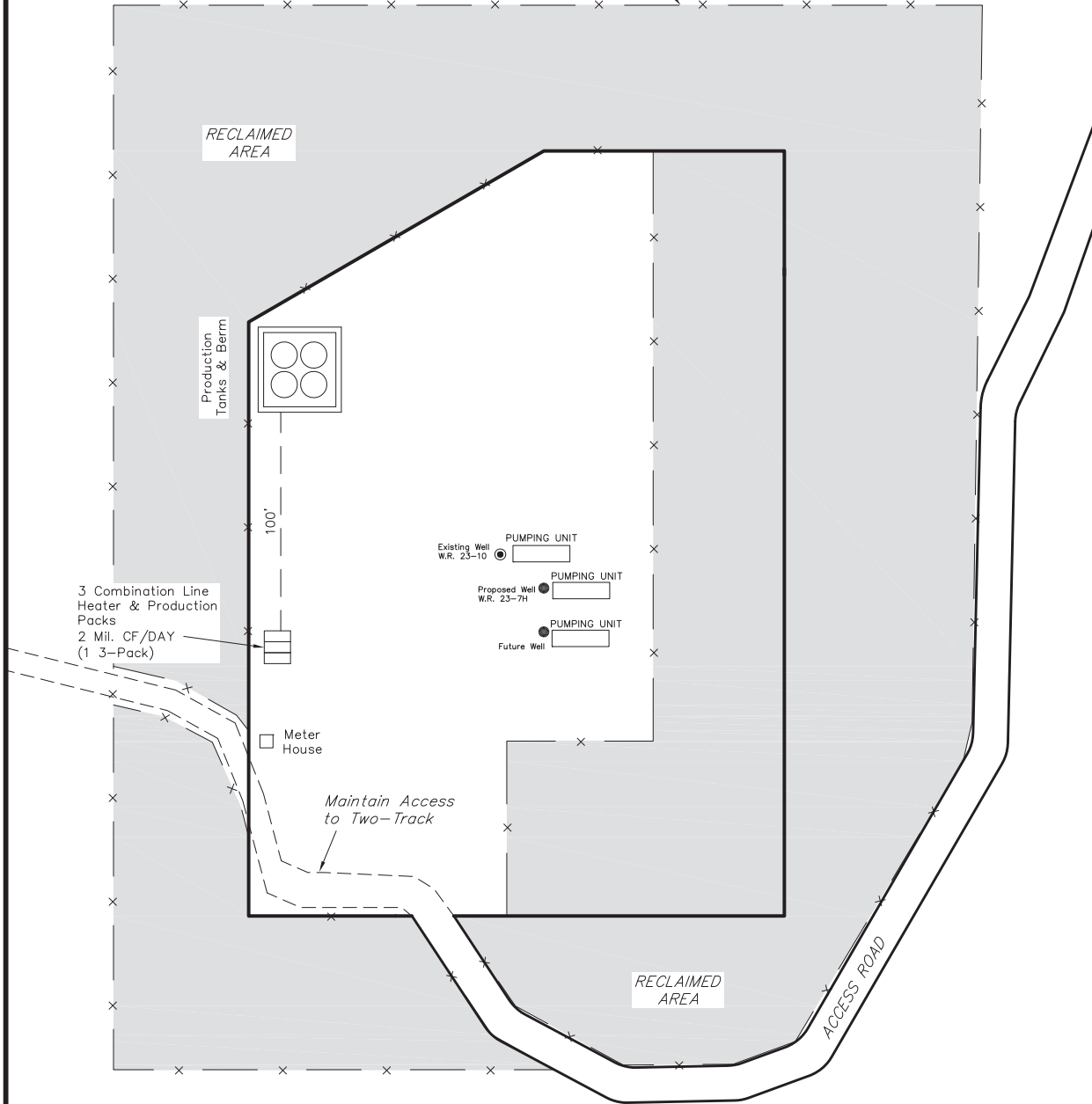

Notes:

1. Reclaimed area to include seeding of approved vegetation and sufficient storm water management system.
2. Actual Equipment Layout and Reclaimed Pad Surface Area May Change do to Production Requirements or Site Conditions.

DISTURBED AREA:

TOTAL DISTURBED AREA = 4.52 ACRES
 TOTAL RECLAIMED AREA = 2.94 ACRES
 UNRECLAIMED AREA = 1.58 ACRES

SURVEYED BY:	C.D.S.	DATE SURVEYED:	10-03-11
DRAWN BY:	F.T.M.	DATE DRAWN:	10-06-11
SCALE:	1" = 50'	REVISED:	M.W. - 03-27-12

Tri State (435) 781-2501
 Land Surveying, Inc.
 180 NORTH VERNAL AVE. VERNAL, UTAH 84078