

# GREAT WESTERN OIL & GAS COMPANY

## TYPICAL RIG LAYOUT FOR

H-Y #29-21, #20-23, #20-24, #20-53, #29-21-4,  
#29-52, #20-23-18, #29-21-3, #20-34, #29-31-2,  
#29-31, #29-51, #29-31-8 & #20-54

SECTION 29, T6N, R67W, 6th P.M.

NE 1/4 NW 1/4

FIGURE #3



SCALE: 1" = 60'  
DATE: 02-10-12  
DRAWN BY: S.L.  
REVISED: 02-22-12

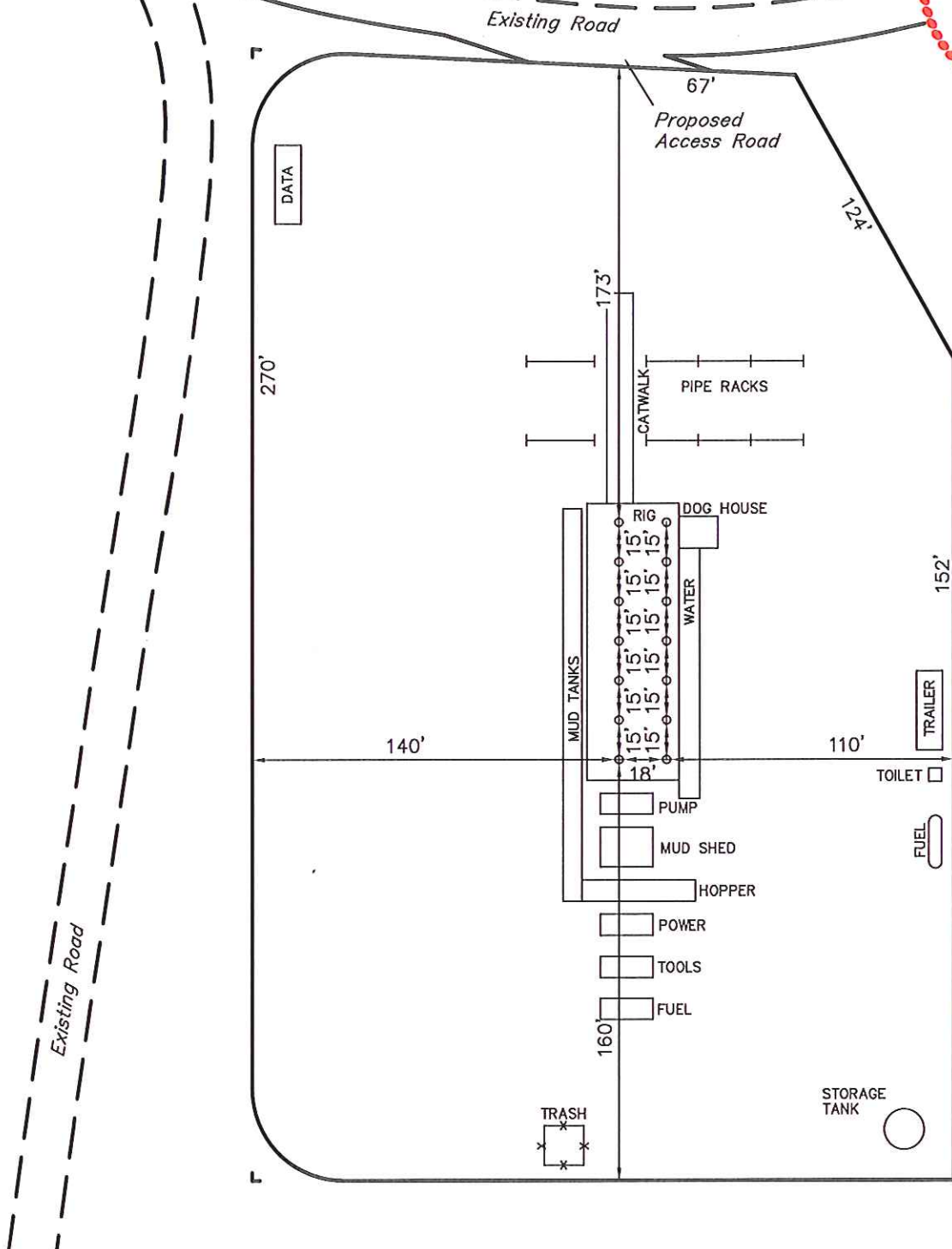

UINTAH ENGINEERING & LAND SURVEYING

85 So. 200 East \* Vernal, Utah 84078 \* (435) 789-1017