

BONANZA CREEK ENERGY OPERATING

Well Name: **PARK T-P-4HZ**

Surface Location: PARK T-P-4HHZ PAD SEC.4- 4N-63W
North American Datum 1983 , US State Plane 1983 , Colorado Northern Zone

Ground Elevation: 4625.0

+N/-S	+E/-W	Northing	Easting	Latitude	Longitude	Slot
0.0	0.0	1366451.03	3296011.50	40.334444	-104.438163	
ENSIGN RIG 128 KB 15'				RKB @ 4640.0ft (ENSIGN RIG 128 KB 15')		

WELLBORE TARGET DETAILS (LAT/LONG)

Name	TVD	+N/-S	+E/-W	Latitude	Longitude	Shape
HARDLINE 460'FNL	1.0	4736.7	-447.0	40.347446	-104.439767	Polygon
HARDLINE 460'FSL	2.0	240.0	8.0	40.335103	-104.438134	Polygon
BHL 460'FNL & 1816'FEL	6412.0	4736.7	-447.7	40.347446	-104.439769	Point
TARGET 1 460'FSL & 1230'FEL	6412.0	240.1	-21.7	40.335103	-104.438241	Point

PARK T-P-4HHZ PAD SEC.4- 4N-63W
PARK T-P-4HZ
PLAN 2 (MAR 12, 2012) PROG 3-5-12
16:16, March 12 2012

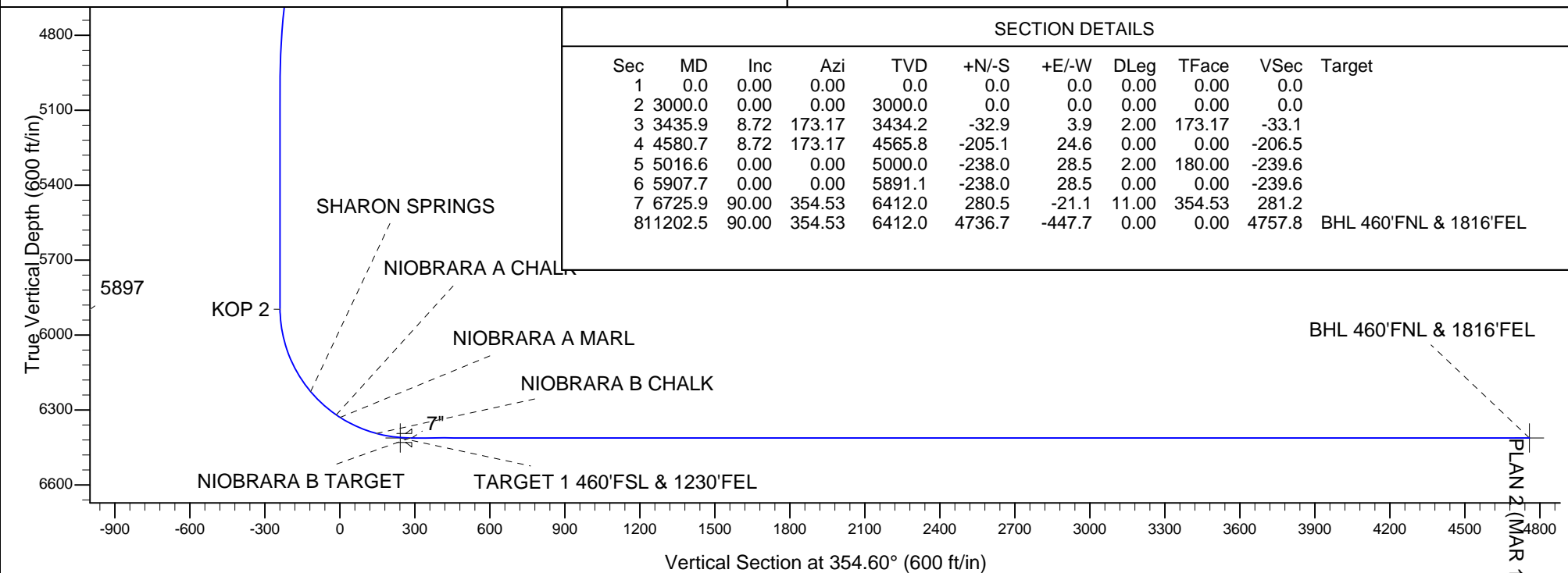
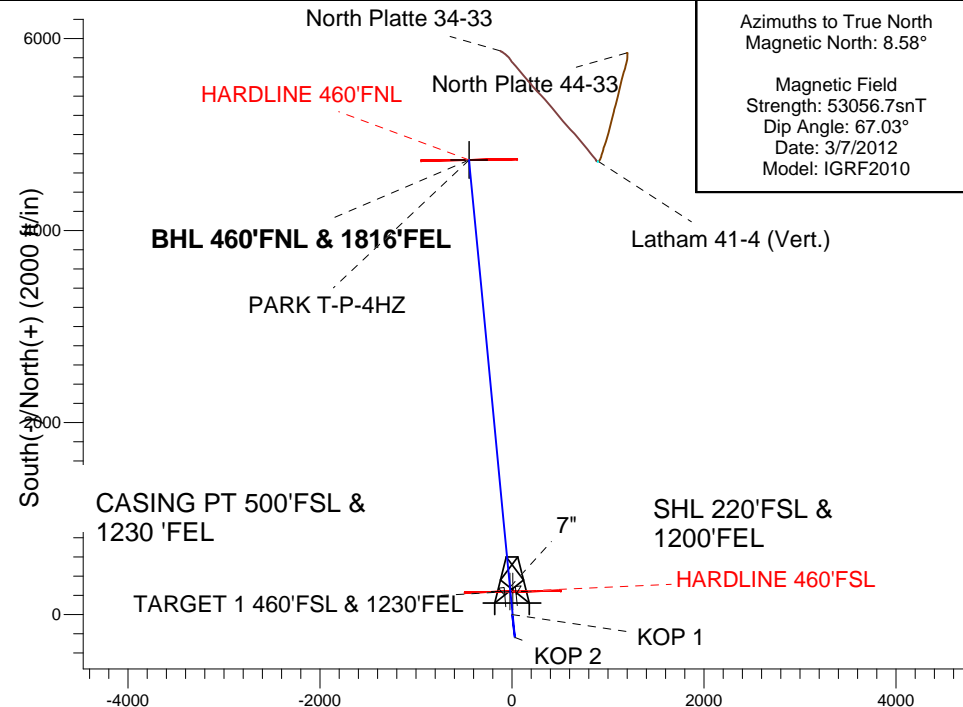



Directional

BONANZA CREEK ENERGY OPERATING

SEC.4-T4N-R63W

PARK T-P-4HHZ PAD SEC.4- 4N-63W

PARK T-P-4HZ

Wellbore #1

Plan: PLAN 2 (MAR 12, 2012) PROG 3-5-12

Standard Planning Report

12 March, 2012

Plan Sections										
Measured Depth (ft)	Inclination (°)	Azimuth (°)	Vertical Depth (ft)	+N/-S (ft)	+E/-W (ft)	Dogleg Rate (°/100ft)	Build Rate (°/100ft)	Turn Rate (°/100ft)	TFO (°)	Target
0.0	0.00	0.00	0.0	0.0	0.0	0.00	0.00	0.00	0.00	
3,000.0	0.00	0.00	3,000.0	0.0	0.0	0.00	0.00	0.00	0.00	
3,435.9	8.72	173.17	3,434.2	-32.9	3.9	2.00	2.00	0.00	173.17	
4,580.7	8.72	173.17	4,565.8	-205.1	24.6	0.00	0.00	0.00	0.00	
5,016.6	0.00	0.00	5,000.0	-238.0	28.5	2.00	-2.00	0.00	180.00	
5,907.7	0.00	0.00	5,891.1	-238.0	28.5	0.00	0.00	0.00	0.00	
6,725.9	90.00	354.53	6,412.0	280.5	-21.1	11.00	11.00	0.00	354.53	
11,202.5	90.00	354.53	6,412.0	4,736.7	-447.7	0.00	0.00	0.00	0.00	BHL 460°FNL & 181°

Database:	Landmark	Local Co-ordinate Reference:	Well PARK T-P-4HZ
Company:	BONANZA CREEK ENERGY OPERATING	TVD Reference:	RKB @ 4640.0ft (ENSIGN RIG 128 KB 15')
Project:	SEC.4-T4N-R63W	MD Reference:	RKB @ 4640.0ft (ENSIGN RIG 128 KB 15')
Site:	PARK T-P-4HHZ PAD SEC.4- 4N-63W	North Reference:	True
Well:	PARK T-P-4HZ	Survey Calculation Method:	Minimum Curvature
Wellbore:	Wellbore #1		
Design:	PLAN 2 (MAR 12, 2012) PROG 3-5-12		

Planned Survey									
Measured Depth (ft)	Inclination (°)	Azimuth (°)	Vertical Depth (ft)	+N/-S (ft)	+E/-W (ft)	Vertical Section (ft)	Dogleg Rate (°/100ft)	Build Rate (°/100ft)	Turn Rate (°/100ft)
0.0	0.00	0.00	0.0	0.0	0.0	0.0	0.00	0.00	0.00
100.0	0.00	0.00	100.0	0.0	0.0	0.0	0.00	0.00	0.00
200.0	0.00	0.00	200.0	0.0	0.0	0.0	0.00	0.00	0.00
300.0	0.00	0.00	300.0	0.0	0.0	0.0	0.00	0.00	0.00
400.0	0.00	0.00	400.0	0.0	0.0	0.0	0.00	0.00	0.00
500.0	0.00	0.00	500.0	0.0	0.0	0.0	0.00	0.00	0.00
600.0	0.00	0.00	600.0	0.0	0.0	0.0	0.00	0.00	0.00
700.0	0.00	0.00	700.0	0.0	0.0	0.0	0.00	0.00	0.00
800.0	0.00	0.00	800.0	0.0	0.0	0.0	0.00	0.00	0.00
900.0	0.00	0.00	900.0	0.0	0.0	0.0	0.00	0.00	0.00
1,000.0	0.00	0.00	1,000.0	0.0	0.0	0.0	0.00	0.00	0.00
1,100.0	0.00	0.00	1,100.0	0.0	0.0	0.0	0.00	0.00	0.00
1,200.0	0.00	0.00	1,200.0	0.0	0.0	0.0	0.00	0.00	0.00
1,300.0	0.00	0.00	1,300.0	0.0	0.0	0.0	0.00	0.00	0.00
1,400.0	0.00	0.00	1,400.0	0.0	0.0	0.0	0.00	0.00	0.00
1,500.0	0.00	0.00	1,500.0	0.0	0.0	0.0	0.00	0.00	0.00
1,600.0	0.00	0.00	1,600.0	0.0	0.0	0.0	0.00	0.00	0.00
1,700.0	0.00	0.00	1,700.0	0.0	0.0	0.0	0.00	0.00	0.00
1,800.0	0.00	0.00	1,800.0	0.0	0.0	0.0	0.00	0.00	0.00
1,900.0	0.00	0.00	1,900.0	0.0	0.0	0.0	0.00	0.00	0.00
2,000.0	0.00	0.00	2,000.0	0.0	0.0	0.0	0.00	0.00	0.00
2,100.0	0.00	0.00	2,100.0	0.0	0.0	0.0	0.00	0.00	0.00
2,200.0	0.00	0.00	2,200.0	0.0	0.0	0.0	0.00	0.00	0.00
2,300.0	0.00	0.00	2,300.0	0.0	0.0	0.0	0.00	0.00	0.00
2,400.0	0.00	0.00	2,400.0	0.0	0.0	0.0	0.00	0.00	0.00
2,500.0	0.00	0.00	2,500.0	0.0	0.0	0.0	0.00	0.00	0.00
2,600.0	0.00	0.00	2,600.0	0.0	0.0	0.0	0.00	0.00	0.00
2,700.0	0.00	0.00	2,700.0	0.0	0.0	0.0	0.00	0.00	0.00
2,800.0	0.00	0.00	2,800.0	0.0	0.0	0.0	0.00	0.00	0.00
2,900.0	0.00	0.00	2,900.0	0.0	0.0	0.0	0.00	0.00	0.00
3,000.0	0.00	0.00	3,000.0	0.0	0.0	0.0	0.00	0.00	0.00
KOP 1									
3,100.0	2.00	173.17	3,100.0	-1.7	0.2	-1.7	2.00	2.00	0.00
3,200.0	4.00	173.17	3,199.8	-6.9	0.8	-7.0	2.00	2.00	0.00
3,300.0	6.00	173.17	3,299.5	-15.6	1.9	-15.7	2.00	2.00	0.00
3,400.0	8.00	173.17	3,398.7	-27.7	3.3	-27.9	2.00	2.00	0.00
3,405.4	8.11	173.17	3,404.0	-28.4	3.4	-28.6	2.00	2.00	0.00
PARKMAN									
3,435.9	8.72	173.17	3,434.2	-32.9	3.9	-33.1	2.00	2.00	0.00
3,500.0	8.72	173.17	3,497.6	-42.5	5.1	-42.8	0.00	0.00	0.00
3,600.0	8.72	173.17	3,596.4	-57.6	6.9	-58.0	0.00	0.00	0.00
3,700.0	8.72	173.17	3,695.3	-72.6	8.7	-73.1	0.00	0.00	0.00
3,800.0	8.72	173.17	3,794.1	-87.7	10.5	-88.3	0.00	0.00	0.00
3,900.0	8.72	173.17	3,893.0	-102.7	12.3	-103.4	0.00	0.00	0.00
4,000.0	8.72	173.17	3,991.8	-117.8	14.1	-118.6	0.00	0.00	0.00
4,091.3	8.72	173.17	4,082.0	-131.5	15.7	-132.4	0.00	0.00	0.00
SUSSEX									
4,100.0	8.72	173.17	4,090.6	-132.8	15.9	-133.7	0.00	0.00	0.00
4,200.0	8.72	173.17	4,189.5	-147.8	17.7	-148.9	0.00	0.00	0.00
4,300.0	8.72	173.17	4,288.3	-162.9	19.5	-164.0	0.00	0.00	0.00
4,400.0	8.72	173.17	4,387.2	-177.9	21.3	-179.2	0.00	0.00	0.00
4,500.0	8.72	173.17	4,486.0	-193.0	23.1	-194.3	0.00	0.00	0.00
4,580.7	8.72	173.17	4,565.8	-205.1	24.6	-206.5	0.00	0.00	0.00

Database:	Landmark	Local Co-ordinate Reference:	Well PARK T-P-4HZ
Company:	BONANZA CREEK ENERGY OPERATING	TVD Reference:	RKB @ 4640.0ft (ENSIGN RIG 128 KB 15')
Project:	SEC.4-T4N-R63W	MD Reference:	RKB @ 4640.0ft (ENSIGN RIG 128 KB 15')
Site:	PARK T-P-4HHZ PAD SEC.4- 4N-63W	North Reference:	True
Well:	PARK T-P-4HZ	Survey Calculation Method:	Minimum Curvature
Wellbore:	Wellbore #1		
Design:	PLAN 2 (MAR 12, 2012) PROG 3-5-12		

Planned Survey									
Measured Depth (ft)	Inclination (°)	Azimuth (°)	Vertical Depth (ft)	+N/-S (ft)	+E/-W (ft)	Vertical Section (ft)	Dogleg Rate (°/100ft)	Build Rate (°/100ft)	Turn Rate (°/100ft)
4,600.0	8.33	173.17	4,584.9	-208.0	24.9	-209.4	2.00	-2.00	0.00
4,700.0	6.33	173.17	4,684.1	-220.6	26.4	-222.2	2.00	-2.00	0.00
4,800.0	4.33	173.17	4,783.6	-229.9	27.5	-231.4	2.00	-2.00	0.00
4,900.0	2.33	173.17	4,883.4	-235.6	28.2	-237.3	2.00	-2.00	0.00
5,000.0	0.33	173.17	4,983.4	-238.0	28.5	-239.6	2.00	-2.00	0.00
5,016.6	0.00	0.00	5,000.0	-238.0	28.5	-239.6	2.00	-2.00	0.00
5,100.0	0.00	0.00	5,083.4	-238.0	28.5	-239.6	0.00	0.00	0.00
5,200.0	0.00	0.00	5,183.4	-238.0	28.5	-239.6	0.00	0.00	0.00
5,300.0	0.00	0.00	5,283.4	-238.0	28.5	-239.6	0.00	0.00	0.00
5,400.0	0.00	0.00	5,383.4	-238.0	28.5	-239.6	0.00	0.00	0.00
5,500.0	0.00	0.00	5,483.4	-238.0	28.5	-239.6	0.00	0.00	0.00
5,600.0	0.00	0.00	5,583.4	-238.0	28.5	-239.6	0.00	0.00	0.00
5,700.0	0.00	0.00	5,683.4	-238.0	28.5	-239.6	0.00	0.00	0.00
5,800.0	0.00	0.00	5,783.4	-238.0	28.5	-239.6	0.00	0.00	0.00
5,900.0	0.00	0.00	5,883.4	-238.0	28.5	-239.6	0.00	0.00	0.00
5,907.7	0.00	0.00	5,891.1	-238.0	28.5	-239.6	0.00	0.00	0.00
5,914.0	0.69	354.53	5,897.4	-238.0	28.5	-239.6	11.00	11.00	0.00
KOP 2									
6,000.0	10.15	354.53	5,982.9	-229.9	27.7	-231.5	11.00	11.00	0.00
6,100.0	21.15	354.53	6,079.1	-203.1	25.2	-204.5	11.00	11.00	0.00
6,200.0	32.15	354.53	6,168.3	-158.5	20.9	-159.7	11.00	11.00	0.00
6,272.7	40.15	354.53	6,227.0	-115.8	16.8	-116.9	11.00	11.00	0.00
SHARON SPRINGS									
6,300.0	43.15	354.53	6,247.4	-97.8	15.1	-98.8	11.00	11.00	0.00
6,400.0	54.15	354.53	6,313.3	-23.2	7.9	-23.8	11.00	11.00	0.00
6,411.6	55.42	354.53	6,320.0	-13.7	7.0	-14.3	11.00	11.00	0.00
NIOBRARA A CHALK									
6,429.6	57.41	354.53	6,330.0	1.2	5.6	0.7	11.00	11.00	0.00
NIOBRARA A MARL									
6,500.0	65.15	354.53	6,363.8	62.6	-0.3	62.4	11.00	11.00	0.00
6,588.6	74.89	354.53	6,394.0	145.4	-8.2	145.5	11.00	11.00	0.00
NIOBRARA B CHALK									
6,600.0	76.15	354.53	6,396.9	156.4	-9.2	156.6	11.00	11.00	0.00
6,700.0	87.15	354.53	6,411.4	254.7	-18.7	255.4	11.00	11.00	0.00
6,725.9	90.00	354.53	6,412.0	280.5	-21.1	281.2	11.00	11.00	0.00
NIOBRARA B TARGET - NIOBRARA B MARL									
6,732.0	90.00	354.53	6,412.0	286.6	-21.7	287.3	0.00	0.00	0.00
7"									
6,800.0	90.00	354.53	6,412.0	354.3	-28.2	355.3	0.00	0.00	0.00
6,900.0	90.00	354.53	6,412.0	453.8	-37.7	455.3	0.00	0.00	0.00
7,000.0	90.00	354.53	6,412.0	553.4	-47.2	555.3	0.00	0.00	0.00
7,100.0	90.00	354.53	6,412.0	652.9	-56.8	655.3	0.00	0.00	0.00
7,200.0	90.00	354.53	6,412.0	752.4	-66.3	755.3	0.00	0.00	0.00
7,300.0	90.00	354.53	6,412.0	852.0	-75.8	855.3	0.00	0.00	0.00
7,400.0	90.00	354.53	6,412.0	951.5	-85.4	955.3	0.00	0.00	0.00
7,500.0	90.00	354.53	6,412.0	1,051.1	-94.9	1,055.3	0.00	0.00	0.00
7,600.0	90.00	354.53	6,412.0	1,150.6	-104.4	1,155.3	0.00	0.00	0.00
7,700.0	90.00	354.53	6,412.0	1,250.2	-113.9	1,255.3	0.00	0.00	0.00
7,800.0	90.00	354.53	6,412.0	1,349.7	-123.5	1,355.3	0.00	0.00	0.00
7,900.0	90.00	354.53	6,412.0	1,449.3	-133.0	1,455.3	0.00	0.00	0.00
8,000.0	90.00	354.53	6,412.0	1,548.8	-142.5	1,555.3	0.00	0.00	0.00
8,100.0	90.00	354.53	6,412.0	1,648.4	-152.1	1,655.3	0.00	0.00	0.00
8,200.0	90.00	354.53	6,412.0	1,747.9	-161.6	1,755.3	0.00	0.00	0.00

Database:	Landmark	Local Co-ordinate Reference:	Well PARK T-P-4HZ
Company:	BONANZA CREEK ENERGY OPERATING	TVD Reference:	RKB @ 4640.0ft (ENSIGN RIG 128 KB 15')
Project:	SEC.4-T4N-R63W	MD Reference:	RKB @ 4640.0ft (ENSIGN RIG 128 KB 15')
Site:	PARK T-P-4HHZ PAD SEC.4- 4N-63W	North Reference:	True
Well:	PARK T-P-4HZ	Survey Calculation Method:	Minimum Curvature
Wellbore:	Wellbore #1		
Design:	PLAN 2 (MAR 12, 2012) PROG 3-5-12		

Planned Survey										
Measured Depth (ft)	Inclination (°)	Azimuth (°)	Vertical Depth (ft)	+N/-S (ft)	+E/-W (ft)	Vertical Section (ft)	Dogleg Rate (°/100ft)	Build Rate (°/100ft)	Turn Rate (°/100ft)	
8,300.0	90.00	354.53	6,412.0	1,847.4	-171.1	1,855.3	0.00	0.00	0.00	
8,400.0	90.00	354.53	6,412.0	1,947.0	-180.6	1,955.3	0.00	0.00	0.00	
8,500.0	90.00	354.53	6,412.0	2,046.5	-190.2	2,055.3	0.00	0.00	0.00	
8,600.0	90.00	354.53	6,412.0	2,146.1	-199.7	2,155.3	0.00	0.00	0.00	
8,700.0	90.00	354.53	6,412.0	2,245.6	-209.2	2,255.3	0.00	0.00	0.00	
8,800.0	90.00	354.53	6,412.0	2,345.2	-218.7	2,355.3	0.00	0.00	0.00	
8,900.0	90.00	354.53	6,412.0	2,444.7	-228.3	2,455.3	0.00	0.00	0.00	
9,000.0	90.00	354.53	6,412.0	2,544.3	-237.8	2,555.3	0.00	0.00	0.00	
9,100.0	90.00	354.53	6,412.0	2,643.8	-247.3	2,655.3	0.00	0.00	0.00	
9,200.0	90.00	354.53	6,412.0	2,743.4	-256.9	2,755.3	0.00	0.00	0.00	
9,300.0	90.00	354.53	6,412.0	2,842.9	-266.4	2,855.3	0.00	0.00	0.00	
9,400.0	90.00	354.53	6,412.0	2,942.4	-275.9	2,955.3	0.00	0.00	0.00	
9,500.0	90.00	354.53	6,412.0	3,042.0	-285.4	3,055.3	0.00	0.00	0.00	
9,600.0	90.00	354.53	6,412.0	3,141.5	-295.0	3,155.3	0.00	0.00	0.00	
9,700.0	90.00	354.53	6,412.0	3,241.1	-304.5	3,255.3	0.00	0.00	0.00	
9,800.0	90.00	354.53	6,412.0	3,340.6	-314.0	3,355.3	0.00	0.00	0.00	
9,900.0	90.00	354.53	6,412.0	3,440.2	-323.6	3,455.3	0.00	0.00	0.00	
10,000.0	90.00	354.53	6,412.0	3,539.7	-333.1	3,555.3	0.00	0.00	0.00	
10,100.0	90.00	354.53	6,412.0	3,639.3	-342.6	3,655.3	0.00	0.00	0.00	
10,200.0	90.00	354.53	6,412.0	3,738.8	-352.1	3,755.3	0.00	0.00	0.00	
10,300.0	90.00	354.53	6,412.0	3,838.3	-361.7	3,855.3	0.00	0.00	0.00	
10,400.0	90.00	354.53	6,412.0	3,937.9	-371.2	3,955.3	0.00	0.00	0.00	
10,500.0	90.00	354.53	6,412.0	4,037.4	-380.7	4,055.3	0.00	0.00	0.00	
10,600.0	90.00	354.53	6,412.0	4,137.0	-390.2	4,155.3	0.00	0.00	0.00	
10,700.0	90.00	354.53	6,412.0	4,236.5	-399.8	4,255.3	0.00	0.00	0.00	
10,800.0	90.00	354.53	6,412.0	4,336.1	-409.3	4,355.3	0.00	0.00	0.00	
10,900.0	90.00	354.53	6,412.0	4,435.6	-418.8	4,455.3	0.00	0.00	0.00	
11,000.0	90.00	354.53	6,412.0	4,535.2	-428.4	4,555.3	0.00	0.00	0.00	
11,100.0	90.00	354.53	6,412.0	4,634.7	-437.9	4,655.3	0.00	0.00	0.00	
11,200.0	90.00	354.53	6,412.0	4,734.3	-447.4	4,755.3	0.00	0.00	0.00	
11,202.5	90.00	354.53	6,412.0	4,736.7	-447.7	4,757.8	0.00	0.00	0.00	

Casing Points					
Measured Depth (ft)	Vertical Depth (ft)	Name	Casing Diameter (")	Hole Diameter (")	
6,732.0	6,412.0	7"	7	8-3/4	

Database:	Landmark	Local Co-ordinate Reference:	Well PARK T-P-4HZ
Company:	BONANZA CREEK ENERGY OPERATING	TVD Reference:	RKB @ 4640.0ft (ENSIGN RIG 128 KB 15')
Project:	SEC.4-T4N-R63W	MD Reference:	RKB @ 4640.0ft (ENSIGN RIG 128 KB 15')
Site:	PARK T-P-4HHZ PAD SEC.4- 4N-63W	North Reference:	True
Well:	PARK T-P-4HZ	Survey Calculation Method:	Minimum Curvature
Wellbore:	Wellbore #1		
Design:	PLAN 2 (MAR 12, 2012) PROG 3-5-12		

Formations					
Measured Depth (ft)	Vertical Depth (ft)	Name	Lithology	Dip (°)	Dip Direction (°)
3,405.4	3,404.0	PARKMAN		0.00	
4,091.3	4,082.0	SUSSEX		0.00	
6,272.7	6,227.0	SHARON SPRINGS		0.00	
6,411.6	6,320.0	NIOBRARA A CHALK		0.00	
6,429.6	6,330.0	NIOBRARA A MARL		0.00	
6,588.6	6,394.0	NIOBRARA B CHALK		0.00	
6,725.9	6,412.0	NIOBRARA B TARGET		0.00	
6,725.9	6,412.0	NIOBRARA B MARL		0.00	
	6,452.0	NIOBRARA C CHALK		0.00	

Plan Annotations				
Measured Depth (ft)	Vertical Depth (ft)	Local Coordinates		Comment
		+N/-S (ft)	+E/-W (ft)	
3,000.0	3,000.0	0.0	0.0	KOP 1
5,914.0	5,897.6	-238.0	18.0	KOP 2



Directional

BONANZA CREEK ENERGY OPERATING

SEC.4-T4N-R63W

PARK T-P-4HHZ PAD SEC.4- 4N-63W

PARK T-P-4HZ

Wellbore #1

PLAN 2 (MAR 12, 2012) PROG 3-5-12

Anticollision Summary Report

12 March, 2012

Company:	BONANZA CREEK ENERGY OPERATING	Local Co-ordinate Reference:	Well PARK T-P-4HZ
Project:	SEC.4-T4N-R63W	TVD Reference:	RKB @ 4640.0ft (ENSIGN RIG 128 KB 15')
Reference Site:	PARK T-P-4HHZ PAD SEC.4- 4N-63W	MD Reference:	RKB @ 4640.0ft (ENSIGN RIG 128 KB 15')
Site Error:	0.0ft	North Reference:	True
Reference Well:	PARK T-P-4HZ	Survey Calculation Method:	Minimum Curvature
Well Error:	0.0ft	Output errors are at	2.00 sigma
Reference Wellbore	Wellbore #1	Database:	Landmark
Reference Design:	PLAN 2 (MAR 12, 2012) PROG 3-5-12	Offset TVD Reference:	Offset Datum

Reference	PLAN 2 (MAR 12, 2012) PROG 3-5-		
Filter type:	NO GLOBAL FILTER: Using user defined selection & filtering criteria		
Interpolation Method:	MD Interval 100.0ft	Error Model:	ISCWSA
Depth Range:	Unlimited	Scan Method:	Closest Approach 3D
Results Limited by:	Maximum center-center distance of 1,500.0ft	Error Surface:	Elliptical Conic
Warning Levels Evaluated at:	2.00 Sigma		

Survey Tool Program	Date 3/12/2012			
From (ft)	To (ft)	Survey (Wellbore)	Tool Name	Description
0.0	11,202.5	PLAN 2 (MAR 12, 2012) PROG 3-5-12 (W	MWD	MWD - Standard

Summary						
Site Name	Reference Measured Depth (ft)	Offset Measured Depth (ft)	Distance Between Centres (ft)	Distance Between Ellipses (ft)	Separation Factor	Warning
Offset Well - Wellbore - Design						
Latham 41-4 Pad Sec.4-T4N-R63W						
Latham 41-4 (Vert.) - Wellbore #1 - Design #1	11,061.5	6,320.7	1,335.9	1,229.1	12.508 CC	
Latham 41-4 (Vert.) - Wellbore #1 - Design #1	11,100.0	6,320.7	1,336.4	1,228.9	12.427 ES	
Latham 41-4 (Vert.) - Wellbore #1 - Design #1	11,202.5	6,320.7	1,343.3	1,233.8	12.263 SF	
North Platte 34-33 - Wellbore #1 - Wellbore #1	11,202.5	6,581.4	1,177.7	1,055.2	9.611 CC, ES, SF	
North Platte 44-33 - Wellbore #1 - Wellbore #1						Out of range

Company:	BONANZA CREEK ENERGY OPERATING	Local Co-ordinate Reference:	Well PARK T-P-4HZ
Project:	SEC.4-T4N-R63W	TVD Reference:	RKB @ 4640.0ft (ENSIGN RIG 128 KB 15')
Reference Site:	PARK T-P-4HHZ PAD SEC.4- 4N-63W	MD Reference:	RKB @ 4640.0ft (ENSIGN RIG 128 KB 15')
Site Error:	0.0ft	North Reference:	True
Reference Well:	PARK T-P-4HZ	Survey Calculation Method:	Minimum Curvature
Well Error:	0.0ft	Output errors are at	2.00 sigma
Reference Wellbore	Wellbore #1	Database:	Landmark
Reference Design:	PLAN 2 (MAR 12, 2012) PROG 3-5-12	Offset TVD Reference:	Offset Datum

Reference Depths are relative to RKB @ 4640.0ft (ENSIGN RIG 128 KCoordinates are relative to: PARK T-P-4HZ
Offset Depths are relative to Offset Datum
Central Meridian is -105.500000 °
Coordinate System is US State Plane 1983, Colorado Northern Zone
Grid Convergence at Surface is: 0.69°

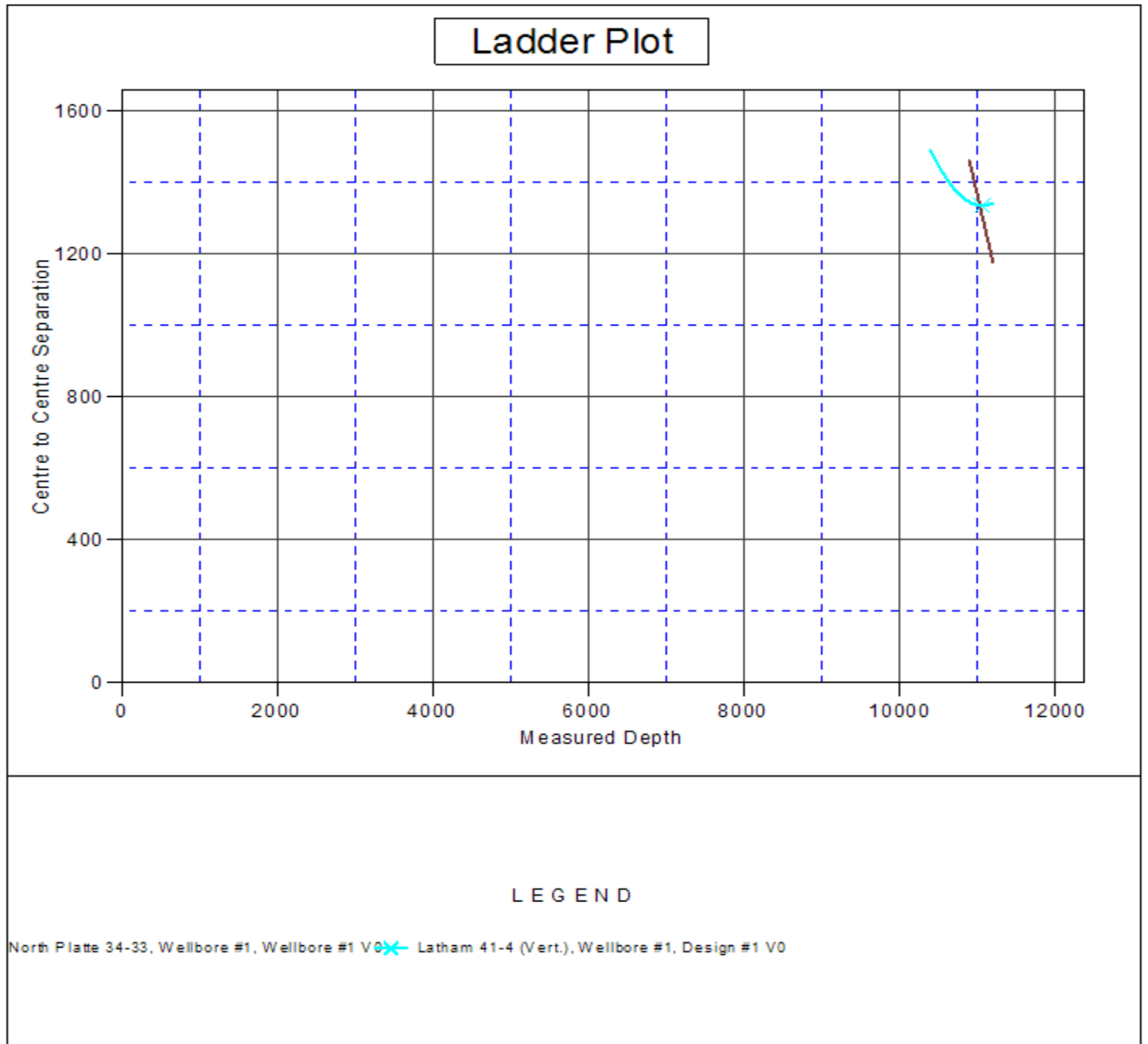

Company:	BONANZA CREEK ENERGY OPERATING	Local Co-ordinate Reference:	Well PARK T-P-4HZ
Project:	SEC.4-T4N-R63W	TVD Reference:	RKB @ 4640.0ft (ENSIGN RIG 128 KB 15')
Reference Site:	PARK T-P-4HHZ PAD SEC.4- 4N-63W	MD Reference:	RKB @ 4640.0ft (ENSIGN RIG 128 KB 15')
Site Error:	0.0ft	North Reference:	True
Reference Well:	PARK T-P-4HZ	Survey Calculation Method:	Minimum Curvature
Well Error:	0.0ft	Output errors are at	2.00 sigma
Reference Wellbore	Wellbore #1	Database:	Landmark
Reference Design:	PLAN 2 (MAR 12, 2012) PROG 3-5-12	Offset TVD Reference:	Offset Datum

Reference Depths are relative to RKB @ 4640.0ft (ENSIGN RIG 128 KCoordinates are relative to: PARK T-P-4HZ
Offset Depths are relative to Offset Datum Coordinate System is US State Plane 1983, Colorado Northern Zone
Central Meridian is -105.500000 ° Grid Convergence at Surface is: 0.69°

