



Lat40°, Inc. 1635 Foxtrail Drive, Suite 325 Loveland, CO 970-776-3321

# LOCATION DRAWING

ESTERLING 44-33H

SECTION: 33  
TOWNSHIP: 6N  
RANGE: 61W



IMPROVEMENTS:

A FIELD ROAD 330' SOUTH

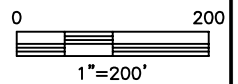

NEAREST: BUILDING 4950' N, PUBLIC ROAD 4700' W,  
ABOVE GROUND UTILITY 5200' N, RAILROAD 5280'+, PROPERTY LINE 300' SOUTH

DATE: 2/3/12  
PROJECT#: 2012008



# CUT & FILL DIAGRAM

ESTERLING 44-33H

SECTION: 33  
TOWNSHIP: 6N  
RANGE: 61W

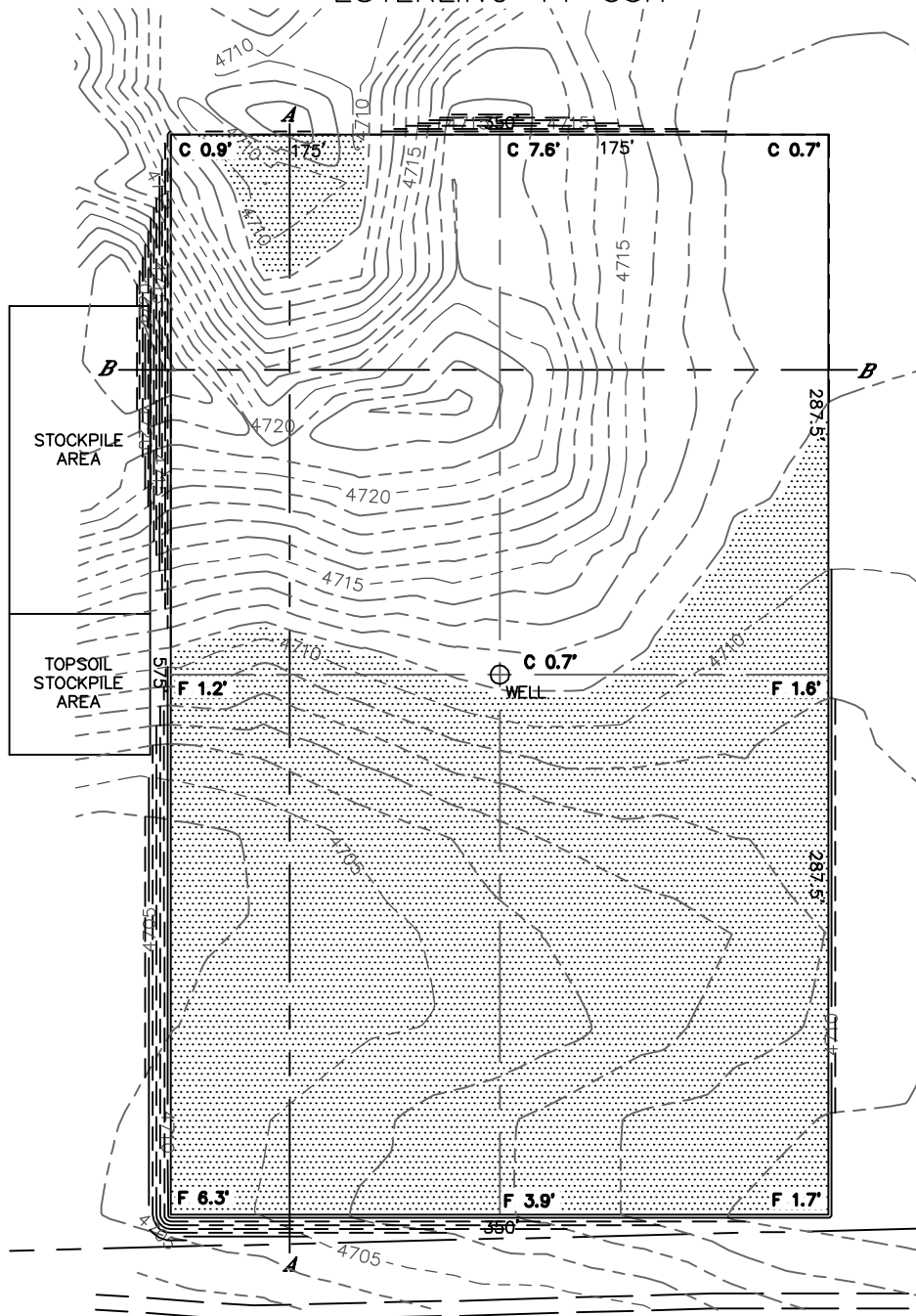

**OPERATOR: BILL BARRETT CORPORATION**  
**LOCATION: 300 FSL, 600 FEL**  
**EXISTING ELEV=4711.5'**  
**PROPOSED ELEV=4710.8'**  
**DISTURBANCE= 4.9 ACRES**

**ESTIMATED EARTHWORK:**  
**TOPSOIL= 7,454 CY**  
**CUT= 16,272 CY**  
**FILL= 16,262 CY**  
**EXCESS= 10 CY**

**NOTE:**

- 1) Ground elevations are based on an observed GPS elevation (NAVD 1988 DATUM).
- 2) No allowance has been made for soil expansion or compaction
- 3) Proposed elevation does not account for top soil removal.
- 4) Top soil volume assumes 12" depth across entire location.
- 5) Fill slopes 2:1
- 6) Cut slopes 1.5:1

**LEGEND**

EX. CONTOUR	---
PRO. CONTOUR	- - -
FILL AREA	▒



DATE: 2/3/12  
PROJECT#: 2012008



# CROSS SECTION DIAGRAM

ESTERLING 44-33H

SECTION: 33  
TOWNSHIP: 6N  
RANGE: 61W

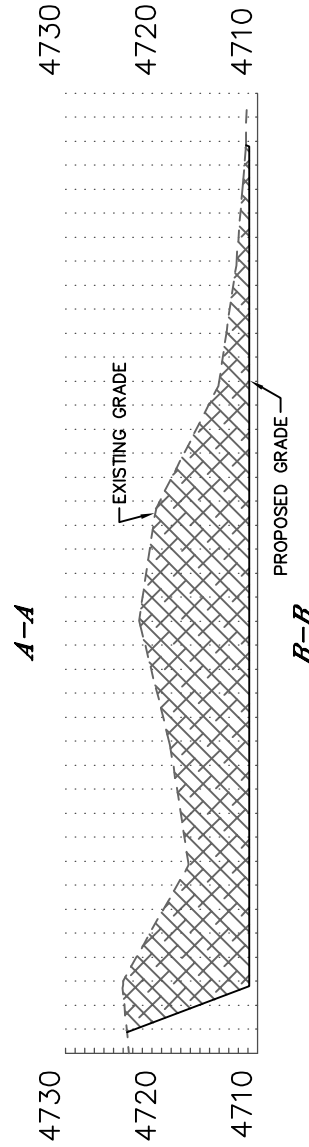
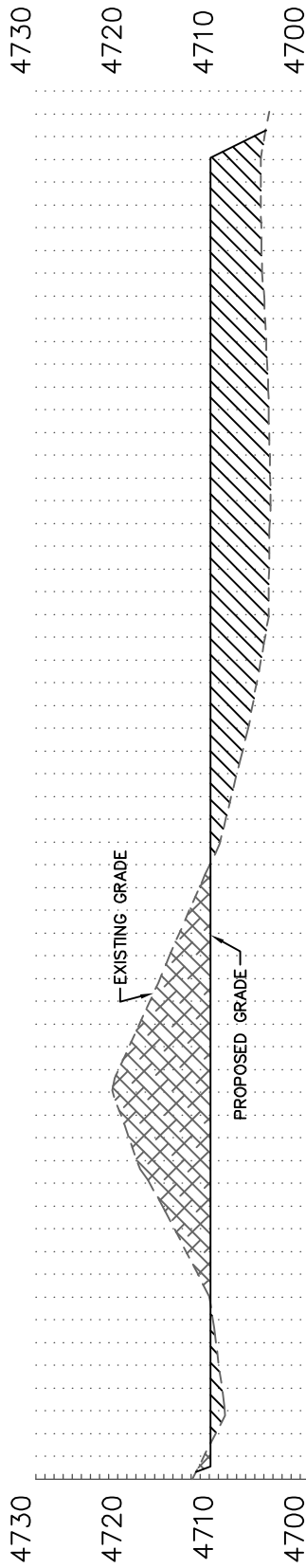

HORIZONTAL SCALE: 1"=80', VERTICAL SCALE: 1"=20'