

SWEPI LP
CONSTRUCTION LAYOUT FOR
DEAL GULCH #1-16
SECTION 16, T5N, R90W, 6th P.M.
2157' FNL 2465' FEL

FIGURE #1

SCALE: 1" = 50'
DATE: 12-05-11
DRAWN BY: J.I.
REV.: 02-08-12

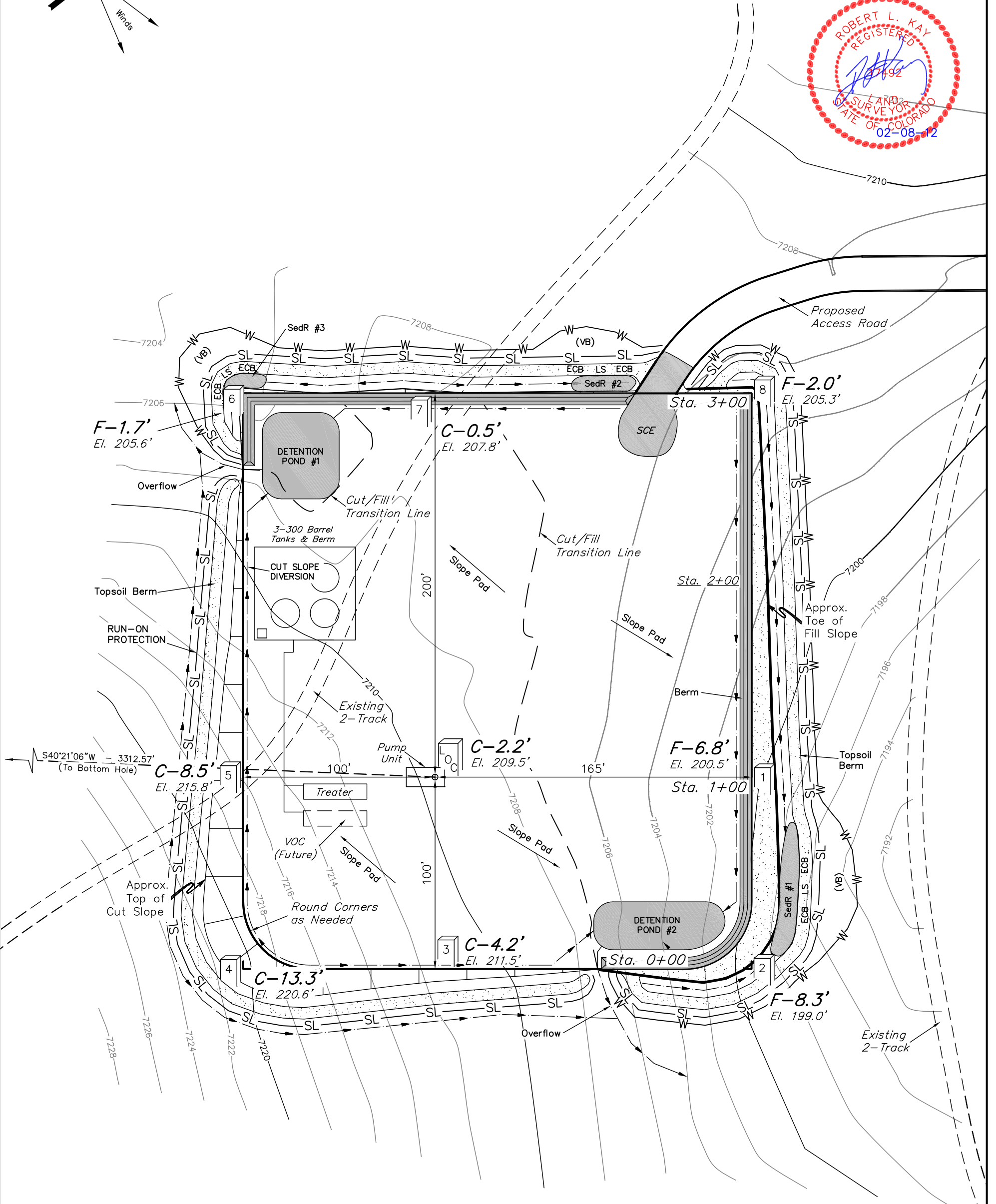

- SWMP LEGEND:**
ECB - EROSION CONTROL BLANKET
LS - LEVEL SPREADER
SCE - STABILIZED CONSTRUCTION ENTRANCE
SedR - SEDIMENT RESERVOIR
SL - SLASH
VB - VEGETATED BUFFER
W - WATTLE

Elev. Ungraded Ground At Loc. Stake = 7209.5'
FINISHED GRADE ELEV. AT LOC. STAKE = 7207.3'

1" = 20'
X-Section
Scale
1" = 50'

DATE: 12-05-11
DRAWN BY: J.I.

SWEPI LP
CONSTRUCTION LAYOUT CROSS SECTIONS FOR
DEAL GULCH #1-16
SECTION 16, T5N, R90W, 6th P.M.
2157' FNL 2465' FEL

FIGURE #2

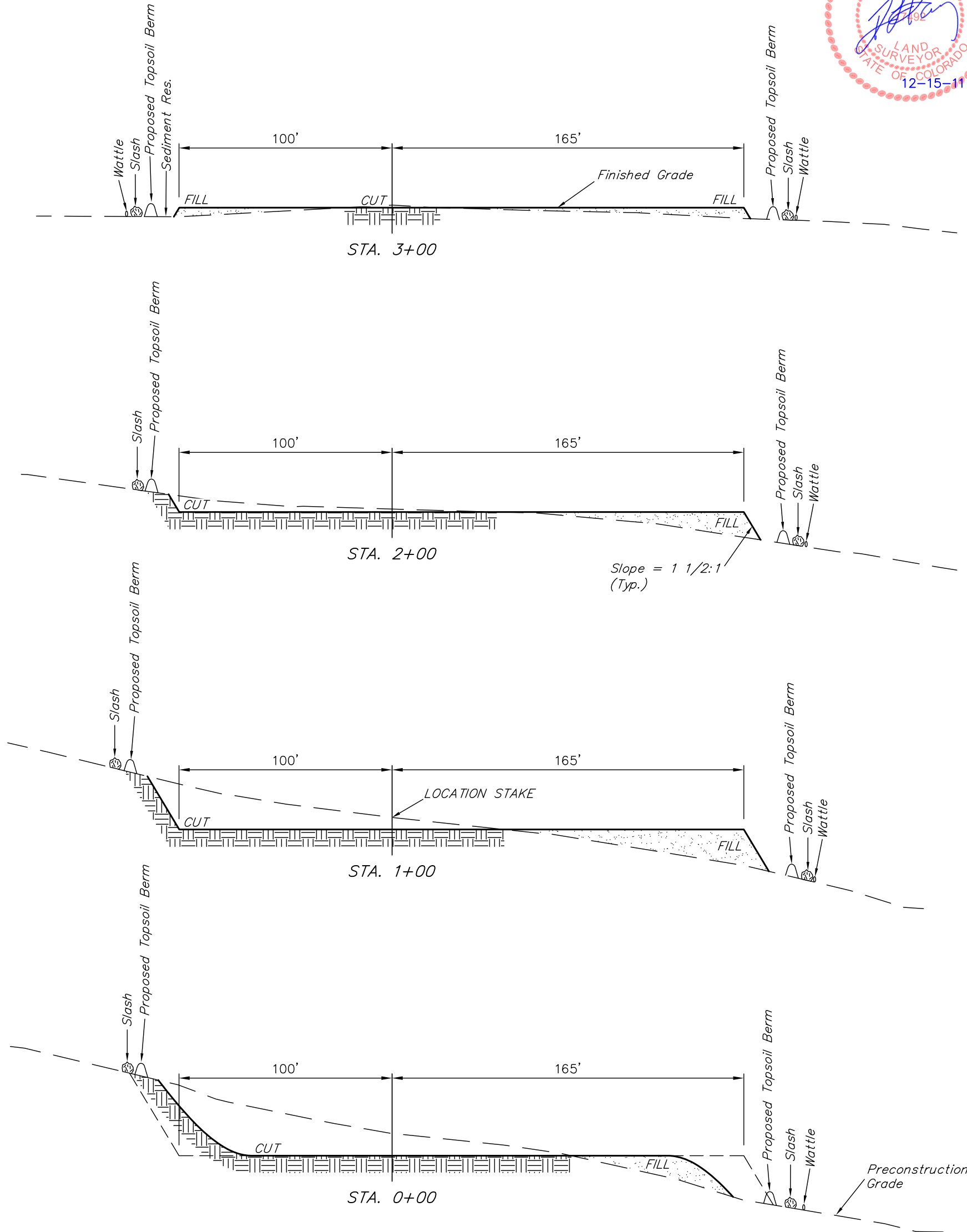

NOTE:
Topsoil should not be
Stripped Below Finished
Grade on Substructure Area.

* NOTE:
FILL QUANTITY INCLUDES
5% FOR COMPACTION

APPROXIMATE YARDAGES

(6") Topsoil Stripping	=	1,650 Cu. Yds.
Remaining Location	=	4,180 Cu. Yds.
TOTAL CUT	=	5,830 CU.YDS.
FILL	=	4,180 CU.YDS.

EXCESS MATERIAL	=	1,650 Cu. Yds.
Topsoil	=	1,650 Cu. Yds.
EXCESS UNBALANCE (After Interim Rehabilitation)	=	0 Cu. Yds.

APPROXIMATE ACREAGES	
WELL SITE DISTURBANCE	= ± 2.005 ACRES
ACCESS ROAD DISTURBANCE	= ± 2.866 ACRES
TOTAL	= ± 4.871 ACRES

UINTAH ENGINEERING & LAND SURVEYING
85 So. 200 East * Vernal, Utah 84078 * (435) 789-1017