

- Ⓢ Well Site
- Located 2" Al Cap
Marked LS 12160

PDOP ≤ 6
 ELEVATION MASK $\geq 15^\circ$

WELL LOCATION FOR:

WELL NO.:

LOCATION:

NATURAL RESOURCE GROUP

LARGO NO. 2

382 FEET FROM THE SOUTH LINE AND 1855 FEET FROM THE EAST LINE OF SECTION 4, TOWNSHIP 34 SOUTH, RANGE 62 WEST OF THE 6th P.M., COUNTY OF LAS ANIMAS, STATE OF COLORADO.

WELL DISTANCES ARE MEASURED PERPENDICULAR TO SECTION LINES.

BEARINGS WERE OBTAINED FROM USING NGS CONTROL STATION "TRINIDAD" (BEING AN ALUMINUM ROD DRIVEN INTO ROCK)

USING PUBLISHED NAD83(1992) DATA.

BY GPS OBSERVATIONS OF THE SOUTH LINE OF THE

SW1/4 SEC 32, T 33 S, R 61 W OF THE 6th P.M.

WHICH BEARS N 89°42'09" E. (BOTH BEING 2" AL CAPS MK'D LS 12160)

ALL BEARINGS ARE RELATIVE THEREOF.

ELEVATION CONTROL WAS FROM GPS OBSERVATIONS REFERENCED TO NAD83.

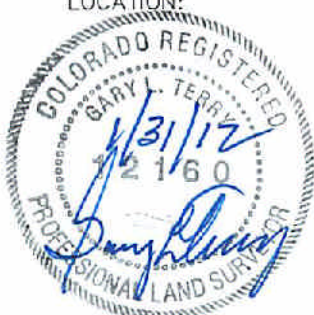

GARY L. TERRY
 P.L.S. 12160

TERRY SURVEYING INC.
 P.O. BOX 851
 TRINIDAD, COLORADO 81082
 (719)846-6921

I GARY L. TERRY HEREBY CERTIFY THAT THIS WELL PLAT IS A
 ACCURATE REPRESENTATION OF A CORRECT SURVEY OF WELL NO.
 LARGO NO. 2

NOTE: THERE ARE NO IMPROVEMENTS WITHIN 200 FEET OF THIS
 WELL SITE.

CURRENT LAND USE: Range land and timber
 DATE SURVEYED: JANUARY 19, 2011