

US ROCKIES REGION PLANNING

COLORADO NORTHERN ZONE - 83

WELD_WEICHEL 3 PAD

WEICHEL 35N-11HZ

WEICHEL 35N-11HZ

Plan: WEICHEL 35N-11HZ (wp01)

Standard Planning Report

05 December, 2011

Azimuths to True North
 Magnetic North: 8.71°
 Magnetic Field
 Strength: 52953.6snT
 Dip Angle: 66.84°
 Date: 12/5/2011
 Model: IGRF2010



Project: COLORADO NORTHERN ZONE - 83
Site: WELD WEICHEL 3 PAD
Well: WEICHEL 35N-11HZ
Wellbore: WEICHEL 35N-11HZ
Section:
SHL:
Design: WEICHEL 35N-11HZ (wp01)
Latitude: 40.132278
Longitude: -104.639361
GL: 4893.00
KB: RKB + GL @ 4910.00ft

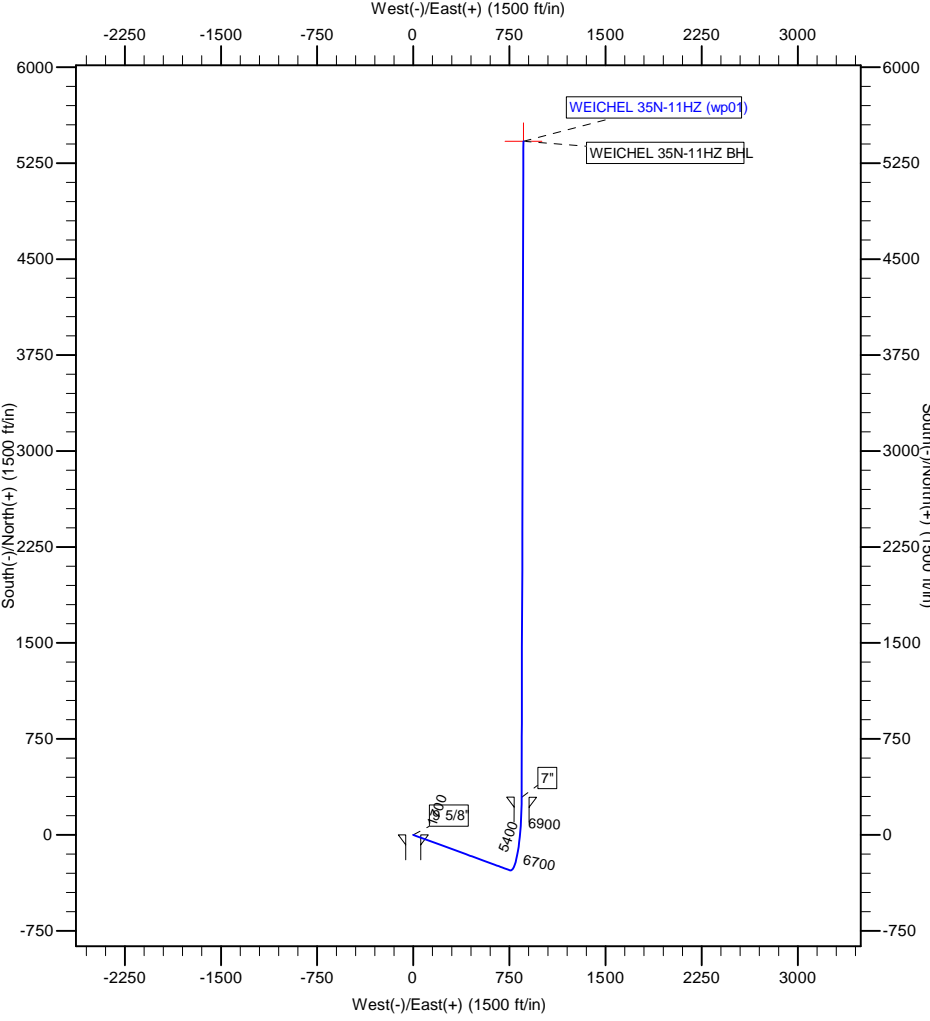

WELL DETAILS: WEICHEL 35N-11HZ						
+N-S	+E-W	Northing	Ground Level: Easting	4893.00	Latitude	Longitude
0.00	0.00	1292200.37	3240639.66	40.132278	-104.639361	Slot

SECTION DETAILS									
MD	Inc	Azi	TVD	+N-S	+E-W	Dleg	TFace	VSect	
0.00	0.00	0.00	0.00	0.00	0.00	0.00	0.00	0.00	
1100.00	0.00	0.00	1100.00	0.00	0.00	0.00	0.00	0.00	
1555.71	9.11	110.18	1553.79	-12.47	33.95	2.00	110.18	-7.01	
6395.72	9.11	110.18	6332.69	-276.89	753.58	0.00	0.00	-155.63	
7326.83	90.00	0.14	6930.00	295.00	845.00	10.00	-109.80	423.53	
7436.44	90.00	0.15	6930.00	404.60	845.28	0.01	90.00	531.83	
12453.46	90.00	0.15	6930.00	5421.61	858.50	0.00	0.00	5489.16	

WELLBORE TARGET DETAILS (MAP CO-ORDINATES AND LAT/LONG)							
Name	TVD	+N-S	+E-W	Latitude	Longitude	Shape	Point
WEICHEL 35N-11HZ BHL	6930.00	5421.61	858.50	40.147161	-104.636290	Point	

FORMATION TOP DETAILS		
TVDPath	MDPath	Formation
3919.00	3951.16	PARKAMAN
4301.00	4338.05	SUSSEX
6811.00	6948.65	SHARON SPRINGS
6870.00	7060.76	NIOBRARA A
6915.00	7194.69	NIOBRARA B

CASING DETAILS			
TVD	MD	Name	Size
900.00	900.00	9 5/8"	9-5/8
6930.00	7326.83	7"	7

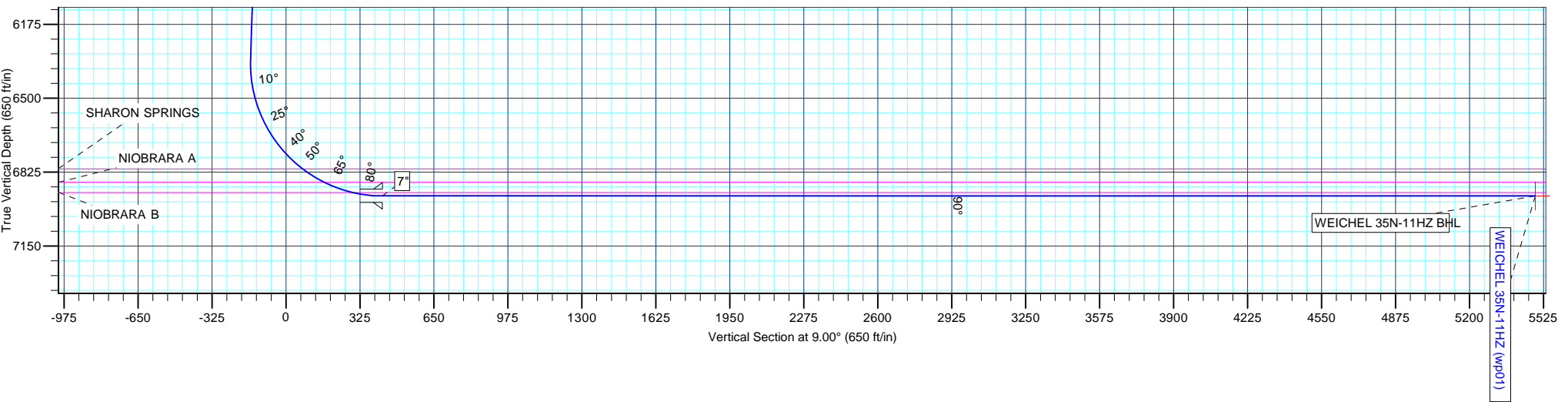

Anadarko Petroleum Corp

Planning Report

Database:	edmp	Local Co-ordinate Reference:	Well WEICHEL 35N-11HZ
Company:	US ROCKIES REGION PLANNING	TVD Reference:	RKB + GL @ 4910.00ft
Project:	COLORADO NORTHERN ZONE - 83	MD Reference:	RKB + GL @ 4910.00ft
Site:	WELD_WEICHEL 3 PAD	North Reference:	True
Well:	WEICHEL 35N-11HZ	Survey Calculation Method:	Minimum Curvature
Wellbore:	WEICHEL 35N-11HZ		
Design:	WEICHEL 35N-11HZ (wp01)		

Project COLORADO NORTHERN ZONE - 83			
Map System:	US State Plane 1983	System Datum:	Mean Sea Level
Geo Datum:	North American Datum 1983		
Map Zone:	Colorado Northern Zone		

Site WELD_WEICHEL 3 PAD					
Site Position:		Northing:	1,292,398.97 usft	Latitude:	40.132701
From:	Lat/Long	Easting:	3,245,181.03 usft	Longitude:	-104.623113
Position Uncertainty:	0.00 ft	Slot Radius:	13-3/16 "	Grid Convergence:	0.57 °

Well WEICHEL 35N-11HZ						
Well Position	+N/-S	-153.68 ft	Northing:	1,292,200.37 usft	Latitude:	40.132278
	+E/-W	-4,543.12 ft	Easting:	3,240,639.66 usft	Longitude:	-104.639361
Position Uncertainty		0.00 ft	Wellhead Elevation:		Ground Level:	4,893.00 ft

Wellbore WEICHEL 35N-11HZ					
Magnetics	Model Name	Sample Date	Declination	Dip Angle	Field Strength
	IGRF2010	12/5/2011	(°)	(°)	(nT)
			8.71	66.84	52,954

Design WEICHEL 35N-11HZ (wp01)				
Audit Notes:				
Version:	Phase:	PLAN	Tie On Depth:	0.00
Vertical Section:	Depth From (TVD)	+N/-S	+E/-W	Direction
	(ft)	(ft)	(ft)	(°)
	0.00	0.00	0.00	9.00

Plan Sections										
Measured Depth (ft)	Inclination (°)	Azimuth (°)	Vertical Depth (ft)	+N/-S (ft)	+E/-W (ft)	Dogleg Rate (°/100usft)	Build Rate (°/100usft)	Turn Rate (°/100usft)	TFO (°)	Target
0.00	0.00	0.00	0.00	0.00	0.00	0.00	0.00	0.00	0.00	
1,100.00	0.00	0.00	1,100.00	0.00	0.00	0.00	0.00	0.00	0.00	
1,555.71	9.11	110.18	1,553.79	-12.47	33.95	2.00	2.00	0.00	110.18	
6,395.72	9.11	110.18	6,332.69	-276.89	753.58	0.00	0.00	0.00	0.00	
7,326.83	90.00	0.14	6,930.00	295.00	845.00	10.00	8.69	-11.82	-109.80	
7,436.44	90.00	0.15	6,930.00	404.60	845.28	0.01	0.00	0.01	90.00	
12,453.46	90.00	0.15	6,930.00	5,421.61	858.50	0.00	0.00	0.00	0.00	WEICHEL 35N-11HZ

Anadarko Petroleum Corp

Planning Report

Database:	edmp	Local Co-ordinate Reference:	Well WEICHEL 35N-11HZ
Company:	US ROCKIES REGION PLANNING	TVD Reference:	RKB + GL @ 4910.00ft
Project:	COLORADO NORTHERN ZONE - 83	MD Reference:	RKB + GL @ 4910.00ft
Site:	WELD_WEICHEL 3 PAD	North Reference:	True
Well:	WEICHEL 35N-11HZ	Survey Calculation Method:	Minimum Curvature
Wellbore:	WEICHEL 35N-11HZ		
Design:	WEICHEL 35N-11HZ (wp01)		

Planned Survey										
Measured Depth (ft)	Inclination (°)	Azimuth (°)	Vertical Depth (ft)	+N/-S (ft)	+E/-W (ft)	Vertical Section (ft)	Dogleg Rate (°/100usft)	Build Rate (°/100usft)	Turn Rate (°/100usft)	
0.00	0.00	0.00	0.00	0.00	0.00	0.00	0.00	0.00	0.00	
100.00	0.00	0.00	100.00	0.00	0.00	0.00	0.00	0.00	0.00	
200.00	0.00	0.00	200.00	0.00	0.00	0.00	0.00	0.00	0.00	
300.00	0.00	0.00	300.00	0.00	0.00	0.00	0.00	0.00	0.00	
400.00	0.00	0.00	400.00	0.00	0.00	0.00	0.00	0.00	0.00	
500.00	0.00	0.00	500.00	0.00	0.00	0.00	0.00	0.00	0.00	
600.00	0.00	0.00	600.00	0.00	0.00	0.00	0.00	0.00	0.00	
700.00	0.00	0.00	700.00	0.00	0.00	0.00	0.00	0.00	0.00	
800.00	0.00	0.00	800.00	0.00	0.00	0.00	0.00	0.00	0.00	
900.00	0.00	0.00	900.00	0.00	0.00	0.00	0.00	0.00	0.00	
9 5/8"										
1,000.00	0.00	0.00	1,000.00	0.00	0.00	0.00	0.00	0.00	0.00	
1,100.00	0.00	0.00	1,100.00	0.00	0.00	0.00	0.00	0.00	0.00	
1,200.00	2.00	110.18	1,199.98	-0.60	1.64	-0.34	2.00	2.00	0.00	
1,300.00	4.00	110.18	1,299.84	-2.41	6.55	-1.35	2.00	2.00	0.00	
1,400.00	6.00	110.18	1,399.45	-5.41	14.73	-3.04	2.00	2.00	0.00	
1,500.00	8.00	110.18	1,498.70	-9.62	26.17	-5.40	2.00	2.00	0.00	
1,555.71	9.11	110.18	1,553.79	-12.47	33.95	-7.01	2.00	2.00	0.00	
1,600.00	9.11	110.18	1,597.52	-14.89	40.54	-8.37	0.00	0.00	0.00	
1,700.00	9.11	110.18	1,696.26	-20.36	55.40	-11.44	0.00	0.00	0.00	
1,800.00	9.11	110.18	1,795.00	-25.82	70.27	-14.51	0.00	0.00	0.00	
1,900.00	9.11	110.18	1,893.73	-31.28	85.14	-17.58	0.00	0.00	0.00	
2,000.00	9.11	110.18	1,992.47	-36.75	100.01	-20.65	0.00	0.00	0.00	
2,100.00	9.11	110.18	2,091.21	-42.21	114.88	-23.72	0.00	0.00	0.00	
2,200.00	9.11	110.18	2,189.95	-47.67	129.74	-26.79	0.00	0.00	0.00	
2,300.00	9.11	110.18	2,288.68	-53.14	144.61	-29.87	0.00	0.00	0.00	
2,400.00	9.11	110.18	2,387.42	-58.60	159.48	-32.94	0.00	0.00	0.00	
2,500.00	9.11	110.18	2,486.16	-64.06	174.35	-36.01	0.00	0.00	0.00	
2,600.00	9.11	110.18	2,584.90	-69.53	189.22	-39.08	0.00	0.00	0.00	
2,700.00	9.11	110.18	2,683.63	-74.99	204.09	-42.15	0.00	0.00	0.00	
2,800.00	9.11	110.18	2,782.37	-80.45	218.95	-45.22	0.00	0.00	0.00	
2,900.00	9.11	110.18	2,881.11	-85.92	233.82	-48.29	0.00	0.00	0.00	
3,000.00	9.11	110.18	2,979.85	-91.38	248.69	-51.36	0.00	0.00	0.00	
3,100.00	9.11	110.18	3,078.58	-96.84	263.56	-54.43	0.00	0.00	0.00	
3,200.00	9.11	110.18	3,177.32	-102.30	278.43	-57.50	0.00	0.00	0.00	
3,300.00	9.11	110.18	3,276.06	-107.77	293.30	-60.57	0.00	0.00	0.00	
3,400.00	9.11	110.18	3,374.80	-113.23	308.16	-63.64	0.00	0.00	0.00	
3,500.00	9.11	110.18	3,473.53	-118.69	323.03	-66.71	0.00	0.00	0.00	
3,600.00	9.11	110.18	3,572.27	-124.16	337.90	-69.78	0.00	0.00	0.00	
3,700.00	9.11	110.18	3,671.01	-129.62	352.77	-72.85	0.00	0.00	0.00	
3,800.00	9.11	110.18	3,769.75	-135.08	367.64	-75.92	0.00	0.00	0.00	
3,900.00	9.11	110.18	3,868.48	-140.55	382.51	-78.99	0.00	0.00	0.00	
3,951.16	9.11	110.18	3,919.00	-143.34	390.11	-80.57	0.00	0.00	0.00	
PARKAMAN										
4,000.00	9.11	110.18	3,967.22	-146.01	397.37	-82.06	0.00	0.00	0.00	
4,100.00	9.11	110.18	4,065.96	-151.47	412.24	-85.14	0.00	0.00	0.00	
4,200.00	9.11	110.18	4,164.70	-156.94	427.11	-88.21	0.00	0.00	0.00	
4,300.00	9.11	110.18	4,263.43	-162.40	441.98	-91.28	0.00	0.00	0.00	
4,338.05	9.11	110.18	4,301.00	-164.48	447.64	-92.44	0.00	0.00	0.00	
SUSSEX										
4,400.00	9.11	110.18	4,362.17	-167.86	456.85	-94.35	0.00	0.00	0.00	
4,500.00	9.11	110.18	4,460.91	-173.33	471.72	-97.42	0.00	0.00	0.00	
4,600.00	9.11	110.18	4,559.65	-178.79	486.58	-100.49	0.00	0.00	0.00	

Anadarko Petroleum Corp

Planning Report

Database:	edmp	Local Co-ordinate Reference:	Well WEICHEL 35N-11HZ
Company:	US ROCKIES REGION PLANNING	TVD Reference:	RKB + GL @ 4910.00ft
Project:	COLORADO NORTHERN ZONE - 83	MD Reference:	RKB + GL @ 4910.00ft
Site:	WELD_WEICHEL 3 PAD	North Reference:	True
Well:	WEICHEL 35N-11HZ	Survey Calculation Method:	Minimum Curvature
Wellbore:	WEICHEL 35N-11HZ		
Design:	WEICHEL 35N-11HZ (wp01)		

Planned Survey									
Measured Depth (ft)	Inclination (°)	Azimuth (°)	Vertical Depth (ft)	+N/-S (ft)	+E/-W (ft)	Vertical Section (ft)	Dogleg Rate (°/100usft)	Build Rate (°/100usft)	Turn Rate (°/100usft)
4,700.00	9.11	110.18	4,658.38	-184.25	501.45	-103.56	0.00	0.00	0.00
4,800.00	9.11	110.18	4,757.12	-189.72	516.32	-106.63	0.00	0.00	0.00
4,900.00	9.11	110.18	4,855.86	-195.18	531.19	-109.70	0.00	0.00	0.00
5,000.00	9.11	110.18	4,954.60	-200.64	546.06	-112.77	0.00	0.00	0.00
5,100.00	9.11	110.18	5,053.33	-206.11	560.93	-115.84	0.00	0.00	0.00
5,200.00	9.11	110.18	5,152.07	-211.57	575.79	-118.91	0.00	0.00	0.00
5,300.00	9.11	110.18	5,250.81	-217.03	590.66	-121.98	0.00	0.00	0.00
5,400.00	9.11	110.18	5,349.55	-222.49	605.53	-125.05	0.00	0.00	0.00
5,500.00	9.11	110.18	5,448.28	-227.96	620.40	-128.12	0.00	0.00	0.00
5,600.00	9.11	110.18	5,547.02	-233.42	635.27	-131.19	0.00	0.00	0.00
5,700.00	9.11	110.18	5,645.76	-238.88	650.14	-134.26	0.00	0.00	0.00
5,800.00	9.11	110.18	5,744.50	-244.35	665.00	-137.34	0.00	0.00	0.00
5,900.00	9.11	110.18	5,843.23	-249.81	679.87	-140.41	0.00	0.00	0.00
6,000.00	9.11	110.18	5,941.97	-255.27	694.74	-143.48	0.00	0.00	0.00
6,100.00	9.11	110.18	6,040.71	-260.74	709.61	-146.55	0.00	0.00	0.00
6,200.00	9.11	110.18	6,139.44	-266.20	724.48	-149.62	0.00	0.00	0.00
6,300.00	9.11	110.18	6,238.18	-271.66	739.35	-152.69	0.00	0.00	0.00
6,395.72	9.11	110.18	6,332.69	-276.89	753.58	-155.63	0.00	0.00	0.00
6,400.00	8.98	107.59	6,336.92	-277.11	754.21	-155.74	10.00	-3.18	-60.31
6,500.00	11.25	49.39	6,435.60	-273.11	769.10	-149.46	10.00	2.27	-58.20
6,600.00	19.26	25.69	6,532.08	-251.84	783.69	-126.17	10.00	8.01	-23.70
6,700.00	28.53	16.23	6,623.44	-213.95	797.55	-86.58	10.00	9.27	-9.45
6,800.00	38.15	11.20	6,706.90	-160.59	810.26	-31.89	10.00	9.62	-5.03
6,900.00	47.90	7.97	6,779.93	-93.38	821.43	36.24	10.00	9.76	-3.24
6,948.65	52.68	6.74	6,811.00	-56.27	826.21	73.64	10.00	9.81	-2.52
SHARON SPRINGS									
7,000.00	57.73	5.60	6,840.30	-14.36	830.72	115.74	10.00	9.83	-2.21
7,060.76	63.71	4.41	6,870.00	38.41	835.33	168.58	10.00	9.85	-1.96
NIOBRARA A									
7,100.00	67.58	3.70	6,886.18	74.07	837.86	204.19	10.00	9.87	-1.80
7,194.69	76.94	2.14	6,915.00	164.04	842.42	293.77	10.00	9.88	-1.65
NIOBRARA B									
7,200.00	77.46	2.06	6,916.18	169.21	842.61	298.91	10.00	9.88	-1.57
7,300.00	87.35	0.54	6,929.38	268.18	844.84	397.01	10.00	9.89	-1.52
7,326.83	90.00	0.14	6,930.00	295.00	845.00	423.53	10.00	9.89	-1.49
7"									
7,400.00	90.00	0.15	6,930.00	368.17	845.18	495.82	0.01	0.00	0.01
7,436.44	90.00	0.15	6,930.00	404.60	845.28	531.83	0.01	0.00	0.01
7,500.00	90.00	0.15	6,930.00	468.17	845.45	594.63	0.00	0.00	0.00
7,600.00	90.00	0.15	6,930.00	568.17	845.71	693.44	0.00	0.00	0.00
7,700.00	90.00	0.15	6,930.00	668.17	845.97	792.25	0.00	0.00	0.00
7,800.00	90.00	0.15	6,930.00	768.17	846.24	891.06	0.00	0.00	0.00
7,900.00	90.00	0.15	6,930.00	868.17	846.50	989.88	0.00	0.00	0.00
8,000.00	90.00	0.15	6,930.00	968.17	846.76	1,088.69	0.00	0.00	0.00
8,100.00	90.00	0.15	6,930.00	1,068.17	847.03	1,187.50	0.00	0.00	0.00
8,200.00	90.00	0.15	6,930.00	1,168.17	847.29	1,286.31	0.00	0.00	0.00
8,300.00	90.00	0.15	6,930.00	1,268.17	847.55	1,385.12	0.00	0.00	0.00
8,400.00	90.00	0.15	6,930.00	1,368.17	847.82	1,483.93	0.00	0.00	0.00
8,500.00	90.00	0.15	6,930.00	1,468.17	848.08	1,582.74	0.00	0.00	0.00
8,600.00	90.00	0.15	6,930.00	1,568.17	848.34	1,681.55	0.00	0.00	0.00
8,700.00	90.00	0.15	6,930.00	1,668.16	848.61	1,780.36	0.00	0.00	0.00
8,800.00	90.00	0.15	6,930.00	1,768.16	848.87	1,879.17	0.00	0.00	0.00
8,900.00	90.00	0.15	6,930.00	1,868.16	849.13	1,977.98	0.00	0.00	0.00
9,000.00	90.00	0.15	6,930.00	1,968.16	849.40	2,076.79	0.00	0.00	0.00

Anadarko Petroleum Corp

Planning Report

Database:	edmp	Local Co-ordinate Reference:	Well WEICHEL 35N-11HZ
Company:	US ROCKIES REGION PLANNING	TVD Reference:	RKB + GL @ 4910.00ft
Project:	COLORADO NORTHERN ZONE - 83	MD Reference:	RKB + GL @ 4910.00ft
Site:	WELD_WEICHEL 3 PAD	North Reference:	True
Well:	WEICHEL 35N-11HZ	Survey Calculation Method:	Minimum Curvature
Wellbore:	WEICHEL 35N-11HZ		
Design:	WEICHEL 35N-11HZ (wp01)		

Planned Survey									
Measured Depth (ft)	Inclination (°)	Azimuth (°)	Vertical Depth (ft)	+N/-S (ft)	+E/-W (ft)	Vertical Section (ft)	Dogleg Rate (°/100usft)	Build Rate (°/100usft)	Turn Rate (°/100usft)
9,100.00	90.00	0.15	6,930.00	2,068.16	849.66	2,175.60	0.00	0.00	0.00
9,200.00	90.00	0.15	6,930.00	2,168.16	849.92	2,274.41	0.00	0.00	0.00
9,300.00	90.00	0.15	6,930.00	2,268.16	850.19	2,373.22	0.00	0.00	0.00
9,400.00	90.00	0.15	6,930.00	2,368.16	850.45	2,472.03	0.00	0.00	0.00
9,500.00	90.00	0.15	6,930.00	2,468.16	850.72	2,570.84	0.00	0.00	0.00
9,600.00	90.00	0.15	6,930.00	2,568.16	850.98	2,669.65	0.00	0.00	0.00
9,700.00	90.00	0.15	6,930.00	2,668.16	851.24	2,768.46	0.00	0.00	0.00
9,800.00	90.00	0.15	6,930.00	2,768.16	851.51	2,867.27	0.00	0.00	0.00
9,900.00	90.00	0.15	6,930.00	2,868.16	851.77	2,966.08	0.00	0.00	0.00
10,000.00	90.00	0.15	6,930.00	2,968.16	852.03	3,064.89	0.00	0.00	0.00
10,100.00	90.00	0.15	6,930.00	3,068.16	852.30	3,163.70	0.00	0.00	0.00
10,200.00	90.00	0.15	6,930.00	3,168.16	852.56	3,262.51	0.00	0.00	0.00
10,300.00	90.00	0.15	6,930.00	3,268.16	852.82	3,361.32	0.00	0.00	0.00
10,400.00	90.00	0.15	6,930.00	3,368.16	853.09	3,460.13	0.00	0.00	0.00
10,500.00	90.00	0.15	6,930.00	3,468.16	853.35	3,558.94	0.00	0.00	0.00
10,600.00	90.00	0.15	6,930.00	3,568.16	853.61	3,657.75	0.00	0.00	0.00
10,700.00	90.00	0.15	6,930.00	3,668.16	853.88	3,756.56	0.00	0.00	0.00
10,800.00	90.00	0.15	6,930.00	3,768.16	854.14	3,855.37	0.00	0.00	0.00
10,900.00	90.00	0.15	6,930.00	3,868.16	854.40	3,954.18	0.00	0.00	0.00
11,000.00	90.00	0.15	6,930.00	3,968.16	854.67	4,052.99	0.00	0.00	0.00
11,100.00	90.00	0.15	6,930.00	4,068.16	854.93	4,151.80	0.00	0.00	0.00
11,200.00	90.00	0.15	6,930.00	4,168.16	855.19	4,250.61	0.00	0.00	0.00
11,300.00	90.00	0.15	6,930.00	4,268.16	855.46	4,349.42	0.00	0.00	0.00
11,400.00	90.00	0.15	6,930.00	4,368.16	855.72	4,448.23	0.00	0.00	0.00
11,500.00	90.00	0.15	6,930.00	4,468.16	855.98	4,547.04	0.00	0.00	0.00
11,600.00	90.00	0.15	6,930.00	4,568.15	856.25	4,645.86	0.00	0.00	0.00
11,700.00	90.00	0.15	6,930.00	4,668.15	856.51	4,744.67	0.00	0.00	0.00
11,800.00	90.00	0.15	6,930.00	4,768.15	856.78	4,843.48	0.00	0.00	0.00
11,900.00	90.00	0.15	6,930.00	4,868.15	857.04	4,942.29	0.00	0.00	0.00
12,000.00	90.00	0.15	6,930.00	4,968.15	857.30	5,041.10	0.00	0.00	0.00
12,100.00	90.00	0.15	6,930.00	5,068.15	857.57	5,139.91	0.00	0.00	0.00
12,200.00	90.00	0.15	6,930.00	5,168.15	857.83	5,238.72	0.00	0.00	0.00
12,300.00	90.00	0.15	6,930.00	5,268.15	858.09	5,337.53	0.00	0.00	0.00
12,400.00	90.00	0.15	6,930.00	5,368.15	858.36	5,436.34	0.00	0.00	0.00
12,453.46	90.00	0.15	6,930.00	5,421.61	858.50	5,489.16	0.00	0.00	0.00
WEICHEL 35N-11HZ BHL									

Design Targets									
Target Name	Dip Angle (°)	Dip Dir. (°)	TVD (ft)	+N/-S (ft)	+E/-W (ft)	Northing (usft)	Easting (usft)	Latitude	Longitude
WEICHEL 35N-11HZ BF - hit/miss target - Shape - plan hits target center - Point	0.00	0.00	6,930.00	5,421.61	858.50	1,297,630.05	3,241,445.50	40.147161	-104.636290

Anadarko Petroleum Corp
 Planning Report

Database:	edmp	Local Co-ordinate Reference:	Well WEICHEL 35N-11HZ
Company:	US ROCKIES REGION PLANNING	TVD Reference:	RKB + GL @ 4910.00ft
Project:	COLORADO NORTHERN ZONE - 83	MD Reference:	RKB + GL @ 4910.00ft
Site:	WELD_WEICHEL 3 PAD	North Reference:	True
Well:	WEICHEL 35N-11HZ	Survey Calculation Method:	Minimum Curvature
Wellbore:	WEICHEL 35N-11HZ		
Design:	WEICHEL 35N-11HZ (wp01)		

Casing Points						
Measured Depth (ft)	Vertical Depth (ft)		Name	Casing Diameter (")	Hole Diameter (")	
900.00	900.00	9 5/8"		9-5/8	12-1/4	
7,326.83	6,930.00	7"		7	8-3/4	

Formations						
Measured Depth (ft)	Vertical Depth (ft)	Name	Lithology	Dip (°)	Dip Direction (°)	
3,951.16	3,919.00	PARKAMAN		0.00		
4,338.05	4,301.00	SUSSEX		0.00		
6,948.65	6,811.00	SHARON SPRINGS		0.00		
7,060.76	6,870.00	NIOBRARA A		0.00		
7,194.69	6,915.00	NIOBRARA B		0.00		