

CONFIDENTIALITY NOTES:
The information contained in this plat is legally privileged and confidential information intended only for the use of the recipients. If you are not the intended recipients, you are hereby notified that any use, dissemination, distribution or copying of this information is strictly prohibited.



**WILLIAM H. SMITH
& ASSOCIATES P.C.**
SURVEYING CONSULTANTS
550 EAST SECOND NORTH PHONE: 307-875-3638
GREEN RIVER, WY 307-875-3639
www.whsmithpc.com

LEGEND	
PROPOSED ACCESS	— — — — —
EXISTING ROAD	— — — — —
1/16 LINE	— — — — —
1/4 LINE	— — — — —
SECTION LINE	— — — — —
EXISTING FENCE	— ○ — ○ — ○ —
EXISTING OHP	— — — — —

LOCATION:
CROW VALLEY
7-62-24-2H &
7-62-13-2H
WITHIN THE NE1/4
NW1/4 SECTION 24,
T 7 N, R 62 W,
6TH PM.
WELD COUNTY,
COLORADO

MARATHON OIL COMPANY
PO BOX 3128, HOUSTON TX, 77253
5555 SAN FELIPE, HOUSTON TX, 77056

DRAWN BY: LAL	CHECKED BY: RAW
PROJECT NO: 762242H	JOB NO: 2011001
REVISIONS:	

ACCESS ROAD MAP	
SCALE: 1"=200'	EXHIBIT "E"
DATE: 1/09/2012	SHEET 4 of 15

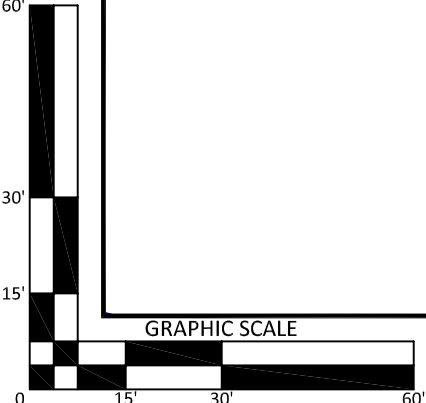
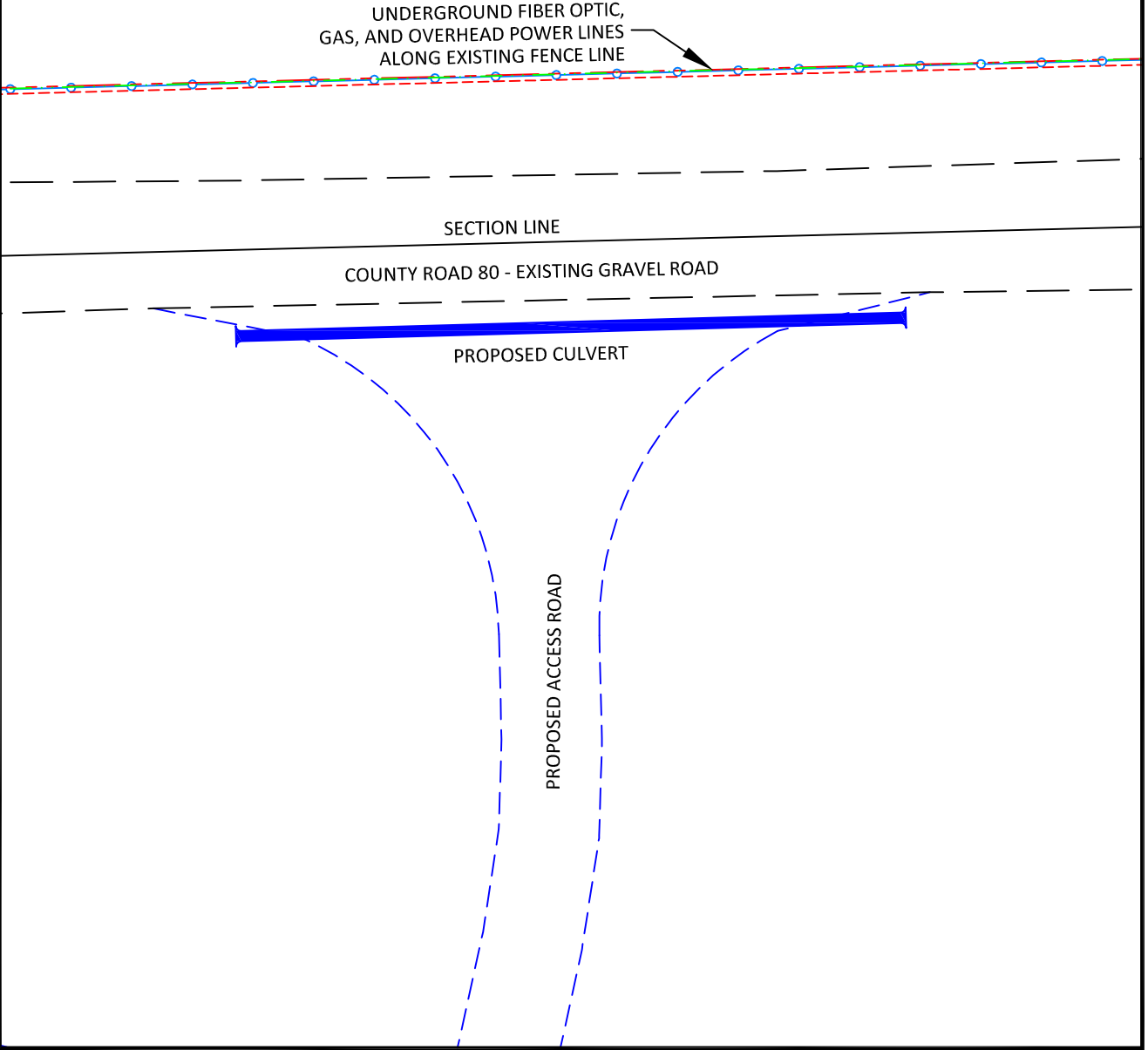

CONFIDENTIALITY NOTES:
 The information contained in this plat is legally privileged and confidential information intended only for the use of the recipients. If you are not the intended recipients, you are hereby notified that any use, dissemination, distribution or copying of this information is strictly prohibited.



WILLIAM H. SMITH & ASSOCIATES P.C.
 SURVEYING CONSULTANTS
 550 EAST SECOND NORTH GREEN RIVER, WY
 PHONE: 307-875-3638 307-875-3639
 www.whsmithpc.com

LEGEND

ACCESS ROAD	
EXISTING ROAD	
FENCE	
EXISTING OHP	
UNDERGROUND GAS	
FIBER OPTIC	

LOCATION:
 CROW VALLEY
 7-62-24-2H & 7-62-13-2H
 WITHIN THE NE1/4 NW1/4 SECTION 24,
 T 7 N, R 62 W,
 6TH PM.
 WELD COUNTY,
 COLORADO

MARATHON OIL COMPANY
 PO BOX 3128, HOUSTON TX, 77253
 5555 SAN FELIPE, HOUSTON TX, 77056

DRAWN BY: LAL	CHECKED BY: RAW
PROJECT NO: 762242H	JOB NO: 2011001
REVISIONS:	

ACCESS ROAD ENTRANCE	
SCALE: 1"=30'	EXHIBIT "A"
DATE: 1/09/2012	SHEET 1 OF 1