

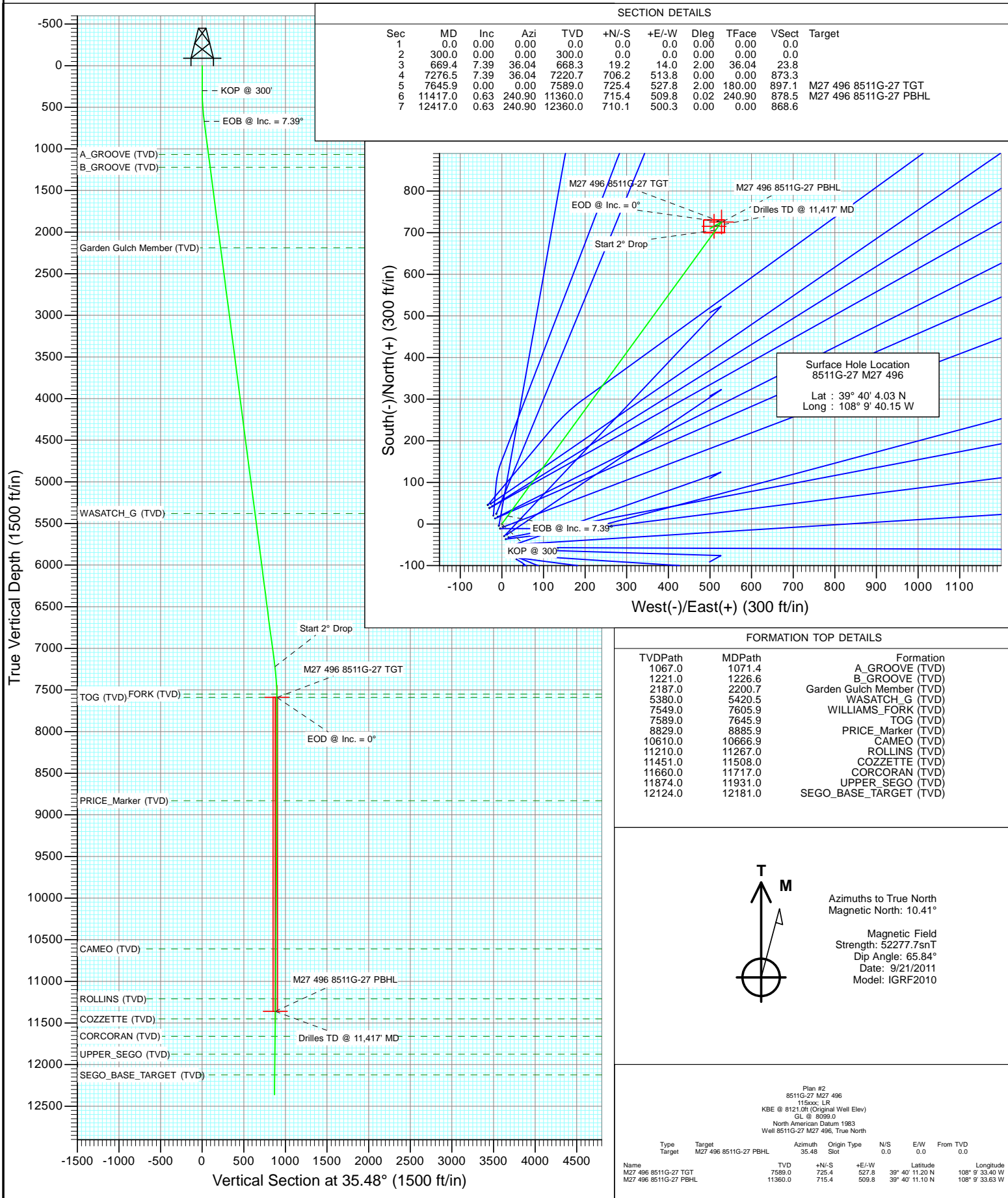

Project: Story Gulch  
Site: S27-T4S-R96W (M27 496)  
Well: 8511G-27 M27 496  
Wellbore: DD  
Design: Plan #2





Project: Story Gulch  
Site: S27-T4S-R96W (M27 496)  
Well: 8511G-27 M27 496  
Wellbore: DD  
Design: Plan #2

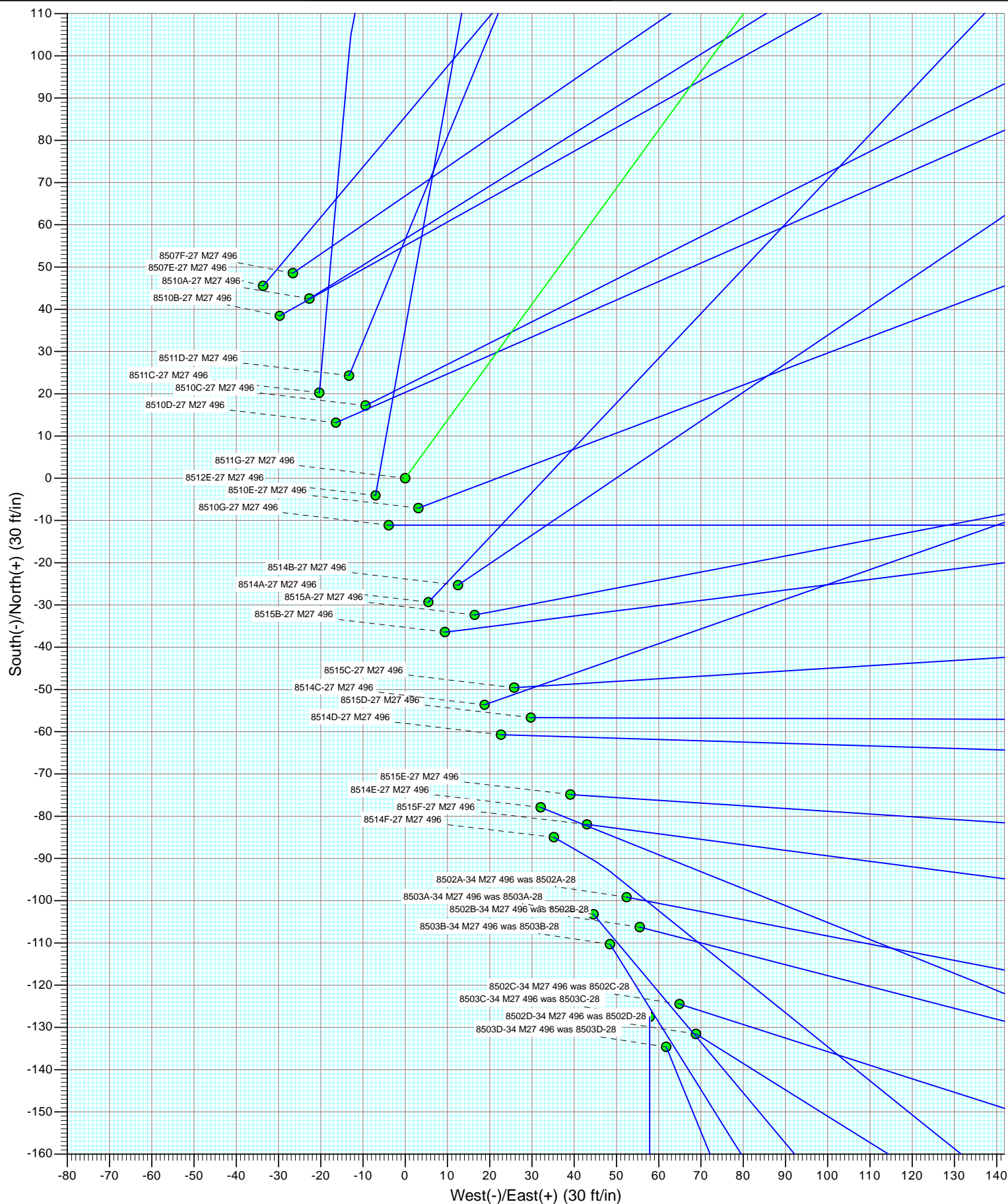



Project: Story Gulch  
Site: S27-T4S-R96W (M27 496)  
Well: 8511G-27 M27 496  
Wellbore: DD  
Design: Plan #2

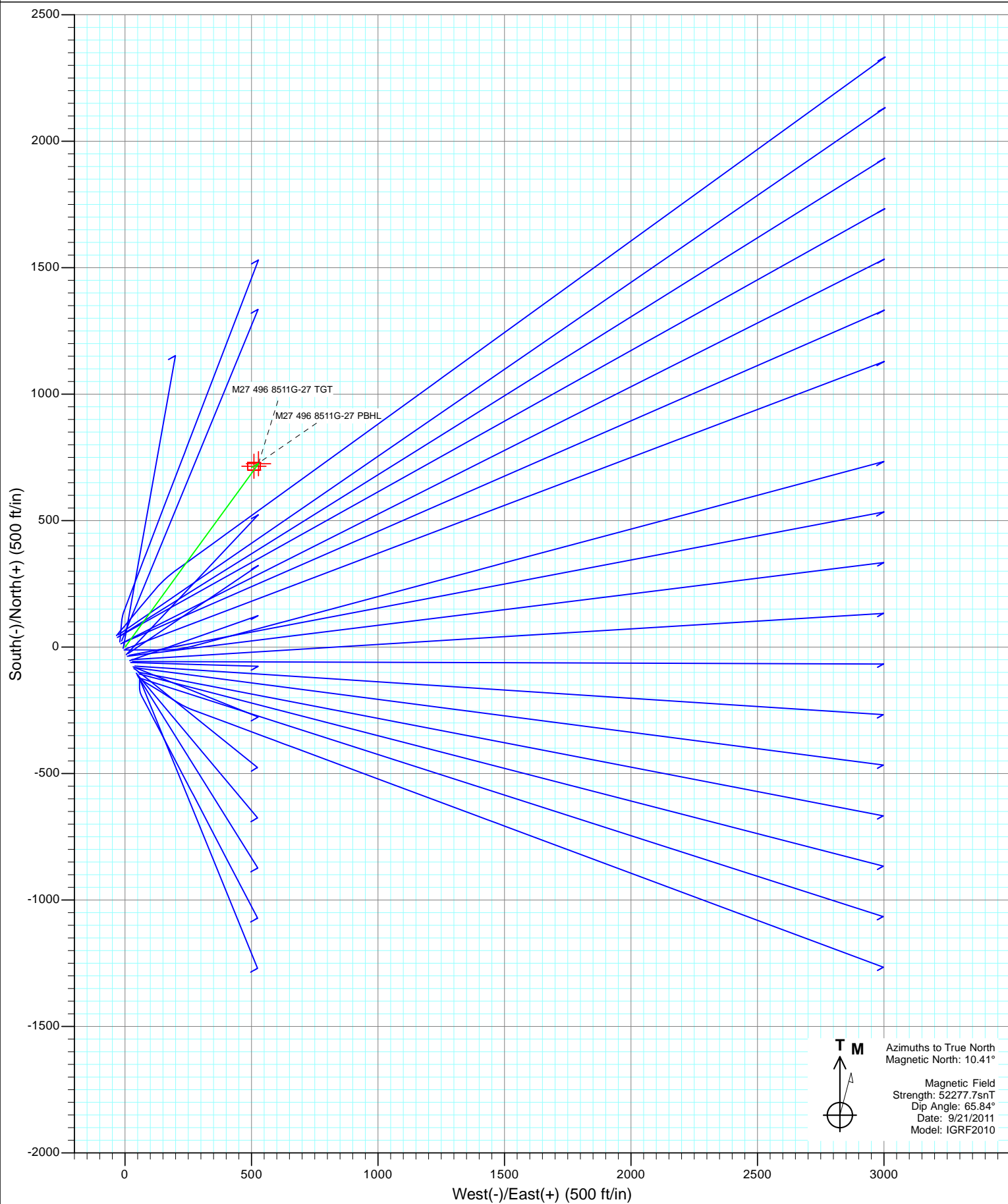



Project: Story Gulch  
Site: S27-T4S-R96W (M27 496)  
Well: 8511G-27 M27 496  
Wellbore: DD  
Design: Plan #2

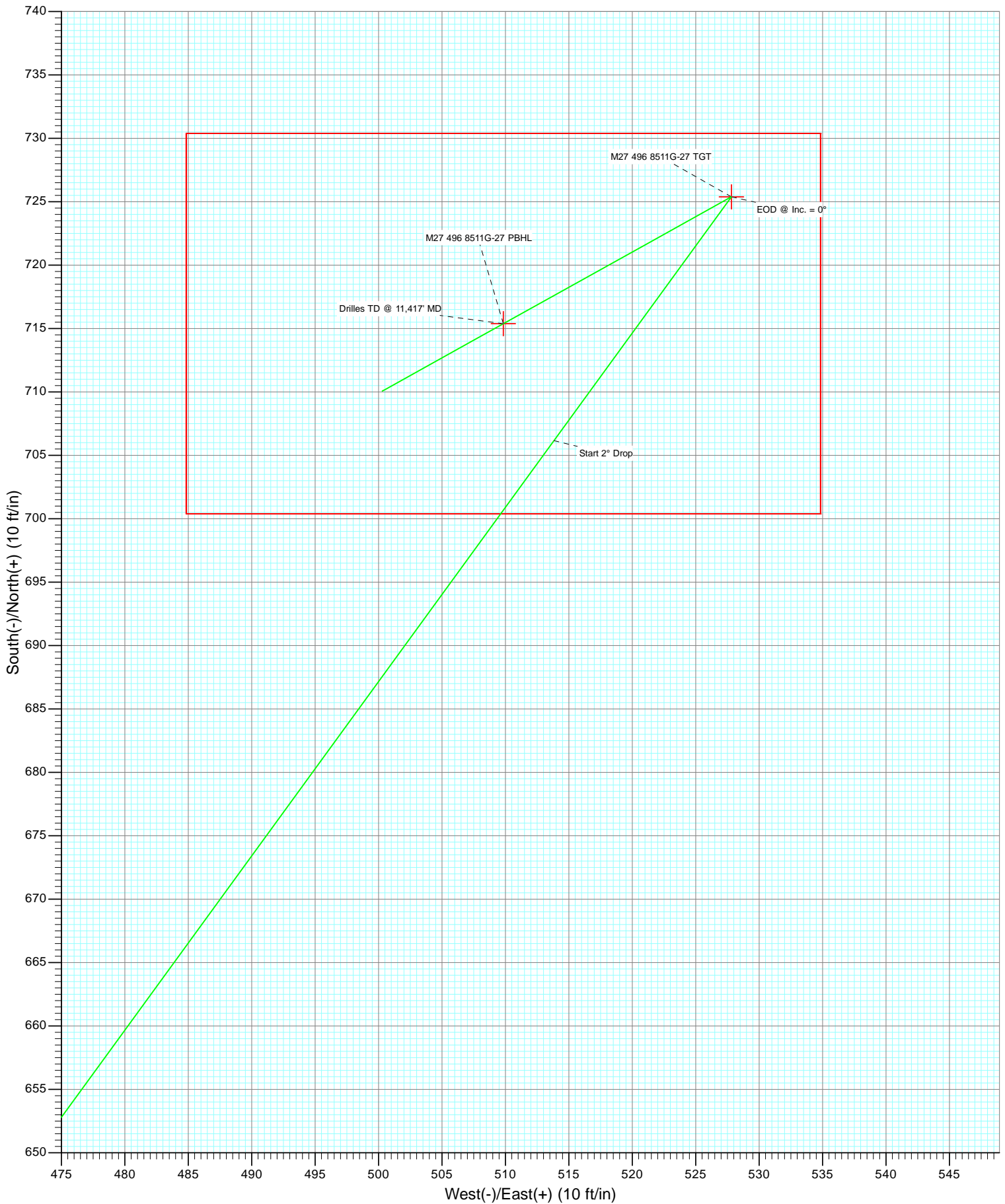

# Cathedral Energy Services

## Planning Report

<b>Database:</b>	USA EDM 5000 Multi Users DB	<b>Local Co-ordinate Reference:</b>	Well 8511G-27 M27 496
<b>Company:</b>	EnCana Oil & Gas (USA) Inc	<b>TVD Reference:</b>	KBE @ 8121.0ft (Original Well Elev)
<b>Project:</b>	Story Gulch	<b>MD Reference:</b>	KBE @ 8121.0ft (Original Well Elev)
<b>Site:</b>	S27-T4S-R96W (M27 496)	<b>North Reference:</b>	True
<b>Well:</b>	8511G-27 M27 496	<b>Survey Calculation Method:</b>	Minimum Curvature
<b>Wellbore:</b>	DD		
<b>Design:</b>	Plan #2		

<b>Project</b>	Story Gulch		
<b>Map System:</b>	US State Plane 1983	<b>System Datum:</b>	Mean Sea Level
<b>Geo Datum:</b>	North American Datum 1983		
<b>Map Zone:</b>	Colorado Central Zone		

<b>Site</b>	S27-T4S-R96W (M27 496)			
<b>Site Position:</b>		<b>Northing:</b>	1,678,990.24 ft	<b>Latitude:</b> 39° 40' 3.01 N
<b>From:</b>	Lat/Long	<b>Easting:</b>	2,251,008.33 ft	<b>Longitude:</b> 108° 9' 39.57 W
<b>Position Uncertainty:</b>	0.0 ft	<b>Slot Radius:</b>	13.200 in	<b>Grid Convergence:</b> -1.68 °

<b>Well</b>	8511G-27 M27 496			
<b>Well Position</b>	<b>+N/-S</b>	0.0 ft	<b>Northing:</b>	1,679,094.72 ft
	<b>+E/-W</b>	0.0 ft	<b>Easting:</b>	2,250,966.01 ft
<b>Position Uncertainty</b>	0.0 ft		<b>Wellhead Elevation:</b>	ft
			<b>Ground Level:</b>	8,099.0 ft

<b>Wellbore</b>	DD				
<b>Magnetics</b>	<b>Model Name</b>	<b>Sample Date</b>	<b>Declination (°)</b>	<b>Dip Angle (°)</b>	<b>Field Strength (nT)</b>
	IGRF2010	9/21/2011	10.41	65.84	52,278

<b>Design</b>	Plan #2			
<b>Audit Notes:</b>				
<b>Version:</b>	<b>Phase:</b>	PLAN	<b>Tie On Depth:</b>	0.0
<b>Vertical Section:</b>	<b>Depth From (TVD) (ft)</b>	<b>+N/-S (ft)</b>	<b>+E/-W (ft)</b>	<b>Direction (°)</b>
	0.0	0.0	0.0	35.48

<b>Plan Sections</b>										
Measured Depth (ft)	Inclination (°)	Azimuth (°)	Vertical Depth (ft)	+N/-S (ft)	+E/-W (ft)	Dogleg Rate (°/100ft)	Build Rate (°/100ft)	Turn Rate (°/100ft)	TFO (°)	Target
0.0	0.00	0.00	0.0	0.0	0.0	0.00	0.00	0.00	0.00	
300.0	0.00	0.00	300.0	0.0	0.0	0.00	0.00	0.00	0.00	
669.4	7.39	36.04	668.3	19.2	14.0	2.00	2.00	0.00	36.04	
7,276.5	7.39	36.04	7,220.7	706.2	513.8	0.00	0.00	0.00	0.00	
7,645.9	0.00	0.00	7,589.0	725.4	527.8	2.00	-2.00	0.00	180.00	M27 496 8511G-27 T
11,417.0	0.63	240.90	11,360.0	715.4	509.8	0.02	0.02	-3.16	240.90	M27 496 8511G-27 P
12,417.0	0.63	240.90	12,360.0	710.1	500.3	0.00	0.00	0.00	0.00	

# Cathedral Energy Services

## Planning Report

<b>Database:</b>	USA EDM 5000 Multi Users DB	<b>Local Co-ordinate Reference:</b>	Well 8511G-27 M27 496
<b>Company:</b>	EnCana Oil & Gas (USA) Inc	<b>TVD Reference:</b>	KBE @ 8121.0ft (Original Well Elev)
<b>Project:</b>	Story Gulch	<b>MD Reference:</b>	KBE @ 8121.0ft (Original Well Elev)
<b>Site:</b>	S27-T4S-R96W (M27 496)	<b>North Reference:</b>	True
<b>Well:</b>	8511G-27 M27 496	<b>Survey Calculation Method:</b>	Minimum Curvature
<b>Wellbore:</b>	DD		
<b>Design:</b>	Plan #2		

Planned Survey									
Measured Depth (ft)	Inclination (°)	Azimuth (°)	Vertical Depth (ft)	+N/-S (ft)	+E/-W (ft)	Vertical Section (ft)	Dogleg Rate (°/100ft)	Build Rate (°/100ft)	Comments / Formations
0.0	0.00	0.00	0.0	0.0	0.0	0.0	0.00	0.00	
100.0	0.00	0.00	100.0	0.0	0.0	0.0	0.00	0.00	
200.0	0.00	0.00	200.0	0.0	0.0	0.0	0.00	0.00	
300.0	0.00	0.00	300.0	0.0	0.0	0.0	0.00	0.00	KOP @ 300'
400.0	2.00	36.04	400.0	1.4	1.0	1.7	2.00	2.00	
500.0	4.00	36.04	499.8	5.6	4.1	7.0	2.00	2.00	
600.0	6.00	36.04	599.5	12.7	9.2	15.7	2.00	2.00	
669.4	7.39	36.04	668.3	19.2	14.0	23.8	2.00	2.00	EOB @ Inc. = 7.39°
700.0	7.39	36.04	698.7	22.4	16.3	27.7	0.00	0.00	
800.0	7.39	36.04	797.9	32.8	23.9	40.6	0.00	0.00	
900.0	7.39	36.04	897.1	43.2	31.4	53.4	0.00	0.00	
1,000.0	7.39	36.04	996.2	53.6	39.0	66.3	0.00	0.00	
1,071.4	7.39	36.04	1,067.0	61.0	44.4	75.5	0.00	0.00	A_GROOVE (TVD)
1,100.0	7.39	36.04	1,095.4	64.0	46.6	79.1	0.00	0.00	
1,200.0	7.39	36.04	1,194.6	74.4	54.1	92.0	0.00	0.00	
1,226.6	7.39	36.04	1,221.0	77.2	56.1	95.4	0.00	0.00	B_GROOVE (TVD)
1,300.0	7.39	36.04	1,293.7	84.8	61.7	104.9	0.00	0.00	
1,400.0	7.39	36.04	1,392.9	95.2	69.3	117.7	0.00	0.00	
1,500.0	7.39	36.04	1,492.1	105.6	76.8	130.6	0.00	0.00	
1,600.0	7.39	36.04	1,591.3	116.0	84.4	143.4	0.00	0.00	
1,700.0	7.39	36.04	1,690.4	126.4	92.0	156.3	0.00	0.00	
1,800.0	7.39	36.04	1,789.6	136.8	99.5	169.1	0.00	0.00	
1,900.0	7.39	36.04	1,888.8	147.2	107.1	182.0	0.00	0.00	
2,000.0	7.39	36.04	1,987.9	157.6	114.7	194.9	0.00	0.00	
2,100.0	7.39	36.04	2,087.1	168.0	122.2	207.7	0.00	0.00	
2,200.0	7.39	36.04	2,186.3	178.4	129.8	220.6	0.00	0.00	
2,200.7	7.39	36.04	2,187.0	178.4	129.8	220.7	0.00	0.00	Garden Gulch Member (TVD)
2,300.0	7.39	36.04	2,285.4	188.8	137.3	233.4	0.00	0.00	
2,400.0	7.39	36.04	2,384.6	199.2	144.9	246.3	0.00	0.00	
2,500.0	7.39	36.04	2,483.8	209.6	152.5	259.1	0.00	0.00	
2,600.0	7.39	36.04	2,583.0	220.0	160.0	272.0	0.00	0.00	
2,700.0	7.39	36.04	2,682.1	230.3	167.6	284.9	0.00	0.00	
2,800.0	7.39	36.04	2,781.3	240.7	175.2	297.7	0.00	0.00	
2,900.0	7.39	36.04	2,880.5	251.1	182.7	310.6	0.00	0.00	
3,000.0	7.39	36.04	2,979.6	261.5	190.3	323.4	0.00	0.00	
3,100.0	7.39	36.04	3,078.8	271.9	197.9	336.3	0.00	0.00	
3,200.0	7.39	36.04	3,178.0	282.3	205.4	349.1	0.00	0.00	
3,300.0	7.39	36.04	3,277.1	292.7	213.0	362.0	0.00	0.00	
3,400.0	7.39	36.04	3,376.3	303.1	220.6	374.9	0.00	0.00	
3,500.0	7.39	36.04	3,475.5	313.5	228.1	387.7	0.00	0.00	
3,600.0	7.39	36.04	3,574.7	323.9	235.7	400.6	0.00	0.00	
3,700.0	7.39	36.04	3,673.8	334.3	243.3	413.4	0.00	0.00	
3,800.0	7.39	36.04	3,773.0	344.7	250.8	426.3	0.00	0.00	
3,900.0	7.39	36.04	3,872.2	355.1	258.4	439.1	0.00	0.00	
4,000.0	7.39	36.04	3,971.3	365.5	266.0	452.0	0.00	0.00	
4,100.0	7.39	36.04	4,070.5	375.9	273.5	464.9	0.00	0.00	
4,200.0	7.39	36.04	4,169.7	386.3	281.1	477.7	0.00	0.00	
4,300.0	7.39	36.04	4,268.8	396.7	288.7	490.6	0.00	0.00	
4,400.0	7.39	36.04	4,368.0	407.1	296.2	503.4	0.00	0.00	
4,500.0	7.39	36.04	4,467.2	417.5	303.8	516.3	0.00	0.00	
4,600.0	7.39	36.04	4,566.4	427.9	311.3	529.1	0.00	0.00	
4,700.0	7.39	36.04	4,665.5	438.3	318.9	542.0	0.00	0.00	

# Cathedral Energy Services

## Planning Report

<b>Database:</b>	USA EDM 5000 Multi Users DB	<b>Local Co-ordinate Reference:</b>	Well 8511G-27 M27 496
<b>Company:</b>	EnCana Oil & Gas (USA) Inc	<b>TVD Reference:</b>	KBE @ 8121.0ft (Original Well Elev)
<b>Project:</b>	Story Gulch	<b>MD Reference:</b>	KBE @ 8121.0ft (Original Well Elev)
<b>Site:</b>	S27-T4S-R96W (M27 496)	<b>North Reference:</b>	True
<b>Well:</b>	8511G-27 M27 496	<b>Survey Calculation Method:</b>	Minimum Curvature
<b>Wellbore:</b>	DD		
<b>Design:</b>	Plan #2		

Planned Survey									
Measured Depth (ft)	Inclination (°)	Azimuth (°)	Vertical Depth (ft)	+N/-S (ft)	+E/-W (ft)	Vertical Section (ft)	Dogleg Rate (°/100ft)	Build Rate (°/100ft)	Comments / Formations
4,800.0	7.39	36.04	4,764.7	448.7	326.5	554.9	0.00	0.00	
4,900.0	7.39	36.04	4,863.9	459.1	334.0	567.7	0.00	0.00	
5,000.0	7.39	36.04	4,963.0	469.5	341.6	580.6	0.00	0.00	
5,100.0	7.39	36.04	5,062.2	479.9	349.2	593.4	0.00	0.00	
5,200.0	7.39	36.04	5,161.4	490.3	356.7	606.3	0.00	0.00	
5,300.0	7.39	36.04	5,260.5	500.7	364.3	619.1	0.00	0.00	
5,400.0	7.39	36.04	5,359.7	511.1	371.9	632.0	0.00	0.00	
5,420.5	7.39	36.04	5,380.0	513.2	373.4	634.6	0.00	0.00	WASATCH_G (TVD)
5,500.0	7.39	36.04	5,458.9	521.5	379.4	644.9	0.00	0.00	
5,600.0	7.39	36.04	5,558.0	531.9	387.0	657.7	0.00	0.00	
5,700.0	7.39	36.04	5,657.2	542.3	394.6	670.6	0.00	0.00	
5,800.0	7.39	36.04	5,756.4	552.6	402.1	683.4	0.00	0.00	
5,900.0	7.39	36.04	5,855.6	563.0	409.7	696.3	0.00	0.00	
6,000.0	7.39	36.04	5,954.7	573.4	417.3	709.1	0.00	0.00	
6,100.0	7.39	36.04	6,053.9	583.8	424.8	722.0	0.00	0.00	
6,200.0	7.39	36.04	6,153.1	594.2	432.4	734.9	0.00	0.00	
6,300.0	7.39	36.04	6,252.2	604.6	440.0	747.7	0.00	0.00	
6,400.0	7.39	36.04	6,351.4	615.0	447.5	760.6	0.00	0.00	
6,500.0	7.39	36.04	6,450.6	625.4	455.1	773.4	0.00	0.00	
6,600.0	7.39	36.04	6,549.7	635.8	462.6	786.3	0.00	0.00	
6,700.0	7.39	36.04	6,648.9	646.2	470.2	799.1	0.00	0.00	
6,800.0	7.39	36.04	6,748.1	656.6	477.8	812.0	0.00	0.00	
6,900.0	7.39	36.04	6,847.3	667.0	485.3	824.9	0.00	0.00	
7,000.0	7.39	36.04	6,946.4	677.4	492.9	837.7	0.00	0.00	
7,100.0	7.39	36.04	7,045.6	687.8	500.5	850.6	0.00	0.00	
7,200.0	7.39	36.04	7,144.8	698.2	508.0	863.4	0.00	0.00	
7,276.5	7.39	36.04	7,220.7	706.2	513.8	873.3	0.00	0.00	Start 2° Drop
7,300.0	6.92	36.04	7,244.0	708.5	515.5	876.2	2.00	-2.00	
7,400.0	4.92	36.04	7,343.4	716.9	521.6	886.5	2.00	-2.00	
7,500.0	2.92	36.04	7,443.2	722.4	525.6	893.3	2.00	-2.00	
7,600.0	0.92	36.04	7,543.1	725.1	527.6	896.7	2.00	-2.00	
7,605.9	0.80	36.04	7,549.0	725.2	527.7	896.8	2.00	-2.00	WILLIAMS_FORK (TVD)
7,645.9	0.00	0.00	7,589.0	725.4	527.8	897.1	2.00	-2.00	EOD @ Inc. = 0° - TOG (TVD)
7,700.0	0.01	240.90	7,643.1	725.4	527.8	897.0	0.02	0.02	
7,800.0	0.03	240.90	7,743.1	725.4	527.8	897.0	0.02	0.02	
7,900.0	0.04	240.90	7,843.1	725.3	527.7	897.0	0.02	0.02	
8,000.0	0.06	240.90	7,943.1	725.3	527.7	896.9	0.02	0.02	
8,100.0	0.08	240.90	8,043.1	725.2	527.6	896.8	0.02	0.02	
8,200.0	0.09	240.90	8,143.1	725.2	527.4	896.7	0.02	0.02	
8,300.0	0.11	240.90	8,243.1	725.1	527.3	896.5	0.02	0.02	
8,400.0	0.13	240.90	8,343.1	725.0	527.1	896.3	0.02	0.02	
8,500.0	0.14	240.90	8,443.1	724.9	526.9	896.1	0.02	0.02	
8,600.0	0.16	240.90	8,543.1	724.7	526.7	895.9	0.02	0.02	
8,700.0	0.17	240.90	8,643.1	724.6	526.4	895.6	0.02	0.02	
8,800.0	0.19	240.90	8,743.1	724.5	526.1	895.3	0.02	0.02	
8,885.9	0.21	240.90	8,829.0	724.3	525.9	895.0	0.02	0.02	PRICE_Marker (TVD)
8,900.0	0.21	240.90	8,843.1	724.3	525.8	895.0	0.02	0.02	
9,000.0	0.22	240.90	8,943.1	724.1	525.5	894.7	0.02	0.02	
9,100.0	0.24	240.90	9,043.1	723.9	525.1	894.3	0.02	0.02	
9,200.0	0.26	240.90	9,143.1	723.7	524.8	893.9	0.02	0.02	
9,300.0	0.27	240.90	9,243.1	723.5	524.4	893.5	0.02	0.02	
9,400.0	0.29	240.90	9,343.1	723.2	523.9	893.0	0.02	0.02	



# Cathedral Energy Services

## Planning Report

<b>Database:</b>	USA EDM 5000 Multi Users DB	<b>Local Co-ordinate Reference:</b>	Well 8511G-27 M27 496
<b>Company:</b>	EnCana Oil & Gas (USA) Inc	<b>TVD Reference:</b>	KBE @ 8121.0ft (Original Well Elev)
<b>Project:</b>	Story Gulch	<b>MD Reference:</b>	KBE @ 8121.0ft (Original Well Elev)
<b>Site:</b>	S27-T4S-R96W (M27 496)	<b>North Reference:</b>	True
<b>Well:</b>	8511G-27 M27 496	<b>Survey Calculation Method:</b>	Minimum Curvature
<b>Wellbore:</b>	DD		
<b>Design:</b>	Plan #2		

Planned Survey									
Measured Depth (ft)	Inclination (°)	Azimuth (°)	Vertical Depth (ft)	+N/-S (ft)	+E/-W (ft)	Vertical Section (ft)	Dogleg Rate (°/100ft)	Build Rate (°/100ft)	Comments / Formations
9,500.0	0.31	240.90	9,443.1	723.0	523.5	892.6	0.02	0.02	
9,600.0	0.32	240.90	9,543.1	722.7	523.0	892.1	0.02	0.02	
9,700.0	0.34	240.90	9,643.1	722.4	522.5	891.5	0.02	0.02	
9,800.0	0.36	240.90	9,743.1	722.1	522.0	891.0	0.02	0.02	
9,900.0	0.37	240.90	9,843.1	721.8	521.4	890.4	0.02	0.02	
10,000.0	0.39	240.90	9,943.1	721.5	520.8	889.8	0.02	0.02	
10,100.0	0.41	240.90	10,043.1	721.2	520.2	889.2	0.02	0.02	
10,200.0	0.42	240.90	10,143.1	720.8	519.6	888.5	0.02	0.02	
10,300.0	0.44	240.90	10,243.1	720.4	518.9	887.8	0.02	0.02	
10,400.0	0.46	240.90	10,343.1	720.1	518.2	887.1	0.02	0.02	
10,500.0	0.47	240.90	10,443.1	719.7	517.5	886.4	0.02	0.02	
10,600.0	0.49	240.90	10,543.1	719.2	516.8	885.6	0.02	0.02	
10,666.9	0.50	240.90	10,610.0	719.0	516.3	885.1	0.02	0.02	CAMEO (TVD)
10,700.0	0.51	240.90	10,643.1	718.8	516.0	884.9	0.02	0.02	
10,800.0	0.52	240.90	10,743.1	718.4	515.2	884.0	0.02	0.02	
10,900.0	0.54	240.90	10,843.1	717.9	514.4	883.2	0.02	0.02	
11,000.0	0.56	240.90	10,943.1	717.5	513.6	882.3	0.02	0.02	
11,100.0	0.57	240.90	11,043.1	717.0	512.7	881.5	0.02	0.02	
11,200.0	0.59	240.90	11,143.0	716.5	511.8	880.5	0.02	0.02	
11,267.0	0.60	240.90	11,210.0	716.2	511.2	879.9	0.02	0.02	ROLLINS (TVD)
11,300.0	0.61	240.90	11,243.0	716.0	510.9	879.6	0.02	0.02	
11,400.0	0.62	240.90	11,343.0	715.5	510.0	878.6	0.02	0.02	
11,417.0	0.63	240.90	11,360.0	715.4	509.8	878.5	0.02	0.02	Drilles TD @ 11,417' MD
11,500.0	0.63	240.90	11,443.0	714.9	509.0	877.6	0.00	0.00	
11,508.0	0.63	240.90	11,451.0	714.9	509.0	877.6	0.00	0.00	COZZETTE (TVD)
11,600.0	0.63	240.90	11,543.0	714.4	508.1	876.7	0.00	0.00	
11,700.0	0.63	240.90	11,643.0	713.9	507.1	875.7	0.00	0.00	
11,717.0	0.63	240.90	11,660.0	713.8	507.0	875.5	0.00	0.00	CORCORAN (TVD)
11,800.0	0.63	240.90	11,743.0	713.3	506.2	874.7	0.00	0.00	
11,900.0	0.63	240.90	11,843.0	712.8	505.2	873.7	0.00	0.00	
11,931.0	0.63	240.90	11,874.0	712.7	504.9	873.4	0.00	0.00	UPPER_SEGO (TVD)
12,000.0	0.63	240.90	11,943.0	712.3	504.3	872.7	0.00	0.00	
12,100.0	0.63	240.90	12,043.0	711.8	503.3	871.7	0.00	0.00	
12,181.0	0.63	240.90	12,124.0	711.3	502.5	870.9	0.00	0.00	SEGO_BASE_TARGET (TVD)
12,200.0	0.63	240.90	12,143.0	711.2	502.4	870.7	0.00	0.00	
12,300.0	0.63	240.90	12,243.0	710.7	501.4	869.8	0.00	0.00	
12,400.0	0.63	240.90	12,343.0	710.2	500.5	868.8	0.00	0.00	
12,417.0	0.63	240.90	12,360.0	710.1	500.3	868.6	0.00	0.00	Permit TD @ 12,417' MD

Targets									
Target Name	Dip Angle (°)	Dip Dir. (°)	TVD (ft)	+N/-S (ft)	+E/-W (ft)	Northing (ft)	Easting (ft)	Latitude	Longitude
- hit/miss target									
- Shape									
M27 496 8511G-27 TGT	0.00	0.00	7,589.0	725.4	527.8	1,679,804.34	2,251,514.85	39° 40' 11.20 N	108° 9' 33.40 W
- plan hits target center									
- Point									
M27 496 8511G-27 PBH	0.00	0.00	11,360.0	715.4	509.8	1,679,794.87	2,251,496.58	39° 40' 11.10 N	108° 9' 33.63 W
- plan hits target center									
- Rectangle (sides W30.0 H50.0 D0.0)									



# Cathedral Energy Services

## Planning Report

<b>Database:</b>	USA EDM 5000 Multi Users DB	<b>Local Co-ordinate Reference:</b>	Well 8511G-27 M27 496
<b>Company:</b>	EnCana Oil & Gas (USA) Inc	<b>TVD Reference:</b>	KBE @ 8121.0ft (Original Well Elev)
<b>Project:</b>	Story Gulch	<b>MD Reference:</b>	KBE @ 8121.0ft (Original Well Elev)
<b>Site:</b>	S27-T4S-R96W (M27 496)	<b>North Reference:</b>	True
<b>Well:</b>	8511G-27 M27 496	<b>Survey Calculation Method:</b>	Minimum Curvature
<b>Wellbore:</b>	DD		
<b>Design:</b>	Plan #2		

### Formations

Measured Depth (ft)	Vertical Depth (ft)	Name	Lithology	Dip (°)	Dip Direction (°)
1,071.4	1,067.0	A_GROOVE (TVD)			
1,226.6	1,221.0	B_GROOVE (TVD)			
2,200.7	2,187.0	Garden Gulch Member (TVD)			
5,420.5	5,380.0	WASATCH_G (TVD)			
7,605.9	7,549.0	WILLIAMS_FORK (TVD)			
7,645.9	7,589.0	TOG (TVD)			
8,885.9	8,829.0	PRICE_Marker (TVD)			
10,666.9	10,610.0	CAMEO (TVD)			
11,267.0	11,210.0	ROLLINS (TVD)			
11,508.0	11,451.0	COZZETTE (TVD)			
11,717.0	11,660.0	CORCORAN (TVD)			
11,931.0	11,874.0	UPPER_SEGO (TVD)			
12,181.0	12,124.0	SEGO_BASE_TARGET (TVD)			

### Plan Annotations

Measured Depth (ft)	Vertical Depth (ft)	Local Coordinates		Comment
		+N/-S (ft)	+E/-W (ft)	
300.0	300.0	0.0	0.0	KOP @ 300'
669.4	668.3	19.2	14.0	EOB @ Inc. = 7.39°
7,276.5	7,220.7	706.2	513.8	Start 2° Drop
7,645.9	7,589.0	725.4	527.8	EOD @ Inc. = 0°
11,417.0	11,360.0	715.4	509.8	Drilles TD @ 11,417' MD
12,417.0	12,360.0	710.1	500.3	Permit TD @ 12,417' MD