

WELL: LARSON 20-21 TO BE LOCATED 1183' FWL AND 1111' FNL IN SECTION 20, TOWNSHIP 7 NORTH, RANGE 66 WEST OF THE 6TH P.M. LOCATION FALLS IN: NATURAL GROUND GROUND ELEVATION = 4989' IMPROVEMENTS: E-W FENCE 90' S& NW/SE DITCH 136' N OF LOC.

**LEGEND:**

- SECTION CORNER (AS NOTED)
- ▼ PROPOSED WELL LOCATION
- ⊗ PROPOSED BOTTOM HOLE LOCATION

SCALE 1"=1000'

**NOTES:**

1. THIS SURVEY WAS DONE BY GPS METHODS AND CONFORMS TO THE MINIMUM STANDARDS AS SET BY THE C.O.G.C.C. RULE NO. 215.
2. ELEVATIONS SHOWN AT THE WELL HEAD, AS WELL AS HORIZONTAL CONTROL, ARE BASED ON GPS-RTK VALUES DERIVED FROM DOING 2-HOUR STATIC GPS SESSIONS AND REDUCTIONS USING O.P.U.S. SOLUTIONS.
3. THE BEARINGS AS SHOWN HEREON ARE BASED ON GPS OBSERVATIONS BETWEEN THE MONUMENTS SHOWN HEREON AS FOUND IN THE FIELD DATE BELOW.
4. DISTANCES SHOWN ARE AT GROUND LEVEL, AS MEASURED IN THE FIELD, WITH TIES TO WELLS MEASURED AT A PERPENDICULAR TO SECTION LINES.

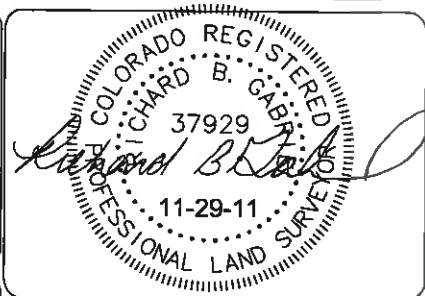

I, RICHARD B. GABRIEL, A LICENSED PROFESSIONAL LAND SURVEYOR IN THE STATE OF COLORADO DO HEREBY CERTIFY TO:  
**GREAT WESTERN OIL AND GAS COMPANY**, THAT THE SURVEY AND WELL LOCATION CERTIFICATE SHOWN HEREON WAS DONE BY ME OR UNDER MY DIRECT SUPERVISION AND THAT THE DRAWING SHOWN HEREON ACCURATELY DEPICTS THE PROPOSED LOCATION OF THE WELL **LARSON 20-21**.  
 THIS CERTIFICATE DOES NOT REPRESENT A LAND SURVEY PLAT OR IMPROVEMENT SURVEY PLAT AS DEFINED BY C.R.S. 38-51-102 AND CANNOT BE RELIED UPON TO DETERMINE OWNERSHIP.

RICHARD B. GABRIEL P.L.S. #37929  
 COLORADO LICENSED PROFESSIONAL LAND SURVEYOR  
 FOR AND ON BEHALF OF POWER SURVEYING CO., INC.

**POWER**<sup>TM</sup>  
 Surveying Company, Inc.  
*Established 1988*

120 W. 84TH AVENUE      PH. 303-702-1617  
 THORNTON, COLORADO 80260      FAX. 303-702-1488

WWW.POWERSURVEYING.COM

NOTICE: ACCORDING TO COLORADO LAW YOU MUST COMMENCE ANY LEGAL ACTION BASED UPON ANY DEFECT IN THIS SURVEY WITHIN THREE YEARS AFTER YOU FIRST DISCOVER SUCH DEFECT. IN NO EVENT MAY ANY ACTION BASED ON ANY DEFECT IN THIS SURVEY BE COMMENCED MORE THAN TEN YEARS FROM THE SAID DATE OF THIS CERTIFICATION SHOWN HEREON.

DATE OF FIELD WORK: 5-5-2010

DATE OF COMPLETION: 11-29-11

PROJECT NUMBER: 501-11-212