

ConocoPhillips Company

CONSTRUCTION LAYOUT FOR

GRIMM #34-4H
SECTION 34, T4S, R64W, 6th P.M.
260' FSL 1448' FWL

FIGURE #1

SCALE: 1" = 60'
DATE: 12-09-11
DRAWN BY: J.J.
REVISED: 12-19-11

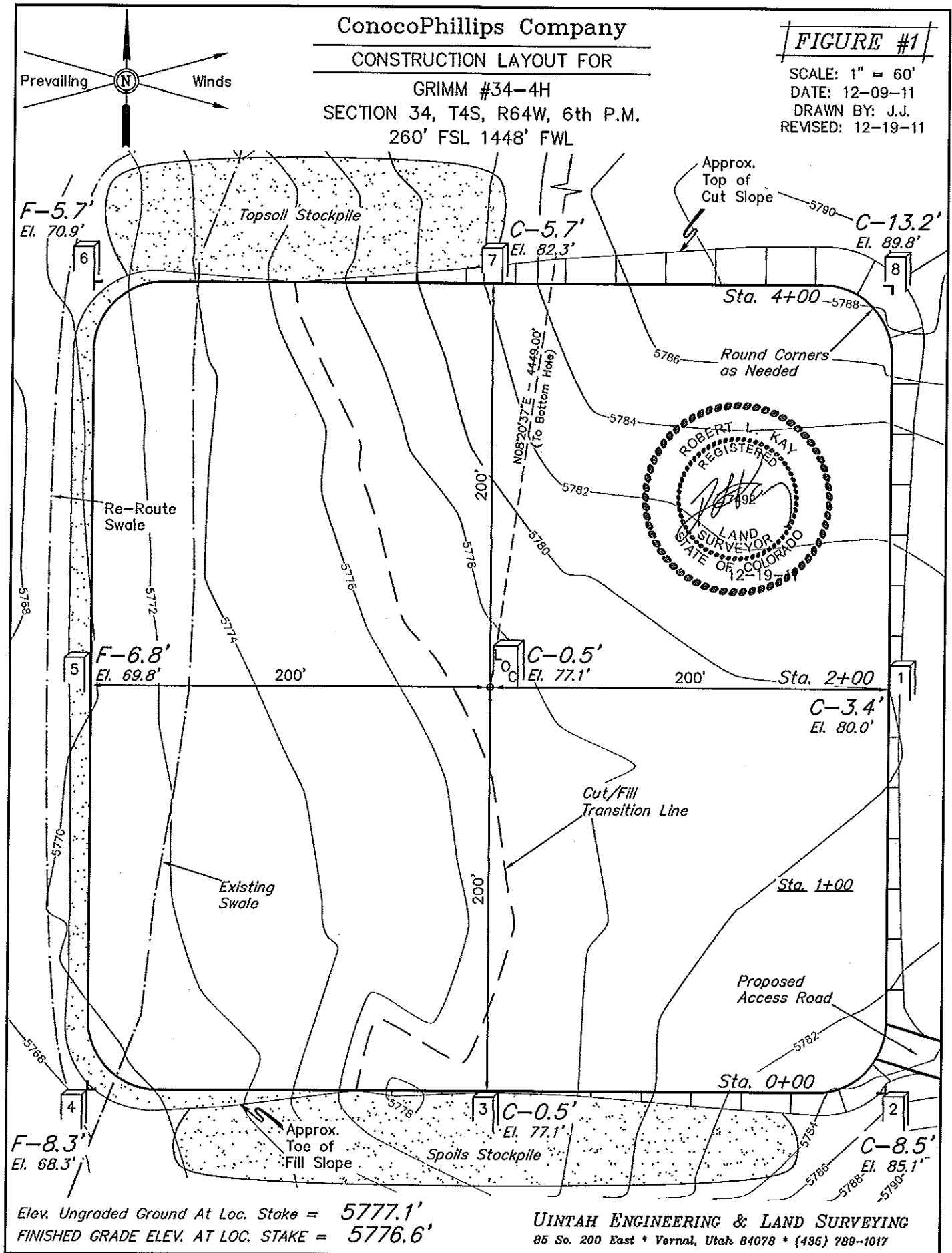

UINTAH ENGINEERING & LAND SURVEYING
85 So. 200 East * Vernal, Utah 84078 * (435) 789-1017

1" = 40'
X-Section
Scale
1" = 100'
DATE: 12-09-11
DRAWN BY: J.J.

ConocoPhillips Company
CONSTRUCTION LAYOUT CROSS SECTIONS FOR
GRIMM #34-4H
SECTION 34, T4S, R64W, 6th P.M.
260' FSL 1448' FWL

FIGURE #2

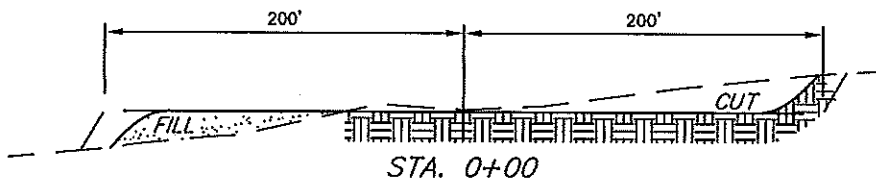
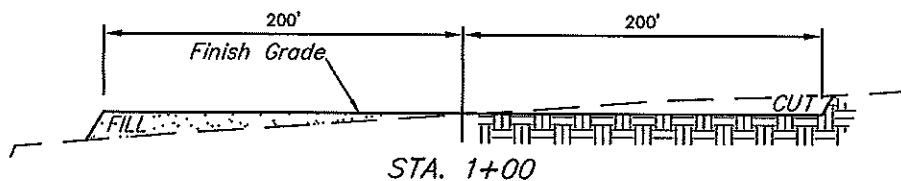
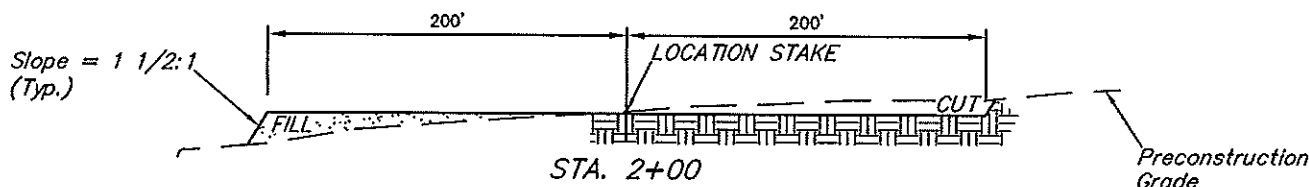
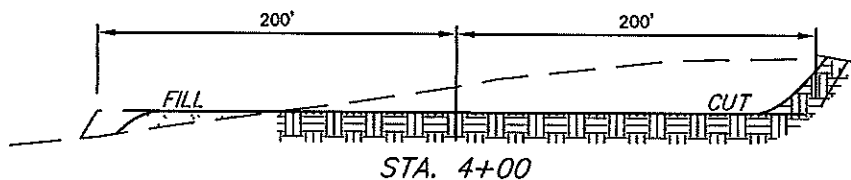

NOTE:

Topsoil should not be Stripped Below Finished Grade on Substructure Area.

APPROXIMATE ACREAGES
WELL SITE DISTURBANCE = ± 4.543 ACRES
ACCESS ROAD DISTURBANCE = ± 6.048 ACRES
TOTAL = ± 10.591 ACRES

* NOTE:
FILL QUANTITY INCLUDES 5% FOR COMPACTION

APPROXIMATE YARDAGES

(6") Topsoil Stripping = 3,250 Cu. Yds.
Remaining Location = 12,670 Cu. Yds.
TOTAL CUT = 15,920 CU.YDS.
FILL = 9,450 CU.YDS.

EXCESS MATERIAL = 6,470 Cu. Yds.
Topsoil = 3,250 Cu. Yds.

EXCESS UNBALANCE = 3,220 Cu. Yds.
(After Interim Rehabilitation)

UINTAH ENGINEERING & LAND SURVEYING
86 So. 200 East * Vernal, Utah 84078 * (435) 789-1017



ConocoPhillips Company
TYPICAL RIG LAYOUT FOR
GRIMM #34-4H
SECTION 34, T4S, R64W, 6th P.M.
260' FSL 1448' FWL

FIGURE #3

SCALE: 1" = 60'
DATE: 12-09-11
DRAWN BY: J.J.

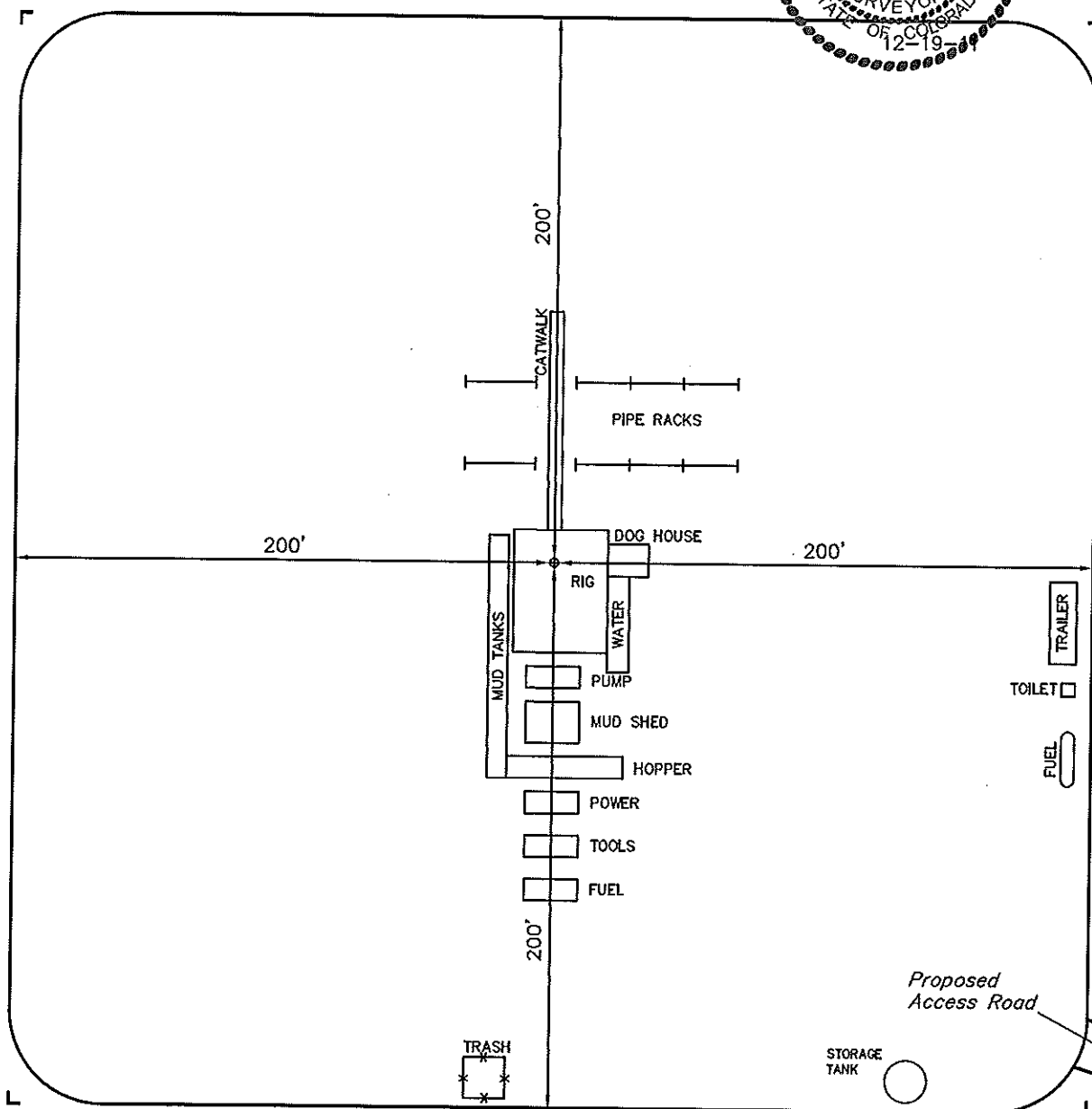



ConocoPhillips Company

RECLAMATION DIAGRAM FOR

GRIMM #34-4H

SECTION 34, T4S, R64W, 6th P.M.

260' FSL 1448' FWL

FIGURE #4

SCALE: 1" = 60'

DATE: 12-09-11

DRAWN BY: J.J.

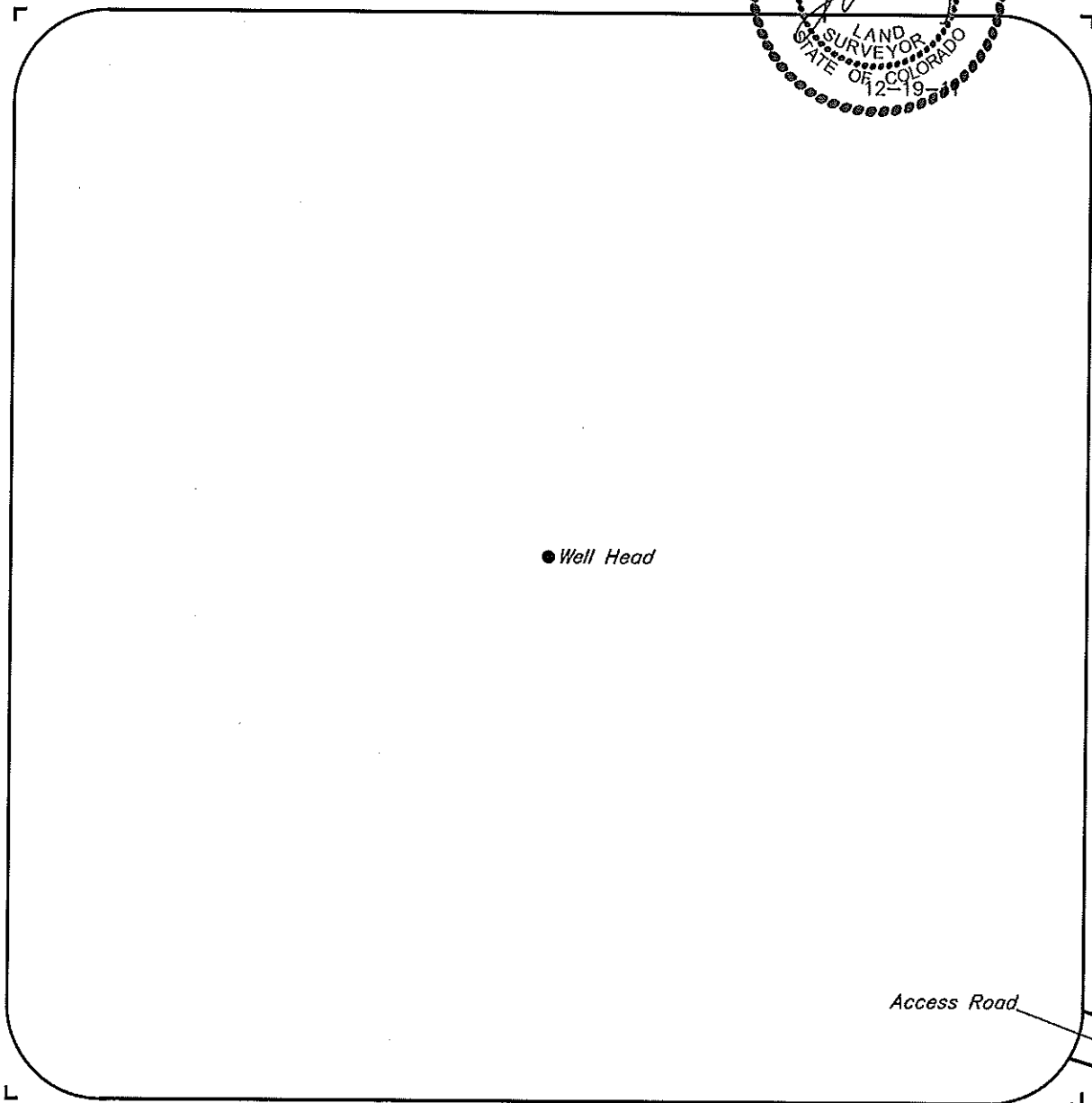

RECLAIMED AREA

UINTAH ENGINEERING & LAND SURVEYING
85 So. 200 East * Vernal, Utah 84078 * (435) 789-1017