

Steil Surveying Services, LLC

1102 West 19th Street P.O. BOX 2073

Cheyenne, Wyoming 82001

LOCATION DRAWING

DATE: 08/23/2011

THIS MAP DOES NOT REPRESENT A BOUNDARY SURVEY

SECTION 28
TOWNSHIP 3 NORTH
RANGE 64 WEST

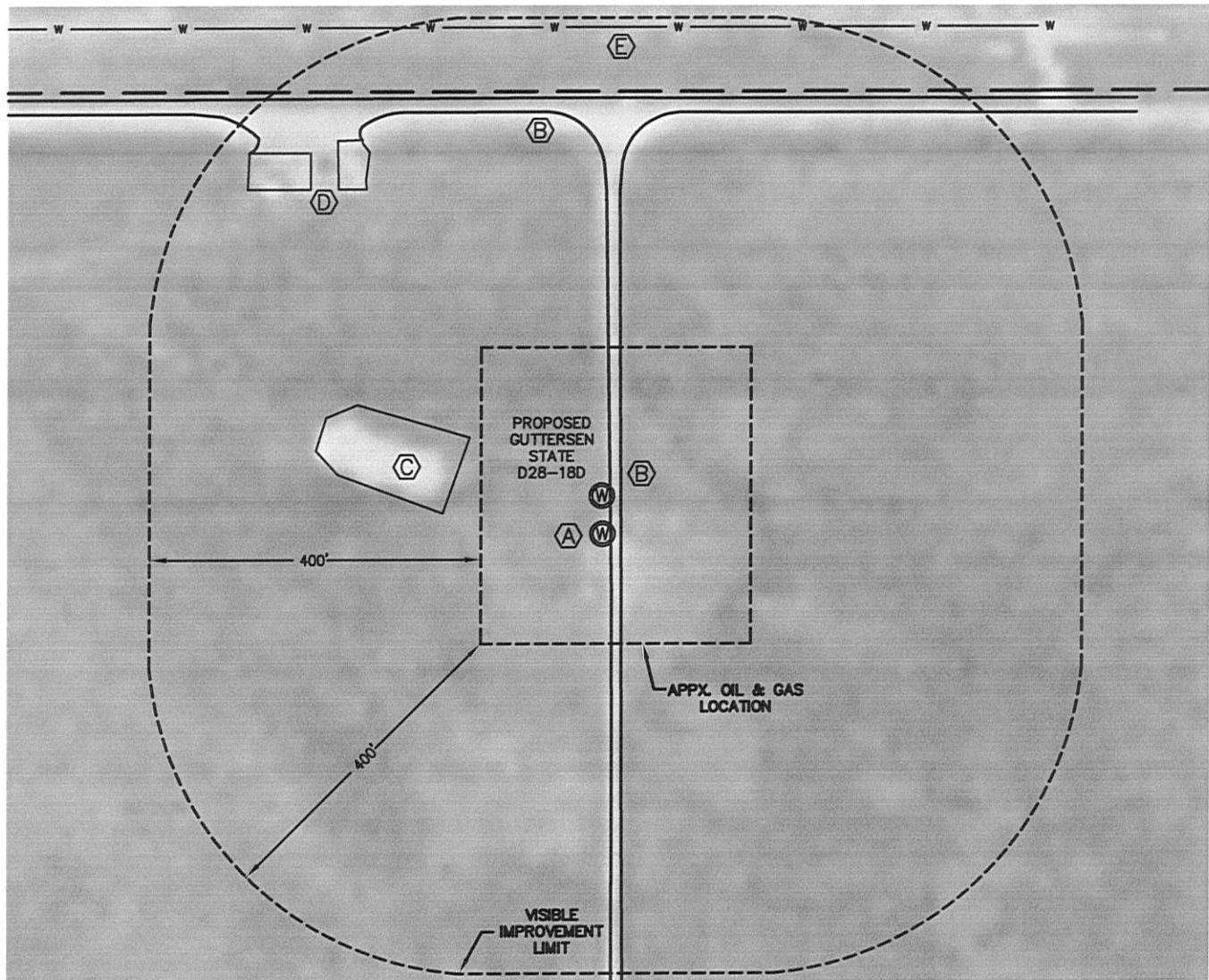

IMPROVEMENTS:

- (A) EXISTING SPIKE STATE GWS D28-03 - 47' SOUTH
- (B) GRAVEL ROADS - 10' EAST & 466' NORTH
- (C) LOW AREA - 175' WEST
- (D) EXISTING NOBLE ENERGY PRODUCTION FACILITY - 469' NORTHWEST
- (E) APX. WATER LINE - 570' NORTH

THE NEAREST OVERHEAD POWER LINE IS MORE THAN ONE MILE AWAY.

NEW WELL DATA

ELEV = 4791', PDOP: 1.9

NE $\frac{1}{4}$ NW $\frac{1}{4}$ SEC 28

491' FNL, 2087' FWL

LAT: N 40.20235

LONG: W 104.55825

NEAREST PROP LINE: 491' NORTH

NEAREST RAILROAD: MORE THAN ONE MILE AWAY

NEAREST BUILDING: MORE THAN ONE MILE AWAY

COUNTY ROAD NO. 34: 2.1 MILES NORTH

NOTICE: According to Colorado law you MUST commence any legal action based upon any defect in this W.L.C. within three years after you first discover such defect. In no event may any action based upon any defect in this W.L.C. be commenced more than ten years from this sold date of the certification shown hereon.

NOTE: The orientation of the oil & gas location as shown was determined by Noble Energy.

