

SECTION: 30  
TOWNSHIP: 6 N  
RANGE: 67 W

T 6 N  
R 67 W  
WELD COUNTY

**SURFACE LOCATION**  
NAD 83  
LAT = 40.45121°N  
LON = 104.92844°W  
P.D.O.P. = 2.5  
GPS OPERATOR= C VANMATRE

**BOTTOM HOLE LOCATION**  
NAD 83  
LAT = 40.45245°N  
LON = 104.92871°W  
P.D.O.P. = 2.5  
GPS OPERATOR= C VANMATRE

**SURFACE LOCATION**  
NAD 27  
LAT = 40.45122°N  
LON = 104.92791°W  
P.D.O.P. = 2.5  
GPS OPERATOR= C VANMATRE

**BOTTOM HOLE LOCATION**  
NAD 27  
LAT = 40.45247°N  
LON = 104.92818°W  
P.D.O.P. = 2.5  
GPS OPERATOR= C VANMATRE

**PROTRACTED POSITION**



**SESE**

N 09°32'46" W 460'  
618'  
540'  
188'  
643'

(BASIS OF BEARINGS)

N 89°17'08" E 2417.68' FND 2.5" AC PLS #23513  
N 88°30'32" E 2503.85' FND 3.25" AC PLS #20685  
N 00°09'40" E 2630.06' FND 2.5" AC PLS #31169  
N 89°14'16" E 2414.89' FND 3.25" AC PLS #22098  
N 89°14'47" E 2506.25' FND 3.25" AC PLS #22098  
N 00°09'48" E 2629.71' FND 2.5" AC PLS #31169  
S 88°28'35" W 2461.35' FND 2.5" AC PLS #31169  
S 88°28'35" W 2461.35' FND 2.5" AC PLS #31169  
S 00°09'16" W 2660.27' FND 3.25" AC PLS #20685  
S 00°09'16" W 2563.91' FND 3.25" AC PLS #22098  
S 00°09'43" W 2461.35' FND 2.5" AC PLS #31169  
S 00°13'21" W 2628.09' FND 3.25" AC PLS #22098  
S 00°50'44" E 2596.66' FND 3.25" AC PLS #22098

LEGEND:

-  SECTION CORNER (AS NOTED)  
 PROPOSED WELL LOCATION  
 PROPOSED BOTTOM HOLE LOCATION

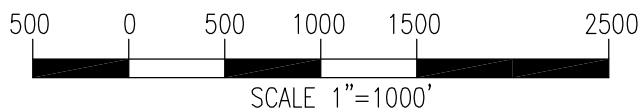

NOTES:

1. THIS SURVEY WAS DONE BY GPS METHODS AND CONFORMS TO THE MINIMUM STANDARDS AS SET BY THE C.O.G.C.C. RULE NO. 215.
2. ELEVATIONS SHOWN AT THE WELL HEAD, AS WELL AS HORIZONTAL CONTROL, ARE BASED ON GPS-RTK VALUES DERIVED FROM DOING 2-HOUR STATIC GPS SESSIONS AND REDUCTIONS USING O.P.U.S. SOLUTIONS.
- VERTICAL = NAVD88 HORIZONTAL = NAD83/92
3. THE BEARINGS AS SHOWN HEREON ARE BASED ON GPS OBSERVATIONS BETWEEN THE MONUMENTS SHOWN HEREON AS FOUND IN THE FIELD DATE BELOW.
4. DISTANCES SHOWN ARE AT GROUND LEVEL, AS MEASURED IN THE FIELD, WITH TIES TO WELLS MEASURED AT A PERPENDICULAR TO SECTION LINES.

I, RICHARD B. GABRIEL, A LICENSED PROFESSIONAL LAND SURVEYOR IN THE STATE OF COLORADO DO HEREBY CERTIFY TO:  
**GREAT WESTERN OIL AND GAS COMPANY** THAT THE SURVEY AND WELL LOCATION CERTIFICATE SHOWN HEREON WAS DONE BY ME OR UNDER MY DIRECT SUPERVISION AND THAT THE DRAWING SHOWN HEREON ACCURATELY DEPICTS THE PROPOSED LOCATION OF THE WELL **RAINDANCE 30-44**.  
 THIS CERTIFICATE DOES NOT REPRESENT A LAND SURVEY PLAT OR IMPROVEMENT SURVEY PLAT AS DEFINED BY C.R.S. 38-51-102 AND CANNOT BE RELIED UPON TO DETERMINE OWNERSHIP.

RICHARD B. GABRIEL P.L.S. #37929  
COLORADO LICENSED PROFESSIONAL LAND SURVEYOR  
FOR AND ON BEHALF OF POWER SURVEYING CO., INC.

NOTICE: ACCORDING TO COLORADO LAW YOU MUST COMMENCE ANY LEGAL ACTION BASED UPON ANY DEFECT IN THIS SURVEY WITHIN THREE YEARS AFTER YOU FIRST DISCOVER SUCH DEFECT. IN NO EVENT MAY ANY ACTION BASED ON ANY DEFECT IN THIS SURVEY BE COMMENCED MORE THAN TEN YEARS FROM THIS SAID DATE OF THIS CERTIFICATION SHOWN HEREON.

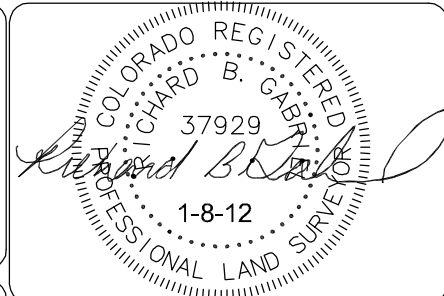

120 W. 84TH AVENUE  
THORNTON, COLORADO 80260

PH. 303-702-1617  
FAX. 303-702-1488

WWW.POWERSURVEYING.COM

DATE OF FIELD WORK: 12-28-11  
DATE OF COMPLETION: 1-8-12  
PROJECT NUMBER: 501-11-185A