

Steil Surveying Services, LLC

1102 West 19th Street P.O. BOX 2073

Cheyenne, Wyoming 82001

LOCATION DRAWING

SECTION 2
TOWNSHIP 3 NORTH
RANGE 64 WEST

DATE: 09/08/2011

THIS MAP DOES NOT REPRESENT A BOUNDARY SURVEY

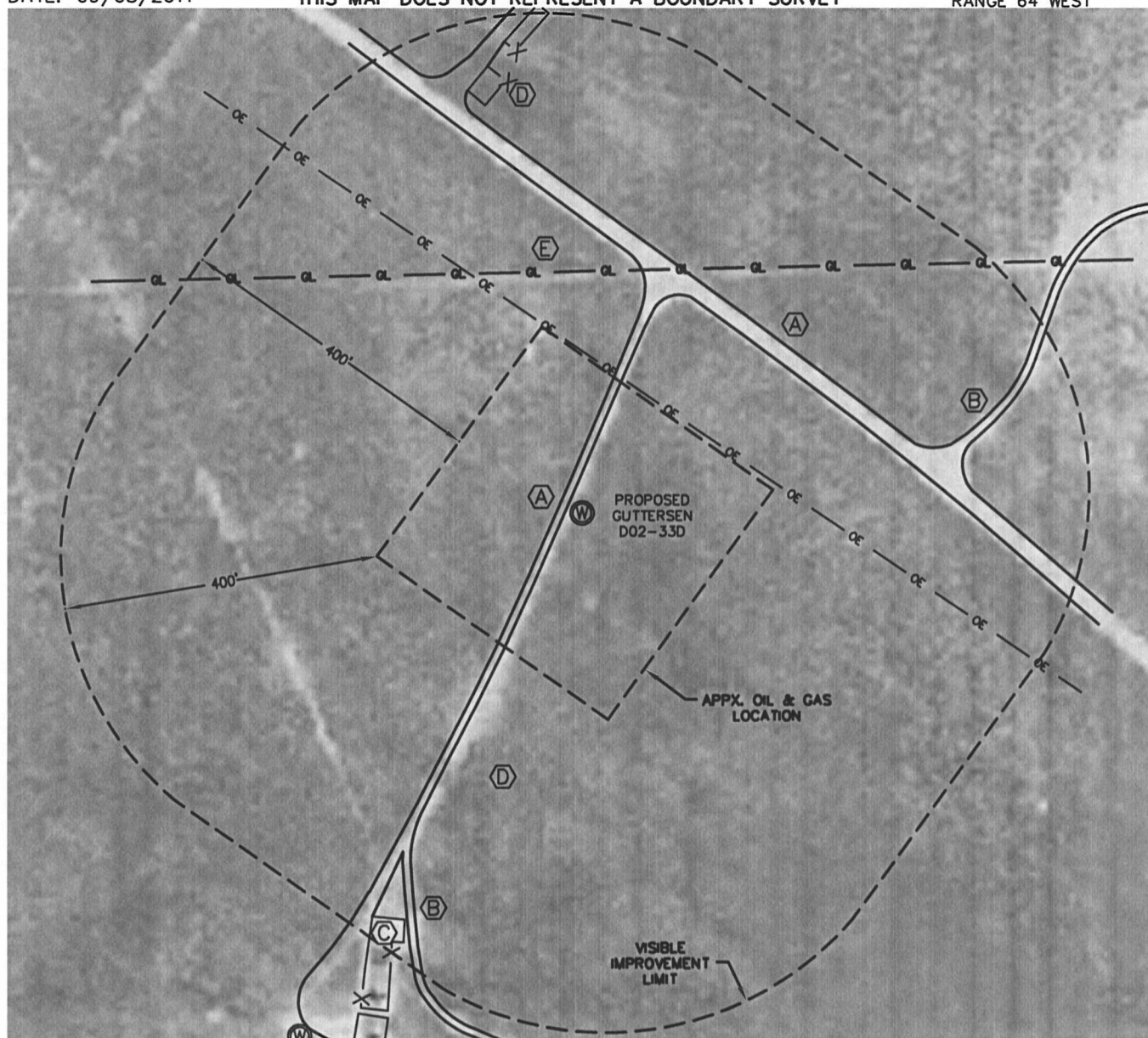

IMPROVEMENTS:

- (A) GRAVEL ROADS - 20' WEST & 304' NORTHEAST
- (B) DIRT ROADS - 475' EAST & 496' SOUTHWEST
- (C) NOBLE ENERGY PRODUCTION FACILITY - 565' SOUTHWEST
- (D) NOBLE ENERGY PRODUCTION FACILITY - 535' NORTHWEST
- (E) APX. BURIED GAS LINE - 309' NORTH

THE NEAREST OVERHEAD POWER LINE IS 170' NORTHEAST.

NOTICE: According to Colorado law you MUST commence any legal action based upon any defect in this W.L.C. within three years after you first discover such defect. In no event may any action based upon any defect in this W.L.C. be commenced more than ten years from this said date of the certification shown hereon.

NOTE: The orientation of the oil & gas location as shown was determined by Noble Energy.

NEW WELL DATA

ELEV = 4699', PDOP: 2.0

NE $\frac{1}{4}$ SW $\frac{1}{4}$ SEC 2

1647' FSL, 1350' FWL

LAT: N 40.25167

LONG: W 104.52293

NEAREST PROP LINE: 1012' NORTH

NEAREST RAILROAD: MORE THAN ONE MILE AWAY

NEAREST BUILDING: MORE THAN ONE MILE AWAY

COUNTY ROAD NO. 57: 1680'+/- NORTHWEST

