

804 Grand Ave.
Platteville, CO 80651

Tel: 970.785.5000
Fax: 970.785.5099
www.nobleenergyinc.com

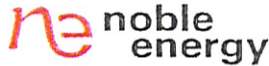

Land Department

September 28, 2011

CERTIFIED MAIL
RETURN RECEIPT REQUESTED

Article #: 70110470000023580602

Timmerman & Sons Feeding Co. Inc.
P.O. Box 367
Springfield, Nebraska

Re: Advance Notice of Drilling Operations
WELL NAME: TIMMERMAN G13-18D, 20D, 21D, 22D, 32D, 33D
Township 4 North, Range 65 West, 6th P.M.
Section 13: SE/4NW/4
Weld County, Colorado

Dear Surface Owner:

Pursuant to Rule 305.e.(1).B of the Rules and Regulations of the Colorado Oil and Gas Conservation Commission ("COGCC"), Noble Energy, Inc. ("Noble") hereby gives notice to you that it intends to commence operations for the drilling of a well or wells for oil and/or gas on the referenced lands no sooner than October 28, 2011. As surface owner you have the responsibility for notifying any affected tenant of the proposed operations.

The attached plat illustrates the area, per COGCC rules, orders or policies, within which the well(s) may be located and the proposed location of the well(s) access road(s) and production facilities. The location of roads and facilities as depicted on the attached plat are only proposed locations. Prior to commencing these operations, we would like to consult with you concerning the proposed operation and to finalize the location of the well site(s), production facilities, pipelines and roads. The location will be staked before the consultation and I will contact you to discuss the proposed operations and to schedule an on-site consultation, if you request one. I may be reached at 970-785-5052. Enclosed is a postage prepaid postcard for your use in requesting a consultation. If you wish to appoint a tenant for the consultation, please indicate the name, address and telephone number in the space provided on the postcard. Please fill out the postcard and return it to Noble within ten (10) days from the date of this letter.

Also enclosed is a copy of the COGCC's brochure describing surface owner rights and responsibilities.

Regards,
NOBLE ENERGY, INC.

A handwritten signature in black ink, appearing to read 'Nate McCorkell'.

Nate McCorkell
Land Negotiator

cc: David Bauer

TIMMERMAN G13-18D, 20D, 21D, 22D, 32D, 33D
SECTION 13-TOWNSHIP 4 NORTH, RANGE 65 WEST
OF THE SIXTH PRINCIPAL MERIDIAN
WELD COUNTY, COLORADO

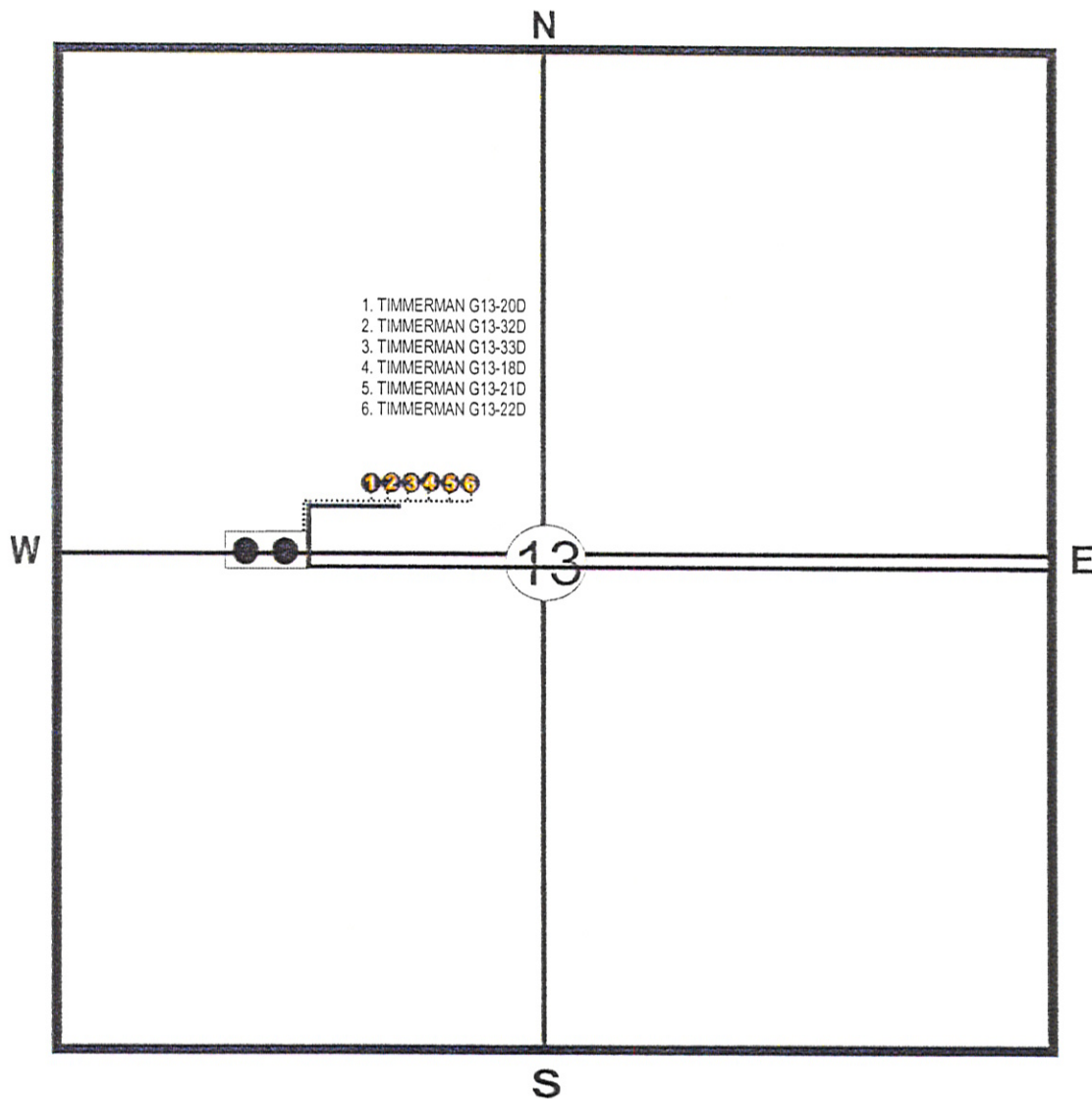

● PROPOSED WELL LOCATION

■ PROPOSED TANK FACILITY LOCATION

----- PROPOSED FLOWLINES

—— PROPOSED ACCESS ROAD