



Lat40°, Inc. 1635 Foxtrail Drive, Suite 325 Loveland, CO 970-776-3321





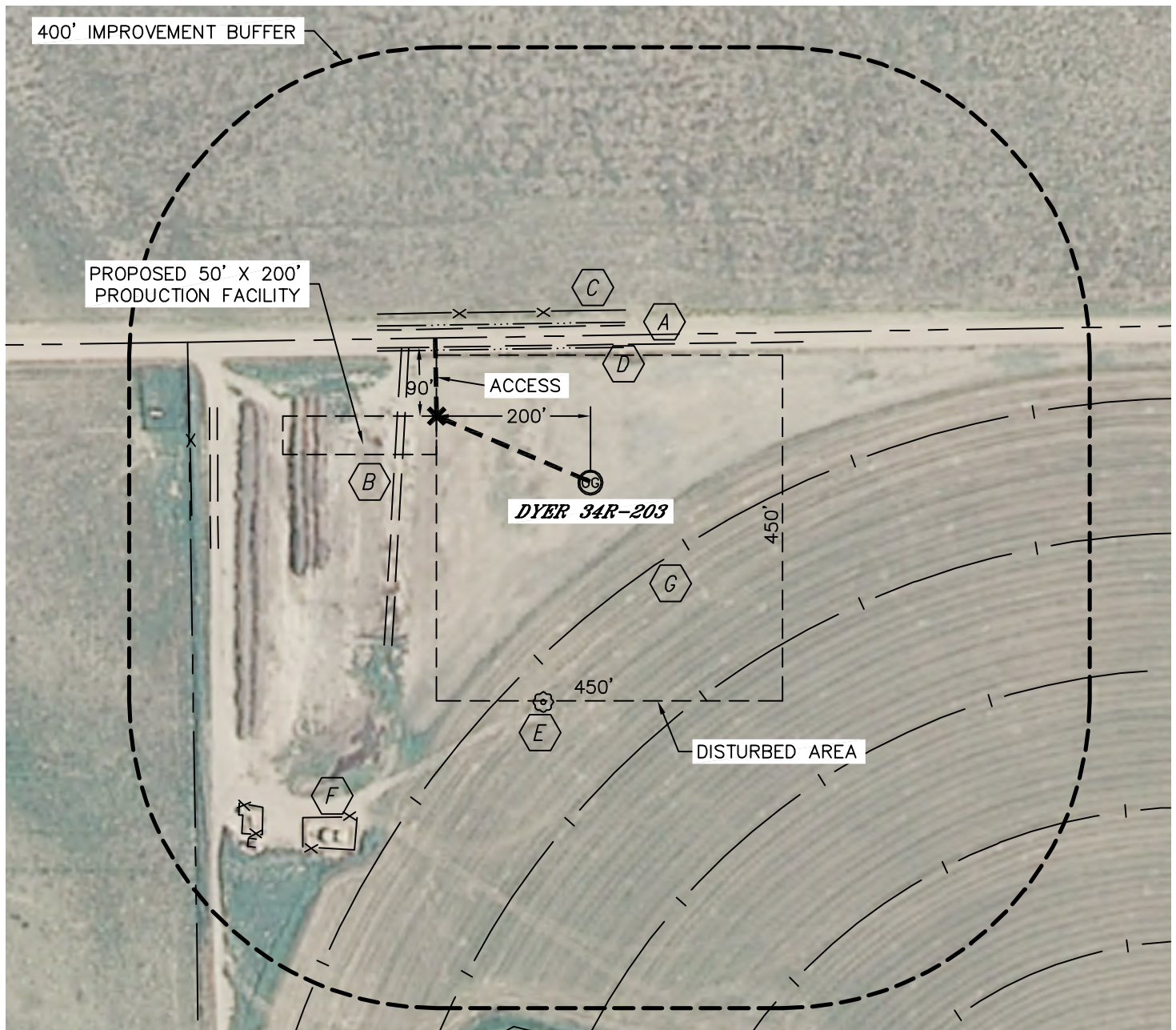

LOCATION DRAWING

DYER 34R-203

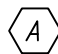
SECTION: 34
TOWNSHIP: 7N
RANGE: 64W

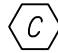
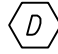

IMPROVEMENTS:

- | | | | |
|---|----------------------------|---|--|
|  | COUNTY ROAD 76 179' N |  | EX. PRODUCTION EQUIPMENT (PDC)
531', 600' & 636' SW |
|  | FIELD ROAD 246' & 485 W |  | PIVOT TRACK 136', 311', 489', 668' SE |
|  | FENCE 223' N, 520' W | | |
|  | BARROW DITCH 175' & 208' N | | |
|  | EX. O&G WELL 292' SW | | |

LEGEND

 - REFERENCE POINT
ALL DISTANCES ARE APPROXIMATE.

NEAREST: BUILDING 1816' NE, PUBLIC ROAD (CR 76) 179' N,
ABOVE GROUND UTILITY 2098' E, RAILROAD 5280'+, PROPERTY LINE 191' N

