

Well Details: Carney CT EL AL 45X35

TVD Reference: GL 5347' @ 5347.00ft (Ground Level) Ground Level: 5347.00

+N/-S	+E/-W	Northing	Easting	Latitude	Longitude	Slot
0.00	0.00	1299010.22	2074058.75	40° 6' 24.180 N	108° 48' 39.850 W	

T M Azimuths to True North
Magnetic North: 10.74°

Magnetic Field
Strength: 52431.5nT
Dip Angle: 66.08°
Date: 12/02/2011
Model: IGRF2010

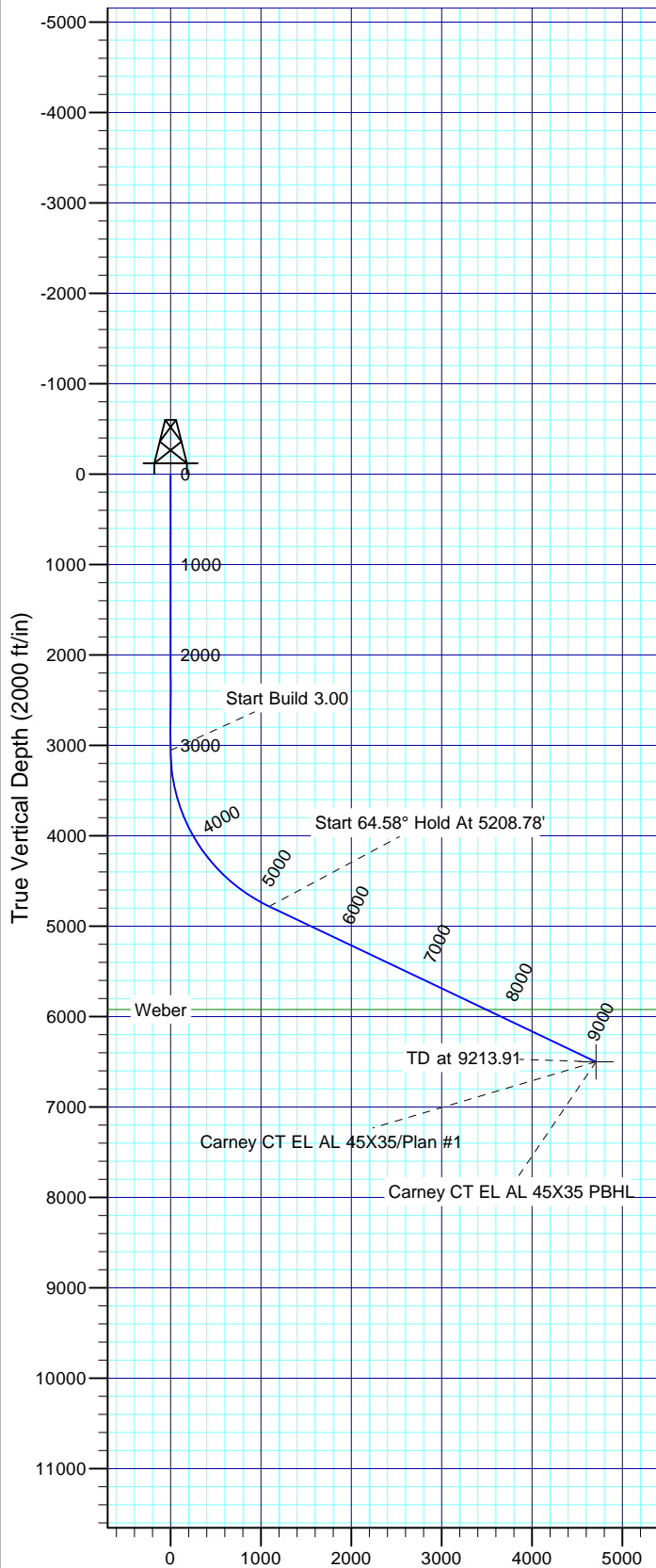

Vertical Section at 136.45° (2000 ft/in)

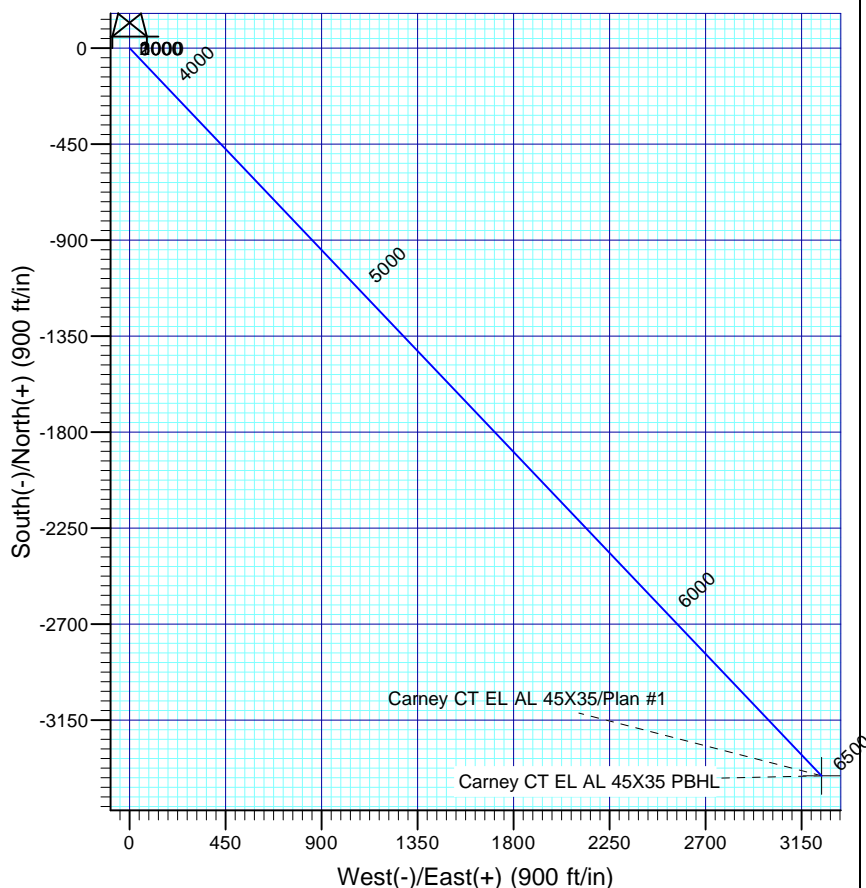

FORMATION TOP DETAILS

TVDPath	MDPath	Formation
5921.00	7864.88	Weber

Plan: Plan #1

12:19, December 28 2011
Created By: Rex Hall

PROJECT DETAILS: Rio Blanco County, CO (NAD 83)

Geodetic System: US State Plane 1983
Datum: North American Datum 1983
Ellipsoid: GRS 1980
Zone: Colorado Northern Zone

System Datum: Mean Sea Level

SECTION DETAILS

Sec	MD	Inc	Azi	TVD	+N/-S	+E/-W	Dleg	TFace	VSect	Target
1	0.00	0.00	0.00	0.00	0.00	0.00	0.00	0.00	0.00	
2	3056.00	0.00	0.00	3056.00	0.00	0.00	0.00	0.00	0.00	
3	5208.78	64.58	136.45	4781.00	-790.09	751.12	3.00	136.451090.15		
4	9213.91	64.58	136.45	6500.00	-3411.87	3243.59	0.00	0.004707.63		Carney CT EL AL 45X35 PBHL

Chevron

Rio Blanco County, CO (NAD 83)

Carney CT EL AL 45X35

Carney CT EL AL 45X35

OH

Plan: Plan #1

Standard Planning Report

28 December, 2011

Scientific Drilling International

Planning Report

Database:	Rockies Compass Server	Local Co-ordinate Reference:	Well Carney CT EL AL 45X35
Company:	Chevron	TVD Reference:	GL 5347' @ 5347.00ft (Ground Level)
Project:	Rio Blanco County, CO (NAD 83)	MD Reference:	GL 5347' @ 5347.00ft (Ground Level)
Site:	Carney CT EL AL 45X35	North Reference:	True
Well:	Carney CT EL AL 45X35	Survey Calculation Method:	Minimum Curvature
Wellbore:	OH		
Design:	Plan #1		

Project	Rio Blanco County, CO (NAD 83)		
Map System:	US State Plane 1983	System Datum:	Mean Sea Level
Geo Datum:	North American Datum 1983		
Map Zone:	Colorado Northern Zone		

Site		Carney CT EL AL 45X35			
Site Position:		Northing:	1,299,010.22 usft	Latitude:	40° 6' 24.180 N
From:	Lat/Long	Easting:	2,074,058.75 usft	Longitude:	108° 48' 39.850 W
Position Uncertainty:	0.00 ft	Slot Radius:	13.200 in	Grid Convergence:	-2.14 °

Well	Carney CT EL AL 45X35, NE 1/4 NW 1/4 Sec. 35 T2N R102W					
Well Position	+N/-S	0.00 ft	Northing:	1,299,010.22 usft	Latitude:	40° 6' 24.180 N
	+E/-W	0.00 ft	Easting:	2,074,058.75 usft	Longitude:	108° 48' 39.850 W
Position Uncertainty		0.00 ft	Wellhead Elevation:		Ground Level:	5,347.00 ft

Wellbore	OH				
Magnetics	Model Name	Sample Date	Declination (°)	Dip Angle (°)	Field Strength (nT)
	IGRF2010	12/02/11	10.74	66.08	52,431

Design	Plan #1			
Audit Notes:				
Version:	Phase:	PLAN	Tie On Depth:	0.00
Vertical Section:	Depth From (TVD)	+N/-S (ft)	+E/-W (ft)	Direction (°)
	0.00	0.00	0.00	136.45

Plan Sections										
Measured Depth (ft)	Inclination (°)	Azimuth (°)	Vertical Depth (ft)	+N/-S (ft)	+E/-W (ft)	Dogleg Rate (°/100ft)	Build Rate (°/100ft)	Turn Rate (°/100ft)	TFO (°)	Target
0.00	0.00	0.00	0.00	0.00	0.00	0.00	0.00	0.00	0.00	
3,056.00	0.00	0.00	3,056.00	0.00	0.00	0.00	0.00	0.00	0.00	
5,208.78	64.58	136.45	4,781.00	-790.09	751.12	3.00	3.00	0.00	136.45	
9,213.91	64.58	136.45	6,500.00	-3,411.87	3,243.60	0.00	0.00	0.00	0.00	Carney CT EL AL 45>

Scientific Drilling International

Planning Report

Database:	Rockies Compass Server	Local Co-ordinate Reference:	Well Carney CT EL AL 45X35
Company:	Chevron	TVD Reference:	GL 5347' @ 5347.00ft (Ground Level)
Project:	Rio Blanco County, CO (NAD 83)	MD Reference:	GL 5347' @ 5347.00ft (Ground Level)
Site:	Carney CT EL AL 45X35	North Reference:	True
Well:	Carney CT EL AL 45X35	Survey Calculation Method:	Minimum Curvature
Wellbore:	OH		
Design:	Plan #1		

Planned Survey									
Measured Depth (ft)	Inclination (°)	Azimuth (°)	Vertical Depth (ft)	+N/-S (ft)	+E/-W (ft)	Vertical Section (ft)	Dogleg Rate (°/100ft)	Build Rate (°/100ft)	Turn Rate (°/100ft)
0.00	0.00	0.00	0.00	0.00	0.00	0.00	0.00	0.00	0.00
100.00	0.00	0.00	100.00	0.00	0.00	0.00	0.00	0.00	0.00
200.00	0.00	0.00	200.00	0.00	0.00	0.00	0.00	0.00	0.00
300.00	0.00	0.00	300.00	0.00	0.00	0.00	0.00	0.00	0.00
400.00	0.00	0.00	400.00	0.00	0.00	0.00	0.00	0.00	0.00
500.00	0.00	0.00	500.00	0.00	0.00	0.00	0.00	0.00	0.00
600.00	0.00	0.00	600.00	0.00	0.00	0.00	0.00	0.00	0.00
700.00	0.00	0.00	700.00	0.00	0.00	0.00	0.00	0.00	0.00
800.00	0.00	0.00	800.00	0.00	0.00	0.00	0.00	0.00	0.00
900.00	0.00	0.00	900.00	0.00	0.00	0.00	0.00	0.00	0.00
1,000.00	0.00	0.00	1,000.00	0.00	0.00	0.00	0.00	0.00	0.00
1,100.00	0.00	0.00	1,100.00	0.00	0.00	0.00	0.00	0.00	0.00
1,200.00	0.00	0.00	1,200.00	0.00	0.00	0.00	0.00	0.00	0.00
1,300.00	0.00	0.00	1,300.00	0.00	0.00	0.00	0.00	0.00	0.00
1,400.00	0.00	0.00	1,400.00	0.00	0.00	0.00	0.00	0.00	0.00
1,500.00	0.00	0.00	1,500.00	0.00	0.00	0.00	0.00	0.00	0.00
1,600.00	0.00	0.00	1,600.00	0.00	0.00	0.00	0.00	0.00	0.00
1,700.00	0.00	0.00	1,700.00	0.00	0.00	0.00	0.00	0.00	0.00
1,800.00	0.00	0.00	1,800.00	0.00	0.00	0.00	0.00	0.00	0.00
1,900.00	0.00	0.00	1,900.00	0.00	0.00	0.00	0.00	0.00	0.00
2,000.00	0.00	0.00	2,000.00	0.00	0.00	0.00	0.00	0.00	0.00
2,100.00	0.00	0.00	2,100.00	0.00	0.00	0.00	0.00	0.00	0.00
2,200.00	0.00	0.00	2,200.00	0.00	0.00	0.00	0.00	0.00	0.00
2,300.00	0.00	0.00	2,300.00	0.00	0.00	0.00	0.00	0.00	0.00
2,400.00	0.00	0.00	2,400.00	0.00	0.00	0.00	0.00	0.00	0.00
2,500.00	0.00	0.00	2,500.00	0.00	0.00	0.00	0.00	0.00	0.00
2,600.00	0.00	0.00	2,600.00	0.00	0.00	0.00	0.00	0.00	0.00
2,700.00	0.00	0.00	2,700.00	0.00	0.00	0.00	0.00	0.00	0.00
2,800.00	0.00	0.00	2,800.00	0.00	0.00	0.00	0.00	0.00	0.00
2,900.00	0.00	0.00	2,900.00	0.00	0.00	0.00	0.00	0.00	0.00
3,000.00	0.00	0.00	3,000.00	0.00	0.00	0.00	0.00	0.00	0.00
3,056.00	0.00	0.00	3,056.00	0.00	0.00	0.00	0.00	0.00	0.00
Start Build 3.00									
3,100.00	1.32	136.45	3,100.00	-0.37	0.35	0.51	3.00	3.00	0.00
3,200.00	4.32	136.45	3,199.86	-3.93	3.74	5.43	3.00	3.00	0.00
3,300.00	7.32	136.45	3,299.34	-11.28	10.72	15.57	3.00	3.00	0.00
3,400.00	10.32	136.45	3,398.14	-22.39	21.29	30.90	3.00	3.00	0.00
3,500.00	13.32	136.45	3,496.01	-37.24	35.40	51.38	3.00	3.00	0.00
3,600.00	16.32	136.45	3,592.67	-55.77	53.02	76.95	3.00	3.00	0.00
3,700.00	19.32	136.45	3,687.87	-77.95	74.10	107.55	3.00	3.00	0.00
3,800.00	22.32	136.45	3,781.32	-103.71	98.59	143.09	3.00	3.00	0.00
3,900.00	25.32	136.45	3,872.80	-132.97	126.42	183.47	3.00	3.00	0.00
4,000.00	28.32	136.45	3,962.03	-165.67	157.50	228.59	3.00	3.00	0.00
4,100.00	31.32	136.45	4,048.78	-201.71	191.76	278.31	3.00	3.00	0.00
4,200.00	34.32	136.45	4,132.81	-240.98	229.10	332.50	3.00	3.00	0.00
4,300.00	37.32	136.45	4,213.88	-283.39	269.42	391.02	3.00	3.00	0.00
4,400.00	40.32	136.45	4,291.79	-328.82	312.60	453.70	3.00	3.00	0.00
4,500.00	43.32	136.45	4,366.30	-377.14	358.54	520.37	3.00	3.00	0.00
4,600.00	46.32	136.45	4,437.23	-428.22	407.10	590.85	3.00	3.00	0.00
4,700.00	49.32	136.45	4,504.36	-481.92	458.16	664.95	3.00	3.00	0.00
4,800.00	52.32	136.45	4,567.53	-538.10	511.56	742.46	3.00	3.00	0.00
4,900.00	55.32	136.45	4,626.56	-596.59	567.17	823.16	3.00	3.00	0.00
5,000.00	58.32	136.45	4,681.28	-657.24	624.83	906.85	3.00	3.00	0.00
5,100.00	61.32	136.45	4,731.55	-719.89	684.38	993.28	3.00	3.00	0.00

Scientific Drilling International

Planning Report

Database:	Rockies Compass Server	Local Co-ordinate Reference:	Well Carney CT EL AL 45X35
Company:	Chevron	TVD Reference:	GL 5347' @ 5347.00ft (Ground Level)
Project:	Rio Blanco County, CO (NAD 83)	MD Reference:	GL 5347' @ 5347.00ft (Ground Level)
Site:	Carney CT EL AL 45X35	North Reference:	True
Well:	Carney CT EL AL 45X35	Survey Calculation Method:	Minimum Curvature
Wellbore:	OH		
Design:	Plan #1		

Planned Survey									
Measured Depth (ft)	Inclination (°)	Azimuth (°)	Vertical Depth (ft)	+N/-S (ft)	+E/-W (ft)	Vertical Section (ft)	Dogleg Rate (°/100ft)	Build Rate (°/100ft)	Turn Rate (°/100ft)
5,200.00	64.32	136.45	4,777.22	-784.35	745.67	1,082.23	3.00	3.00	0.00
5,208.78	64.58	136.45	4,781.00	-790.09	751.12	1,090.15	3.00	3.00	0.00
Start 64.58° Hold At 5208.78'									
5,300.00	64.58	136.45	4,820.16	-849.81	807.89	1,172.54	0.00	0.00	0.00
5,400.00	64.58	136.45	4,863.08	-915.27	870.13	1,262.87	0.00	0.00	0.00
5,500.00	64.58	136.45	4,906.00	-980.73	932.36	1,353.19	0.00	0.00	0.00
5,600.00	64.58	136.45	4,948.92	-1,046.19	994.59	1,443.51	0.00	0.00	0.00
5,700.00	64.58	136.45	4,991.84	-1,111.65	1,056.82	1,533.83	0.00	0.00	0.00
5,800.00	64.58	136.45	5,034.76	-1,177.11	1,119.05	1,624.15	0.00	0.00	0.00
5,900.00	64.58	136.45	5,077.68	-1,242.57	1,181.29	1,714.47	0.00	0.00	0.00
6,000.00	64.58	136.45	5,120.60	-1,308.03	1,243.52	1,804.79	0.00	0.00	0.00
6,100.00	64.58	136.45	5,163.52	-1,373.49	1,305.75	1,895.11	0.00	0.00	0.00
6,200.00	64.58	136.45	5,206.44	-1,438.95	1,367.98	1,985.43	0.00	0.00	0.00
6,300.00	64.58	136.45	5,249.36	-1,504.41	1,430.21	2,075.75	0.00	0.00	0.00
6,400.00	64.58	136.45	5,292.28	-1,569.87	1,492.45	2,166.08	0.00	0.00	0.00
6,500.00	64.58	136.45	5,335.20	-1,635.33	1,554.68	2,256.40	0.00	0.00	0.00
6,600.00	64.58	136.45	5,378.12	-1,700.79	1,616.91	2,346.72	0.00	0.00	0.00
6,700.00	64.58	136.45	5,421.04	-1,766.25	1,679.14	2,437.04	0.00	0.00	0.00
6,800.00	64.58	136.45	5,463.96	-1,831.71	1,741.37	2,527.36	0.00	0.00	0.00
6,900.00	64.58	136.45	5,506.87	-1,897.17	1,803.61	2,617.68	0.00	0.00	0.00
7,000.00	64.58	136.45	5,549.79	-1,962.63	1,865.84	2,708.00	0.00	0.00	0.00
7,100.00	64.58	136.45	5,592.71	-2,028.09	1,928.07	2,798.32	0.00	0.00	0.00
7,200.00	64.58	136.45	5,635.63	-2,093.55	1,990.30	2,888.64	0.00	0.00	0.00
7,300.00	64.58	136.45	5,678.55	-2,159.01	2,052.53	2,978.97	0.00	0.00	0.00
7,400.00	64.58	136.45	5,721.47	-2,224.47	2,114.76	3,069.29	0.00	0.00	0.00
7,500.00	64.58	136.45	5,764.39	-2,289.93	2,177.00	3,159.61	0.00	0.00	0.00
7,600.00	64.58	136.45	5,807.31	-2,355.40	2,239.23	3,249.93	0.00	0.00	0.00
7,700.00	64.58	136.45	5,850.23	-2,420.86	2,301.46	3,340.25	0.00	0.00	0.00
7,800.00	64.58	136.45	5,893.15	-2,486.32	2,363.69	3,430.57	0.00	0.00	0.00
7,864.88	64.58	136.45	5,921.00	-2,528.79	2,404.07	3,489.17	0.00	0.00	0.00
Weber									
7,900.00	64.58	136.45	5,936.07	-2,551.78	2,425.92	3,520.89	0.00	0.00	0.00
8,000.00	64.58	136.45	5,978.99	-2,617.24	2,488.16	3,611.21	0.00	0.00	0.00
8,100.00	64.58	136.45	6,021.91	-2,682.70	2,550.39	3,701.53	0.00	0.00	0.00
8,200.00	64.58	136.45	6,064.83	-2,748.16	2,612.62	3,791.85	0.00	0.00	0.00
8,300.00	64.58	136.45	6,107.75	-2,813.62	2,674.85	3,882.18	0.00	0.00	0.00
8,400.00	64.58	136.45	6,150.67	-2,879.08	2,737.08	3,972.50	0.00	0.00	0.00
8,500.00	64.58	136.45	6,193.59	-2,944.54	2,799.32	4,062.82	0.00	0.00	0.00
8,600.00	64.58	136.45	6,236.51	-3,010.00	2,861.55	4,153.14	0.00	0.00	0.00
8,700.00	64.58	136.45	6,279.43	-3,075.46	2,923.78	4,243.46	0.00	0.00	0.00
8,800.00	64.58	136.45	6,322.35	-3,140.92	2,986.01	4,333.78	0.00	0.00	0.00
8,900.00	64.58	136.45	6,365.27	-3,206.38	3,048.24	4,424.10	0.00	0.00	0.00
9,000.00	64.58	136.45	6,408.19	-3,271.84	3,110.48	4,514.42	0.00	0.00	0.00
9,100.00	64.58	136.45	6,451.11	-3,337.30	3,172.71	4,604.74	0.00	0.00	0.00
9,200.00	64.58	136.45	6,494.03	-3,402.76	3,234.94	4,695.06	0.00	0.00	0.00
9,213.91	64.58	136.45	6,500.00	-3,411.87	3,243.60	4,707.63	0.00	0.00	0.00
TD at 9213.91									

Scientific Drilling International

Planning Report

Database:	Rockies Compass Server	Local Co-ordinate Reference:	Well Carney CT EL AL 45X35
Company:	Chevron	TVD Reference:	GL 5347' @ 5347.00ft (Ground Level)
Project:	Rio Blanco County, CO (NAD 83)	MD Reference:	GL 5347' @ 5347.00ft (Ground Level)
Site:	Carney CT EL AL 45X35	North Reference:	True
Well:	Carney CT EL AL 45X35	Survey Calculation Method:	Minimum Curvature
Wellbore:	OH		
Design:	Plan #1		

Design Targets									
Target Name	Dip Angle	Dip Dir.	TVD	+N/-S	+E/-W	Northing	Easting	Latitude	Longitude
- hit/miss target	(°)	(°)	(ft)	(ft)	(ft)	(usft)	(usft)		
- Shape									
Carney CT EL AL 45X35	0.00	0.00	6,500.00	-3,411.87	3,243.60	1,295,479.66	2,077,172.71	40° 5' 50.460 N	108° 47' 58.110 W
- plan hits target center									
- Point									

Formations					
Measured Depth	Vertical Depth	Name	Lithology	Dip	Dip Direction
(ft)	(ft)			(°)	(°)
7,864.88	5,921.00	Weber		0.00	

Plan Annotations				
Measured Depth	Vertical Depth	Local Coordinates		Comment
(ft)	(ft)	+N/-S (ft)	+E/-W (ft)	
3,056.00	3,056.00	0.00	0.00	Start Build 3.00
5,208.78	4,781.00	-790.09	751.12	Start 64.58° Hold At 5208.78'
9,213.91	6,500.00	-3,411.87	3,243.60	TD at 9213.91