

Facilities and Construction Layout Drawing Gentry B Pad Extension Section 17, Township 6 South, Range 92 West

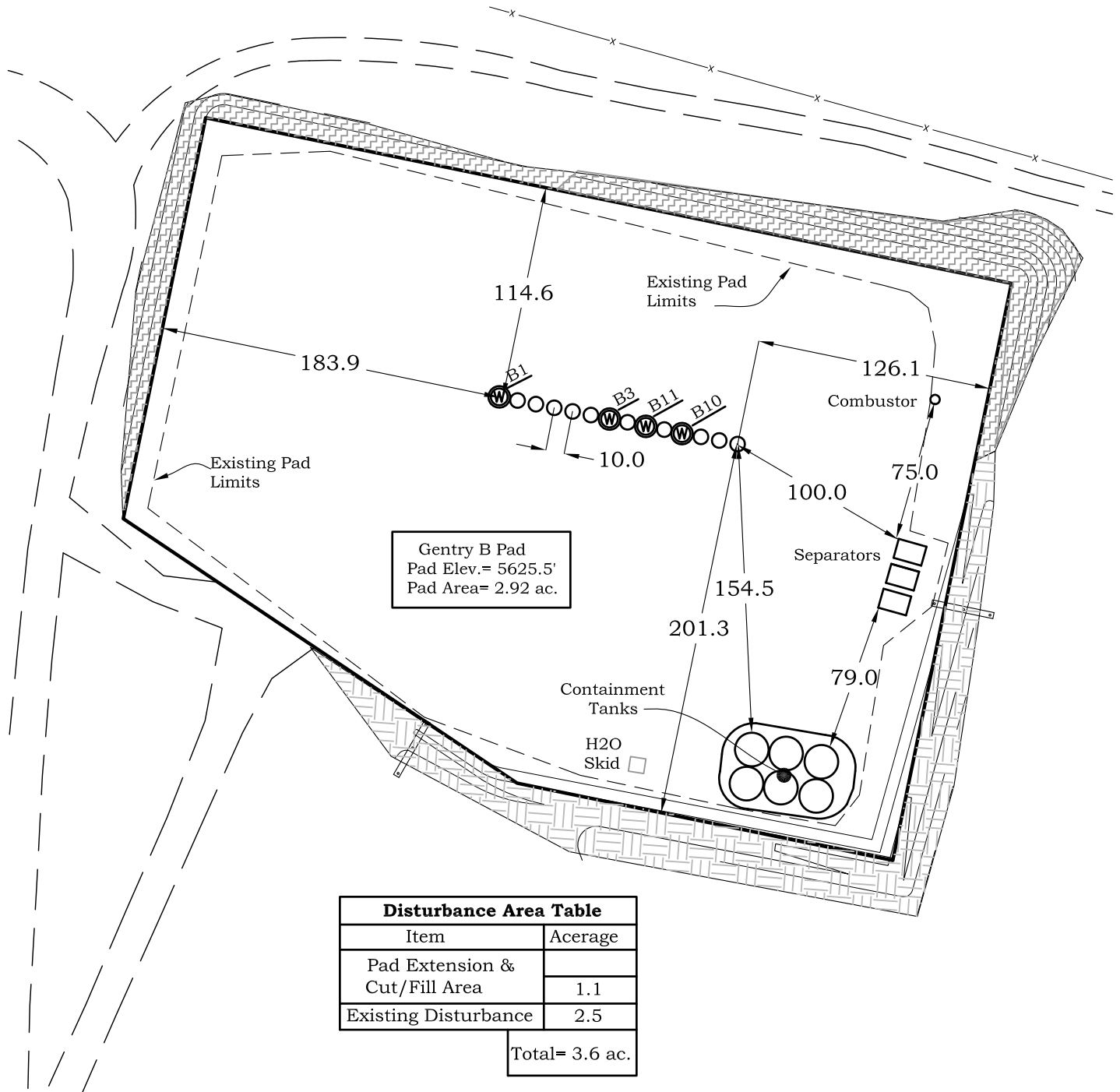

Disturbance Area Table	
Item	Acerage
Pad Extension & Cut/Fill Area	1.1
Existing Disturbance	2.5
Total= 3.6 ac.	

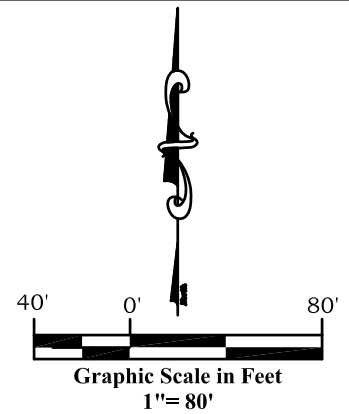

River Valley Survey, Inc.
110 East 3rd. Street, Suite 213
Rifle, Colorado 81650
Ph: 970-379-7846

Project: Gentry B PAD

Field Date: 11-15-11

Date: 12-12-11

Project No.: 06001-11

Scale: 1"= 80'

Sheet: 1 of 7

**Well Location Plat
Prepared For Antero Resources**

Situate In:
SE1/4NW1/4 Section 17, T6S., R. 92 W.
of the 6th P.M., Garfield County,
Colorado



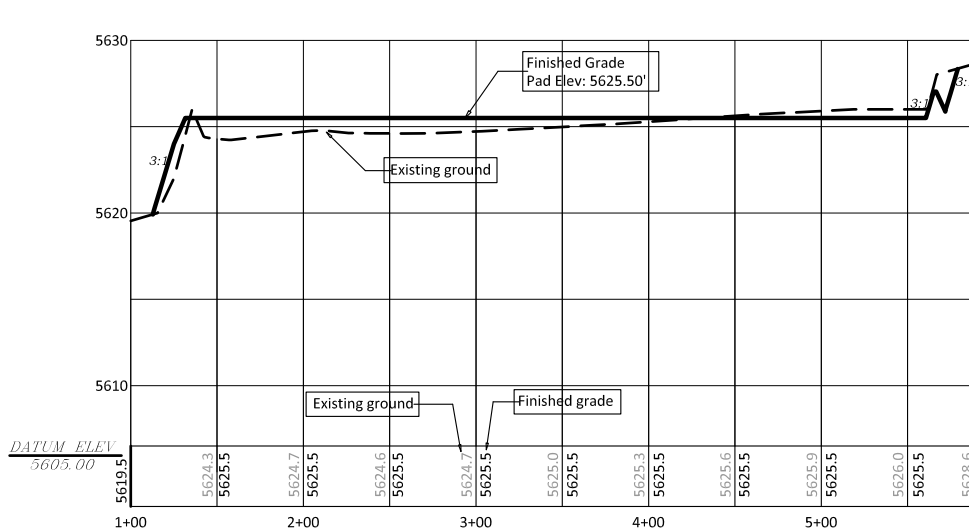

CROSS SECTION A-A'

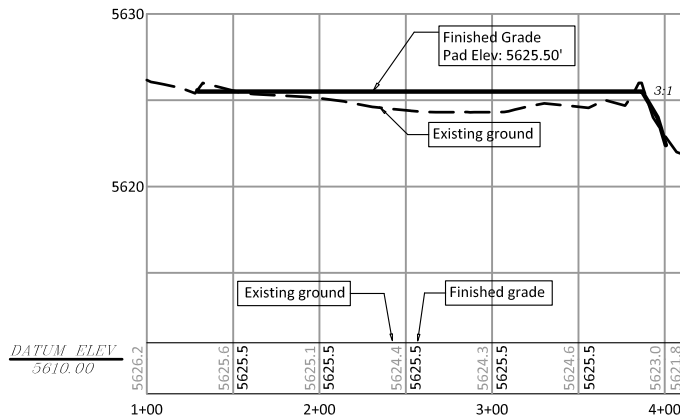
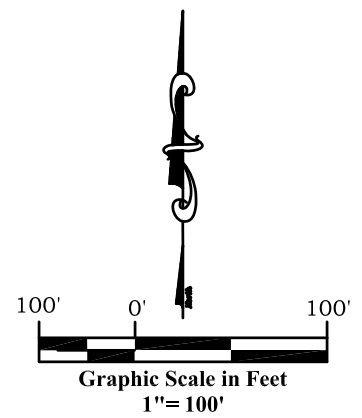

CROSS SECTION B-B'

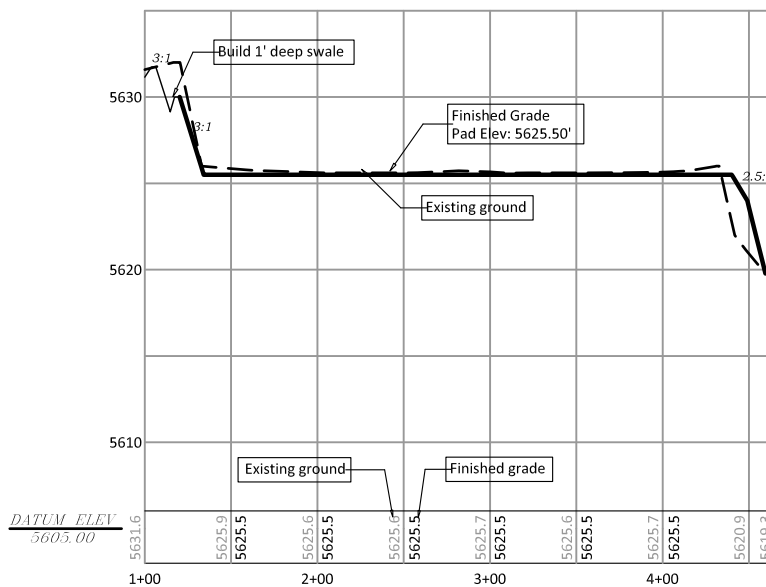

CROSS SECTION C-C'

CROSS SECTIONS Gentry B Pad Extension Section 17, Township 6 South, Range 92 West

TOTAL PAD GRADING
1,939 cu. yd. CUT
3,586 cu. yd. FILL

*assumes 15% compaction rate



River Valley Survey, Inc.
110 East 3rd. Street, Suite 213
Rifle, Colorado 81650
Ph: 970-379-7846

Project: Gentry B PAD

Field Date: 11-15-11

Date: 12-08-11

Project No.: 06001-11

Scale: 1" = 100'

Sheet: 4 of 7

Well Location Plat
Prepared For Antero Resources

Situate In:
SE1/4 NW1/4 Section 17, T6S., R. 92 W.
of the 6th P.M., Garfield County,
Colorado

