

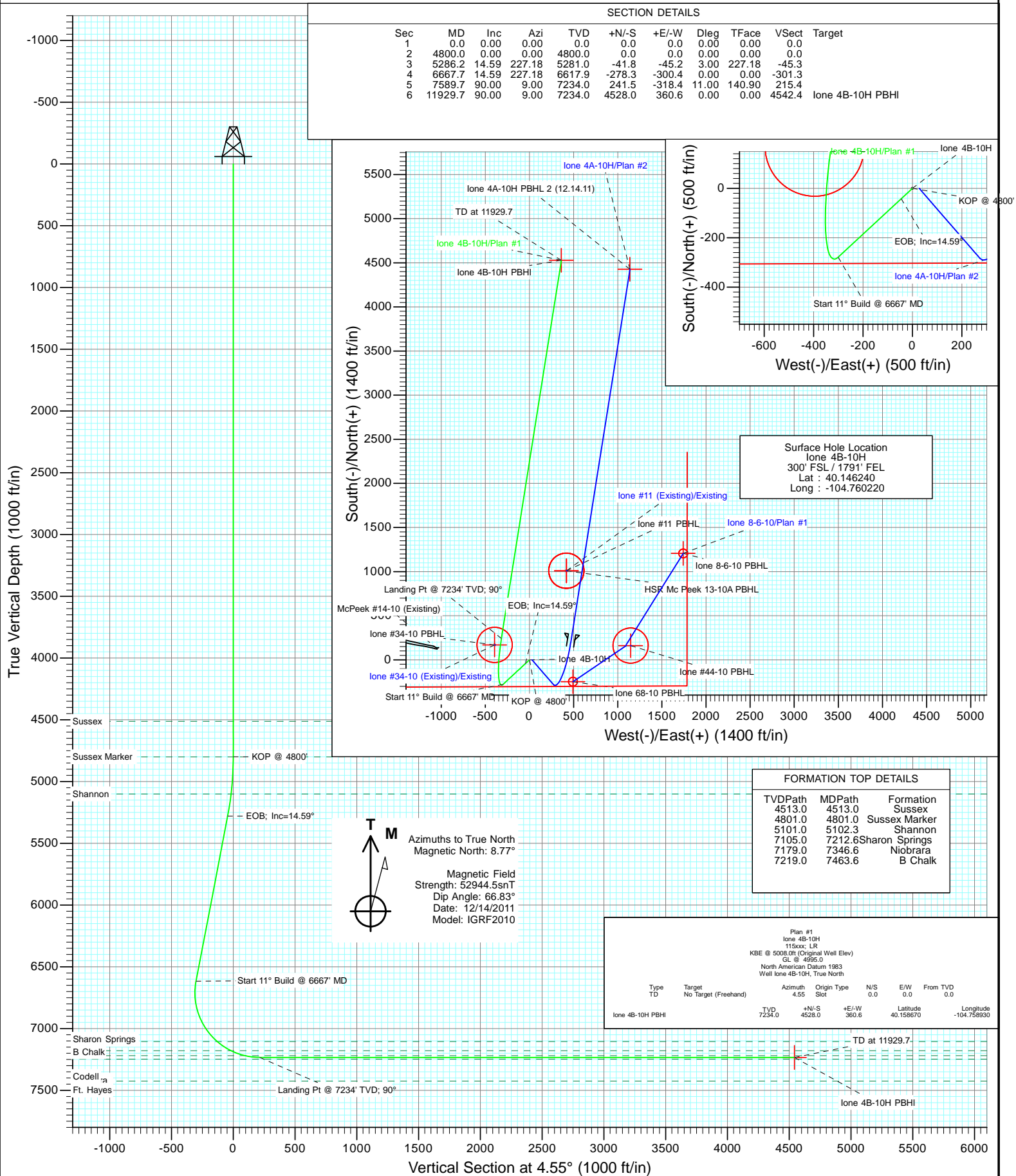

Project: DJ Wattenberg  
Site: SESE S10-T2N-R66W (Ione)  
Well: Ione 4B-10H  
Wellbore: HZ  
Design: Plan #1





Project: DJ Wattenberg  
Site: SESE S10-T2N-R66W (Ione)  
Well: Ione 4B-10H  
Wellbore: HZ  
Design: Plan #1

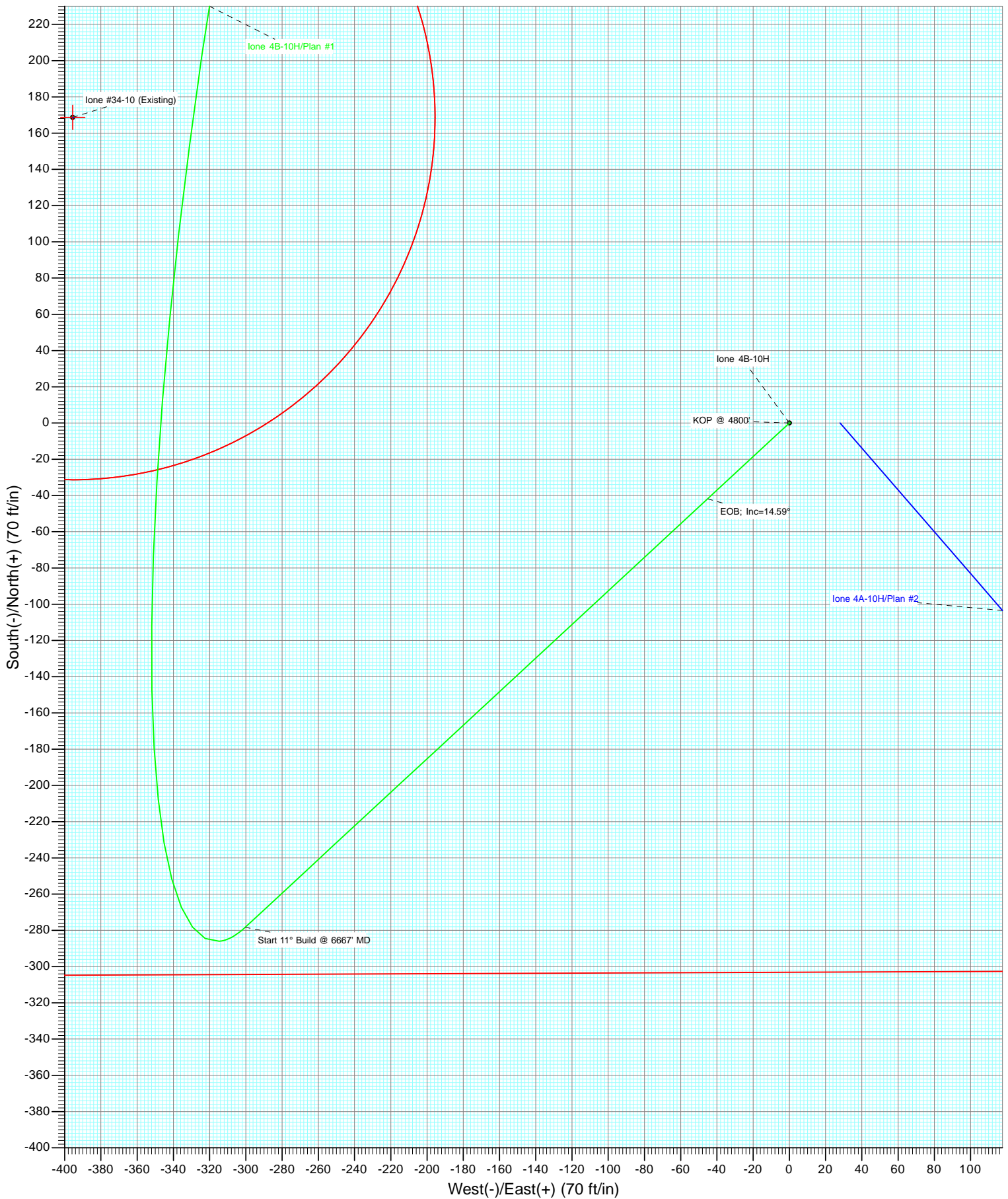

## Planning Report

<b>Database:</b>	USA EDM 5000 Multi Users DB	<b>Local Co-ordinate Reference:</b>	Well lone 4B-10H
<b>Company:</b>	EnCana Oil & Gas (USA) Inc	<b>TVD Reference:</b>	KBE @ 5008.0ft (Original Well Elev)
<b>Project:</b>	DJ Wattenberg	<b>MD Reference:</b>	KBE @ 5008.0ft (Original Well Elev)
<b>Site:</b>	SESE S10-T2N-R66W (lone)	<b>North Reference:</b>	True
<b>Well:</b>	lone 4B-10H	<b>Survey Calculation Method:</b>	Minimum Curvature
<b>Wellbore:</b>	HZ		
<b>Design:</b>	Plan #1		

<b>Project</b>	DJ Wattenberg		
<b>Map System:</b>	US State Plane 1983	<b>System Datum:</b>	Mean Sea Level
<b>Geo Datum:</b>	North American Datum 1983		
<b>Map Zone:</b>	Colorado Northern Zone		

Site		SESE S10-T2N-R66W (lone)			
Site Position:		Northing:	1,297,164.04 ft	Latitude:	40.146710
From:	Lat/Long	Easting:	3,207,875.24 ft	Longitude:	-104.756410
Position Uncertainty:	0.0 ft	Slot Radius:	13.200 in	Grid Convergence:	0.48 °

Well	lone 4B-10H					
Well Position	+N/-S	0.0 ft	Northing:	1,296,983.91 ft	Latitude:	40.146240
	+E/-W	0.0 ft	Easting:	3,206,811.61 ft	Longitude:	-104.760220
Position Uncertainty		0.0 ft	Wellhead Elevation:	ft	Ground Level:	4,995.0 ft

<b>Wellbore</b>	HZ				
<b>Magnetics</b>	<b>Model Name</b>	<b>Sample Date</b>	<b>Declination</b> (°)	<b>Dip Angle</b> (°)	<b>Field Strength</b> (nT)
	IGRF2010	12/14/2011	8.77	66.83	52,944

<b>Design</b>	Plan #1			
<b>Audit Notes:</b>				
<b>Version:</b>	<b>Phase:</b>	PLAN	<b>Tie On Depth:</b>	0.0
<b>Vertical Section:</b>	<b>Depth From (TVD)</b> (ft)	<b>+N/-S</b> (ft)	<b>+E/-W</b> (ft)	<b>Direction</b> (°)
	0.0	0.0	0.0	4.55

<b>Plan Sections</b>										
Measured Depth (ft)	Inclination (°)	Azimuth (°)	Vertical Depth (ft)	+N/-S (ft)	+E/-W (ft)	Dogleg Rate (°/100ft)	Build Rate (°/100ft)	Turn Rate (°/100ft)	TFO (°)	Target
0.0	0.00	0.00	0.0	0.0	0.0	0.00	0.00	0.00	0.00	
4,800.0	0.00	0.00	4,800.0	0.0	0.0	0.00	0.00	0.00	0.00	
5,286.2	14.59	227.18	5,281.0	-41.8	-45.2	3.00	3.00	0.00	227.18	
6,667.7	14.59	227.18	6,617.9	-278.3	-300.4	0.00	0.00	0.00	0.00	
7,589.7	90.00	9.00	7,234.0	241.5	-318.4	11.00	8.18	15.38	140.90	
11,929.7	90.00	9.00	7,234.0	4,528.0	360.6	0.00	0.00	0.00	0.00	lone 4B-10H PBHI

# Planning Report

<b>Database:</b>	USA EDM 5000 Multi Users DB	<b>Local Co-ordinate Reference:</b>	Well lone 4B-10H
<b>Company:</b>	EnCana Oil & Gas (USA) Inc	<b>TVD Reference:</b>	KBE @ 5008.0ft (Original Well Elev)
<b>Project:</b>	DJ Wattenberg	<b>MD Reference:</b>	KBE @ 5008.0ft (Original Well Elev)
<b>Site:</b>	SESE S10-T2N-R66W (lone)	<b>North Reference:</b>	True
<b>Well:</b>	lone 4B-10H	<b>Survey Calculation Method:</b>	Minimum Curvature
<b>Wellbore:</b>	HZ		
<b>Design:</b>	Plan #1		

Planned Survey									
Measured Depth (ft)	Inclination (°)	Azimuth (°)	Vertical Depth (ft)	+N/-S (ft)	+E/-W (ft)	Vertical Section (ft)	Dogleg Rate (°/100ft)	Build Rate (°/100ft)	Comments / Formations
0.0	0.00	0.00	0.0	0.0	0.0	0.0	0.00	0.00	
100.0	0.00	0.00	100.0	0.0	0.0	0.0	0.00	0.00	
200.0	0.00	0.00	200.0	0.0	0.0	0.0	0.00	0.00	
300.0	0.00	0.00	300.0	0.0	0.0	0.0	0.00	0.00	
400.0	0.00	0.00	400.0	0.0	0.0	0.0	0.00	0.00	
500.0	0.00	0.00	500.0	0.0	0.0	0.0	0.00	0.00	
600.0	0.00	0.00	600.0	0.0	0.0	0.0	0.00	0.00	
700.0	0.00	0.00	700.0	0.0	0.0	0.0	0.00	0.00	
800.0	0.00	0.00	800.0	0.0	0.0	0.0	0.00	0.00	
900.0	0.00	0.00	900.0	0.0	0.0	0.0	0.00	0.00	
1,000.0	0.00	0.00	1,000.0	0.0	0.0	0.0	0.00	0.00	
1,100.0	0.00	0.00	1,100.0	0.0	0.0	0.0	0.00	0.00	
1,200.0	0.00	0.00	1,200.0	0.0	0.0	0.0	0.00	0.00	
1,300.0	0.00	0.00	1,300.0	0.0	0.0	0.0	0.00	0.00	
1,400.0	0.00	0.00	1,400.0	0.0	0.0	0.0	0.00	0.00	
1,500.0	0.00	0.00	1,500.0	0.0	0.0	0.0	0.00	0.00	
1,600.0	0.00	0.00	1,600.0	0.0	0.0	0.0	0.00	0.00	
1,700.0	0.00	0.00	1,700.0	0.0	0.0	0.0	0.00	0.00	
1,800.0	0.00	0.00	1,800.0	0.0	0.0	0.0	0.00	0.00	
1,900.0	0.00	0.00	1,900.0	0.0	0.0	0.0	0.00	0.00	
2,000.0	0.00	0.00	2,000.0	0.0	0.0	0.0	0.00	0.00	
2,100.0	0.00	0.00	2,100.0	0.0	0.0	0.0	0.00	0.00	
2,200.0	0.00	0.00	2,200.0	0.0	0.0	0.0	0.00	0.00	
2,300.0	0.00	0.00	2,300.0	0.0	0.0	0.0	0.00	0.00	
2,400.0	0.00	0.00	2,400.0	0.0	0.0	0.0	0.00	0.00	
2,500.0	0.00	0.00	2,500.0	0.0	0.0	0.0	0.00	0.00	
2,600.0	0.00	0.00	2,600.0	0.0	0.0	0.0	0.00	0.00	
2,700.0	0.00	0.00	2,700.0	0.0	0.0	0.0	0.00	0.00	
2,800.0	0.00	0.00	2,800.0	0.0	0.0	0.0	0.00	0.00	
2,900.0	0.00	0.00	2,900.0	0.0	0.0	0.0	0.00	0.00	
3,000.0	0.00	0.00	3,000.0	0.0	0.0	0.0	0.00	0.00	
3,100.0	0.00	0.00	3,100.0	0.0	0.0	0.0	0.00	0.00	
3,200.0	0.00	0.00	3,200.0	0.0	0.0	0.0	0.00	0.00	
3,300.0	0.00	0.00	3,300.0	0.0	0.0	0.0	0.00	0.00	
3,400.0	0.00	0.00	3,400.0	0.0	0.0	0.0	0.00	0.00	
3,500.0	0.00	0.00	3,500.0	0.0	0.0	0.0	0.00	0.00	
3,600.0	0.00	0.00	3,600.0	0.0	0.0	0.0	0.00	0.00	
3,700.0	0.00	0.00	3,700.0	0.0	0.0	0.0	0.00	0.00	
3,800.0	0.00	0.00	3,800.0	0.0	0.0	0.0	0.00	0.00	
3,900.0	0.00	0.00	3,900.0	0.0	0.0	0.0	0.00	0.00	
4,000.0	0.00	0.00	4,000.0	0.0	0.0	0.0	0.00	0.00	
4,100.0	0.00	0.00	4,100.0	0.0	0.0	0.0	0.00	0.00	
4,200.0	0.00	0.00	4,200.0	0.0	0.0	0.0	0.00	0.00	
4,300.0	0.00	0.00	4,300.0	0.0	0.0	0.0	0.00	0.00	
4,400.0	0.00	0.00	4,400.0	0.0	0.0	0.0	0.00	0.00	
4,500.0	0.00	0.00	4,500.0	0.0	0.0	0.0	0.00	0.00	
4,513.0	0.00	0.00	4,513.0	0.0	0.0	0.0	0.00	0.00	Sussex
4,600.0	0.00	0.00	4,600.0	0.0	0.0	0.0	0.00	0.00	
4,700.0	0.00	0.00	4,700.0	0.0	0.0	0.0	0.00	0.00	
4,800.0	0.00	0.00	4,800.0	0.0	0.0	0.0	0.00	0.00	KOP @ 4800'
4,801.0	0.03	227.18	4,801.0	0.0	0.0	0.0	3.00	3.00	Sussex Marker
4,900.0	3.00	227.18	4,900.0	-1.8	-1.9	-1.9	3.00	3.00	

# Planning Report

<b>Database:</b>	USA EDM 5000 Multi Users DB	<b>Local Co-ordinate Reference:</b>	Well lone 4B-10H
<b>Company:</b>	EnCana Oil & Gas (USA) Inc	<b>TVD Reference:</b>	KBE @ 5008.0ft (Original Well Elev)
<b>Project:</b>	DJ Wattenberg	<b>MD Reference:</b>	KBE @ 5008.0ft (Original Well Elev)
<b>Site:</b>	SESE S10-T2N-R66W (lone)	<b>North Reference:</b>	True
<b>Well:</b>	lone 4B-10H	<b>Survey Calculation Method:</b>	Minimum Curvature
<b>Wellbore:</b>	HZ		
<b>Design:</b>	Plan #1		

Planned Survey									
Measured Depth (ft)	Inclination (°)	Azimuth (°)	Vertical Depth (ft)	+N/-S (ft)	+E/-W (ft)	Vertical Section (ft)	Dogleg Rate (°/100ft)	Build Rate (°/100ft)	Comments / Formations
5,000.0	6.00	227.18	4,999.6	-7.1	-7.7	-7.7	3.00	3.00	
5,100.0	9.00	227.18	5,098.8	-16.0	-17.2	-17.3	3.00	3.00	
5,102.3	9.07	227.18	5,101.0	-16.2	-17.5	-17.6	3.00	3.00	Shannon
5,200.0	12.00	227.18	5,197.1	-28.4	-30.6	-30.7	3.00	3.00	
5,286.2	14.59	227.18	5,281.0	-41.8	-45.2	-45.3	3.00	3.00	EOB; Inc=14.59°
5,300.0	14.59	227.18	5,294.3	-44.2	-47.7	-47.8	0.00	0.00	
5,400.0	14.59	227.18	5,391.1	-61.3	-66.2	-66.4	0.00	0.00	
5,500.0	14.59	227.18	5,487.9	-78.4	-84.6	-84.9	0.00	0.00	
5,600.0	14.59	227.18	5,584.7	-95.6	-103.1	-103.4	0.00	0.00	
5,700.0	14.59	227.18	5,681.4	-112.7	-121.6	-122.0	0.00	0.00	
5,800.0	14.59	227.18	5,778.2	-129.8	-140.1	-140.5	0.00	0.00	
5,900.0	14.59	227.18	5,875.0	-146.9	-158.5	-159.0	0.00	0.00	
6,000.0	14.59	227.18	5,971.8	-164.0	-177.0	-177.6	0.00	0.00	
6,100.0	14.59	227.18	6,068.5	-181.1	-195.5	-196.1	0.00	0.00	
6,200.0	14.59	227.18	6,165.3	-198.3	-214.0	-214.6	0.00	0.00	
6,300.0	14.59	227.18	6,262.1	-215.4	-232.4	-233.1	0.00	0.00	
6,400.0	14.59	227.18	6,358.9	-232.5	-250.9	-251.7	0.00	0.00	
6,500.0	14.59	227.18	6,455.6	-249.6	-269.4	-270.2	0.00	0.00	
6,600.0	14.59	227.18	6,552.4	-266.7	-287.8	-288.7	0.00	0.00	
6,667.7	14.59	227.18	6,617.9	-278.3	-300.4	-301.3	0.00	0.00	Start 11° Build @ 6667' MD
6,700.0	12.04	237.98	6,649.4	-282.9	-306.2	-306.3	11.00	-7.90	
6,800.0	9.66	298.03	6,747.9	-284.5	-322.5	-309.2	11.00	-2.38	
6,900.0	16.78	336.76	6,845.3	-267.2	-335.6	-293.0	11.00	7.12	
7,000.0	26.64	350.30	6,938.2	-231.7	-345.1	-258.4	11.00	9.86	
7,100.0	37.12	356.73	7,023.0	-179.3	-350.6	-206.6	11.00	10.48	
7,200.0	47.81	0.61	7,096.7	-112.0	-352.0	-139.5	11.00	10.69	
7,212.6	49.16	1.01	7,105.0	-102.6	-351.8	-130.2	11.00	10.75	Sharon Springs
7,300.0	58.59	3.36	7,156.5	-32.1	-349.1	-59.7	11.00	10.78	
7,346.6	63.62	4.42	7,179.0	8.6	-346.3	-18.9	11.00	10.82	Niobrara
7,400.0	69.41	5.54	7,200.3	57.4	-342.0	30.1	11.00	10.83	
7,463.6	76.31	6.75	7,219.0	117.7	-335.5	90.7	11.00	10.85	B Chalk
7,500.0	80.26	7.42	7,226.4	153.1	-331.1	126.4	11.00	10.85	
7,589.7	90.00	9.00	7,234.0	241.5	-318.4	215.4	11.00	10.86	Landing Pt @ 7234' TVD; 90°
7,600.0	90.00	9.00	7,234.0	251.7	-316.8	225.7	0.00	0.00	
7,700.0	90.00	9.00	7,234.0	350.4	-301.1	325.4	0.00	0.00	
7,800.0	90.00	9.00	7,234.0	449.2	-285.5	425.1	0.00	0.00	
7,900.0	90.00	9.00	7,234.0	548.0	-269.8	524.8	0.00	0.00	
8,000.0	90.00	9.00	7,234.0	646.7	-254.2	624.5	0.00	0.00	
8,100.0	90.00	9.00	7,234.0	745.5	-238.5	724.2	0.00	0.00	
8,200.0	90.00	9.00	7,234.0	844.3	-222.9	823.9	0.00	0.00	
8,300.0	90.00	9.00	7,234.0	943.0	-207.2	923.6	0.00	0.00	
8,400.0	90.00	9.00	7,234.0	1,041.8	-191.6	1,023.3	0.00	0.00	
8,500.0	90.00	9.00	7,234.0	1,140.6	-176.0	1,123.0	0.00	0.00	
8,600.0	90.00	9.00	7,234.0	1,239.3	-160.3	1,222.7	0.00	0.00	
8,700.0	90.00	9.00	7,234.0	1,338.1	-144.7	1,322.4	0.00	0.00	
8,800.0	90.00	9.00	7,234.0	1,436.9	-129.0	1,422.1	0.00	0.00	
8,900.0	90.00	9.00	7,234.0	1,535.7	-113.4	1,521.8	0.00	0.00	
9,000.0	90.00	9.00	7,234.0	1,634.4	-97.7	1,621.5	0.00	0.00	
9,100.0	90.00	9.00	7,234.0	1,733.2	-82.1	1,721.2	0.00	0.00	
9,200.0	90.00	9.00	7,234.0	1,832.0	-66.5	1,820.9	0.00	0.00	
9,300.0	90.00	9.00	7,234.0	1,930.7	-50.8	1,920.6	0.00	0.00	
9,400.0	90.00	9.00	7,234.0	2,029.5	-35.2	2,020.3	0.00	0.00	

## Planning Report

<b>Database:</b>	USA EDM 5000 Multi Users DB	<b>Local Co-ordinate Reference:</b>	Well lone 4B-10H
<b>Company:</b>	EnCana Oil & Gas (USA) Inc	<b>TVD Reference:</b>	KBE @ 5008.0ft (Original Well Elev)
<b>Project:</b>	DJ Wattenberg	<b>MD Reference:</b>	KBE @ 5008.0ft (Original Well Elev)
<b>Site:</b>	SESE S10-T2N-R66W (lone)	<b>North Reference:</b>	True
<b>Well:</b>	lone 4B-10H	<b>Survey Calculation Method:</b>	Minimum Curvature
<b>Wellbore:</b>	HZ		
<b>Design:</b>	Plan #1		

### Planned Survey

Measured Depth (ft)	Inclination (°)	Azimuth (°)	Vertical Depth (ft)	+N/-S (ft)	+E/-W (ft)	Vertical Section (ft)	Dogleg Rate (°/100ft)	Build Rate (°/100ft)	Comments / Formations
9,500.0	90.00	9.00	7,234.0	2,128.3	-19.5	2,120.0	0.00	0.00	
9,600.0	90.00	9.00	7,234.0	2,227.0	-3.9	2,219.7	0.00	0.00	
9,700.0	90.00	9.00	7,234.0	2,325.8	11.8	2,319.4	0.00	0.00	
9,800.0	90.00	9.00	7,234.0	2,424.6	27.4	2,419.1	0.00	0.00	
9,900.0	90.00	9.00	7,234.0	2,523.3	43.0	2,518.8	0.00	0.00	
10,000.0	90.00	9.00	7,234.0	2,622.1	58.7	2,618.5	0.00	0.00	
10,100.0	90.00	9.00	7,234.0	2,720.9	74.3	2,718.2	0.00	0.00	
10,200.0	90.00	9.00	7,234.0	2,819.7	90.0	2,817.9	0.00	0.00	
10,300.0	90.00	9.00	7,234.0	2,918.4	105.6	2,917.6	0.00	0.00	
10,400.0	90.00	9.00	7,234.0	3,017.2	121.3	3,017.3	0.00	0.00	
10,500.0	90.00	9.00	7,234.0	3,116.0	136.9	3,117.0	0.00	0.00	
10,600.0	90.00	9.00	7,234.0	3,214.7	152.6	3,216.7	0.00	0.00	
10,700.0	90.00	9.00	7,234.0	3,313.5	168.2	3,316.4	0.00	0.00	
10,800.0	90.00	9.00	7,234.0	3,412.3	183.8	3,416.1	0.00	0.00	
10,900.0	90.00	9.00	7,234.0	3,511.0	199.5	3,515.8	0.00	0.00	
11,000.0	90.00	9.00	7,234.0	3,609.8	215.1	3,615.5	0.00	0.00	
11,100.0	90.00	9.00	7,234.0	3,708.6	230.8	3,715.2	0.00	0.00	
11,200.0	90.00	9.00	7,234.0	3,807.3	246.4	3,814.9	0.00	0.00	
11,300.0	90.00	9.00	7,234.0	3,906.1	262.1	3,914.6	0.00	0.00	
11,400.0	90.00	9.00	7,234.0	4,004.9	277.7	4,014.3	0.00	0.00	
11,500.0	90.00	9.00	7,234.0	4,103.6	293.3	4,114.0	0.00	0.00	
11,600.0	90.00	9.00	7,234.0	4,202.4	309.0	4,213.7	0.00	0.00	
11,700.0	90.00	9.00	7,234.0	4,301.2	324.6	4,313.4	0.00	0.00	
11,800.0	90.00	9.00	7,234.0	4,400.0	340.3	4,413.1	0.00	0.00	
11,900.0	90.00	9.00	7,234.0	4,498.7	355.9	4,512.8	0.00	0.00	
11,929.7	90.00	9.00	7,234.0	4,528.0	360.6	4,542.4	0.00	0.00	TD at 11929.7 - lone 4B-10H PBHI

### Targets

Target Name	Dip Angle (°)	Dip Dir. (°)	TVD (ft)	+N/-S (ft)	+E/-W (ft)	Northing (ft)	Easting (ft)	Latitude	Longitude
- hit/miss target									
- Shape									
lone 4B-10H PBHI	0.00	0.00	7,234.0	4,528.0	360.6	1,301,514.79	3,207,134.38	40.158670	-104.758930
- plan hits target center									
- Point									

### Formations

Measured Depth (ft)	Vertical Depth (ft)	Name	Lithology	Dip (°)	Dip Direction (°)
4,513.0	4,513.0	Sussex			
4,801.0	4,801.0	Sussex Marker			
5,102.3	5,101.0	Shannon			
7,212.6	7,105.0	Sharon Springs			
7,346.6	7,179.0	Niobrara			
7,463.6	7,219.0	B Chalk			

## Planning Report

<b>Database:</b>	USA EDM 5000 Multi Users DB	<b>Local Co-ordinate Reference:</b>	Well lone 4B-10H
<b>Company:</b>	EnCana Oil & Gas (USA) Inc	<b>TVD Reference:</b>	KBE @ 5008.0ft (Original Well Elev)
<b>Project:</b>	DJ Wattenberg	<b>MD Reference:</b>	KBE @ 5008.0ft (Original Well Elev)
<b>Site:</b>	SESE S10-T2N-R66W (lone)	<b>North Reference:</b>	True
<b>Well:</b>	lone 4B-10H	<b>Survey Calculation Method:</b>	Minimum Curvature
<b>Wellbore:</b>	HZ		
<b>Design:</b>	Plan #1		

### Plan Annotations

Measured Depth (ft)	Vertical Depth (ft)	Local Coordinates		Comment
		+N/-S (ft)	+E/-W (ft)	
4,800.0	4,800.0	0.0	0.0	KOP @ 4800'
5,286.2	5,281.0	-41.8	-45.2	EOB; Inc=14.59°
6,667.7	6,617.9	-278.3	-300.4	Start 11° Build @ 6667' MD
7,589.7	7,234.0	241.5	-318.4	Landing Pt @ 7234' TVD; 90°
11,929.7	7,234.0	4,528.0	360.6	TD at 11929.7

# **EnCana Oil & Gas (USA) Inc**

**DJ Wattenberg**

**SESE S10-T2N-R66W (lone)**

**lone 4B-10H**

**HZ**

**Plan #1**

## **Anticollision Report**

**14 December, 2011**



## Anticollision Report

<b>Company:</b>	EnCana Oil & Gas (USA) Inc	<b>Local Co-ordinate Reference:</b>	Well lone 4B-10H
<b>Project:</b>	DJ Wattenberg	<b>TVD Reference:</b>	KBE @ 5008.0ft (Original Well Elev)
<b>Reference Site:</b>	SESE S10-T2N-R66W (lone)	<b>MD Reference:</b>	KBE @ 5008.0ft (Original Well Elev)
<b>Site Error:</b>	0.0ft	<b>North Reference:</b>	True
<b>Reference Well:</b>	lone 4B-10H	<b>Survey Calculation Method:</b>	Minimum Curvature
<b>Well Error:</b>	0.0ft	<b>Output errors are at</b>	2.00 sigma
<b>Reference Wellbore</b>	HZ	<b>Database:</b>	USA EDM 5000 Multi Users DB
<b>Reference Design:</b>	Plan #1	<b>Offset TVD Reference:</b>	Offset Datum

<b>Reference</b>	Plan #1		
<b>Filter type:</b>	NO GLOBAL FILTER: Using user defined selection & filtering criteria		
<b>Interpolation Method:</b>	MD Interval 100.0ft	<b>Error Model:</b>	Systematic Ellipse
<b>Depth Range:</b>	Unlimited	<b>Scan Method:</b>	Closest Approach 3D
<b>Results Limited by:</b>	Maximum center-center distance of 1,043.8ft	<b>Error Surface:</b>	Elliptical Conic
<b>Warning Levels Evaluated at:</b>	2.00 Sigma		

<b>Survey Tool Program</b>	<b>Date</b>	12/14/2011		
<b>From (ft)</b>	<b>To (ft)</b>	<b>Survey (Wellbore)</b>	<b>Tool Name</b>	<b>Description</b>
0.0	11,929.7	Plan #1 (HZ)	MWD	Geolink MWD

<b>Summary</b>						
<b>Site Name</b>	<b>Reference Measured Depth (ft)</b>	<b>Offset Measured Depth (ft)</b>	<b>Distance Between Centres (ft)</b>	<b>Distance Between Ellipses (ft)</b>	<b>Separation Factor</b>	<b>Warning</b>
<b>Offset Well - Wellbore - Design</b>						
SESE S10-T2N-R66W (lone)						
HSR McPeck 13-10A (Existing) - Existing - Existing						Out of range
lone #11 (Existing) - Existing - Existing	8,463.7	7,238.0	606.7	570.1	16.537	CC, ES
lone #11 (Existing) - Existing - Existing	8,600.0	7,238.0	621.9	583.1	16.042	SF
lone #34-10 (Existing) - Existing - Existing	7,507.0	7,209.5	65.9	40.0	2.547	CC, ES, SF
lone #44-10 (Existing) - Existing - Existing						Out of range
lone 4A-10H - HZ - Plan #2	4,800.0	4,822.0	28.0	11.2	1.673	CC, ES, SF
lone 6-8-10 - DD - Plan #1	4,882.1	4,970.3	552.2	529.6	24.416	CC, ES
lone 6-8-10 - DD - Plan #1	5,000.0	5,079.4	554.6	531.7	24.216	SF
lone 8-6-10 - DD - Plan #1						Out of range
McPeck #14-10 (Existing) - Existing - Existing						Out of range
McPeck #24-10 (Existing) - Existing - Existing	413.8	408.9	1,038.5	1,037.1	746.128	CC, ES
McPeck #24-10 (Existing) - Existing - Existing	800.0	775.4	1,043.4	1,040.7	385.827	SF

# Anticollision Report

<b>Company:</b>	EnCana Oil & Gas (USA) Inc	<b>Local Co-ordinate Reference:</b>	Well lone 4B-10H
<b>Project:</b>	DJ Wattenberg	<b>TVD Reference:</b>	KBE @ 5008.0ft (Original Well Elev)
<b>Reference Site:</b>	SESE S10-T2N-R66W (lone)	<b>MD Reference:</b>	KBE @ 5008.0ft (Original Well Elev)
<b>Site Error:</b>	0.0ft	<b>North Reference:</b>	True
<b>Reference Well:</b>	lone 4B-10H	<b>Survey Calculation Method:</b>	Minimum Curvature
<b>Well Error:</b>	0.0ft	<b>Output errors are at</b>	2.00 sigma
<b>Reference Wellbore</b>	HZ	<b>Database:</b>	USA EDM 5000 Multi Users DB
<b>Reference Design:</b>	Plan #1	<b>Offset TVD Reference:</b>	Offset Datum

Offset Design SESE S10-T2N-R66W (lone) - lone #11 (Existing) - Existing - Existing													Offset Site Error:	0.0 ft
Survey Program: 0-MWD													Offset Well Error:	0.0 ft
Reference		Offset		Semi Major Axis		Highside Toolface (°)	Offset Wellbore Centre		Distance		Total Uncertainty Axis	Separation Factor	Warning	
Measured Depth (ft)	Vertical Depth (ft)	Measured Depth (ft)	Vertical Depth (ft)	Reference (ft)	Offset (ft)		+N/-S (ft)	+E/-W (ft)	Between Centres (ft)	Between Ellipses (ft)				
7,700.0	7,234.0	7,238.0	7,238.0	15.8	12.6	90.00	1,009.8	417.6	975.4	948.2	27.15	35.927		
7,800.0	7,234.0	7,238.0	7,238.0	16.7	12.6	90.00	1,009.8	417.6	899.2	871.2	28.06	32.048		
7,900.0	7,234.0	7,238.0	7,238.0	17.6	12.6	90.00	1,009.8	417.6	828.2	799.1	29.11	28.450		
8,000.0	7,234.0	7,238.0	7,238.0	18.7	12.6	90.00	1,009.8	417.6	763.6	733.4	30.28	25.220		
8,100.0	7,234.0	7,238.0	7,238.0	19.9	12.6	90.00	1,009.8	417.6	707.4	675.9	31.54	22.428		
8,200.0	7,234.0	7,238.0	7,238.0	21.2	12.6	90.00	1,009.8	417.6	661.6	628.7	32.88	20.120		
8,300.0	7,234.0	7,238.0	7,238.0	22.5	12.6	90.00	1,009.8	417.6	628.4	594.2	34.28	18.331		
8,400.0	7,234.0	7,238.0	7,238.0	23.9	12.6	90.00	1,009.8	417.6	610.1	574.3	35.74	17.071		
8,463.7	7,234.0	7,238.0	7,238.0	24.9	12.6	90.00	1,009.8	417.6	606.7	570.1	36.69	16.537 CC, ES		
8,500.0	7,234.0	7,238.0	7,238.0	25.4	12.6	90.00	1,009.8	417.6	607.8	570.6	37.23	16.325		
8,600.0	7,234.0	7,238.0	7,238.0	26.9	12.6	90.00	1,009.8	417.6	621.9	583.1	38.76	16.042 SF		
8,700.0	7,234.0	7,238.0	7,238.0	28.4	12.6	90.00	1,009.8	417.6	651.1	610.8	40.32	16.147		
8,800.0	7,234.0	7,238.0	7,238.0	29.9	12.6	90.00	1,009.8	417.6	693.7	651.8	41.91	16.553		
8,900.0	7,234.0	7,238.0	7,238.0	31.5	12.6	90.00	1,009.8	417.6	747.3	703.8	43.52	17.174		
9,000.0	7,234.0	7,238.0	7,238.0	33.1	12.6	90.00	1,009.8	417.6	809.8	764.7	45.14	17.941		
9,100.0	7,234.0	7,238.0	7,238.0	34.7	12.6	90.00	1,009.8	417.6	879.2	832.5	46.78	18.796		
9,200.0	7,234.0	7,238.0	7,238.0	36.3	12.6	90.00	1,009.8	417.6	954.1	905.7	48.43	19.702		
9,300.0	7,234.0	7,238.0	7,238.0	38.0	12.6	90.00	1,009.8	417.6	1,033.2	983.1	50.09	20.627		

# Anticollision Report

<b>Company:</b>	EnCana Oil & Gas (USA) Inc	<b>Local Co-ordinate Reference:</b>	Well lone 4B-10H
<b>Project:</b>	DJ Wattenberg	<b>TVD Reference:</b>	KBE @ 5008.0ft (Original Well Elev)
<b>Reference Site:</b>	SESE S10-T2N-R66W (lone)	<b>MD Reference:</b>	KBE @ 5008.0ft (Original Well Elev)
<b>Site Error:</b>	0.0ft	<b>North Reference:</b>	True
<b>Reference Well:</b>	lone 4B-10H	<b>Survey Calculation Method:</b>	Minimum Curvature
<b>Well Error:</b>	0.0ft	<b>Output errors are at</b>	2.00 sigma
<b>Reference Wellbore</b>	HZ	<b>Database:</b>	USA EDM 5000 Multi Users DB
<b>Reference Design:</b>	Plan #1	<b>Offset TVD Reference:</b>	Offset Datum

Offset Design SESE S10-T2N-R66W (lone) - lone #34-10 (Existing) - Existing - Existing														Offset Site Error:	0.0 ft
Survey Program: O-MWD														Offset Well Error:	0.0 ft
Reference		Offset		Semi Major Axis		Highside Toolface (°)	Distance		Total Uncertainty Axis	Separation Factor	Warning				
Measured Depth (ft)	Vertical Depth (ft)	Measured Depth (ft)	Vertical Depth (ft)	Reference (ft)	Offset (ft)		Offset Wellbore Centre +N/-S (ft)	+E/-W (ft)							
0.0	0.0	0.0	0.0	0.0	0.0	-66.91	168.7	-395.6	430.4						
100.0	100.0	82.0	82.0	0.2	0.1	-66.91	168.7	-395.6	430.0	429.7	0.29	1,457.727			
200.0	200.0	182.0	182.0	0.3	0.3	-66.91	168.7	-395.6	430.0	429.4	0.64	667.713			
300.0	300.0	282.0	282.0	0.5	0.5	-66.91	168.7	-395.6	430.0	429.0	0.99	433.016			
400.0	400.0	382.0	382.0	0.7	0.7	-66.91	168.7	-395.6	430.0	428.7	1.34	320.398			
500.0	500.0	482.0	482.0	0.8	0.8	-66.91	168.7	-395.6	430.0	428.3	1.69	254.268			
600.0	600.0	582.0	582.0	1.0	1.0	-66.91	168.7	-395.6	430.0	428.0	2.04	210.767			
700.0	700.0	682.0	682.0	1.2	1.2	-66.91	168.7	-395.6	430.0	427.6	2.39	179.975			
800.0	800.0	782.0	782.0	1.4	1.4	-66.91	168.7	-395.6	430.0	427.3	2.74	157.034			
900.0	900.0	882.0	882.0	1.5	1.5	-66.91	168.7	-395.6	430.0	426.9	3.09	139.280			
1,000.0	1,000.0	982.0	982.0	1.7	1.7	-66.91	168.7	-395.6	430.0	426.6	3.44	125.133			
1,100.0	1,100.0	1,082.0	1,082.0	1.9	1.9	-66.91	168.7	-395.6	430.0	426.2	3.79	113.594			
1,200.0	1,200.0	1,182.0	1,182.0	2.1	2.1	-66.91	168.7	-395.6	430.0	425.9	4.13	104.004			
1,300.0	1,300.0	1,282.0	1,282.0	2.2	2.2	-66.91	168.7	-395.6	430.0	425.5	4.48	95.907			
1,400.0	1,400.0	1,382.0	1,382.0	2.4	2.4	-66.91	168.7	-395.6	430.0	425.2	4.83	88.980			
1,500.0	1,500.0	1,482.0	1,482.0	2.6	2.6	-66.91	168.7	-395.6	430.0	424.8	5.18	82.986			
1,600.0	1,600.0	1,582.0	1,582.0	2.8	2.8	-66.91	168.7	-395.6	430.0	424.5	5.53	77.749			
1,700.0	1,700.0	1,682.0	1,682.0	2.9	2.9	-66.91	168.7	-395.6	430.0	424.1	5.88	73.133			
1,800.0	1,800.0	1,782.0	1,782.0	3.1	3.1	-66.91	168.7	-395.6	430.0	423.8	6.23	69.035			
1,900.0	1,900.0	1,882.0	1,882.0	3.3	3.3	-66.91	168.7	-395.6	430.0	423.4	6.58	65.372			
2,000.0	2,000.0	1,982.0	1,982.0	3.5	3.5	-66.91	168.7	-395.6	430.0	423.1	6.93	62.078			
2,100.0	2,100.0	2,082.0	2,082.0	3.6	3.6	-66.91	168.7	-395.6	430.0	422.7	7.28	59.100			
2,200.0	2,200.0	2,182.0	2,182.0	3.8	3.8	-66.91	168.7	-395.6	430.0	422.4	7.63	56.394			
2,300.0	2,300.0	2,282.0	2,282.0	4.0	4.0	-66.91	168.7	-395.6	430.0	422.1	7.97	53.926			
2,400.0	2,400.0	2,382.0	2,382.0	4.2	4.2	-66.91	168.7	-395.6	430.0	421.7	8.32	51.664			
2,500.0	2,500.0	2,482.0	2,482.0	4.3	4.3	-66.91	168.7	-395.6	430.0	421.4	8.67	49.585			
2,600.0	2,600.0	2,582.0	2,582.0	4.5	4.5	-66.91	168.7	-395.6	430.0	421.0	9.02	47.666			
2,700.0	2,700.0	2,682.0	2,682.0	4.7	4.7	-66.91	168.7	-395.6	430.0	420.7	9.37	45.890			
2,800.0	2,800.0	2,782.0	2,782.0	4.9	4.9	-66.91	168.7	-395.6	430.0	420.3	9.72	44.242			
2,900.0	2,900.0	2,882.0	2,882.0	5.0	5.0	-66.91	168.7	-395.6	430.0	420.0	10.07	42.709			
3,000.0	3,000.0	2,982.0	2,982.0	5.2	5.2	-66.91	168.7	-395.6	430.0	419.6	10.42	41.278			
3,100.0	3,100.0	3,082.0	3,082.0	5.4	5.4	-66.91	168.7	-395.6	430.0	419.3	10.77	39.939			
3,200.0	3,200.0	3,182.0	3,182.0	5.6	5.6	-66.91	168.7	-395.6	430.0	418.9	11.12	38.685			
3,300.0	3,300.0	3,282.0	3,282.0	5.7	5.7	-66.91	168.7	-395.6	430.0	418.6	11.47	37.507			
3,400.0	3,400.0	3,382.0	3,382.0	5.9	5.9	-66.91	168.7	-395.6	430.0	418.2	11.81	36.399			
3,500.0	3,500.0	3,482.0	3,482.0	6.1	6.1	-66.91	168.7	-395.6	430.0	417.9	12.16	35.355			
3,600.0	3,600.0	3,582.0	3,582.0	6.3	6.3	-66.91	168.7	-395.6	430.0	417.5	12.51	34.368			
3,700.0	3,700.0	3,682.0	3,682.0	6.4	6.4	-66.91	168.7	-395.6	430.0	417.2	12.86	33.435			
3,800.0	3,800.0	3,782.0	3,782.0	6.6	6.6	-66.91	168.7	-395.6	430.0	416.8	13.21	32.552			
3,900.0	3,900.0	3,882.0	3,882.0	6.8	6.8	-66.91	168.7	-395.6	430.0	416.5	13.56	31.714			
4,000.0	4,000.0	3,982.0	3,982.0	7.0	6.9	-66.91	168.7	-395.6	430.0	416.1	13.91	30.918			
4,100.0	4,100.0	4,082.0	4,082.0	7.1	7.1	-66.91	168.7	-395.6	430.0	415.8	14.26	30.161			
4,200.0	4,200.0	4,182.0	4,182.0	7.3	7.3	-66.91	168.7	-395.6	430.0	415.4	14.61	29.440			
4,300.0	4,300.0	4,282.0	4,282.0	7.5	7.5	-66.91	168.7	-395.6	430.0	415.1	14.96	28.753			
4,400.0	4,400.0	4,382.0	4,382.0	7.7	7.6	-66.91	168.7	-395.6	430.0	414.7	15.30	28.097			
4,500.0	4,500.0	4,482.0	4,482.0	7.8	7.8	-66.91	168.7	-395.6	430.0	414.4	15.65	27.471			
4,600.0	4,600.0	4,582.0	4,582.0	8.0	8.0	-66.91	168.7	-395.6	430.0	414.0	16.00	26.872			
4,700.0	4,700.0	4,682.0	4,682.0	8.2	8.2	-66.91	168.7	-395.6	430.0	413.7	16.35	26.298			
4,800.0	4,800.0	4,782.0	4,782.0	8.4	8.3	-66.91	168.7	-395.6	430.0	413.3	16.70	25.748			
4,900.0	4,900.0	4,882.0	4,882.0	8.5	8.5	66.26	168.7	-395.6	429.0	411.9	17.05	25.162			
5,000.0	4,999.6	4,981.6	4,981.6	8.7	8.7	67.31	168.7	-395.6	425.9	408.5	17.39	24.485			
5,100.0	5,098.8	5,080.8	5,080.8	8.9	8.9	69.07	168.7	-395.6	421.0	403.2	17.74	23.727			

CC - Min centre to center distance or convergent point, SF - min separation factor, ES - min ellipse separation

# Anticollision Report

<b>Company:</b>	EnCana Oil & Gas (USA) Inc	<b>Local Co-ordinate Reference:</b>	Well lone 4B-10H
<b>Project:</b>	DJ Wattenberg	<b>TVD Reference:</b>	KBE @ 5008.0ft (Original Well Elev)
<b>Reference Site:</b>	SESE S10-T2N-R66W (lone)	<b>MD Reference:</b>	KBE @ 5008.0ft (Original Well Elev)
<b>Site Error:</b>	0.0ft	<b>North Reference:</b>	True
<b>Reference Well:</b>	lone 4B-10H	<b>Survey Calculation Method:</b>	Minimum Curvature
<b>Well Error:</b>	0.0ft	<b>Output errors are at</b>	2.00 sigma
<b>Reference Wellbore</b>	HZ	<b>Database:</b>	USA EDM 5000 Multi Users DB
<b>Reference Design:</b>	Plan #1	<b>Offset TVD Reference:</b>	Offset Datum

Offset Design SESE S10-T2N-R66W (lone) - lone #34-10 (Existing) - Existing - Existing													Offset Site Error: 0.0 ft	
Survey Program: 0-MWD													Offset Well Error: 0.0 ft	
Reference		Offset		Semi Major Axis			Distance						Warning	
Measured Depth (ft)	Vertical Depth (ft)	Measured Depth (ft)	Vertical Depth (ft)	Reference (ft)	Offset (ft)	Highside Toolface (°)	Offset Wellbore Centre +N/-S (ft)	+E/-W (ft)	Between Centres (ft)	Between Ellipses (ft)	Total Uncertainty Axis	Separation Factor		
5,200.0	5,197.1	5,179.1	5,179.1	9.1	9.0	71.57	168.7	-395.6	414.7	396.6	18.11	22.903		
5,300.0	5,294.3	5,276.3	5,276.3	9.3	9.2	74.76	168.7	-395.6	407.8	389.3	18.50	22.040		
5,400.0	5,391.1	5,373.1	5,373.1	9.6	9.4	78.13	168.7	-395.6	401.7	382.8	18.93	21.223		
5,500.0	5,487.9	5,469.9	5,469.9	9.8	9.5	81.57	168.7	-395.6	397.2	377.8	19.37	20.502		
5,600.0	5,584.7	5,566.7	5,566.7	10.1	9.7	85.08	168.7	-395.6	394.1	374.3	19.83	19.876		
5,700.0	5,681.4	5,663.4	5,663.4	10.4	9.9	88.62	168.7	-395.6	392.7	372.4	20.30	19.347		
5,738.7	5,718.9	5,700.9	5,700.9	10.5	9.9	90.00	168.7	-395.6	392.6	372.1	20.48	19.167		
5,800.0	5,778.2	5,760.2	5,760.2	10.7	10.1	92.18	168.7	-395.6	392.9	372.1	20.77	18.913		
5,900.0	5,875.0	5,857.0	5,857.0	11.0	10.2	95.72	168.7	-395.6	394.7	373.4	21.25	18.570		
6,000.0	5,971.8	5,953.8	5,953.8	11.4	10.4	99.21	168.7	-395.6	398.1	376.3	21.73	18.316		
6,100.0	6,068.5	6,050.5	6,050.5	11.7	10.6	102.64	168.7	-395.6	403.0	380.8	22.21	18.146		
6,200.0	6,165.3	6,147.3	6,147.3	12.1	10.7	105.98	168.7	-395.6	409.4	386.7	22.68	18.055		
6,300.0	6,262.1	6,244.1	6,244.1	12.4	10.9	109.21	168.7	-395.6	417.3	394.1	23.14	18.035		
6,400.0	6,358.9	6,340.9	6,340.9	12.8	11.1	112.32	168.7	-395.6	426.4	402.9	23.58	18.082		
6,500.0	6,455.6	6,437.6	6,437.6	13.2	11.2	115.30	168.7	-395.6	436.9	412.9	24.02	18.189		
6,600.0	6,552.4	6,534.4	6,534.4	13.5	11.4	118.13	168.7	-395.6	448.5	424.1	24.44	18.348		
6,700.0	6,649.4	6,631.4	6,631.4	13.9	11.6	110.40	168.7	-395.6	460.3	435.4	24.92	18.474		
6,800.0	6,747.9	6,729.9	6,729.9	14.2	11.7	53.20	168.7	-395.6	459.0	433.8	25.16	18.244		
6,900.0	6,845.3	6,827.3	6,827.3	14.3	11.9	16.06	168.7	-395.6	440.0	415.1	24.84	17.713		
7,000.0	6,938.2	6,920.2	6,920.2	14.3	12.1	2.82	168.7	-395.6	403.6	379.6	23.96	16.841		
7,100.0	7,023.0	7,005.0	7,005.0	14.2	12.2	-5.12	168.7	-395.6	350.9	328.3	22.63	15.506		
7,200.0	7,096.7	7,078.7	7,078.7	14.2	12.4	-13.91	168.7	-395.6	284.0	262.8	21.16	13.421		
7,300.0	7,156.5	7,138.5	7,138.5	14.2	12.5	-29.46	168.7	-395.6	206.1	185.3	20.71	9.948		
7,400.0	7,200.3	7,182.3	7,182.3	14.3	12.5	-59.89	168.7	-395.6	123.5	99.8	23.72	5.206		
7,500.0	7,226.4	7,208.4	7,208.4	14.6	12.6	-88.96	168.7	-395.6	66.3	40.4	25.84	2.565		
7,507.0	7,227.5	7,209.5	7,209.5	14.7	12.6	-89.99	168.7	-395.6	65.9	40.0	25.88	2.547	CC, ES, SF	
7,600.0	7,234.0	7,216.0	7,216.0	15.1	12.6	-90.00	168.7	-395.6	114.5	88.1	26.37	4.340		
7,700.0	7,234.0	7,216.0	7,216.0	15.8	12.6	-90.00	168.7	-395.6	204.8	177.7	27.11	7.556		
7,800.0	7,234.0	7,216.0	7,216.0	16.7	12.6	-90.00	168.7	-395.6	301.4	273.3	28.02	10.755		
7,900.0	7,234.0	7,216.0	7,216.0	17.6	12.6	-90.00	168.7	-395.6	399.6	370.5	29.07	13.745		
8,000.0	7,234.0	7,216.0	7,216.0	18.7	12.6	-90.00	168.7	-395.6	498.5	468.3	30.24	16.486		
8,100.0	7,234.0	7,216.0	7,216.0	19.9	12.6	-90.00	168.7	-395.6	597.8	566.3	31.50	18.977		
8,200.0	7,234.0	7,216.0	7,216.0	21.2	12.6	-90.00	168.7	-395.6	697.3	664.5	32.84	21.232		
8,300.0	7,234.0	7,216.0	7,216.0	22.5	12.6	-90.00	168.7	-395.6	796.9	762.7	34.25	23.272		
8,400.0	7,234.0	7,216.0	7,216.0	23.9	12.6	-90.00	168.7	-395.6	896.6	860.9	35.70	25.117		
8,500.0	7,234.0	7,216.0	7,216.0	25.4	12.6	-90.00	168.7	-395.6	996.4	959.2	37.20	26.789		

# Anticollision Report

<b>Company:</b>	EnCana Oil & Gas (USA) Inc	<b>Local Co-ordinate Reference:</b>	Well lone 4B-10H
<b>Project:</b>	DJ Wattenberg	<b>TVD Reference:</b>	KBE @ 5008.0ft (Original Well Elev)
<b>Reference Site:</b>	SESE S10-T2N-R66W (lone)	<b>MD Reference:</b>	KBE @ 5008.0ft (Original Well Elev)
<b>Site Error:</b>	0.0ft	<b>North Reference:</b>	True
<b>Reference Well:</b>	lone 4B-10H	<b>Survey Calculation Method:</b>	Minimum Curvature
<b>Well Error:</b>	0.0ft	<b>Output errors are at</b>	2.00 sigma
<b>Reference Wellbore</b>	HZ	<b>Database:</b>	USA EDM 5000 Multi Users DB
<b>Reference Design:</b>	Plan #1	<b>Offset TVD Reference:</b>	Offset Datum

Offset Design SESE S10-T2N-R66W (lone) - lone 4A-10H - HZ - Plan #2													Offset Site Error:	0.0 ft
Survey Program: 0-MWD													Offset Well Error:	0.0 ft
Reference		Offset		Semi Major Axis		Distance		Total		Separation		Warning		
Measured Depth (ft)	Vertical Depth (ft)	Measured Depth (ft)	Vertical Depth (ft)	Reference (ft)	Offset (ft)	Highside Toolface (°)	Offset Wellbore Centre +N/-S (ft)	+E/-W (ft)	Between Centres (ft)	Between Ellipses (ft)	Uncertainty Axis			
0.0	0.0	22.0	22.0	0.0	0.0	89.98	0.0	28.0	28.0					
100.0	100.0	122.0	122.0	0.2	0.2	89.98	0.0	28.0	28.0	27.7	0.30	92.053		
200.0	200.0	222.0	222.0	0.3	0.3	89.98	0.0	28.0	28.0	27.3	0.65	42.827		
300.0	300.0	322.0	322.0	0.5	0.5	89.98	0.0	28.0	28.0	27.0	1.00	27.905		
400.0	400.0	422.0	422.0	0.7	0.7	89.98	0.0	28.0	28.0	26.6	1.35	20.694		
500.0	500.0	522.0	522.0	0.8	0.8	89.98	0.0	28.0	28.0	26.3	1.70	16.445		
600.0	600.0	622.0	622.0	1.0	1.0	89.98	0.0	28.0	28.0	25.9	2.05	13.643		
700.0	700.0	722.0	722.0	1.2	1.2	89.98	0.0	28.0	28.0	25.6	2.40	11.657		
800.0	800.0	822.0	822.0	1.4	1.4	89.98	0.0	28.0	28.0	25.2	2.75	10.176		
900.0	900.0	922.0	922.0	1.5	1.5	89.98	0.0	28.0	28.0	24.9	3.10	9.029		
1,000.0	1,000.0	1,022.0	1,022.0	1.7	1.7	89.98	0.0	28.0	28.0	24.5	3.45	8.114		
1,100.0	1,100.0	1,122.0	1,122.0	1.9	1.9	89.98	0.0	28.0	28.0	24.2	3.79	7.368		
1,200.0	1,200.0	1,222.0	1,222.0	2.1	2.1	89.98	0.0	28.0	28.0	23.8	4.14	6.747		
1,300.0	1,300.0	1,322.0	1,322.0	2.2	2.2	89.98	0.0	28.0	28.0	23.5	4.49	6.223		
1,400.0	1,400.0	1,422.0	1,422.0	2.4	2.4	89.98	0.0	28.0	28.0	23.1	4.84	5.774		
1,500.0	1,500.0	1,522.0	1,522.0	2.6	2.6	89.98	0.0	28.0	28.0	22.8	5.19	5.386		
1,600.0	1,600.0	1,622.0	1,622.0	2.8	2.8	89.98	0.0	28.0	28.0	22.4	5.54	5.046		
1,700.0	1,700.0	1,722.0	1,722.0	2.9	2.9	89.98	0.0	28.0	28.0	22.1	5.89	4.747		
1,800.0	1,800.0	1,822.0	1,822.0	3.1	3.1	89.98	0.0	28.0	28.0	21.7	6.24	4.482		
1,900.0	1,900.0	1,922.0	1,922.0	3.3	3.3	89.98	0.0	28.0	28.0	21.4	6.59	4.244		
2,000.0	2,000.0	2,022.0	2,022.0	3.5	3.5	89.98	0.0	28.0	28.0	21.0	6.94	4.031		
2,100.0	2,100.0	2,122.0	2,122.0	3.6	3.6	89.98	0.0	28.0	28.0	20.7	7.29	3.837		
2,200.0	2,200.0	2,222.0	2,222.0	3.8	3.8	89.98	0.0	28.0	28.0	20.3	7.63	3.662		
2,300.0	2,300.0	2,322.0	2,322.0	4.0	4.0	89.98	0.0	28.0	28.0	20.0	7.98	3.502		
2,400.0	2,400.0	2,422.0	2,422.0	4.2	4.2	89.98	0.0	28.0	28.0	19.6	8.33	3.355		
2,500.0	2,500.0	2,522.0	2,522.0	4.3	4.3	89.98	0.0	28.0	28.0	19.3	8.68	3.220		
2,600.0	2,600.0	2,622.0	2,622.0	4.5	4.5	89.98	0.0	28.0	28.0	18.9	9.03	3.096		
2,700.0	2,700.0	2,722.0	2,722.0	4.7	4.7	89.98	0.0	28.0	28.0	18.6	9.38	2.981		
2,800.0	2,800.0	2,822.0	2,822.0	4.9	4.9	89.98	0.0	28.0	28.0	18.2	9.73	2.874		
2,900.0	2,900.0	2,922.0	2,922.0	5.0	5.0	89.98	0.0	28.0	28.0	17.9	10.08	2.774		
3,000.0	3,000.0	3,022.0	3,022.0	5.2	5.2	89.98	0.0	28.0	28.0	17.5	10.43	2.681		
3,100.0	3,100.0	3,122.0	3,122.0	5.4	5.4	89.98	0.0	28.0	28.0	17.2	10.78	2.594		
3,200.0	3,200.0	3,222.0	3,222.0	5.6	5.6	89.98	0.0	28.0	28.0	16.8	11.12	2.513		
3,300.0	3,300.0	3,322.0	3,322.0	5.7	5.7	89.98	0.0	28.0	28.0	16.5	11.47	2.436		
3,400.0	3,400.0	3,422.0	3,422.0	5.9	5.9	89.98	0.0	28.0	28.0	16.1	11.82	2.365		
3,500.0	3,500.0	3,522.0	3,522.0	6.1	6.1	89.98	0.0	28.0	28.0	15.8	12.17	2.297		
3,600.0	3,600.0	3,622.0	3,622.0	6.3	6.3	89.98	0.0	28.0	28.0	15.4	12.52	2.233		
3,700.0	3,700.0	3,722.0	3,722.0	6.4	6.4	89.98	0.0	28.0	28.0	15.1	12.87	2.172		
3,800.0	3,800.0	3,822.0	3,822.0	6.6	6.6	89.98	0.0	28.0	28.0	14.7	13.22	2.115		
3,900.0	3,900.0	3,922.0	3,922.0	6.8	6.8	89.98	0.0	28.0	28.0	14.4	13.57	2.060		
4,000.0	4,000.0	4,022.0	4,022.0	7.0	7.0	89.98	0.0	28.0	28.0	14.0	13.92	2.009		
4,100.0	4,100.0	4,122.0	4,122.0	7.1	7.1	89.98	0.0	28.0	28.0	13.7	14.27	1.960		
4,200.0	4,200.0	4,222.0	4,222.0	7.3	7.3	89.98	0.0	28.0	28.0	13.3	14.62	1.913		
4,300.0	4,300.0	4,322.0	4,322.0	7.5	7.5	89.98	0.0	28.0	28.0	13.0	14.96	1.868		
4,400.0	4,400.0	4,422.0	4,422.0	7.7	7.7	89.98	0.0	28.0	28.0	12.6	15.31	1.826		
4,500.0	4,500.0	4,522.0	4,522.0	7.8	7.8	89.98	0.0	28.0	28.0	12.3	15.66	1.785		
4,600.0	4,600.0	4,622.0	4,622.0	8.0	8.0	89.98	0.0	28.0	28.0	11.9	16.01	1.746		
4,700.0	4,700.0	4,722.0	4,722.0	8.2	8.2	89.98	0.0	28.0	28.0	11.6	16.36	1.709		
4,800.0	4,800.0	4,822.0	4,822.0	8.4	8.4	89.98	0.0	28.0	28.0	11.2	16.71	1.673 CC, ES, SF		
4,900.0	4,900.0	4,922.0	4,922.0	8.5	8.5	-140.57	0.0	28.0	29.9	12.9	17.05	1.755		
5,000.0	4,999.6	5,021.4	5,021.4	8.7	8.7	-148.16	-0.1	28.0	36.4	19.0	17.36	2.096		
5,100.0	5,098.8	5,119.5	5,119.4	8.9	8.9	-152.22	-2.8	30.4	49.5	31.8	17.65	2.803		

CC - Min centre to center distance or convergent point, SF - min separation factor, ES - min ellipse separation

# Anticollision Report

<b>Company:</b>	EnCana Oil & Gas (USA) Inc	<b>Local Co-ordinate Reference:</b>	Well lone 4B-10H
<b>Project:</b>	DJ Wattenberg	<b>TVD Reference:</b>	KBE @ 5008.0ft (Original Well Elev)
<b>Reference Site:</b>	SESE S10-T2N-R66W (lone)	<b>MD Reference:</b>	KBE @ 5008.0ft (Original Well Elev)
<b>Site Error:</b>	0.0ft	<b>North Reference:</b>	True
<b>Reference Well:</b>	lone 4B-10H	<b>Survey Calculation Method:</b>	Minimum Curvature
<b>Well Error:</b>	0.0ft	<b>Output errors are at</b>	2.00 sigma
<b>Reference Wellbore</b>	HZ	<b>Database:</b>	USA EDM 5000 Multi Users DB
<b>Reference Design:</b>	Plan #1	<b>Offset TVD Reference:</b>	Offset Datum

Offset Design SESE S10-T2N-R66W (lone) - lone 4A-10H - HZ - Plan #2													Offset Site Error: 0.0 ft			
Survey Program: O-MWD															Offset Well Error: 0.0 ft	
Reference		Offset		Semi Major Axis			Distance									
Measured Depth (ft)	Vertical Depth (ft)	Measured Depth (ft)	Vertical Depth (ft)	Reference (ft)	Offset (ft)	Highside Toolface (°)	Offset Wellbore Centre +N/-S (ft)	+E/-W (ft)	Between Centres (ft)	Between Ellipses (ft)	Total Uncertainty Axis	Separation Factor	Warning			
5,200.0	5,197.1	5,216.2	5,215.8	9.1	9.0	-152.44	-9.2	36.0	69.4	51.4	17.91	3.873				
5,300.0	5,294.3	5,310.9	5,309.5	9.3	9.2	-151.14	-19.1	44.5	95.8	77.6	18.18	5.269				
5,400.0	5,391.1	5,403.7	5,400.7	9.6	9.4	-149.09	-32.1	55.8	126.0	107.5	18.57	6.788				
5,500.0	5,487.9	5,494.8	5,489.3	9.8	9.6	-146.37	-48.1	69.7	158.6	139.7	18.98	8.357				
5,600.0	5,584.7	5,588.6	5,580.0	10.1	9.9	-143.95	-66.2	85.4	192.6	173.2	19.42	9.918				
5,700.0	5,681.4	5,682.4	5,670.7	10.4	10.1	-142.26	-84.2	101.0	226.8	206.9	19.87	11.414				
5,800.0	5,778.2	5,776.2	5,761.4	10.7	10.4	-141.00	-102.3	116.7	261.1	240.8	20.33	12.842				
5,900.0	5,875.0	5,870.0	5,852.1	11.0	10.6	-140.04	-120.3	132.3	295.5	274.7	20.80	14.203				
6,000.0	5,971.8	5,963.8	5,942.8	11.4	10.9	-139.28	-138.3	148.0	329.9	308.7	21.29	15.498				
6,100.0	6,068.5	6,057.6	6,033.5	11.7	11.2	-138.66	-156.4	163.6	364.4	342.6	21.78	16.729				
6,200.0	6,165.3	6,151.4	6,124.2	12.1	11.5	-138.15	-174.4	179.3	399.0	376.7	22.29	17.898				
6,300.0	6,262.1	6,245.2	6,214.9	12.4	11.8	-137.72	-192.5	194.9	433.5	410.7	22.81	19.008				
6,400.0	6,358.9	6,339.0	6,305.6	12.8	12.1	-137.36	-210.5	210.6	468.1	444.7	23.33	20.061				
6,500.0	6,455.6	6,432.8	6,396.3	13.2	12.5	-137.04	-228.5	226.2	502.6	478.8	23.87	21.061				
6,600.0	6,552.4	6,526.6	6,487.0	13.5	12.8	-136.77	-246.6	241.8	537.2	512.8	24.41	22.010				
6,700.0	6,649.4	6,620.4	6,577.7	13.9	13.2	-148.22	-264.6	257.5	571.7	546.8	24.95	22.913				
6,800.0	6,747.9	6,711.3	6,665.7	14.2	13.5	150.56	-282.0	272.7	604.2	578.8	25.42	23.769				
6,900.0	6,845.3	6,789.6	6,742.3	14.3	13.7	111.25	-289.8	287.1	635.5	609.9	25.69	24.744				
7,000.0	6,938.2	6,870.7	6,821.3	14.3	13.9	97.50	-285.7	303.9	665.9	640.1	25.77	25.842				
7,100.0	7,023.0	6,955.6	6,902.0	14.2	14.0	91.29	-268.1	323.1	694.5	668.8	25.70	27.020				
7,200.0	7,096.7	7,045.9	6,983.1	14.2	14.1	88.13	-235.1	344.9	720.5	695.0	25.56	28.194				
7,300.0	7,156.5	7,143.2	7,062.2	14.2	14.2	86.68	-184.1	369.1	743.2	717.8	25.45	29.208				
7,400.0	7,200.3	7,249.4	7,135.6	14.3	14.4	86.43	-112.2	395.5	761.7	736.1	25.55	29.813				
7,500.0	7,226.4	7,366.1	7,197.3	14.6	14.7	87.15	-17.4	423.0	774.9	748.8	26.08	29.713				
7,600.0	7,234.0	7,493.9	7,238.4	15.1	15.3	88.71	100.2	450.1	781.8	754.6	27.22	28.723				
7,700.0	7,234.0	7,624.4	7,250.0	15.8	16.1	89.56	227.9	472.7	783.4	754.5	28.93	27.077				
7,800.0	7,234.0	7,724.4	7,250.0	16.7	17.0	89.56	326.6	488.3	783.4	752.7	30.78	25.455				
7,900.0	7,234.0	7,824.4	7,250.0	17.6	17.9	89.56	425.4	503.9	783.4	750.5	32.90	23.813				
8,000.0	7,234.0	7,924.4	7,250.0	18.7	19.0	89.56	524.2	519.6	783.4	748.2	35.25	22.223				
8,100.0	7,234.0	8,024.4	7,250.0	19.9	20.2	89.56	623.0	535.2	783.4	745.6	37.79	20.729				
8,200.0	7,234.0	8,124.4	7,250.0	21.2	21.5	89.56	721.7	550.9	783.4	742.9	40.49	19.351				
8,300.0	7,234.0	8,224.4	7,250.0	22.5	22.8	89.56	820.5	566.5	783.4	740.1	43.30	18.092				
8,400.0	7,234.0	8,324.4	7,250.0	23.9	24.2	89.56	919.3	582.2	783.4	737.2	46.22	16.950				
8,500.0	7,234.0	8,424.4	7,250.0	25.4	25.7	89.56	1,018.0	597.8	783.4	734.2	49.22	15.916				
8,600.0	7,234.0	8,524.4	7,250.0	26.9	27.1	89.56	1,116.8	613.4	783.4	731.1	52.29	14.982				
8,700.0	7,234.0	8,624.4	7,250.0	28.4	28.7	89.56	1,215.6	629.1	783.4	728.0	55.42	14.136				
8,800.0	7,234.0	8,724.4	7,250.0	29.9	30.2	89.56	1,314.3	644.7	783.4	724.8	58.60	13.370				
8,900.0	7,234.0	8,824.4	7,250.0	31.5	31.8	89.56	1,413.1	660.4	783.4	721.6	61.81	12.674				
9,000.0	7,234.0	8,924.4	7,250.0	33.1	33.4	89.56	1,511.9	676.0	783.4	718.4	65.06	12.041				
9,100.0	7,234.0	9,024.4	7,250.0	34.7	35.0	89.56	1,610.6	691.7	783.4	715.1	68.34	11.463				
9,200.0	7,234.0	9,124.4	7,250.0	36.3	36.6	89.56	1,709.4	707.3	783.4	711.8	71.65	10.934				
9,300.0	7,234.0	9,224.4	7,250.0	38.0	38.2	89.56	1,808.2	723.0	783.4	708.5	74.98	10.449				
9,400.0	7,234.0	9,324.4	7,250.0	39.6	39.9	89.56	1,906.9	738.6	783.4	705.1	78.33	10.002				
9,500.0	7,234.0	9,424.4	7,250.0	41.3	41.5	89.56	2,005.7	754.2	783.4	701.7	81.69	9.590				
9,600.0	7,234.0	9,524.4	7,250.0	43.0	43.2	89.56	2,104.5	769.9	783.4	698.4	85.07	9.209				
9,700.0	7,234.0	9,624.4	7,250.0	44.6	44.9	89.56	2,203.3	785.5	783.4	695.0	88.47	8.856				
9,800.0	7,234.0	9,724.4	7,250.0	46.3	46.5	89.56	2,302.0	801.2	783.4	691.6	91.87	8.527				
9,900.0	7,234.0	9,824.4	7,250.0	48.0	48.2	89.56	2,400.8	816.8	783.4	688.1	95.29	8.222				
10,000.0	7,234.0	9,924.4	7,250.0	49.7	49.9	89.56	2,499.6	832.5	783.4	684.7	98.72	7.936				
10,100.0	7,234.0	10,024.4	7,250.0	51.4	51.6	89.56	2,598.3	848.1	783.4	681.3	102.15	7.669				
10,200.0	7,234.0	10,124.4	7,250.0	53.1	53.3	89.56	2,697.1	863.7	783.4	677.8	105.59	7.419				
10,300.0	7,234.0	10,224.4	7,250.0	54.8	55.0	89.56	2,795.9	879.4	783.4	674.4	109.04	7.185				

CC - Min centre to center distance or convergent point, SF - min separation factor, ES - min ellipse separation

# Anticollision Report

<b>Company:</b>	EnCana Oil & Gas (USA) Inc	<b>Local Co-ordinate Reference:</b>	Well lone 4B-10H
<b>Project:</b>	DJ Wattenberg	<b>TVD Reference:</b>	KBE @ 5008.0ft (Original Well Elev)
<b>Reference Site:</b>	SESE S10-T2N-R66W (lone)	<b>MD Reference:</b>	KBE @ 5008.0ft (Original Well Elev)
<b>Site Error:</b>	0.0ft	<b>North Reference:</b>	True
<b>Reference Well:</b>	lone 4B-10H	<b>Survey Calculation Method:</b>	Minimum Curvature
<b>Well Error:</b>	0.0ft	<b>Output errors are at</b>	2.00 sigma
<b>Reference Wellbore</b>	HZ	<b>Database:</b>	USA EDM 5000 Multi Users DB
<b>Reference Design:</b>	Plan #1	<b>Offset TVD Reference:</b>	Offset Datum

Offset Design SESE S10-T2N-R66W (lone) - lone 4A-10H - HZ - Plan #2												Offset Site Error:	0.0 ft
Survey Program: 0-MWD												Offset Well Error:	0.0 ft
Reference		Offset		Semi Major Axis		Distance							
Measured Depth (ft)	Vertical Depth (ft)	Measured Depth (ft)	Vertical Depth (ft)	Reference (ft)	Offset (ft)	Highside Toolface (°)	Offset Wellbore Centre +N/-S (ft)	+E/-W (ft)	Between Centres (ft)	Between Ellipses (ft)	Total Uncertainty Axis	Separation Factor	Warning
10,400.0	7,234.0	10,324.4	7,250.0	56.6	56.8	89.56	2,894.6	895.0	783.4	670.9	112.50	6.964	
10,500.0	7,234.0	10,424.4	7,250.0	58.3	58.5	89.56	2,993.4	910.7	783.4	667.5	115.96	6.756	
10,600.0	7,234.0	10,524.4	7,250.0	60.0	60.2	89.56	3,092.2	926.3	783.4	664.0	119.42	6.560	
10,700.0	7,234.0	10,624.4	7,250.0	61.7	61.9	89.56	3,190.9	942.0	783.4	660.5	122.89	6.375	
10,800.0	7,234.0	10,724.4	7,250.0	63.5	63.7	89.56	3,289.7	957.6	783.4	657.1	126.37	6.200	
10,900.0	7,234.0	10,824.4	7,250.0	65.2	65.4	89.56	3,388.5	973.2	783.4	653.6	129.85	6.033	
11,000.0	7,234.0	10,924.4	7,250.0	66.9	67.1	89.56	3,487.3	988.9	783.4	650.1	133.33	5.876	
11,100.0	7,234.0	11,024.4	7,250.0	68.6	68.8	89.56	3,586.0	1,004.5	783.4	646.6	136.82	5.726	
11,200.0	7,234.0	11,124.4	7,250.0	70.4	70.6	89.56	3,684.8	1,020.2	783.4	643.1	140.31	5.584	
11,300.0	7,234.0	11,224.4	7,250.0	72.1	72.3	89.56	3,783.6	1,035.8	783.4	639.6	143.80	5.448	
11,400.0	7,234.0	11,324.4	7,250.0	73.9	74.1	89.56	3,882.3	1,051.5	783.4	636.1	147.30	5.319	
11,500.0	7,234.0	11,424.4	7,250.0	75.6	75.8	89.56	3,981.1	1,067.1	783.4	632.6	150.79	5.195	
11,600.0	7,234.0	11,524.4	7,250.0	77.4	77.5	89.56	4,079.9	1,082.7	783.4	629.1	154.29	5.078	
11,700.0	7,234.0	11,624.4	7,250.0	79.1	79.3	89.56	4,178.6	1,098.4	783.4	625.6	157.80	4.965	
11,800.0	7,234.0	11,724.4	7,250.0	80.8	81.0	89.56	4,277.4	1,114.0	783.4	622.1	161.30	4.857	
11,900.0	7,234.0	11,824.4	7,250.0	82.6	82.8	89.56	4,376.2	1,129.7	783.4	618.6	164.81	4.754	
11,929.7	7,234.0	11,854.1	7,250.0	83.1	83.3	89.56	4,405.5	1,134.3	783.4	617.6	165.85	4.724	

# Anticollision Report

<b>Company:</b>	EnCana Oil & Gas (USA) Inc	<b>Local Co-ordinate Reference:</b>	Well lone 4B-10H
<b>Project:</b>	DJ Wattenberg	<b>TVD Reference:</b>	KBE @ 5008.0ft (Original Well Elev)
<b>Reference Site:</b>	SESE S10-T2N-R66W (lone)	<b>MD Reference:</b>	KBE @ 5008.0ft (Original Well Elev)
<b>Site Error:</b>	0.0ft	<b>North Reference:</b>	True
<b>Reference Well:</b>	lone 4B-10H	<b>Survey Calculation Method:</b>	Minimum Curvature
<b>Well Error:</b>	0.0ft	<b>Output errors are at</b>	2.00 sigma
<b>Reference Wellbore</b>	HZ	<b>Database:</b>	USA EDM 5000 Multi Users DB
<b>Reference Design:</b>	Plan #1	<b>Offset TVD Reference:</b>	Offset Datum

Offset Design SESE S10-T2N-R66W (lone) - lone 6-8-10 - DD - Plan #1													Offset Site Error:	0.0 ft
Survey Program: O-MWD													Offset Well Error:	0.0 ft
Reference		Offset		Semi Major Axis		Distance		Total		Separation		Warning		
Measured Depth (ft)	Vertical Depth (ft)	Measured Depth (ft)	Vertical Depth (ft)	Reference (ft)	Offset (ft)	Highside Toolface (°)	Offset Wellbore Centre +N/-S (ft)	+E/-W (ft)	Between Centres (ft)	Between Ellipses (ft)	Uncertainty Axis			
800.0	800.0	980.5	974.1	1.4	2.4	83.86	109.9	1,021.2	1,038.4	1,035.3	3.15	329.249		
900.0	900.0	1,079.1	1,071.3	1.5	2.7	84.29	100.7	1,007.6	1,023.7	1,020.2	3.52	291.092		
1,000.0	1,000.0	1,177.7	1,168.6	1.7	3.1	84.74	91.5	994.0	1,009.1	1,005.2	3.88	260.181		
1,100.0	1,100.0	1,276.4	1,265.8	1.9	3.4	85.20	82.3	980.4	994.5	990.2	4.24	234.645		
1,200.0	1,200.0	1,375.0	1,363.0	2.1	3.7	85.67	73.1	966.8	979.9	975.3	4.60	213.201		
1,300.0	1,300.0	1,473.6	1,460.3	2.2	4.1	86.16	64.0	953.2	965.5	960.5	4.95	194.943		
1,400.0	1,400.0	1,572.2	1,557.5	2.4	4.4	86.66	54.8	939.6	951.1	945.8	5.31	179.215		
1,500.0	1,500.0	1,670.8	1,654.7	2.6	4.7	87.18	45.6	926.0	936.8	931.1	5.66	165.528		
1,600.0	1,600.0	1,769.4	1,752.0	2.8	5.1	87.72	36.4	912.5	922.5	916.5	6.01	153.509		
1,700.0	1,700.0	1,868.0	1,849.2	2.9	5.4	88.27	27.2	898.9	908.4	902.0	6.36	142.874		
1,800.0	1,800.0	1,966.6	1,946.4	3.1	5.7	88.83	18.0	885.3	894.3	887.6	6.70	133.396		
1,900.0	1,900.0	2,065.2	2,043.7	3.3	6.1	89.42	8.9	871.7	880.3	873.3	7.05	124.899		
2,000.0	2,000.0	2,163.8	2,140.9	3.5	6.4	90.02	-0.3	858.1	866.4	859.0	7.39	117.237		
2,100.0	2,100.0	2,262.4	2,238.1	3.6	6.7	90.65	-9.5	844.5	852.6	844.9	7.73	110.294		
2,200.0	2,200.0	2,361.0	2,335.4	3.8	7.1	91.29	-18.7	830.9	839.0	830.9	8.07	103.973		
2,300.0	2,300.0	2,459.6	2,432.6	4.0	7.4	91.95	-27.9	817.3	825.4	817.0	8.41	98.195		
2,400.0	2,400.0	2,558.2	2,529.8	4.2	7.7	92.64	-37.1	803.7	811.9	803.2	8.74	92.892		
2,500.0	2,500.0	2,656.9	2,627.1	4.3	8.1	93.35	-46.2	790.1	798.6	789.5	9.07	88.008		
2,600.0	2,600.0	2,755.5	2,724.3	4.5	8.4	94.08	-55.4	776.6	785.4	775.9	9.41	83.495		
2,700.0	2,700.0	2,854.1	2,821.5	4.7	8.8	94.84	-64.6	763.0	772.3	762.5	9.74	79.312		
2,800.0	2,800.0	2,952.7	2,918.8	4.9	9.1	95.62	-73.8	749.4	759.3	749.3	10.07	75.423		
2,900.0	2,900.0	3,051.3	3,016.0	5.0	9.4	96.43	-83.0	735.8	746.5	736.1	10.40	71.798		
3,000.0	3,000.0	3,149.9	3,113.2	5.2	9.8	97.27	-92.2	722.2	733.9	723.1	10.73	68.410		
3,100.0	3,100.0	3,248.5	3,210.5	5.4	10.1	98.14	-101.3	708.6	721.4	710.3	11.06	65.236		
3,200.0	3,200.0	3,347.1	3,307.7	5.6	10.4	99.04	-110.5	695.0	709.1	697.7	11.39	62.256		
3,300.0	3,300.0	3,445.7	3,404.9	5.7	10.8	99.96	-119.7	681.4	696.9	685.2	11.72	59.452		
3,400.0	3,400.0	3,544.3	3,502.2	5.9	11.1	100.92	-128.9	667.8	685.0	672.9	12.06	56.807		
3,500.0	3,500.0	3,642.9	3,599.4	6.1	11.4	101.92	-138.1	654.2	673.2	660.8	12.40	54.308		
3,600.0	3,600.0	3,741.5	3,696.6	6.3	11.8	102.94	-147.3	640.7	661.7	649.0	12.74	51.943		
3,700.0	3,700.0	3,840.1	3,793.9	6.4	12.1	104.01	-156.4	627.1	650.4	637.3	13.09	49.699		
3,800.0	3,800.0	3,938.7	3,891.1	6.6	12.4	105.11	-165.6	613.5	639.3	625.9	13.44	47.568		
3,900.0	3,900.0	4,037.3	3,988.3	6.8	12.8	106.25	-174.8	599.9	628.5	614.7	13.80	45.541		
4,000.0	4,000.0	4,136.0	4,085.6	7.0	13.1	107.42	-184.0	586.3	617.9	603.7	14.17	43.609		
4,100.0	4,100.0	4,234.6	4,182.8	7.1	13.5	108.64	-193.2	572.7	607.6	593.0	14.55	41.767		
4,200.0	4,200.0	4,333.2	4,280.0	7.3	13.8	109.90	-202.4	559.1	597.5	582.6	14.94	40.008		
4,300.0	4,300.0	4,431.8	4,377.3	7.5	14.1	111.19	-211.5	545.5	587.8	572.5	15.34	38.327		
4,400.0	4,400.0	4,530.4	4,474.5	7.7	14.5	112.54	-220.7	531.9	578.4	562.6	15.75	36.721		
4,500.0	4,500.0	4,624.3	4,567.1	7.8	14.8	113.82	-229.3	519.3	569.5	553.3	16.17	35.231		
4,600.0	4,600.0	4,714.0	4,656.0	8.0	15.0	114.87	-236.1	509.2	562.4	545.8	16.56	33.950		
4,700.0	4,700.0	4,800.0	4,741.6	8.2	15.2	115.67	-241.1	501.7	557.0	540.1	16.94	32.877		
4,800.0	4,800.0	4,895.3	4,836.6	8.4	15.4	116.30	-245.1	495.9	553.4	536.0	17.33	31.940		
4,882.1	4,882.1	4,970.3	4,911.5	8.5	15.5	-110.77	-246.9	493.2	552.2	529.6	22.62	24.416 CC, ES		
4,900.0	4,900.0	4,986.6	4,927.8	8.5	15.5	-110.81	-247.2	492.8	552.3	529.6	22.67	24.364		
5,000.0	4,999.6	5,079.4	5,020.6	8.7	15.6	-111.37	-247.7	492.0	554.6	531.7	22.90	24.216 SF		
5,100.0	5,098.8	5,178.6	5,119.8	8.9	15.7	-112.47	-247.7	492.0	559.5	536.4	23.10	24.223		
5,200.0	5,197.1	5,276.9	5,218.1	9.1	15.8	-113.94	-247.7	492.0	566.8	543.5	23.27	24.358		
5,300.0	5,294.3	5,374.1	5,315.3	9.3	15.9	-115.78	-247.7	492.0	576.8	553.4	23.42	24.632		
5,400.0	5,391.1	5,470.9	5,412.1	9.6	16.0	-117.93	-247.7	492.0	588.5	564.9	23.55	24.993		
5,500.0	5,487.9	5,567.7	5,508.9	9.8	16.1	-120.00	-247.7	492.0	601.0	577.3	23.69	25.370		
5,600.0	5,584.7	5,664.4	5,605.7	10.1	16.2	-121.99	-247.7	492.0	614.3	590.4	23.84	25.761		
5,700.0	5,681.4	5,761.2	5,702.4	10.4	16.3	-123.90	-247.7	492.0	628.3	604.3	24.01	26.165		
5,800.0	5,778.2	5,858.0	5,799.2	10.7	16.4	-125.72	-247.7	492.0	643.0	618.8	24.19	26.579		

CC - Min centre to center distance or convergent point, SF - min separation factor, ES - min ellipse separation



# Anticollision Report

<b>Company:</b>	EnCana Oil & Gas (USA) Inc	<b>Local Co-ordinate Reference:</b>	Well lone 4B-10H
<b>Project:</b>	DJ Wattenberg	<b>TVD Reference:</b>	KBE @ 5008.0ft (Original Well Elev)
<b>Reference Site:</b>	SESE S10-T2N-R66W (lone)	<b>MD Reference:</b>	KBE @ 5008.0ft (Original Well Elev)
<b>Site Error:</b>	0.0ft	<b>North Reference:</b>	True
<b>Reference Well:</b>	lone 4B-10H	<b>Survey Calculation Method:</b>	Minimum Curvature
<b>Well Error:</b>	0.0ft	<b>Output errors are at</b>	2.00 sigma
<b>Reference Wellbore</b>	HZ	<b>Database:</b>	USA EDM 5000 Multi Users DB
<b>Reference Design:</b>	Plan #1	<b>Offset TVD Reference:</b>	Offset Datum

Offset Design SESE S10-T2N-R66W (lone) - lone 6-8-10 - DD - Plan #1													Offset Site Error:	0.0 ft
Survey Program: 0-MWD													Offset Well Error:	0.0 ft
Reference		Offset		Semi Major Axis			Distance				Total Uncertainty Axis	Separation Factor	Warning	
Measured Depth (ft)	Vertical Depth (ft)	Measured Depth (ft)	Vertical Depth (ft)	Reference (ft)	Offset (ft)	Highside Toolface (°)	Offset Wellbore Centre +N/-S (ft)	+E/-W (ft)	Between Centres (ft)	Between Ellipses (ft)				
5,900.0	5,875.0	5,954.8	5,896.0	11.0	16.5	-127.47	-247.7	492.0	658.3	633.9	24.38	27.001		
6,000.0	5,971.8	6,051.6	5,992.8	11.4	16.6	-129.13	-247.7	492.0	674.2	649.7	24.58	27.429		
6,100.0	6,068.5	6,148.3	6,089.5	11.7	16.7	-130.72	-247.7	492.0	690.7	665.9	24.79	27.861		
6,200.0	6,165.3	6,245.1	6,186.3	12.1	16.8	-132.24	-247.7	492.0	707.7	682.7	25.01	28.297		
6,300.0	6,262.1	6,341.9	6,283.1	12.4	16.9	-133.69	-247.7	492.0	725.2	699.9	25.24	28.734		
6,400.0	6,358.9	6,438.7	6,379.9	12.8	17.0	-135.07	-247.7	492.0	743.1	717.6	25.47	29.171		
6,500.0	6,455.6	6,535.4	6,476.6	13.2	17.2	-136.39	-247.7	492.0	761.4	735.7	25.72	29.608		
6,600.0	6,552.4	6,632.2	6,573.4	13.5	17.3	-137.65	-247.7	492.0	780.1	754.1	25.97	30.044		
6,700.0	6,649.4	6,729.2	6,670.4	13.9	17.4	-149.96	-247.7	492.0	799.0	772.8	26.14	30.561		
6,800.0	6,747.9	6,827.7	6,768.9	14.2	17.5	149.03	-247.7	492.0	815.3	789.1	26.26	31.043		
6,900.0	6,845.3	6,925.1	6,866.3	14.3	17.6	111.04	-247.7	492.0	827.9	801.3	26.53	31.206		
7,000.0	6,938.2	7,018.0	6,959.2	14.3	17.7	99.67	-247.7	492.0	837.3	810.4	26.88	31.145		
7,100.0	7,023.0	7,102.8	7,044.0	14.2	17.8	96.32	-247.7	492.0	845.4	818.2	27.26	31.013		
7,200.0	7,096.7	7,176.5	7,117.7	14.2	17.9	95.75	-247.7	492.0	854.8	827.2	27.60	30.976		
7,300.0	7,156.5	7,236.3	7,177.5	14.2	18.0	95.79	-247.7	492.0	868.3	840.4	27.87	31.151		
7,400.0	7,200.3	7,280.1	7,221.3	14.3	18.0	95.22	-247.7	492.0	888.1	859.9	28.17	31.522		
7,500.0	7,226.4	7,306.2	7,247.4	14.6	18.1	93.25	-247.7	492.0	915.5	886.9	28.62	31.995		
7,600.0	7,234.0	7,313.8	7,255.0	15.1	18.1	90.00	-247.7	492.0	950.5	921.3	29.23	32.521		
7,700.0	7,234.0	7,313.8	7,255.0	15.8	18.1	90.00	-247.7	492.0	993.4	963.4	29.97	33.148		

## Anticollision Report

<b>Company:</b>	EnCana Oil & Gas (USA) Inc	<b>Local Co-ordinate Reference:</b>	Well lone 4B-10H
<b>Project:</b>	DJ Wattenberg	<b>TVD Reference:</b>	KBE @ 5008.0ft (Original Well Elev)
<b>Reference Site:</b>	SESE S10-T2N-R66W (lone)	<b>MD Reference:</b>	KBE @ 5008.0ft (Original Well Elev)
<b>Site Error:</b>	0.0ft	<b>North Reference:</b>	True
<b>Reference Well:</b>	lone 4B-10H	<b>Survey Calculation Method:</b>	Minimum Curvature
<b>Well Error:</b>	0.0ft	<b>Output errors are at</b>	2.00 sigma
<b>Reference Wellbore</b>	HZ	<b>Database:</b>	USA EDM 5000 Multi Users DB
<b>Reference Design:</b>	Plan #1	<b>Offset TVD Reference:</b>	Offset Datum

<b>Offset Design</b> SESE S10-T2N-R66W (lone) - McPeck #24-10 (Existing) - Existing - Existing													<b>Offset Site Error:</b>	0.0 ft
Survey Program: 183-MWD													<b>Offset Well Error:</b>	0.0 ft
Reference		Offset		Semi Major Axis			Distance				Total Uncertainty Axis	Separation Factor	Warning	
Measured Depth (ft)	Vertical Depth (ft)	Measured Depth (ft)	Vertical Depth (ft)	Reference (ft)	Offset (ft)	Highside Toolface (°)	Offset Wellbore Centre +N/-S (ft)	+E/-W (ft)	Between Centres (ft)	Between Ellipses (ft)				
0.0	0.0	0.0	0.0	0.0	0.0	-82.36	138.5	-1,031.5	1,040.8					
100.0	100.0	99.8	99.8	0.2	0.2	-82.36	138.4	-1,031.3	1,040.6	1,040.3	0.31	3,312.574		
200.0	200.0	203.8	203.8	0.3	0.3	-82.37	138.1	-1,030.6	1,039.9	1,039.2	0.66	1,574.824		
300.0	300.0	302.6	302.6	0.5	0.5	-82.38	137.7	-1,029.9	1,039.1	1,038.1	1.01	1,031.047		
400.0	400.0	396.5	396.5	0.7	0.7	-82.39	137.5	-1,029.4	1,038.5	1,037.2	1.35	771.443		
413.8	413.8	408.9	408.8	0.7	0.7	-82.40	137.4	-1,029.4	1,038.5	1,037.1	1.39	746.128	CC, ES	
500.0	500.0	486.3	486.2	0.8	0.8	-82.43	136.9	-1,029.8	1,038.9	1,037.2	1.68	619.488		
600.0	600.0	579.7	579.7	1.0	1.0	-82.46	136.4	-1,031.0	1,040.1	1,038.1	2.01	516.438		
700.0	700.0	678.2	678.2	1.2	1.2	-82.48	136.3	-1,032.6	1,041.7	1,039.3	2.36	441.357		
800.0	800.0	775.4	775.4	1.4	1.3	-82.50	136.2	-1,034.3	1,043.4	1,040.7	2.70	385.827	SF	

## Anticollision Report

<b>Company:</b>	EnCana Oil & Gas (USA) Inc	<b>Local Co-ordinate Reference:</b>	Well lone 4B-10H
<b>Project:</b>	DJ Wattenberg	<b>TVD Reference:</b>	KBE @ 5008.0ft (Original Well Elev)
<b>Reference Site:</b>	SESE S10-T2N-R66W (lone)	<b>MD Reference:</b>	KBE @ 5008.0ft (Original Well Elev)
<b>Site Error:</b>	0.0ft	<b>North Reference:</b>	True
<b>Reference Well:</b>	lone 4B-10H	<b>Survey Calculation Method:</b>	Minimum Curvature
<b>Well Error:</b>	0.0ft	<b>Output errors are at</b>	2.00 sigma
<b>Reference Wellbore</b>	HZ	<b>Database:</b>	USA EDM 5000 Multi Users DB
<b>Reference Design:</b>	Plan #1	<b>Offset TVD Reference:</b>	Offset Datum

Reference Depths are relative to KBE @ 5008.0ft (Original Well Elev)

Offset Depths are relative to Offset Datum

Central Meridian is -105.500000 °

Coordinates are relative to: lone 4B-10H

Coordinate System is US State Plane 1983, Colorado Northern Zone

Grid Convergence at Surface is: 0.48°

