

APPROXIMATE DISTURBANCE AREA: 4.2 ACRES±
 1.3% GRADE ON A SOUTHEASTERLY SLOPE
 UNGRADED ELEVATION: 4902.6'
 FINISHED ELEVATION: 4902.3'

2A ATTACHMENT

2

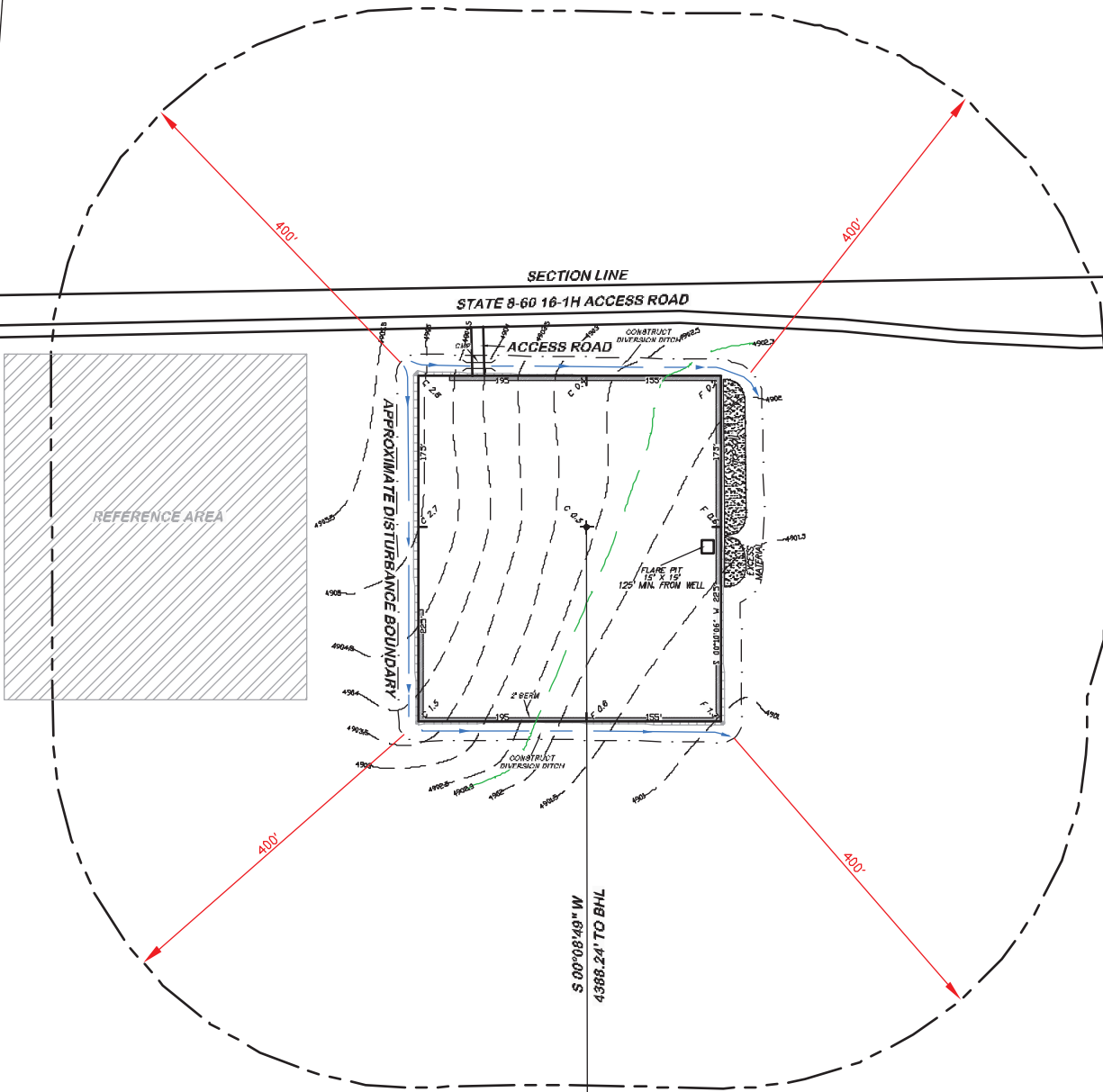

BEFORE DIGGING
 CALL FOR
 UTILITY LINE LOCATION

NOTE: THE EARTH QUANTITIES ON
 THIS DRAWING ARE ESTIMATED
 AND THE USE OF IS AT THE
 RESPONSIBILITY OF THE USER.

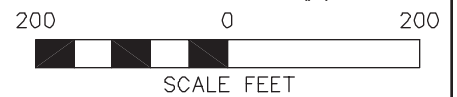

COUNTY ROAD 103



RIFFIN & ASSOCIATES, INC.
 1414 ELK ST., ROCK SPRINGS, WY 82901

(307) 362-5028

DRAWN: 11/30/11 - JMB

REVISED: NA

SCALE: 1" = 200'

DRG JOB No. 18947

EXHIBIT 2C

LOCATION DRAWING

CHESAPEAKE ENERGY, LLC.
STATE 8-60 16-4H
SECTION 16, T8N, R60W

UNGRADED ELEVATION: 4902.6'
FINISHED ELEVATION: 4902.3'