

# KGH OPERATING COMPANY

## CONSTRUCTION LAYOUT FOR

MEAGHER #3-1

SECTION 3, T1S, R104W, 6th P.M.

623' FSL 503' FWL

FIGURE #1

SCALE: 1" = 50'

DATE: 07-06-11

DRAWN BY: S.R.L.

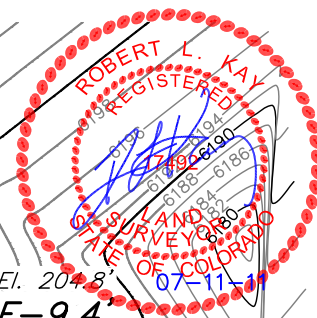
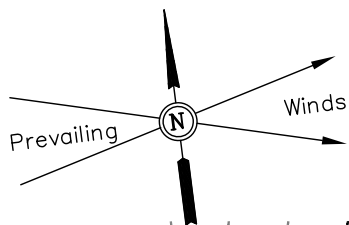

### NOTE:

Flare Pit is to be located a min. of 100' from the Well Head.

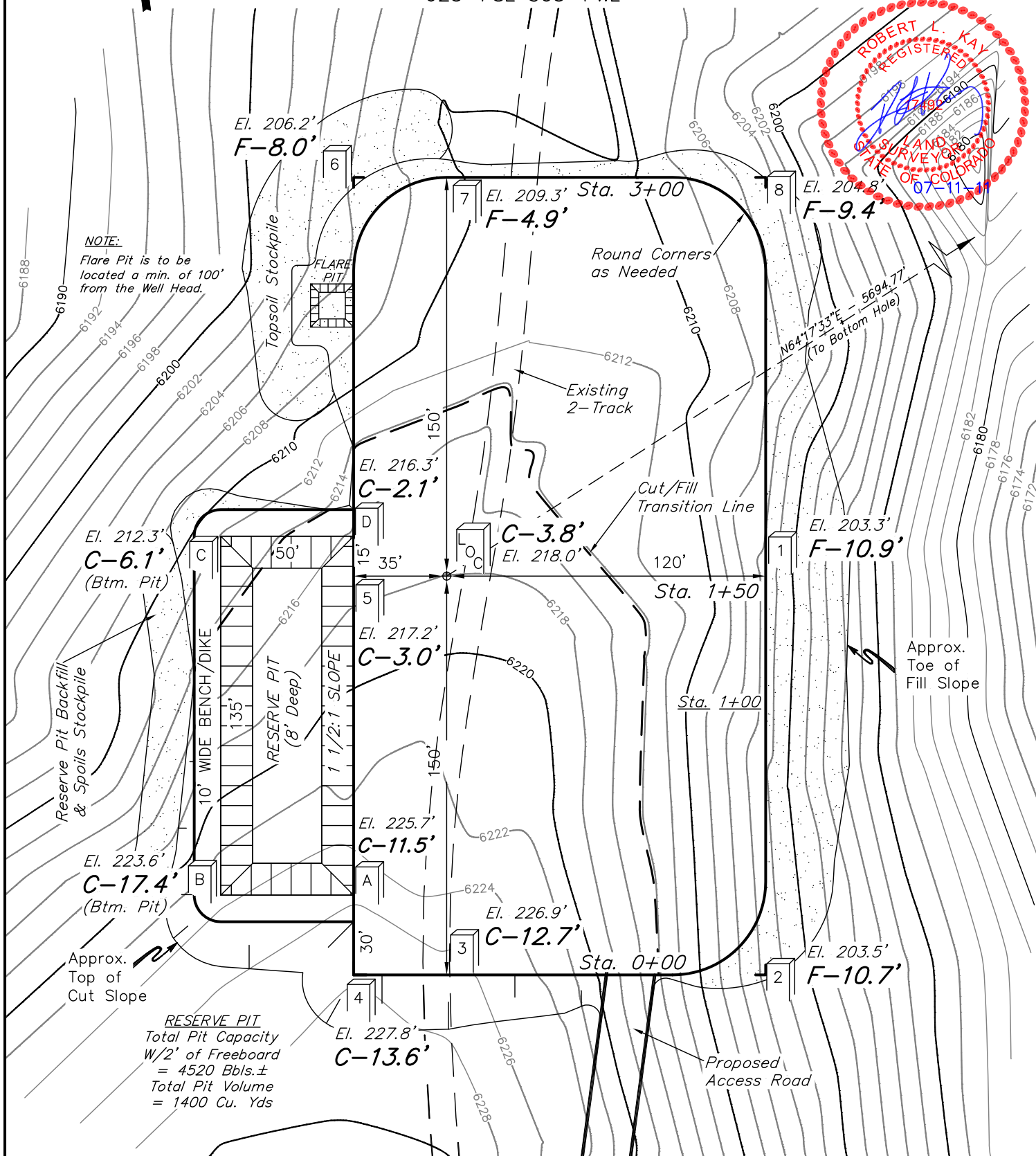

Elev. Ungraded Ground At Loc. Stake = **6218.0'**  
 FINISHED GRADE ELEV. AT LOC. STAKE = **6214.2'**

UINTAH ENGINEERING & LAND SURVEYING

85 So. 200 East \* Vernal, Utah 84078 \* (435) 789-1017

1" = 20'  
X-Section  
Scale  
1" = 50'

DATE: 07-06-11  
DRAWN BY: S.R.L.

KGH OPERATING COMPANY  
CONSTRUCTION LAYOUT CROSS SECTIONS FOR  
MEAGHER #3-1  
SECTION 3, T1S, R104W, 6th P.M.  
623' FSL 503' FWL

FIGURE #2

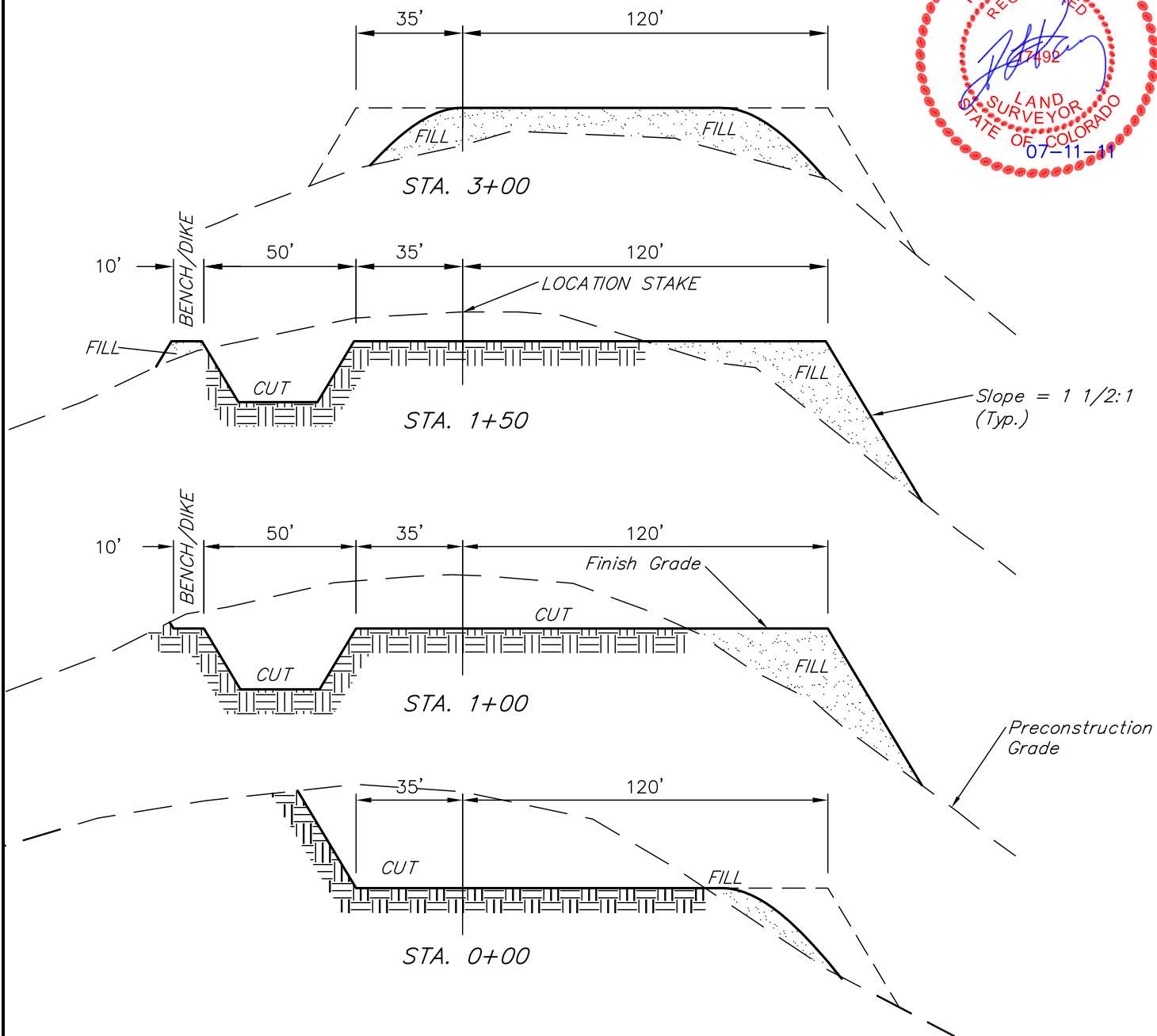

NOTE:

Topsoil should not be Stripped Below Finished Grade on Substructure Area.

APPROXIMATE ACREAGES

WELL SITE DISTURBANCE = ± 1.731 ACRES  
ACCESS ROAD DISTURBANCE = ± 1.127 ACRES  
PIPELINE DISTURBANCE = ± 1.123 ACRES  
TOTAL = ± 3.981 ACRES

\* NOTE:  
FILL QUANTITY INCLUDES 5% FOR COMPACTION

APPROXIMATE YARDAGES

(6") Topsoil Stripping = 1,360 Cu. Yds.  
Remaining Location = 7,210 Cu. Yds.  
TOTAL CUT = 8,570 CU.YDS.  
FILL = 6,510 CU.YDS.

EXCESS MATERIAL = 2,060 Cu. Yds.  
Topsoil & Pit Backfill = 2,060 Cu. Yds.  
(1/2 Pit Vol.)  
EXCESS UNBALANCE = 0 Cu. Yds.  
(After Interim Rehabilitation)

UINTAH ENGINEERING & LAND SURVEYING  
85 So. 200 East \* Vernal, Utah 84078 \* (435) 789-1017



# KGH OPERATING COMPANY

## TYPICAL RIG LAYOUT FOR

MEAGHER #3-1  
SECTION 3, T1S, R104W, 6th P.M.  
623' FSL 503' FWL

FIGURE #3

SCALE: 1" = 50'  
DATE: 07-06-11  
DRAWN BY: S.R.L.

