

**KGH OPERATING COMPANY**  
**MEAGHER #10-2H**  
LOCATED IN RIO BLANCO COUNTY, COLORADO  
SECTION 10, T1S, R104W, 6th P.M.

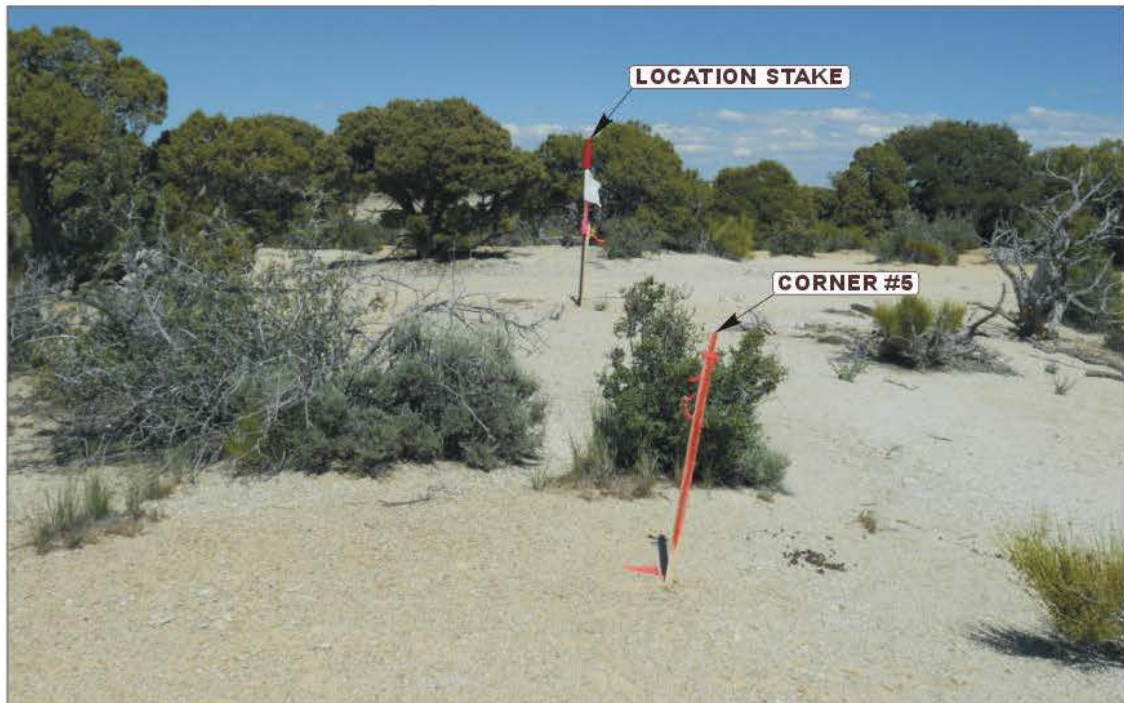

PHOTO: VIEW FROM CORNER #5 TO LOCATION STAKE

CAMERA ANGLE: EASTERLY



PHOTO: VIEW FROM BEGINNING OF PROPOSED ACCESS

CAMERA ANGLE: NORTHERLY



- Since 1964 -

**U  
E  
L  
S**

Uintah Engineering & Land Surveying  
85 South 200 East Vernal, Utah 84078  
(435) 789-1017 \* FAX (435) 789-1813

**LOCATION PHOTOS**

**06** **27** **11**  
MONTH DAY YEAR

TAKEN BY: A.F. DRAWN BY: C.A.G. REVISED: 00-00-00

PHOTO

**P1**



# KGH OPERATING COMPANY

## MEAGHER #10-2H

LOCATED IN RIO BLANCO COUNTY, COLORADO  
SECTION 10, T1S, R104W, 6th P.M.



PHOTO: VIEW OF LOCATION STAKE

CAMERA ANGLE: NORTHERLY



PHOTO: VIEW OF LOCATION STAKE

CAMERA ANGLE: EASTERLY



- Since 1964 -

**UELS**

Uintah Engineering & Land Surveying

85 South 200 East Vernal, Utah 84078  
(435) 789-1017 \* FAX (435) 789-1813

LOCATION PHOTOS

06 27 11  
MONTH DAY YEAR

TAKEN BY: A.F. DRAWN BY: C.A.G. REVISED: 00-00-00

PHOTO

P2



**KGH OPERATING COMPANY**  
**MEAGHER #10-2H**  
LOCATED IN RIO BLANCO COUNTY, COLORADO  
SECTION 10, T1S, R104W, 6th P.M.



PHOTO: VIEW OF LOCATION STAKE

CAMERA ANGLE: SOUTHERLY



PHOTO: VIEW OF LOCATION STAKE

CAMERA ANGLE: WESTERLY



- Since 1964 -

**UELS**

Uintah Engineering & Land Surveying  
85 South 200 East Vernal, Utah 84078  
(435) 789-1017 \* FAX (435) 789-1813

**LOCATION PHOTOS**

**06** **27** **11**  
MONTH DAY YEAR

TAKEN BY: A.F. DRAWN BY: C.A.G. REVISED: 00-00-00

PHOTO  
**P3**