

# KGH OPERATING COMPANY

## CONSTRUCTION LAYOUT FOR

MEAGHER #10-2H

SECTION 10, T1S, R104W, 6th P.M.

1259' FNL 233' FWL

FIGURE #1

SCALE: 1" = 50'

DATE: 07-01-11

DRAWN BY: S.R.L.

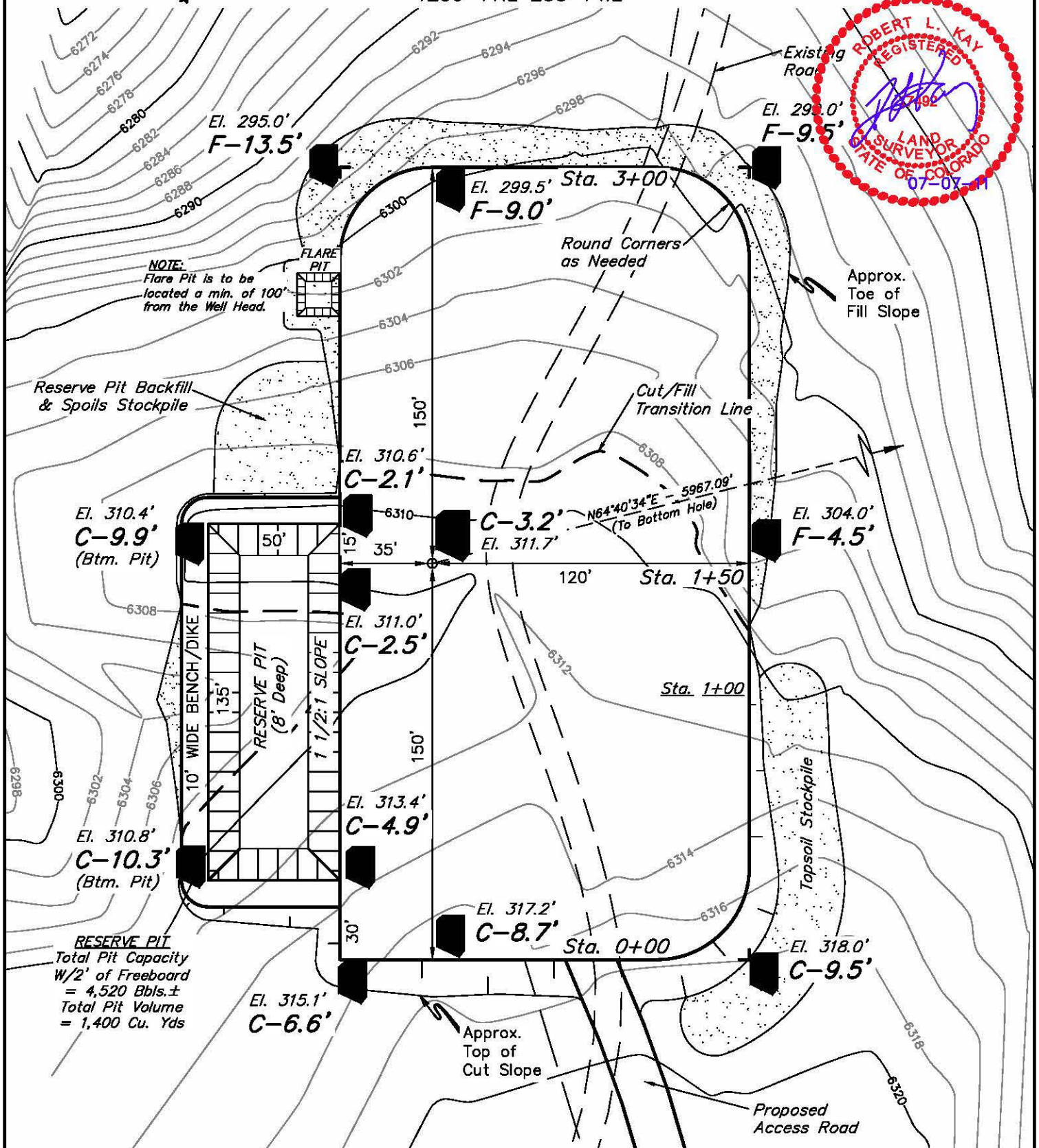
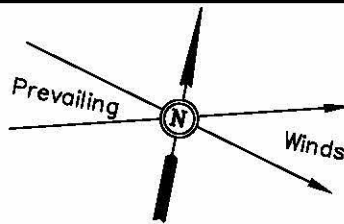

Elev. Ungraded Ground At Loc. Stake = 6311.7'  
FINISHED GRADE ELEV. AT LOC. STAKE = 6308.5'

UINTAH ENGINEERING & LAND SURVEYING  
85 So. 200 East \* Vernal, Utah 84078 \* (435) 789-1017

1" = 20'  
X-Section  
Scale  
1" = 50'

**KGH OPERATING COMPANY**  
**CONSTRUCTION LAYOUT CROSS SECTIONS FOR**  
**MEAGHER #10-2H**  
**SECTION 10, T1S, R104W, 6th P.M.**  
**1259' FNL 233' FWL**

**FIGURE #2**

DATE: 07-05-11  
DRAWN BY: S.R.L.

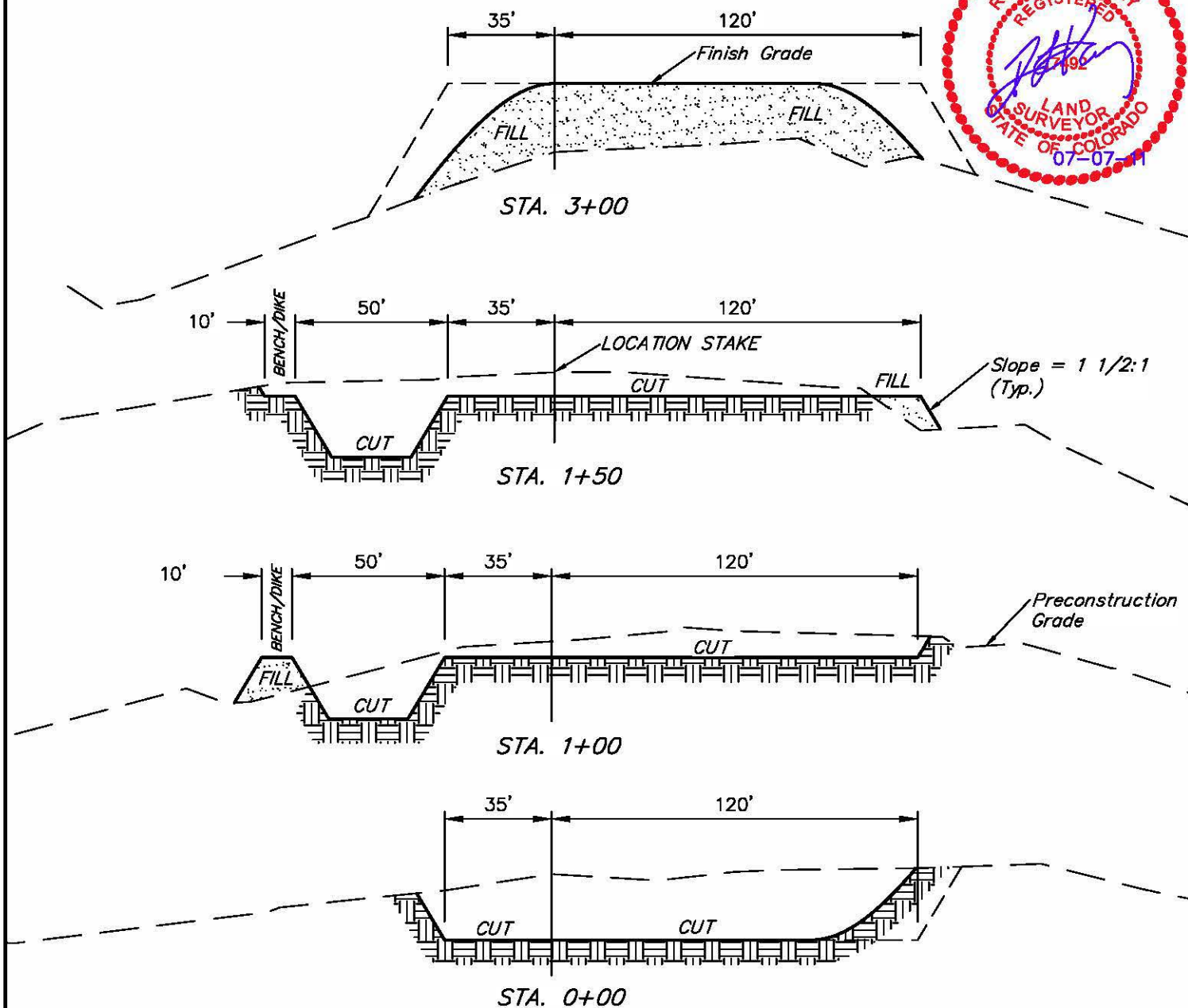
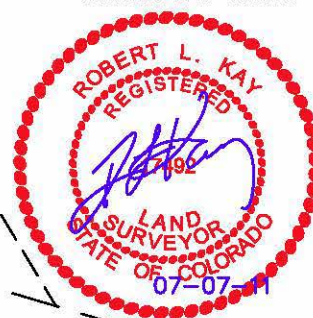

**NOTE:**

Topsoil should not be Stripped Below Finished Grade on Substructure Area.

**APPROXIMATE ACREAGES**

WELL SITE DISTURBANCE = ± 1.626 ACRES  
ACCESS ROAD DISTURBANCE = ± 1.045 ACRES  
PIPELINE DISTURBANCE = ± 1.032 ACRES  
TOTAL = ± 3.703 ACRES

**\* NOTE:**

FILL QUANTITY INCLUDES 5% FOR COMPACTION

**APPROXIMATE YARDAGES**

(6") Topsoil Stripping = 1,250 Cu. Yds.  
Remaining Location = 5,180 Cu. Yds.  
TOTAL CUT = 6,430 CU.YDS.  
FILL = 4,480 CU.YDS.

EXCESS MATERIAL = 1,950 Cu. Yds.  
Topsoil & Pit Backfill = 1,950 Cu. Yds.  
(1/2 Pit Vol.)  
EXCESS UNBALANCE = 0 Cu. Yds.  
(After Interim Rehabilitation)

**UINTAH ENGINEERING & LAND SURVEYING**  
85 So. 200 East \* Vernal, Utah 84078 \* (435) 789-1017



KGH OPERATING COMPANY  
TYPICAL RIG LAYOUT FOR  
MEAGHER #10-2H  
SECTION 10, T1S, R104W, 6th P.M.  
1259' FNL 233' FWL

FIGURE #3

SCALE: 1" = 50'  
DATE: 07-01-11  
DRAWN BY: S.R.L.



NOTE:  
Flare Pit is to be  
located a min. of 100'  
from the Well Head.

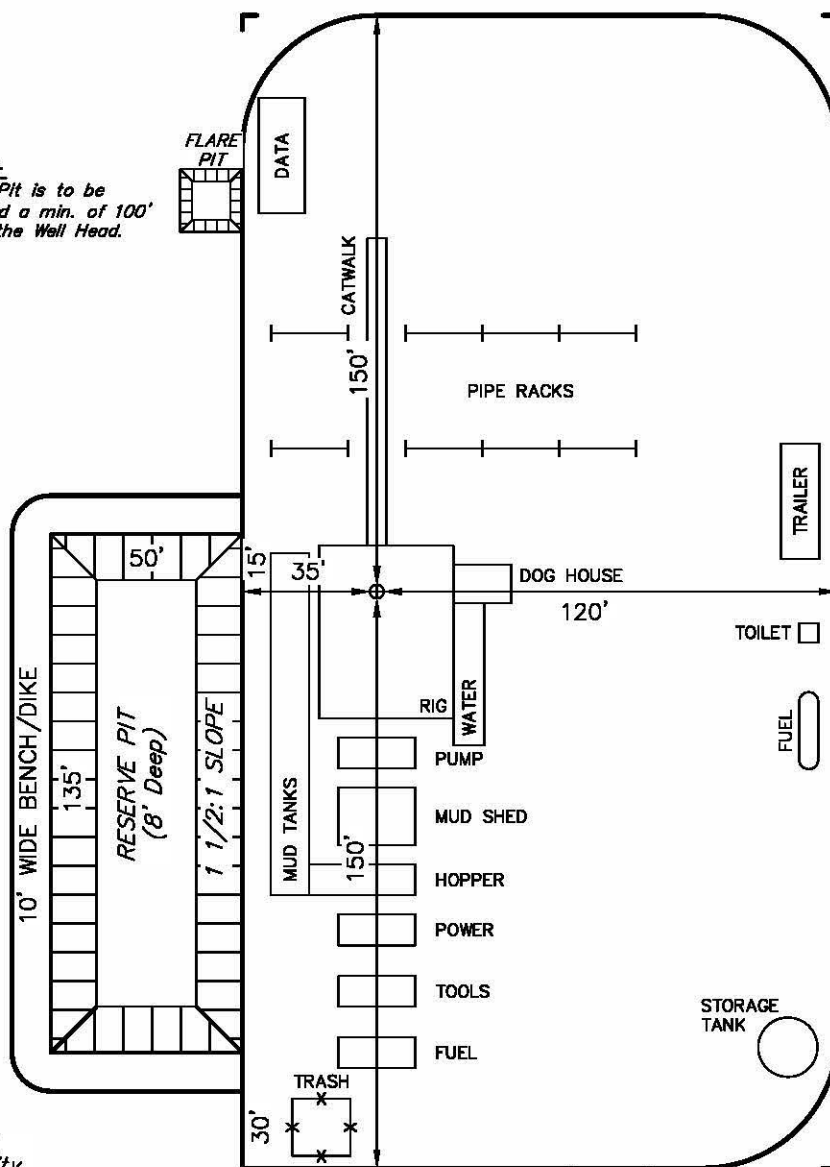

RESERVE PIT  
Total Pit Capacity  
W/2' of Freeboard  
= 4,520 Bbls.±  
Total Pit Volume  
= 1,400 Cu. Yds

Proposed  
Access Road