

CARRIZO OIL & GAS, INC.
CONSTRUCTION LAYOUT FOR
BARRACUDA #29-11-7-60 & #29-21-7-60
SECTION 29, T7N, R60W, 6th. P.M.
NW 1/4 NW 1/4

FIGURE #1

SCALE: 1" = 60'
 DATE: 07-13-11
 DRAWN BY: J.I.
 REV.: 08-02-11
 REV.: 10-17-11
 REV.: 11-23-11

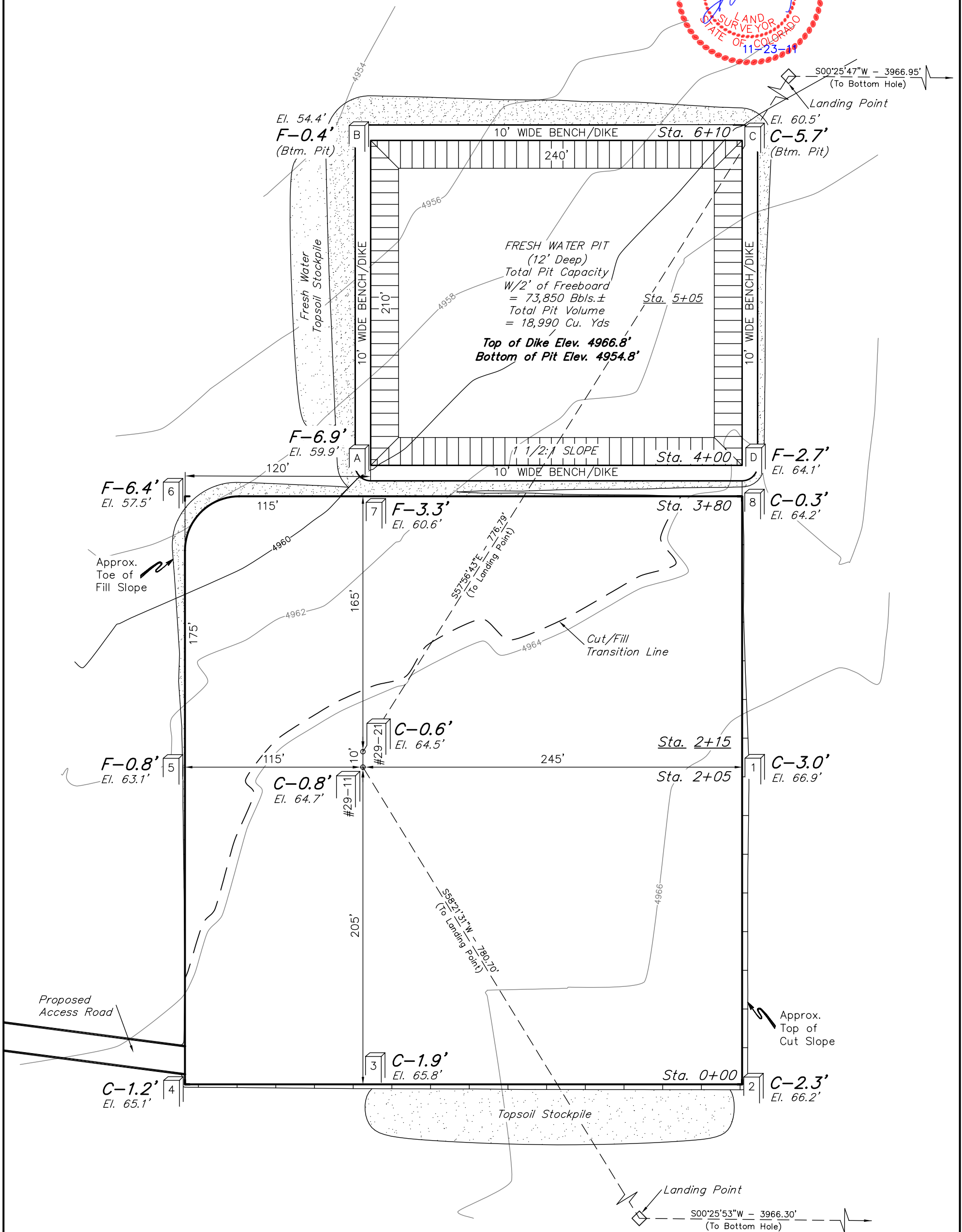
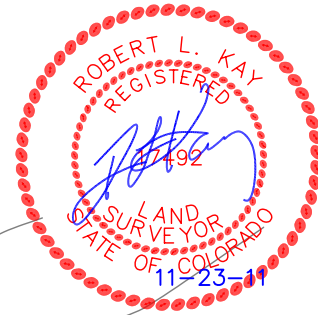
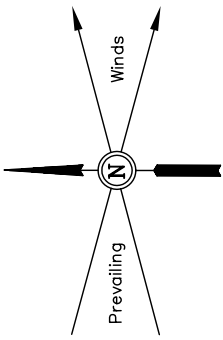

Elev. Ungraded Ground At #29-11-7-60 Loc. Stake = **4964.7'**
 FINISHED GRADE ELEV. AT #29-11-7-60 LOC. STAKE = **4963.9'**

UINTAH ENGINEERING & LAND SURVEYING
 85 So. 200 East * Vernal, Utah 84078 * (435) 789-1017

CARRIZO OIL & GAS, INC.
CONSTRUCTION LAYOUT CROSS SECTIONS FOR
BARRACUDA #29-11-7-60 & #29-21-7-60
SECTION 29, T7N, R60W, 6th. P.M.
NW 1/4 NW 1/4

FIGURE #2

1" = 40'
 X-Section Scale
 1" = 100'

DATE: 07-13-11
 DRAWN BY: J.I.
 REV.: 08-02-11
 REV.: 11-23-11

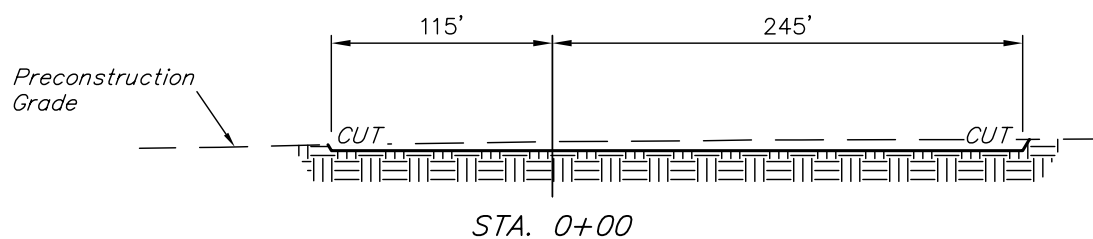
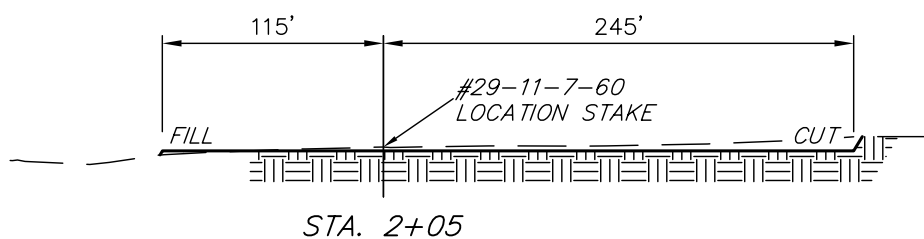
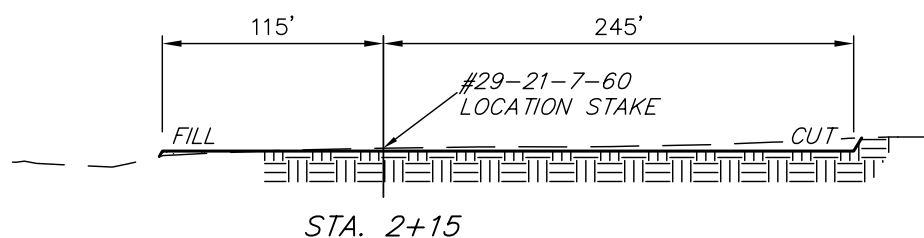
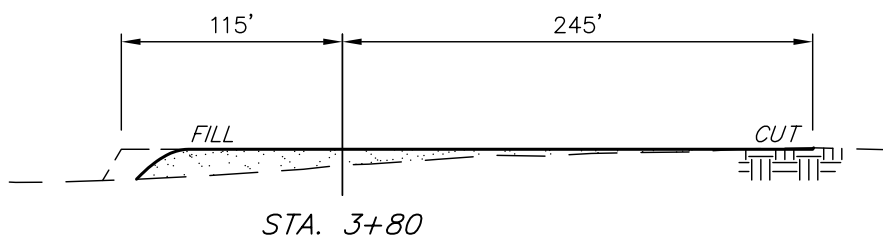
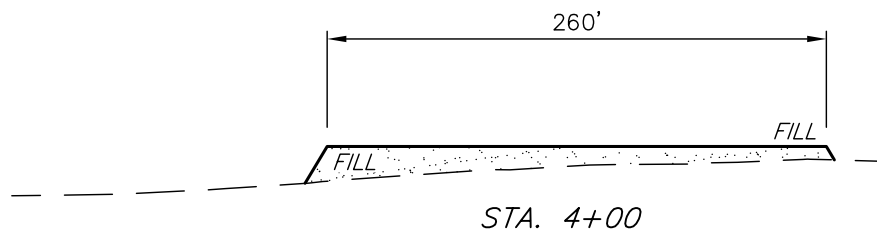
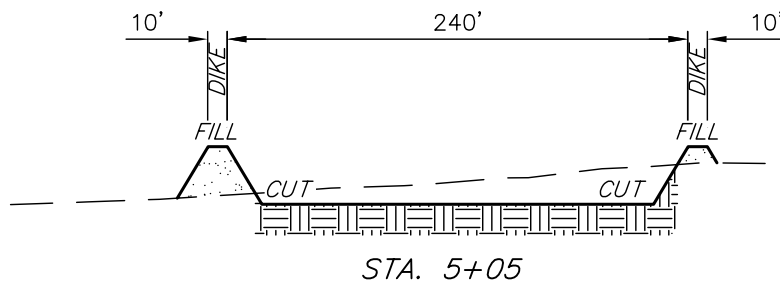
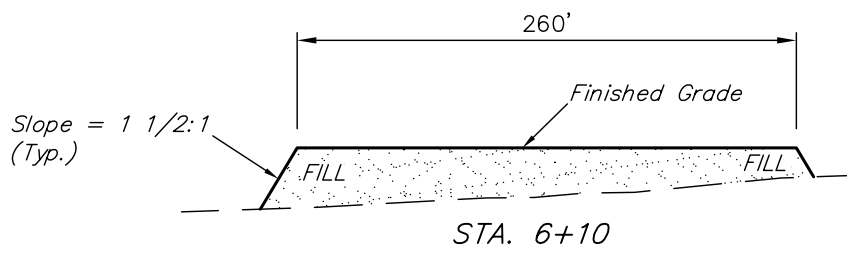

APPROXIMATE PAD YARDAGES

(6") Topsoil Stripping	=	2,630 Cu. Yds.
Remaining Location	=	3,200 Cu. Yds.
TOTAL CUT	=	5,830 CU.YDS.
FILL	=	3,200 CU.YDS.
EXCESS MATERIAL	=	2,630 Cu. Yds.
Topsoil	=	2,630 Cu. Yds.
EXCESS UNBALANCE (After Interim Rehabilitation)	=	0 Cu. Yds.

APPROXIMATE FRESH WATER PIT YARDAGES

(6") Topsoil Stripping	=	1,420 Cu. Yds.
Remaining Location	=	6,430 Cu. Yds.
TOTAL CUT	=	7,850 CU.YDS.
FILL	=	6,430 CU.YDS.
EXCESS MATERIAL	=	1,420 Cu. Yds.
Topsoil	=	1,420 Cu. Yds.
EXCESS UNBALANCE (After Interim Rehabilitation)	=	0 Cu. Yds.

NOTE:

Topsoil should not be Stripped Below Finished Grade on Substructure Area.

* NOTE: FILL QUANTITY INCLUDES 5% FOR COMPACTION

APPROXIMATE ACREAGES
 WELL SITE DISTURBANCE = ± 5.145 ACRES
 ACCESS ROAD DISTURBANCE = ± 0.107 ACRES
 TOTAL = ± 5.252 ACRES

CARRIZO OIL & GAS, INC.
 TYPICAL RIG LAYOUT FOR
 BARRACUDA #29-11-7-60 & #29-21-7-60
 SECTION 29, T7N, R60W, 6th. P.M.
 NW 1/4 NW 1/4

FIGURE #3

SCALE: 1" = 60'
 DATE: 07-13-11
 DRAWN BY: J.I.
 REV.: 08-02-11
 REV.: 11-23-11

