

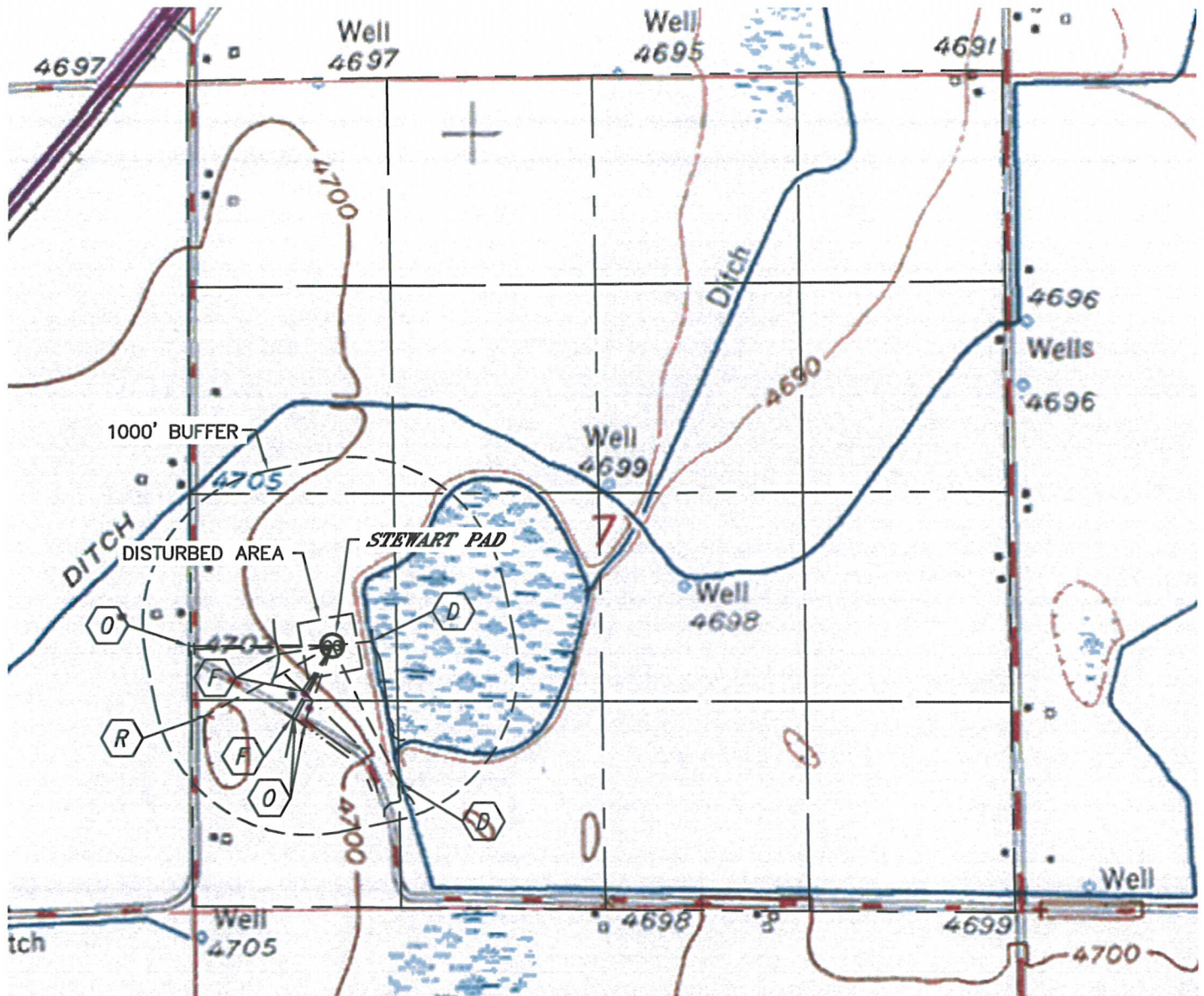

Lat40°, Inc. 1635 Foxtrail Drive, Suite 325 Loveland, CO 970-776-3321

HYDROLOGY MAP

STEWART G07-20D, STEWART FEDERAL G07-32D

SECTION: 7
TOWNSHIP: 4N
RANGE: 65W

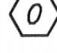
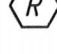

-  EDGE OF WATER 255' NE, 972' SE
-  DITCH 344' SW, 352' W, 535' SW
-  BARROW DITCH 495' SW, 513' SW, 892' W, 926' W
-  IRRIGATION POND 946' SW

