

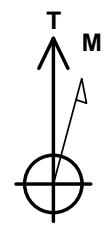

Project: Story Gulch
 Site: F25 496
 Well: SGU 8513F-24 (was 3C)
 Wellbore: DD
 Design: FINAL

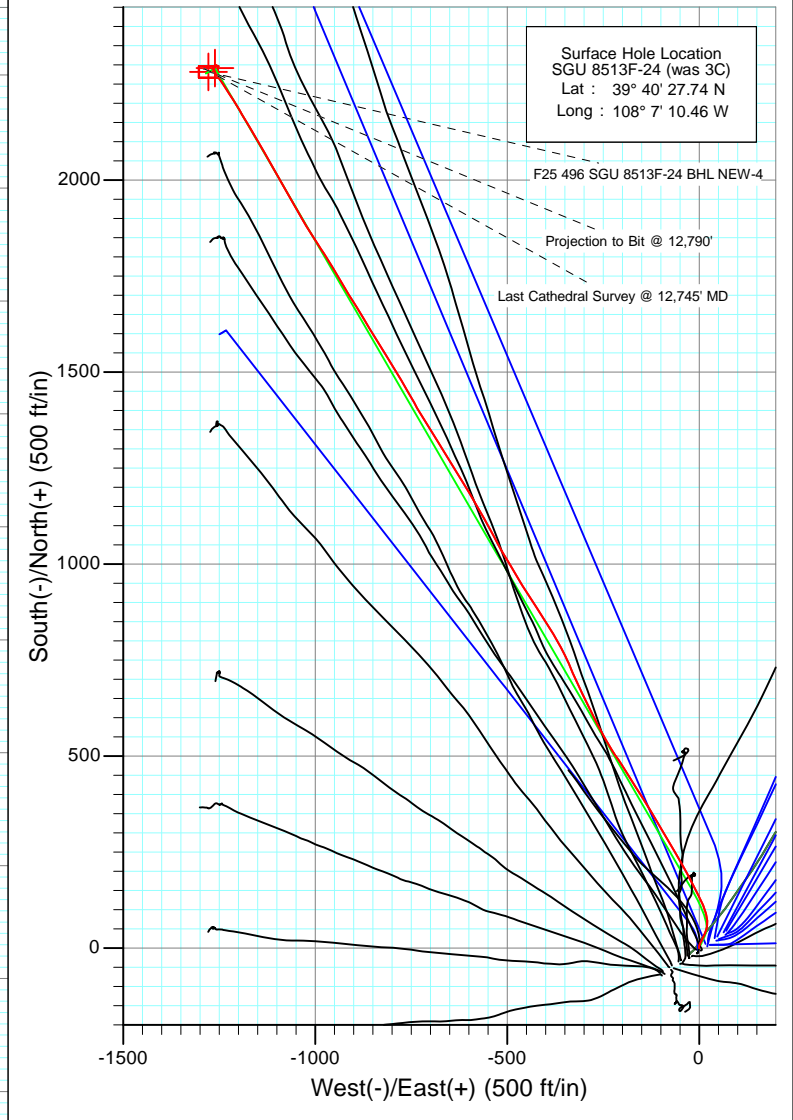

Azimuths to True North
 Magnetic North: 10.46°
 Magnetic Field
 Strength: 52337.4snT
 Dip Angle: 65.87°
 Date: 3/16/2011
 Model: IGRF2010

DD SGU 8513F-24 (was 3C)						
KBE @ 8320.0ft (Patterson 306) North American Datum 1983 Well SGU 8513F-24 (was 3C), True North						
Type	Target	TVD	+	-	N/S	E/W
Target	F25 496 SGU 8513F-24 BHL NEW-4	8355.0	2291.6	-1260.7	0.0	0.0
		12215.0	2281.6	-1277.7		
Name	Target	TVD	+	-	Latitude	Longitude
F25 496 SGU 8513F-24 TGT NEW-4		8355.0	2291.6	-1260.7	39° 40' 50.39 N	108° 7' 26.59 W
F25 496 SGU 8513F-24 BHL NEW-4		12215.0	2281.6	-1277.7	39° 40' 50.29 N	108° 7' 26.81 W



Project: Story Gulch
Site: F25 496
Well: SGU 8513F-24 (was 3C)
Wellbore: DD
Design: FINAL

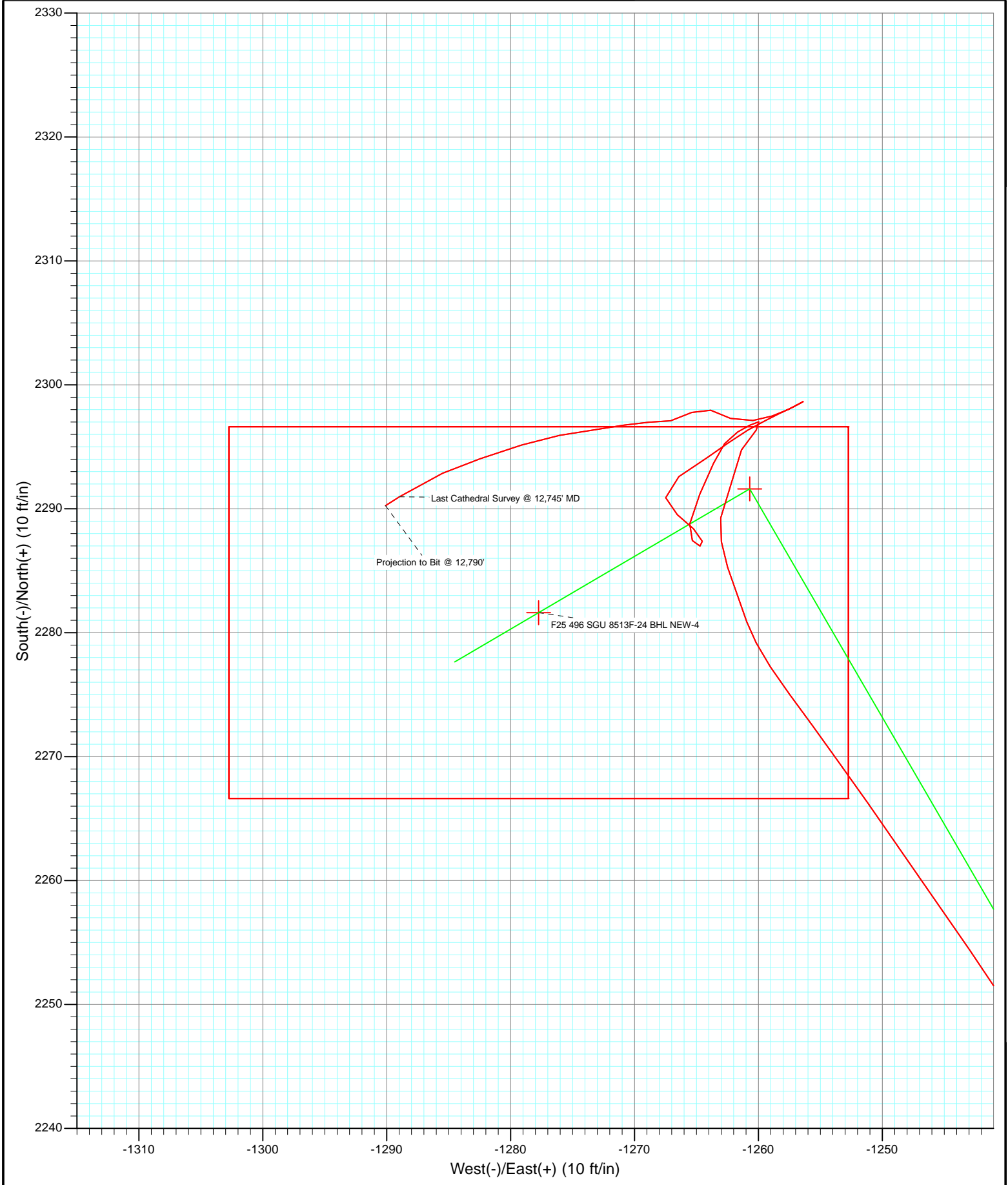

Survey Report

Company: EnCana Oil & Gas (USA) Inc	Local Co-ordinate Reference: Well SGU 8513F-24 (was 3C)
Project: Story Gulch	TVD Reference: KBE @ 8320.0ft (Patterson 306)
Site: F25 496	MD Reference: KBE @ 8320.0ft (Patterson 306)
Well: SGU 8513F-24 (was 3C)	North Reference: True
Wellbore: DD	Survey Calculation Method: Minimum Curvature
Design: DD	Database: EDM 5000.1 US Multi Users DB

Project Story Gulch		
Map System: US State Plane 1983	System Datum:	Mean Sea Level
Geo Datum: North American Datum 1983		
Map Zone: Colorado Central Zone		

Site F25 496					
Site Position:		Northing:	1,681,091.06 ft	Latitude:	39° 40' 27.10 N
From:	Lat/Long	Easting:	2,262,632.54 ft	Longitude:	108° 7' 11.76 W
Position Uncertainty:	0.0 ft	Slot Radius:	13.200 in	Grid Convergence:	-1.65 °

Well SGU 8513F-24 (was 3C)					
Well Position	+N/-S	0.0 ft	Northing:	1,681,152.96 ft	Latitude: 39° 40' 27.74 N
	+E/-W	0.0 ft	Easting:	2,262,735.38 ft	Longitude: 108° 7' 10.46 W
Position Uncertainty		0.0 ft	Wellhead Elevation:	ft	Ground Level: 8,298.0 ft

Wellbore DD					
Magnetics	Model Name	Sample Date	Declination (°)	Dip Angle (°)	Field Strength (nT)
	IGRF2010	3/16/2011	10.46	65.87	52,337

Design DD					
Audit Notes:					
Version:	1.0	Phase:	ACTUAL	Tie On Depth:	0.0
Vertical Section:		Depth From (TVD) (ft)	+N/-S (ft)	+E/-W (ft)	Direction (°)
		0.0	0.0	0.0	330.75

Survey Program Date 3/30/2011					
From (ft)	To (ft)	Survey (Wellbore)	Tool Name	Description	
190.0	12,790.0	Survey #1 (DD)	MWD	Geolink MWD	

Survey									
Measured Depth (ft)	Inclination (°)	Azimuth (°)	Vertical Depth (ft)	+N/-S (ft)	+E/-W (ft)	Vertical Section (ft)	Dogleg Rate (°/100ft)	Build Rate (°/100ft)	Formations / Comments
0.0	0.00	0.00	0.0	0.0	0.0	0.0	0.00	0.00	
190.0	1.10	351.90	190.0	1.8	-0.3	1.7	0.58	0.58	
221.0	1.20	348.30	221.0	2.4	-0.4	2.3	0.40	0.32	
252.0	0.90	351.10	252.0	3.0	-0.5	2.8	0.98	-0.97	
282.0	1.60	1.80	282.0	3.6	-0.5	3.4	2.45	2.33	
312.0	1.90	13.00	312.0	4.5	-0.4	4.1	1.51	1.00	
344.0	2.40	23.80	343.9	5.7	0.0	4.9	2.00	1.56	
436.0	4.70	25.90	435.8	10.8	2.4	8.2	2.50	2.50	
528.0	6.80	25.00	527.3	19.1	6.4	13.6	2.28	2.28	
623.0	7.10	24.70	621.6	29.6	11.2	20.3	0.32	0.32	
718.0	8.30	22.80	715.7	41.2	16.3	28.0	1.29	1.26	
814.0	9.10	9.80	810.6	55.1	20.3	38.1	2.21	0.83	
909.0	10.50	356.10	904.3	71.1	21.0	51.8	2.85	1.47	

Survey Report

Company:	EnCana Oil & Gas (USA) Inc	Local Co-ordinate Reference:	Well SGU 8513F-24 (was 3C)
Project:	Story Gulch	TVD Reference:	KBE @ 8320.0ft (Patterson 306)
Site:	F25 496	MVD Reference:	KBE @ 8320.0ft (Patterson 306)
Well:	SGU 8513F-24 (was 3C)	North Reference:	True
Wellbore:	DD	Survey Calculation Method:	Minimum Curvature
Design:	DD	Database:	EDM 5000.1 US Multi Users DB

Survey									
Measured Depth (ft)	Inclination (°)	Azimuth (°)	Vertical Depth (ft)	+N/-S (ft)	+E/-W (ft)	Vertical Section (ft)	Dogleg Rate (°/100ft)	Build Rate (°/100ft)	Formations / Comments
1,004.0	12.70	345.90	997.3	89.9	17.9	69.7	3.16	2.32	
1,099.0	15.20	337.20	1,089.5	111.5	10.5	92.2	3.43	2.63	
1,195.0	17.60	332.20	1,181.6	136.0	-1.1	119.2	2.90	2.50	
1,290.0	20.70	333.20	1,271.3	163.7	-15.4	150.3	3.28	3.26	
1,385.0	21.90	331.40	1,359.9	194.2	-31.5	184.8	1.44	1.26	
1,479.0	21.40	330.40	1,447.2	224.5	-48.3	219.5	0.66	-0.53	
1,574.0	20.70	330.00	1,535.9	254.1	-65.3	253.6	0.75	-0.74	
1,669.0	20.00	329.20	1,625.0	282.6	-82.0	286.7	0.79	-0.74	
1,764.0	19.40	330.10	1,714.4	310.3	-98.2	318.7	0.71	-0.63	
1,860.0	20.00	328.00	1,804.8	338.0	-114.8	351.0	0.97	0.62	
1,955.0	20.40	329.30	1,893.9	366.0	-131.9	383.8	0.63	0.42	
2,050.0	19.70	327.80	1,983.2	393.8	-148.9	416.3	0.91	-0.74	
2,145.0	19.80	327.20	2,072.6	420.9	-166.1	448.4	0.24	0.11	
2,240.0	20.00	328.70	2,161.9	448.3	-183.3	480.7	0.58	0.21	
2,336.0	19.90	327.00	2,252.2	476.0	-200.7	513.4	0.61	-0.10	
2,431.0	18.50	325.40	2,341.9	502.0	-218.1	544.5	1.57	-1.47	
2,487.0	17.70	325.80	2,395.1	516.3	-227.9	561.9	1.45	-1.43	
2,582.0	18.50	331.50	2,485.4	541.5	-243.2	591.3	2.04	0.84	
2,677.0	19.10	333.40	2,575.3	568.7	-257.4	621.9	0.90	0.63	
2,772.0	20.70	333.60	2,664.7	597.6	-271.8	654.2	1.69	1.68	
2,868.0	20.70	332.70	2,754.5	627.9	-287.1	688.1	0.33	0.00	
2,963.0	19.10	334.60	2,843.8	656.8	-301.5	720.4	1.82	-1.68	
2,980.0	18.90	334.80	2,859.9	661.8	-303.9	725.9	1.24	-1.18	
3,087.0	17.00	333.70	2,961.6	691.6	-318.2	758.8	1.80	-1.78	
3,178.0	17.40	338.40	3,048.6	716.1	-329.1	785.6	1.59	0.44	
3,269.0	18.00	336.40	3,135.3	741.7	-339.7	813.1	0.94	0.66	
3,361.0	21.30	334.00	3,221.9	769.7	-352.7	843.9	3.69	3.59	
3,453.0	23.00	328.70	3,307.1	800.1	-369.4	878.6	2.85	1.85	
3,545.0	21.70	328.80	3,392.2	830.0	-387.5	913.5	1.41	-1.41	
3,636.0	22.60	327.40	3,476.5	859.1	-405.7	947.8	1.15	0.99	
3,728.0	23.00	327.90	3,561.3	889.2	-424.8	983.4	0.48	0.43	
3,820.0	20.80	326.50	3,646.7	918.1	-443.3	1,017.7	2.46	-2.39	
3,911.0	19.50	327.50	3,732.1	944.4	-460.4	1,048.9	1.48	-1.43	
4,003.0	19.50	329.60	3,818.8	970.6	-476.4	1,079.6	0.76	0.00	
4,095.0	20.00	330.30	3,905.4	997.5	-492.0	1,110.7	0.60	0.54	
4,186.0	19.50	328.10	3,991.0	1,023.9	-507.7	1,141.4	0.98	-0.55	
4,278.0	20.20	331.70	4,077.6	1,050.9	-523.4	1,172.7	1.53	0.76	
4,370.0	22.60	332.60	4,163.2	1,080.6	-539.0	1,206.2	2.63	2.61	
4,461.0	22.90	330.40	4,247.2	1,111.5	-555.8	1,241.4	0.99	0.33	
4,553.0	23.10	329.40	4,331.8	1,142.6	-573.9	1,277.3	0.48	0.22	
4,644.0	21.80	329.80	4,415.9	1,172.6	-591.5	1,312.1	1.44	-1.43	
4,736.0	20.00	328.80	4,501.9	1,200.8	-608.2	1,344.9	1.99	-1.96	
4,828.0	20.50	329.80	4,588.2	1,228.2	-624.5	1,376.7	0.66	0.54	
4,919.0	20.30	328.70	4,673.5	1,255.5	-640.7	1,408.4	0.48	-0.22	
5,011.0	20.10	328.10	4,759.8	1,282.5	-657.3	1,440.2	0.31	-0.22	
5,103.0	20.90	327.10	4,846.0	1,309.7	-674.6	1,472.3	0.95	0.87	
5,194.0	20.60	327.00	4,931.1	1,336.8	-692.1	1,504.5	0.33	-0.33	
5,286.0	20.90	329.30	5,017.1	1,364.5	-709.3	1,537.1	0.94	0.33	
5,378.0	20.80	328.50	5,103.1	1,392.5	-726.2	1,569.8	0.33	-0.11	
5,469.0	21.00	331.40	5,188.1	1,420.6	-742.5	1,602.2	1.16	0.22	
5,561.0	21.10	330.50	5,274.0	1,449.5	-758.5	1,635.3	0.37	0.11	
5,653.0	21.50	328.50	5,359.7	1,478.3	-775.5	1,668.7	0.90	0.43	
5,744.0	19.10	328.60	5,445.1	1,505.2	-792.0	1,700.2	2.64	-2.64	

Survey Report

Company:	EnCana Oil & Gas (USA) Inc	Local Co-ordinate Reference:	Well SGU 8513F-24 (was 3C)
Project:	Story Gulch	TVD Reference:	KBE @ 8320.0ft (Patterson 306)
Site:	F25 496	MD Reference:	KBE @ 8320.0ft (Patterson 306)
Well:	SGU 8513F-24 (was 3C)	North Reference:	True
Wellbore:	DD	Survey Calculation Method:	Minimum Curvature
Design:	DD	Database:	EDM 5000.1 US Multi Users DB

Survey									
Measured Depth (ft)	Inclination (°)	Azimuth (°)	Vertical Depth (ft)	+N/-S (ft)	+E/-W (ft)	Vertical Section (ft)	Dogleg Rate (°/100ft)	Build Rate (°/100ft)	Formations / Comments
5,836.0	20.10	328.80	5,531.7	1,531.6	-808.0	1,731.1	1.09	1.09	
5,927.0	20.70	327.70	5,617.0	1,558.5	-824.7	1,762.8	0.78	0.66	
6,019.0	20.60	328.00	5,703.1	1,586.0	-841.9	1,795.2	0.16	-0.11	
6,110.0	20.60	330.20	5,788.3	1,613.5	-858.4	1,827.2	0.85	0.00	
6,201.0	20.50	328.80	5,873.5	1,641.0	-874.6	1,859.1	0.55	-0.11	
6,293.0	20.50	328.00	5,959.7	1,668.4	-891.5	1,891.3	0.30	0.00	
6,384.0	21.50	328.50	6,044.6	1,696.2	-908.6	1,923.9	1.12	1.10	
6,476.0	21.40	328.70	6,130.3	1,724.9	-926.2	1,957.5	0.13	-0.11	
6,567.0	21.20	329.90	6,215.0	1,753.3	-943.0	1,990.5	0.53	-0.22	
6,659.0	20.60	328.50	6,301.0	1,781.5	-959.8	2,023.3	0.85	-0.65	
6,750.0	20.10	327.40	6,386.3	1,808.3	-976.6	2,054.9	0.69	-0.55	
6,842.0	18.30	326.30	6,473.2	1,833.7	-993.2	2,085.1	2.00	-1.96	
6,933.0	17.60	328.00	6,559.8	1,857.2	-1,008.4	2,113.1	0.96	-0.77	
7,025.0	16.70	329.20	6,647.7	1,880.4	-1,022.5	2,140.2	1.05	-0.98	
7,116.0	18.20	329.10	6,734.5	1,903.8	-1,036.5	2,167.5	1.65	1.65	
7,208.0	17.50	331.00	6,822.0	1,928.2	-1,050.6	2,195.7	0.99	-0.76	
7,299.0	18.60	329.00	6,908.6	1,952.6	-1,064.7	2,223.9	1.39	1.21	
7,390.0	19.90	331.40	6,994.5	1,978.7	-1,079.6	2,253.9	1.67	1.43	
7,482.0	19.90	331.00	7,081.0	2,006.1	-1,094.7	2,285.2	0.15	0.00	
7,574.0	19.00	330.50	7,167.7	2,032.8	-1,109.6	2,315.8	0.99	-0.98	
7,665.0	18.20	330.20	7,254.0	2,058.1	-1,124.0	2,344.9	0.89	-0.88	
7,757.0	17.70	329.60	7,341.5	2,082.6	-1,138.2	2,373.2	0.58	-0.54	
7,849.0	16.80	329.40	7,429.4	2,106.1	-1,152.1	2,400.5	0.98	-0.98	
7,940.0	16.50	329.20	7,516.5	2,128.5	-1,165.4	2,426.5	0.34	-0.33	
8,032.0	15.80	329.50	7,604.9	2,150.5	-1,178.4	2,452.1	0.77	-0.76	
8,124.0	14.70	329.90	7,693.7	2,171.4	-1,190.6	2,476.3	1.20	-1.20	
8,216.0	13.50	328.20	7,782.9	2,190.6	-1,202.1	2,498.7	1.38	-1.30	
8,307.0	12.70	328.30	7,871.5	2,208.2	-1,213.0	2,519.3	0.88	-0.88	
8,399.0	12.20	327.00	7,961.4	2,224.9	-1,223.6	2,539.1	0.62	-0.54	
8,491.0	11.10	327.00	8,051.5	2,240.5	-1,233.7	2,557.7	1.20	-1.20	
8,582.0	10.00	325.70	8,140.9	2,254.4	-1,242.9	2,574.3	1.24	-1.21	
8,674.0	8.10	324.80	8,231.8	2,266.3	-1,251.2	2,588.7	2.07	-2.07	
8,766.0	5.40	323.40	8,323.1	2,275.1	-1,257.5	2,599.4	2.94	-2.93	
8,858.0	3.10	340.10	8,414.9	2,280.9	-1,260.9	2,606.2	2.81	-2.50	
8,949.0	2.80	341.30	8,505.8	2,285.3	-1,262.5	2,610.8	0.34	-0.33	
9,041.0	2.30	5.40	8,597.7	2,289.3	-1,263.0	2,614.5	1.27	-0.54	
9,225.0	1.40	36.20	8,781.6	2,294.8	-1,261.4	2,618.5	0.71	-0.49	
9,316.0	1.10	37.30	8,872.6	2,296.3	-1,260.2	2,619.3	0.33	-0.33	
9,408.0	0.40	264.10	8,964.5	2,297.0	-1,260.0	2,619.8	1.53	-0.76	
9,500.0	0.60	241.30	9,056.5	2,296.7	-1,260.7	2,619.9	0.30	0.22	
9,592.0	0.80	239.70	9,148.5	2,296.2	-1,261.7	2,619.9	0.22	0.22	
9,683.0	1.00	219.20	9,239.5	2,295.3	-1,262.7	2,619.6	0.41	0.22	
9,775.0	1.30	201.80	9,331.5	2,293.7	-1,263.6	2,618.6	0.50	0.33	
9,867.0	2.10	205.40	9,423.5	2,291.2	-1,264.7	2,617.0	0.88	0.87	
9,959.0	1.10	185.50	9,515.4	2,288.8	-1,265.5	2,615.3	1.23	-1.09	
10,050.0	0.70	147.80	9,606.4	2,287.4	-1,265.3	2,614.0	0.76	-0.44	
10,142.0	0.40	83.60	9,698.4	2,287.0	-1,264.7	2,613.4	0.69	-0.33	
10,324.0	1.10	318.70	9,880.4	2,288.4	-1,265.2	2,614.8	0.75	0.38	
10,416.0	1.10	303.60	9,972.4	2,289.5	-1,266.5	2,616.5	0.31	0.00	
10,509.0	1.10	347.80	10,065.4	2,290.9	-1,267.5	2,618.1	0.89	0.00	
10,600.0	1.90	55.90	10,156.3	2,292.6	-1,266.4	2,619.1	1.98	0.88	
10,692.0	1.50	56.40	10,248.3	2,294.1	-1,264.1	2,619.3	0.44	-0.43	
10,784.0	1.20	53.30	10,340.3	2,295.4	-1,262.4	2,619.5	0.34	-0.33	

Survey Report

Company: EnCana Oil & Gas (USA) Inc	Local Co-ordinate Reference: Well SGU 8513F-24 (was 3C)
Project: Story Gulch	TVD Reference: KBE @ 8320.0ft (Patterson 306)
Site: F25 496	MD Reference: KBE @ 8320.0ft (Patterson 306)
Well: SGU 8513F-24 (was 3C)	North Reference: True
Wellbore: DD	Survey Calculation Method: Minimum Curvature
Design: DD	Database: EDM 5000.1 US Multi Users DB

Survey									
Measured Depth (ft)	Inclination (°)	Azimuth (°)	Vertical Depth (ft)	+N/-S (ft)	+E/-W (ft)	Vertical Section (ft)	Dogleg Rate (°/100ft)	Build Rate (°/100ft)	Formations / Comments
10,875.0	1.10	60.70	10,431.3	2,296.4	-1,260.8	2,619.6	0.20	-0.11	
10,967.0	0.80	63.00	10,523.3	2,297.1	-1,259.5	2,619.6	0.33	-0.33	
11,058.0	0.80	62.70	10,614.2	2,297.7	-1,258.4	2,619.6	0.00	0.00	
11,150.0	0.80	66.80	10,706.2	2,298.2	-1,257.2	2,619.5	0.06	0.00	
11,241.0	0.40	50.40	10,797.2	2,298.7	-1,256.4	2,619.5	0.47	-0.44	
11,333.0	0.60	231.00	10,889.2	2,298.6	-1,256.5	2,619.4	1.09	0.22	
11,425.0	0.90	250.10	10,981.2	2,298.0	-1,257.6	2,619.5	0.42	0.33	
11,516.0	0.90	246.40	11,072.2	2,297.5	-1,258.9	2,619.7	0.06	0.00	
11,608.0	1.10	265.50	11,164.2	2,297.1	-1,260.4	2,620.1	0.42	0.22	
11,700.0	1.20	284.40	11,256.2	2,297.3	-1,262.2	2,621.1	0.42	0.11	
11,791.0	1.00	302.30	11,347.2	2,298.0	-1,263.8	2,622.5	0.43	-0.22	
11,883.0	1.30	234.40	11,439.1	2,297.8	-1,265.4	2,623.1	1.42	0.33	
11,974.0	1.10	265.70	11,530.1	2,297.1	-1,267.1	2,623.3	0.74	-0.22	
12,066.0	1.10	265.90	11,622.1	2,297.0	-1,268.8	2,624.1	0.00	0.00	
12,158.0	1.40	261.60	11,714.1	2,296.8	-1,270.8	2,624.9	0.34	0.33	
12,341.0	1.90	260.50	11,897.0	2,295.9	-1,276.0	2,626.7	0.27	0.27	
12,432.0	2.10	251.50	11,988.0	2,295.1	-1,279.1	2,627.5	0.41	0.22	
12,524.0	2.30	251.70	12,079.9	2,294.0	-1,282.5	2,628.2	0.22	0.22	
12,615.0	1.80	245.20	12,170.8	2,292.9	-1,285.5	2,628.6	0.61	-0.55	
12,745.0	1.70	237.50	12,300.8	2,291.0	-1,289.0	2,628.7	0.20	-0.08	Last Cathedral Survey @ 12,745' MD
12,790.0	1.70	237.50	12,345.7	2,290.3	-1,290.1	2,628.6	0.00	0.00	Projection to Bit @ 12,790'

Targets									
Target Name	Dip Angle (°)	Dip Dir. (°)	TVD (ft)	+N/-S (ft)	+E/-W (ft)	Northing (ft)	Easting (ft)	Latitude	Longitude
F25 496 SGU 8513F-24 - hit/miss target - Shape	0.00	0.00	12,215.0	2,281.6	-1,277.7	1,683,470.47	2,261,523.96	39° 40' 50.29 N	108° 7' 26.81 W
- survey misses target center by 13.9ft at 12659.1ft MD (12214.9 TVD, 2292.3 N, -1286.7 E)									
- Rectangle (sides W30.0 H50.0 D0.0)									
F25 496 SGU 8513F-24 - hit/miss target - Shape	0.00	0.00	8,355.0	2,291.6	-1,260.7	1,683,479.96	2,261,541.28	39° 40' 50.39 N	108° 7' 26.59 W
- survey misses target center by 14.3ft at 8798.9ft MD (8356.0 TVD, 2277.4 N, -1259.1 E)									
- Point									

Survey Annotations				
Measured Depth (ft)	Vertical Depth (ft)	+N/-S (ft)	+E/-W (ft)	Comment
12,745.0	12,300.8	2,291.0	-1,289.0	Last Cathedral Survey @ 12,745' MD
12,790.0	12,345.7	2,290.3	-1,290.1	Projection to Bit @ 12,790'

Checked By: _____ Approved By: _____ Date: _____