

PETROLEUM DEVELOPMENT CORP Weld County CO

Well Name: **Moss 14-16H**

Surface Location: Moss 14-16H Pad Sec.16-T7N-R65W
North American Datum 1983 , US State Plane 1983 , Colorado Northern Zone

Ground Elevation: 4862.0

| +N/-S | +E/-W | Northing | Easting | Latitude | Longitude | Slot |
|-------|-------|------------|------------|-----------|-------------|------|
| 0.0 | 0.0 | 1451141.63 | 3228659.21 | 40.568870 | -104.676930 | |

Original Well Elev WELL @ 4877.0ft (Original Well Elev)

WELLBORE TARGET DETAILS

| Name | TVD | +N/-S | +E/-W | Shape |
|-----------------------|--------|--------|--------|---------|
| HARDLINE SHL 460'FWL | 1.0 | -400.0 | 250.0 | Polygon |
| HARDLINES BHL 460'FEL | 1.0 | -488.6 | 4522.9 | Polygon |
| BHL 560'FSL, 1279'FEL | 7132.0 | -88.6 | 3703.9 | Point |



Azimuths to True North
Magnetic North: 8.80°

Magnetic Field
Strength: 53202.3snT
Dip Angle: 67.19°
Date: 9/15/2011
Model: IGRF2010

ANNOTATIONS

| TVD | MD | Annotation |
|--------|--------|--------------|
| 6393.2 | 6393.2 | KOP |
| 7157.1 | 7599.7 | End of Build |

Moss 14-16H Pad Sec.16-T7N-R65W
Moss 14-16H
Plan #1 (9-15-11)
9:10, September 15 2011

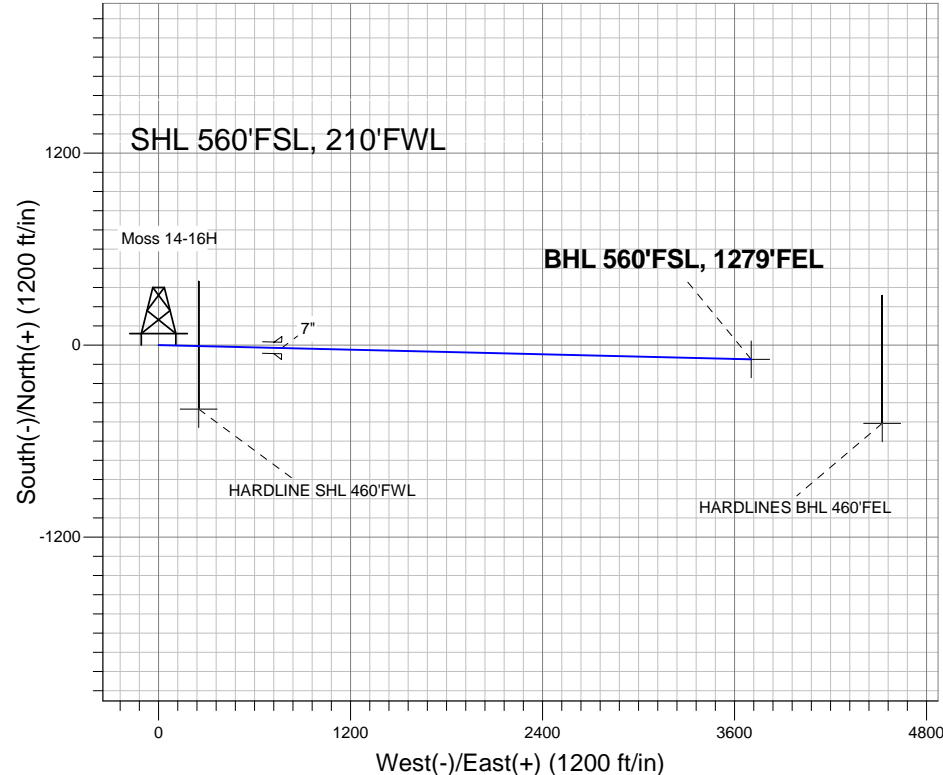

SECTION DETAILS

| Sec | MD | Inc | Azi | TVD | +N/-S | +E/-W | DLeg | TFace | VSec | Target |
|-----|---------|-------|-------|--------|-------|--------|------|-------|--------|-----------------------|
| 1 | 0.0 | 0.00 | 0.00 | 0.0 | 0.0 | 0.0 | 0.00 | 0.00 | 0.0 | |
| 2 | 6393.2 | 0.00 | 0.00 | 6393.2 | 0.0 | 0.0 | 0.00 | 0.00 | 0.0 | |
| 3 | 7599.7 | 90.49 | 91.37 | 7157.1 | -18.4 | 770.3 | 7.50 | 91.37 | 770.5 | |
| 4 | 10534.3 | 90.49 | 91.37 | 7132.0 | -88.6 | 3703.9 | 0.00 | 0.00 | 3705.0 | BHL 560'FSL, 1279'FEL |

