

State of Colorado
Oil and Gas Conservation Commission

1120 Lincoln Street, Suite 801, Denver, Colorado 80203 (303)894-2100 Fax:(303)894-2109



DOCUMENT
#2216417

FOR OGCC USE ONLY

RECEIVED
9/14/2011

EARTHEN PIT REPORT/PERMIT

This form is to be used for both reporting and permitting pits. Rule 903 describes when a Permit with prior approval, or a Report within 30 days, is required for pits. Submit required attachments and forms.

Complete the
Attachment Checklist

FORM SUBMITTED FOR:

☒ Pit Report

☐ Pit Permit

Oper OGCC

Detailed Site Plan	<input checked="" type="checkbox"/>	
Topo Map w/ Pit Location	<input checked="" type="checkbox"/>	
Water Analysis (Form 25)		
Source Wells (Form 26)		
Pit Design/Plan & Cross Sect		
Design Calculations		
Sensitive Area Determ.		
Mud Program		
Form 2A		

OGCC Operator Number: 100185

Name of Operator: Encana Oil & Gas (USA) Inc.

Address: 370 17th Street, Suite 1700

City: Denver State: CO Zip: 80202

Contact Name and Telephone:

Chris Hines

No: 970-285-2653

Fax:

API Number (of associated well): 335839 (Location ID)

OGCC Facility ID (of other associated facility):

Pit Location (QtrQtr, Sec, Twp, Rng, Meridian): NENW Sec. 19 T5S **95W** EF D19 595 pad

Latitude: 39.604672

Longitude: 108.103483

County: Garfield

Pit Use: ☒ Production ☐ Drilling (Attach mud program) ☐ Special Purpose (Describe Use): Multi-well Pit

Pit Type: ☒ Lined ☐ Unlined Surface Discharge Permit: ☐ Yes ☐ No

Offsite disposal of pit contents: ☐ Injection ☐ Commercial Pit/Facility Name: N/A EF D19 Pit/Facility No: N/A 595

Attach Form 26 to Identify Source Wells and Form 25 to provide Produced Water Analysis results.

Existing Site Conditions

Is the location in a "Sensitive Area?" ☒ Yes ☐ No Attach data used for determination.

Distance (in feet) to nearest surface water: -190 ground water: -40' water wells: -1190

LAND USE (or attach copy of Form 2A if previously submitted for associated well) Select one which best describes land use:

Crop Land: ☐ Irrigated ☐ Dry Land ☐ Improved Pasture ☐ Hay Meadow ☐ CRP

Non-Crop Land: ☒ Rangeland ☐ Timber ☐ Recreational ☐ Other (describe):

Subdivided: ☐ Industrial ☐ Commercial ☐ Residential

SOILS (or attach copy of Form 2A if previously submitted for associated well)

Soil map units from USNRCS survey: Sheet No: Soil Complex/Series No: 46

Soils Series Name: Nihill Channery Loam Horizon thickness (in inches): A: ; B: ; C:

Soils Series Name: Horizon thickness (in inches): A: ; B: ; C:

Attach detailed site plan and topo map with pit location.

Pit Design and Construction

Size of pit (feet): Length: 311' Width: 85' Depth: 16'

Calculated pit volume (bbis): 65876 Daily inflow rate (bbis/day):

Daily disposal rates (attach calculations): Evaporation: bbis/day Percolation: bbis/day

Type of liner material: HDPE Thickness: 30 mil

Attach description of proposed design and construction (include sketches and calculations).

Method of treatment of produced water prior to discharge into pit (separator, heater treater, other): Mechanical settling/separating

Is pit fenced? ☒ Yes ☐ No Is pit netted? ☒ Yes ☐ No

I hereby certify that the statements made in this form are, to the best of my knowledge, true, correct, and complete.

Print Name: Heather Mitchell

Signed:

Title: Regulatory Analyst

Date: 09/06/2011

OGCC Approved:

Title: For Greg Deramlean

Date: 10/05/2011



CONDITIONS OF APPROVAL, IF ANY:

Pit report submitted retroactively to establish pit facility ID# for closure purposes. Form 27 to be submitted shortly.

FACILITY NUMBER: 425839

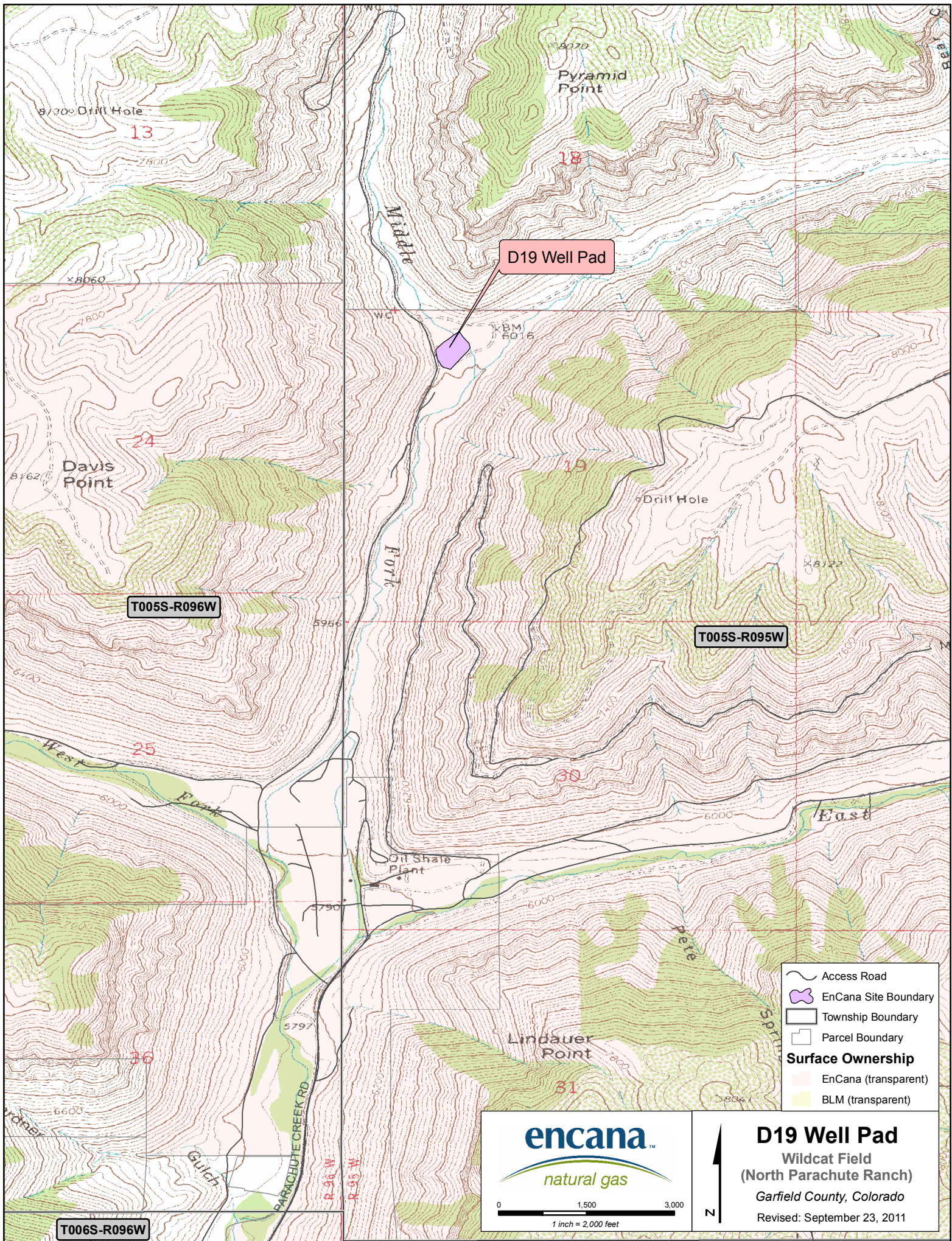
OGCA Supervisor



015003000

1 inch = 2,000 feet



D19 Well Pad
Wildcat Field
(North Parachute Ranch)
Garfield County, Colorado
Revised: September 23, 2011

ENCANA OIL & GAS (USA) INC.
NORTH PARACHUTE RANCH RECYCLING WATER PROGRAM
D19 WELL PAD
S19 T5S R95W

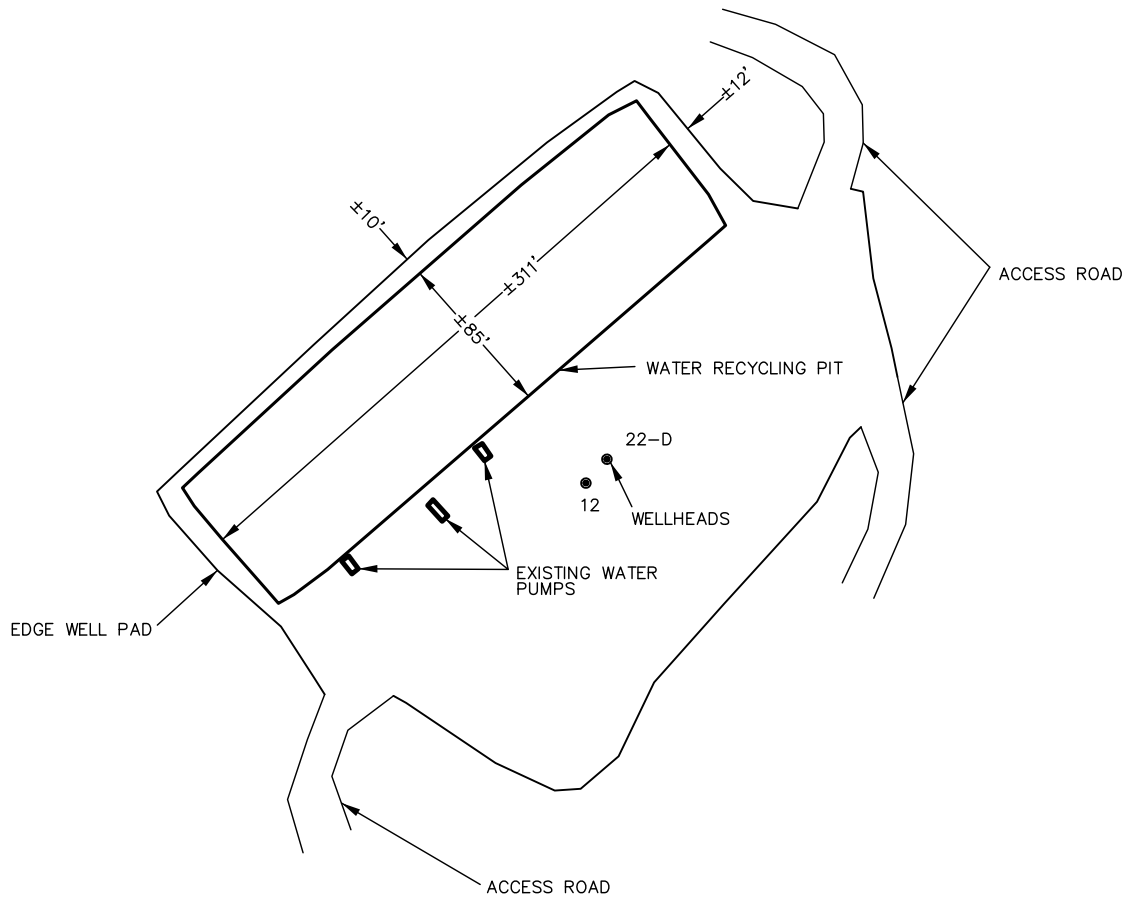

GENERAL NOTE:

PUMP LOCATIONS (IF INDICATED) ARE NOT PERMANENT OR FINAL LOCATIONS. ALL WATER HANDLING PUMPS USED IN RECYCLING OPERATIONS ARE MOBILE TRAILER-MOUNTED UNITS WHICH MAY BE LOCATED ANYWHERE ALONG THE PERIMETER OF THE PIT IN QUESTION, AT A DISTANCE NO GREATER THAN 20 FEET FROM THE PIT BANK, AS OPERATIONS NECESSITATE.

Rev.: 7-31-08
Date: 7-14-08
Drawn By: JEV

UINTAH ENGINEERING & LAND SURVEYING
832 North Crest Drive, Unit B Grand Junction, Colorado

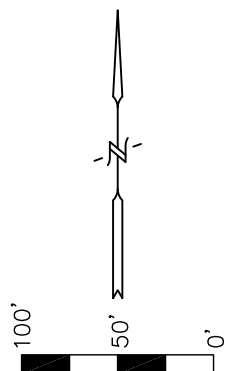

FORM 15 (Earthen Pit Report/Permit) Narrative Attachment

EF D19 595 Pad – 335839(Location ID)

Document Date – 09/06/2011

This pit report was prepared in support of closure activities on historic and unpermitted pit on the EF D19 595 pad. Encana has limited internal documentation on the original use and construction of the pit. The intent of this submittal is not to justify continued operation of the pit, but to provide a facility ID number to reference during all correspondence associated with pit closure site investigation and remediation activities.

Is the location in a “Sensitive Area?”

Yes, based on the distance to surface water and the depth to ground water, this location is found in a sensitive area.

Description of pit use:

The pit on this well pad provided storage for treated water used in support of hydraulic fracturing operations in Encana’s North Parachute Ranch. The pit was constructed on the cut-slope and were supplied filtered produced water via pipeline from the Middle Fork Treatment Facility, located in the SWSW of Section 30, T5S, R95W in Garfield County or transferred from a flowback tank after mechanical settling.

The North Parachute Properties use a centralized 3-phase gathering system for the collection of produced natural gas and associated fluids. With this centralization of the fluid separation and processing, these pits are likely to contain filter produced water from every well in the North Parachute Properties.