

Well Name: **Badding 2-26**

Surface Location: Badding 17-26 Pad Sec.26-T2N-R66W  
North American Datum 1983 US State Plane 1983 Colorado Northern Zone

Ground Elevation: 5067.0

+N/-S	+E/-W	Northing	Easting	Latitude	Longitude
0.0	0.0	1284729.73	3212750.09	40.112471	-104.739331

Original Well Elev WELL @ 5081.0ft (Original Well Elev)

Slot

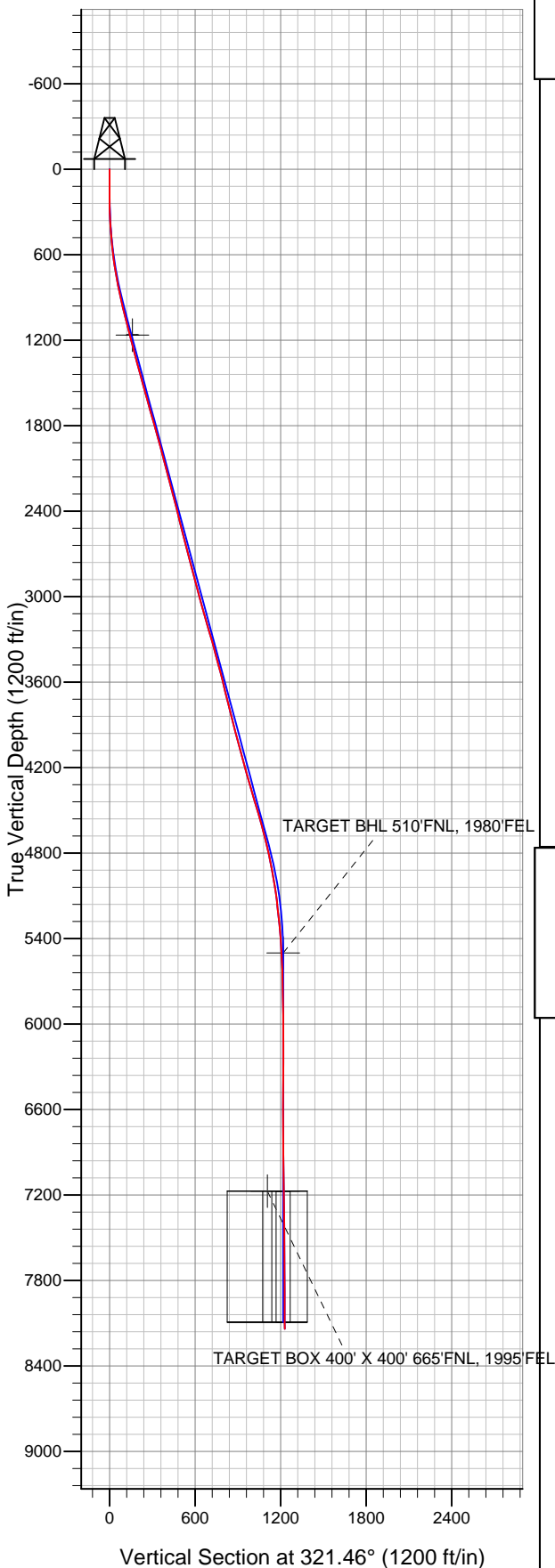

## Anadarko, Weld County CO

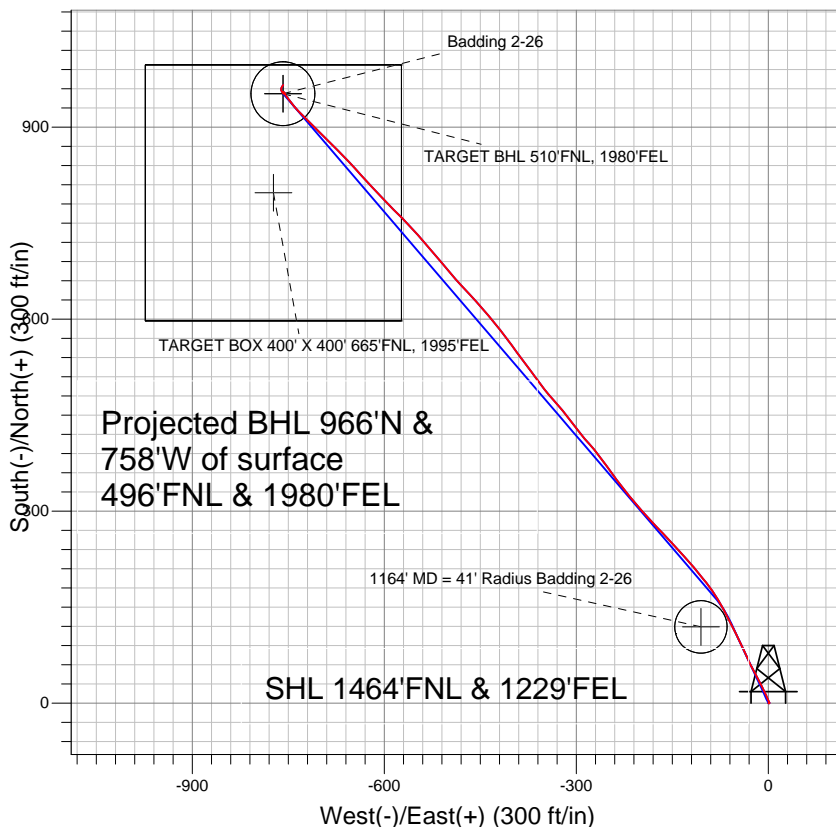

### LEGEND

- ◆ Badding 2-26, Wellbore #1, Plan #1 (5-9-11) V0
- Wellbore #1
- Survey #1

## Final Survey Plot

Projected Final Survey -  
8289'MD & 8139'TVD @ 1227'VS  
0.8 deg Inc 21.3 deg AZ

Project: SEC.26-T2N-R66W  
Site: Badding 17-26 Pad Sec.26-T2N-R66W  
Well: Badding 2-26  
Plan: Wellbore #1



## **Directional**

### **Anadarko, Weld County CO**

**SEC.26-T2N-R66W**

**Badding 17-26 Pad Sec.26-T2N-R66W**

**Badding 2-26**

**Wellbore #1**

**Survey: Survey #1**

### **Standard Survey Report**

**06 July, 2011**

<b>Company:</b>	Anadarko, Weld County CO	<b>Local Co-ordinate Reference:</b>	Well Badding 2-26
<b>Project:</b>	SEC.26-T2N-R66W	<b>TVD Reference:</b>	WELL @ 5081.0ft (Original Well Elev)
<b>Site:</b>	Badding 17-26 Pad Sec.26-T2N-R66W	<b>MD Reference:</b>	WELL @ 5081.0ft (Original Well Elev)
<b>Well:</b>	Badding 2-26	<b>North Reference:</b>	True
<b>Wellbore:</b>	Wellbore #1	<b>Survey Calculation Method:</b>	Minimum Curvature
<b>Design:</b>	Wellbore #1	<b>Database:</b>	Landmark

<b>Project</b>	SEC.26-T2N-R66W, Weld County, Colorado		
<b>Map System:</b>	US State Plane 1983	<b>System Datum:</b>	Mean Sea Level
<b>Geo Datum:</b>	North American Datum 1983		Using Well Reference Point
<b>Map Zone:</b>	Colorado Northern Zone		Using geodetic scale factor

Site	Badding 17-26 Pad Sec.26-T2N-R66W				
Site Position:		Northing:	1,284,730.44 ft	Latitude:	40.112471
From:	Lat/Long	Easting:	3,212,820.01 ft	Longitude:	-104.739081
Position Uncertainty:	0.0 ft	Slot Radius:	"	Grid Convergence:	0.49 °

Well	Badding 2-26					
Well Position	+N/-S	0.0 ft	Northing:	1,284,729.73 ft	Latitude:	40.112471
	+E/-W	0.0 ft	Easting:	3,212,750.09 ft	Longitude:	-104.739331
Position Uncertainty		0.0 ft	Wellhead Elevation:	ft	Ground Level:	5,067.0 ft

<b>Wellbore</b>	Wellbore #1				
<b>Magnetics</b>	<b>Model Name</b>	<b>Sample Date</b>	<b>Declination (°)</b>	<b>Dip Angle (°)</b>	<b>Field Strength (nT)</b>
	IGRF2010	5/9/2011	8.84	66.83	52,992

<b>Design</b>	Wellbore #1				
<b>Audit Notes:</b>					
<b>Version:</b>	1.0	<b>Phase:</b>	ACTUAL	<b>Tie On Depth:</b>	0.0
<b>Vertical Section:</b>	<b>Depth From (TVD) (ft)</b>	<b>+N/-S (ft)</b>	<b>+E/-W (ft)</b>	<b>Direction (°)</b>	
	0.0	0.0	0.0	321.46	

<b>Survey Program</b>	<b>Date</b>	7/6/2011			
<b>From (ft)</b>	<b>To (ft)</b>	<b>Survey (Wellbore)</b>	<b>Tool Name</b>	<b>Description</b>	
118.0	8,289.0	Survey #1 (Wellbore #1)	MWD	MWD - Standard	

<b>Survey</b>										
<b>Measured Depth (ft)</b>	<b>Inclination (°)</b>	<b>Azimuth (°)</b>	<b>Vertical Depth (ft)</b>	<b>+N/-S (ft)</b>	<b>+E/-W (ft)</b>	<b>Vertical Section (ft)</b>	<b>Dogleg Rate (°/100ft)</b>	<b>Build Rate (°/100ft)</b>	<b>Turn Rate (°/100ft)</b>	
0.0	0.00	0.00	0.0	0.0	0.0	0.0	0.00	0.00	0.00	
118.0	0.90	96.60	118.0	-0.1	0.9	-0.7	0.76	0.76	0.00	
210.0	0.70	1.20	210.0	0.4	1.7	-0.7	1.29	-0.22	-103.70	
303.0	1.90	330.90	303.0	2.3	0.9	1.2	1.44	1.29	-32.58	
413.0	4.00	337.60	412.8	7.4	-1.4	6.7	1.93	1.91	6.09	
501.0	5.30	333.90	500.5	13.9	-4.4	13.6	1.52	1.48	-4.20	
590.0	6.90	333.50	589.0	22.4	-8.6	22.9	1.80	1.80	-0.45	
679.0	8.70	333.20	677.2	33.2	-14.0	34.7	2.02	2.02	-0.34	
767.0	10.90	332.20	763.9	46.5	-20.9	49.4	2.51	2.50	-1.14	
856.0	11.70	333.80	851.2	62.0	-28.8	66.5	0.97	0.90	1.80	
945.0	13.40	335.40	938.0	79.5	-37.1	85.3	1.95	1.91	1.80	
1,033.0	14.60	334.80	1,023.4	98.8	-46.0	106.0	1.37	1.36	-0.68	
1,092.0	15.10	334.10	1,080.5	112.5	-52.6	120.7	0.90	0.85	-1.19	

<b>Company:</b>	Anadarko, Weld County CO	<b>Local Co-ordinate Reference:</b>	Well Badding 2-26
<b>Project:</b>	SEC.26-T2N-R66W	<b>TVD Reference:</b>	WELL @ 5081.0ft (Original Well Elev)
<b>Site:</b>	Badding 17-26 Pad Sec.26-T2N-R66W	<b>MD Reference:</b>	WELL @ 5081.0ft (Original Well Elev)
<b>Well:</b>	Badding 2-26	<b>North Reference:</b>	True
<b>Wellbore:</b>	Wellbore #1	<b>Survey Calculation Method:</b>	Minimum Curvature
<b>Design:</b>	Wellbore #1	<b>Database:</b>	Landmark

Survey

Measured Depth (ft)	Inclination (°)	Azimuth (°)	Vertical Depth (ft)	+N/-S (ft)	+E/-W (ft)	Vertical Section (ft)	Dogleg Rate (°/100ft)	Build Rate (°/100ft)	Turn Rate (°/100ft)
1,179.5	14.61	332.33	1,165.0	132.5	-62.7	142.7	0.76	-0.56	-2.02
<b>1164' MD = 41' Radius Badding 2-26</b>									
1,200.0	14.50	331.90	1,184.9	137.0	-65.1	147.7	0.76	-0.55	-2.10
1,288.0	14.40	330.30	1,270.1	156.3	-75.7	169.4	0.47	-0.11	-1.82
1,377.0	15.30	326.10	1,356.1	175.6	-87.7	192.0	1.58	1.01	-4.72
1,466.0	15.40	319.30	1,442.0	194.3	-102.0	215.5	2.02	0.11	-7.64
1,554.0	15.20	321.00	1,526.8	212.1	-116.9	238.8	0.56	-0.23	1.93
1,643.0	15.30	317.40	1,612.7	229.9	-132.2	262.1	1.07	0.11	-4.04
1,731.0	15.90	317.10	1,697.5	247.2	-148.2	285.7	0.69	0.68	-0.34
1,820.0	15.70	316.40	1,783.1	264.9	-164.8	309.9	0.31	-0.22	-0.79
1,909.0	16.10	317.20	1,868.7	282.7	-181.5	334.2	0.51	0.45	0.90
1,997.0	15.20	318.90	1,953.4	300.3	-197.4	357.9	1.15	-1.02	1.93
2,086.0	14.80	320.20	2,039.4	317.8	-212.3	380.9	0.59	-0.45	1.46
2,175.0	13.90	320.50	2,125.6	334.8	-226.4	403.0	1.01	-1.01	0.34
2,263.0	15.40	325.50	2,210.8	352.6	-239.7	425.2	2.23	1.70	5.68
2,352.0	14.10	323.30	2,296.8	371.0	-252.9	447.8	1.59	-1.46	-2.47
2,441.0	14.30	322.40	2,383.1	388.4	-266.1	469.6	0.33	0.22	-1.01
2,529.0	13.80	318.00	2,468.5	404.8	-279.8	491.0	1.34	-0.57	-5.00
2,618.0	14.30	321.60	2,554.8	421.3	-293.7	512.6	1.13	0.56	4.04
2,707.0	15.20	322.60	2,640.9	439.2	-307.6	535.2	1.05	1.01	1.12
2,795.0	14.90	321.10	2,725.9	457.2	-321.7	558.1	0.56	-0.34	-1.70
2,884.0	14.40	318.00	2,812.0	474.3	-336.3	580.6	1.04	-0.56	-3.48
2,972.0	13.90	321.70	2,897.3	490.8	-350.2	602.0	1.17	-0.57	4.20
3,061.0	14.80	324.20	2,983.5	508.4	-363.5	624.1	1.23	1.01	2.81
3,150.0	16.50	322.10	3,069.2	527.6	-377.9	648.1	2.01	1.91	-2.36
3,238.0	16.40	324.20	3,153.6	547.5	-392.8	673.0	0.69	-0.11	2.39
3,327.0	16.10	323.60	3,239.1	567.6	-407.5	697.9	0.39	-0.34	-0.67
3,416.0	15.60	322.30	3,324.7	587.0	-422.1	722.2	0.69	-0.56	-1.46
3,504.0	14.90	317.90	3,409.6	604.8	-437.0	745.3	1.54	-0.80	-5.00
3,593.0	14.90	320.40	3,495.6	622.1	-451.9	768.2	0.72	0.00	2.81
3,682.0	13.80	316.30	3,581.8	638.6	-466.5	790.2	1.68	-1.24	-4.61
3,770.0	14.40	316.10	3,667.2	654.1	-481.4	811.5	0.68	0.68	-0.23
3,859.0	13.80	321.10	3,753.5	670.3	-495.7	833.1	1.53	-0.67	5.62
3,947.0	14.00	319.80	3,838.9	686.6	-509.2	854.3	0.42	0.23	-1.48
4,036.0	14.20	320.30	3,925.2	703.2	-523.1	876.0	0.26	0.22	0.56
4,125.0	14.60	318.00	4,011.4	719.9	-537.6	898.1	0.78	0.45	-2.58
4,213.0	15.40	319.00	4,096.4	737.0	-552.7	920.8	0.96	0.91	1.14
4,302.0	15.50	314.90	4,182.2	754.3	-568.8	944.4	1.23	0.11	-4.61
4,391.0	15.60	315.50	4,268.0	771.2	-585.7	968.2	0.21	0.11	0.67
4,479.0	17.00	316.20	4,352.4	789.0	-602.9	992.7	1.61	1.59	0.80
4,568.0	17.00	317.00	4,437.5	807.9	-620.7	1,018.7	0.26	0.00	0.90
4,657.0	16.20	318.00	4,522.8	826.6	-637.9	1,044.0	0.95	-0.90	1.12
4,745.0	15.20	316.50	4,607.5	844.1	-654.1	1,067.8	1.23	-1.14	-1.70
4,834.0	14.10	316.10	4,693.6	860.4	-669.6	1,090.2	1.24	-1.24	-0.45
4,923.0	12.50	314.40	4,780.3	874.9	-684.0	1,110.5	1.85	-1.80	-1.91
5,011.0	11.40	315.00	4,866.3	887.8	-697.0	1,128.6	1.26	-1.25	0.68
5,100.0	10.20	314.00	4,953.8	899.4	-708.9	1,145.2	1.36	-1.35	-1.12
5,188.0	9.00	315.30	5,040.5	909.8	-719.3	1,159.8	1.39	-1.36	1.48
5,277.0	7.20	315.20	5,128.6	918.7	-728.1	1,172.2	2.02	-2.02	-0.11
5,366.0	5.80	317.40	5,217.1	925.9	-735.1	1,182.3	1.60	-1.57	2.47
5,454.0	5.50	318.80	5,304.6	932.4	-740.9	1,190.9	0.38	-0.34	1.59
5,543.0	4.50	322.20	5,393.3	938.3	-745.8	1,198.7	1.17	-1.12	3.82
5,632.0	3.60	324.20	5,482.1	943.4	-749.6	1,204.9	1.02	-1.01	2.25
5,650.6	3.45	324.61	5,500.6	944.3	-750.3	1,206.1	0.81	-0.80	2.20

<b>Company:</b>	Anadarko, Weld County CO	<b>Local Co-ordinate Reference:</b>	Well Badding 2-26
<b>Project:</b>	SEC.26-T2N-R66W	<b>TVD Reference:</b>	WELL @ 5081.0ft (Original Well Elev)
<b>Site:</b>	Badding 17-26 Pad Sec.26-T2N-R66W	<b>MD Reference:</b>	WELL @ 5081.0ft (Original Well Elev)
<b>Well:</b>	Badding 2-26	<b>North Reference:</b>	True
<b>Wellbore:</b>	Wellbore #1	<b>Survey Calculation Method:</b>	Minimum Curvature
<b>Design:</b>	Wellbore #1	<b>Database:</b>	Landmark

Survey

Measured Depth (ft)	Inclination (°)	Azimuth (°)	Vertical Depth (ft)	+N/-S (ft)	+E/-W (ft)	Vertical Section (ft)	Dogleg Rate (°/100ft)	Build Rate (°/100ft)	Turn Rate (°/100ft)
<b>TARGET BHL 510'FNL, 1980'FEL</b>									
5,720.0	2.90	326.50	5,569.9	947.5	-752.5	1,209.9	0.81	-0.79	2.73
5,809.0	1.60	318.90	5,658.9	950.3	-754.5	1,213.4	1.50	-1.46	-8.54
5,898.0	0.90	348.00	5,747.8	951.9	-755.5	1,215.3	1.04	-0.79	32.70
6,031.0	0.40	320.30	5,880.8	953.3	-756.0	1,216.7	0.43	-0.38	-20.83
6,163.0	0.50	286.00	6,012.8	953.8	-756.9	1,217.6	0.21	0.08	-25.98
6,296.0	0.50	333.50	6,145.8	954.5	-757.7	1,218.6	0.30	0.00	35.71
6,429.0	0.40	87.10	6,278.8	955.0	-757.5	1,218.9	0.57	-0.08	85.41
6,562.0	1.00	147.20	6,411.8	954.1	-756.4	1,217.5	0.66	0.45	45.19
6,695.0	0.50	211.30	6,544.8	952.6	-756.0	1,216.2	0.68	-0.38	48.20
6,828.0	0.50	274.60	6,677.8	952.1	-756.9	1,216.3	0.39	0.00	47.59
6,961.0	0.40	317.50	6,810.8	952.5	-757.8	1,217.2	0.26	-0.08	32.26
7,094.0	0.90	318.60	6,943.8	953.7	-758.8	1,218.7	0.38	0.38	0.83
7,227.0	0.70	325.60	7,076.8	955.1	-760.0	1,220.6	0.17	-0.15	5.26
7,320.6	0.70	334.34	7,170.4	956.1	-760.5	1,221.7	0.11	0.00	9.33
<b>TARGET BOX 400' X 400' 665'FNL, 1995'FEL</b>									
7,322.2	0.70	334.48	7,171.9	956.1	-760.5	1,221.7	0.11	0.01	9.34
<b>TARGET CIRCLE 510'FNL, 1980'FEL</b>									
7,360.0	0.70	338.00	7,209.8	956.5	-760.7	1,222.2	0.11	0.01	9.30
7,493.0	0.70	346.60	7,342.8	958.1	-761.2	1,223.7	0.08	0.00	6.47
7,626.0	0.60	2.97	7,475.8	959.6	-761.4	1,224.9	0.16	-0.08	12.31
7,759.0	0.70	17.50	7,608.7	961.0	-761.1	1,225.9	0.14	0.08	10.92
7,892.0	0.50	34.00	7,741.7	962.3	-760.5	1,226.5	0.20	-0.15	12.41
8,025.0	0.60	38.60	7,874.7	963.3	-759.8	1,226.9	0.08	0.08	3.46
8,158.0	0.70	28.30	8,007.7	964.6	-759.0	1,227.3	0.12	0.08	-7.74
8,243.0	0.80	21.30	8,092.7	965.6	-758.5	1,227.8	0.16	0.12	-8.24
8,289.0	0.80	21.30	8,138.7	966.2	-758.3	1,228.2	0.00	0.00	0.00

Checked By: \_\_\_\_\_ Approved By: \_\_\_\_\_ Date: \_\_\_\_\_