

LEGEND:

 PROPOSED LOCATION

QUICKSILVER RESOURCES, INC.

K-DIAMOND RANCH #44-22
SECTION 22, T6N, R93W, 6th P.M.
610' FSL 612' FEL



Uintah Engineering & Land Surveying
 85 South 200 East Vernal, Utah 84078
 (435) 789-1017 * FAX (435) 789-1813



ACCESS ROAD
 MAP

06 10 11
 MONTH DAY YEAR

SCALE: 1:100,000 DRAWN BY: S.F. REVISED: 00-00-00

A
 TOPO

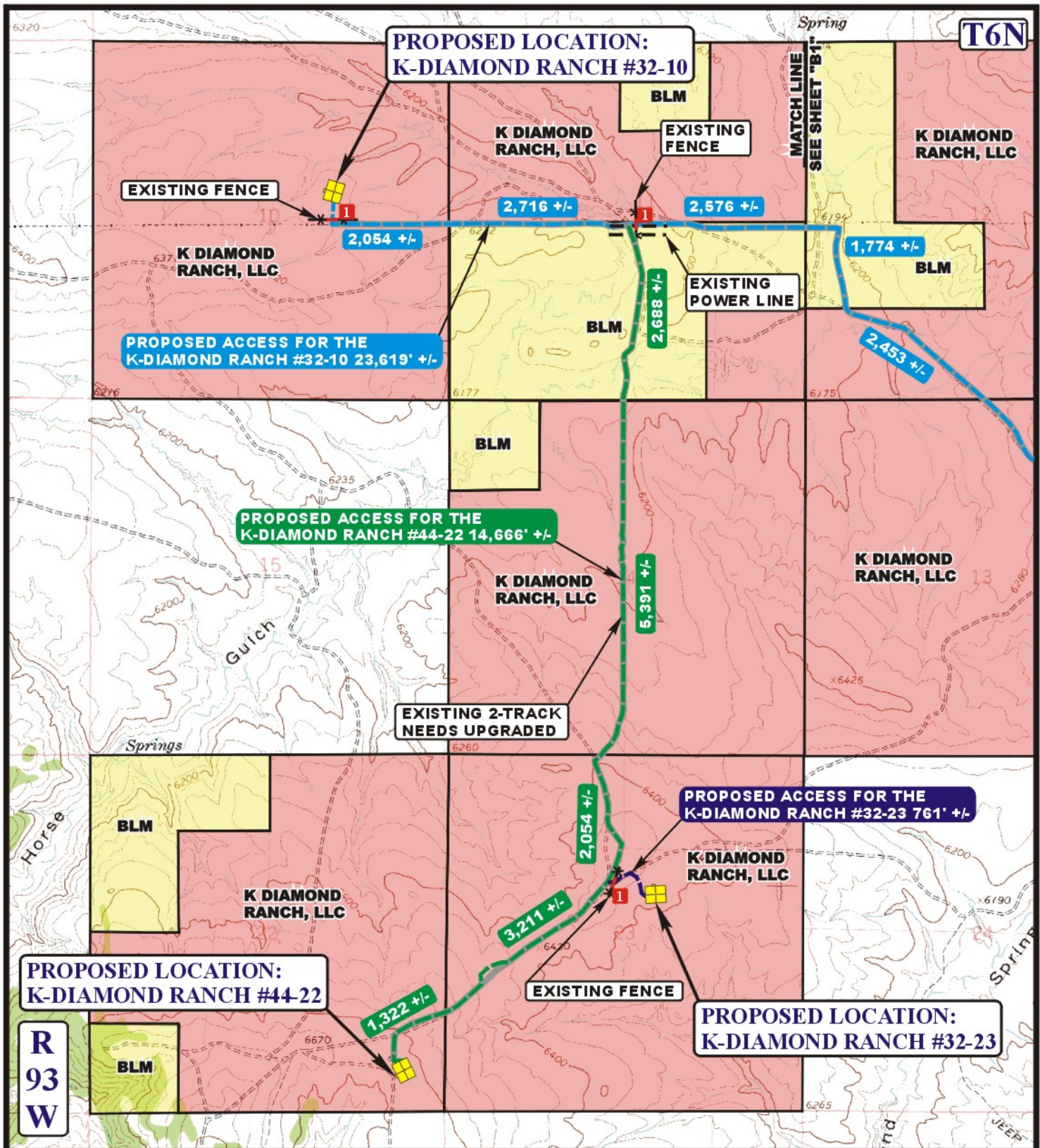

LEGEND:

- EXISTING ROAD
- PROPOSED ACCESS ROAD
- EXISTING FENCE
- INSTALL CATTLE GUARD



Utah Engineering & Land Surveying
85 South 200 East Vernal, Utah 84078
(435) 789-1017 * FAX (435) 789-1813



QUICKSILVER RESOURCES, INC.

**K-DIAMOND RANCH #32-23, #44-22 & #32-10
SECTIONS 10, 22 & 23, T6N, R93W, 6th P.M.
MOFFAT COUNTY, COLORADO**

**ACCESS ROAD
MAP**

07 18 11
MONTH DAY YEAR

**B2
TOPO**

SCALE: 1" = 2000' DRAWN BY: S.F. REVISED: 00-00-00