

**EOG RESOURCES, INC.**  
**GARDEN CREEK #32-07M**  
**LOCATED IN WELD COUNTY, COLORADO**  
**SECTION 7, T11N, R62W, 6th P.M.**

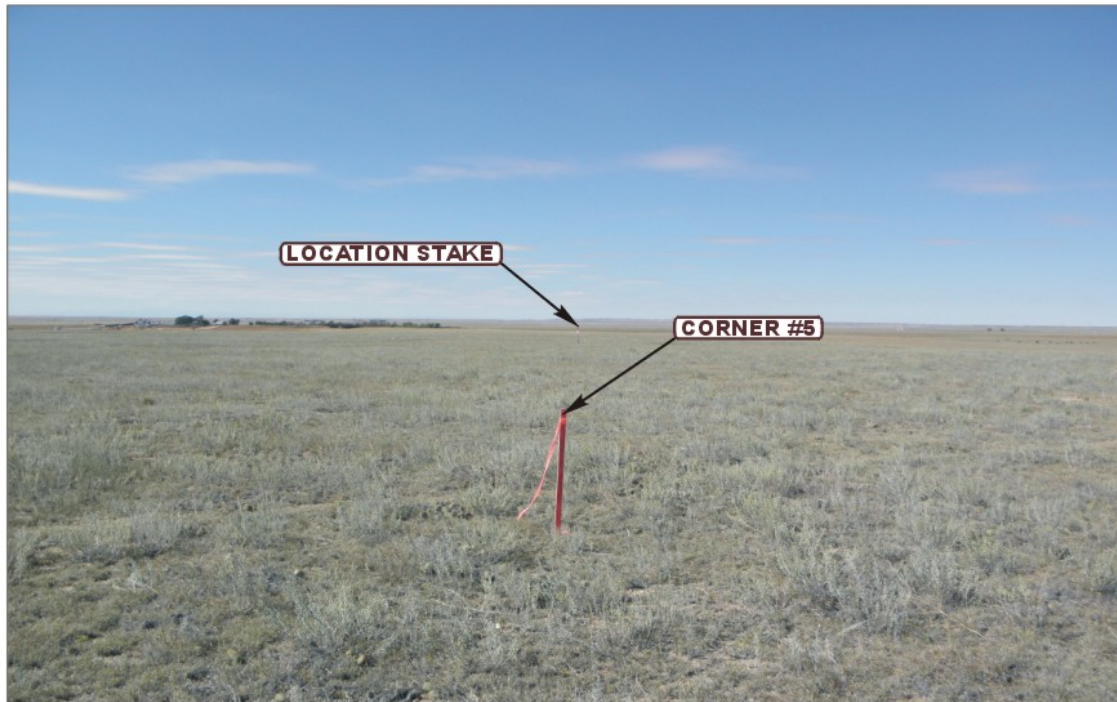

PHOTO: VIEW FROM CORNER #5 TO LOCATION STAKE

CAMERA ANGLE: WESTERLY



PHOTO: VIEW FROM BEGINNING OF PROPOSED ACCESS

CAMERA ANGLE: NORTHERLY



**UELS** Uintah Engineering & Land Surveying  
85 South 200 East Vernal, Utah 84078  
435-789-1017 FAX (435) 789-1813

**LOCATION PHOTOS**

**09** **30** **11**  
MONTH DAY YEAR

TAKEN BY: D.N.

DRAWN BY: A.W.

REVISED: 00-00-00

PHOTO  
**P 1**



**EOG RESOURCES, INC.**  
**GARDEN CREEK #32-07M**  
**LOCATED IN WELD COUNTY, COLORADO**  
**SECTION 7, T11N, R62W, 6th P.M.**



PHOTO: VIEW OF LOCATION STAKE

CAMERA ANGLE: NORTHERLY

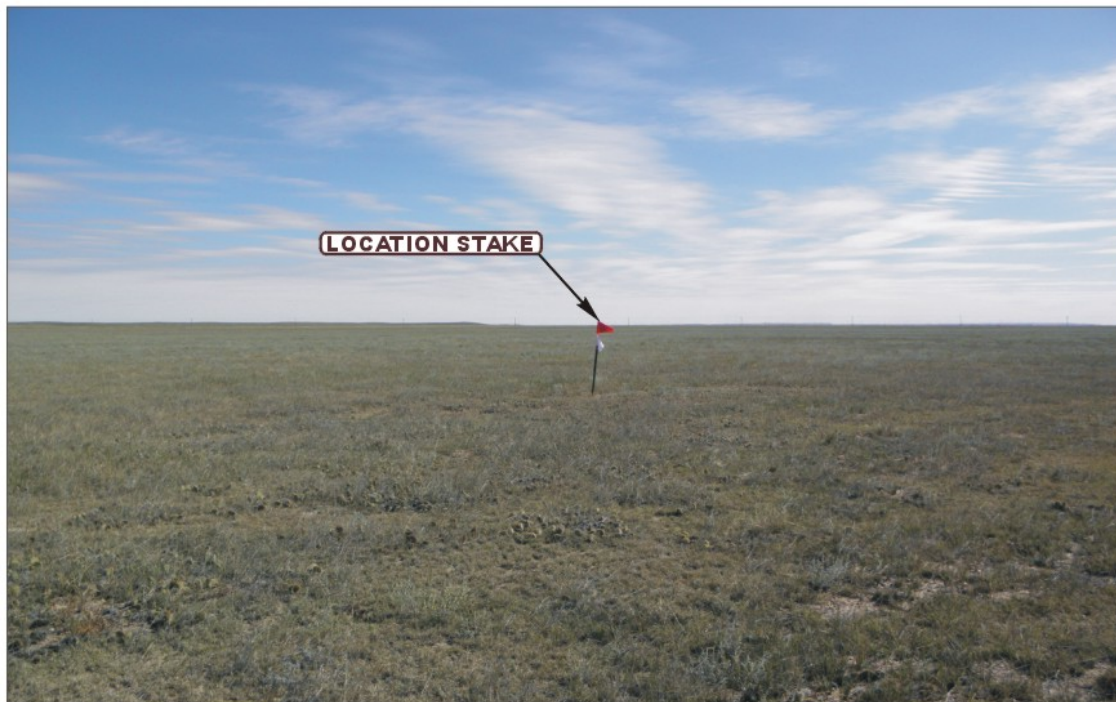

PHOTO: VIEW OF LOCATION STAKE

CAMERA ANGLE: EASTERLY



**UELS** Uintah Engineering & Land Surveying  
85 South 200 East Vernal, Utah 84078  
435-789-1017 FAX (435) 789-1813

**LOCATION PHOTOS**

**09** **30** **11**  
MONTH DAY YEAR

TAKEN BY: D.N.

DRAWN BY: A.W.

REVISED: 00-00-00

PHOTO  
**P 2**

**EOG RESOURCES, INC.**  
**GARDEN CREEK #32-07M**  
**LOCATED IN WELD COUNTY, COLORADO**  
**SECTION 7, T11N, R62W, 6th P.M.**



PHOTO: VIEW OF LOCATION STAKE

CAMERA ANGLE: SOUTHERLY



PHOTO: VIEW OF LOCATION STAKE

CAMERA ANGLE: WESTERLY



**UELS**

Uintah Engineering & Land Surveying  
85 South 200 East Vernal, Utah 84078  
435-789-1017 FAX (435) 789-1813

- Since 1964 -

**LOCATION PHOTOS**

**09** **30** **11**  
MONTH DAY YEAR

**PHOTO**

**P 3**

TAKEN BY: D.N.

DRAWN BY: A.W.

REVISED: 00-00-00