

FORM  
15  
Rev 6/99

State of Colorado  
Oil and Gas Conservation Commission

1120 Lincoln Street, Suite 801, Denver, Colorado 80203 (303)894-2100 Fax: (303)894-2109



DOCUMENT  
#2216418

FOR OGCC USE ONLY

RECEIVED  
9/14/2011

EARTHEN PIT REPORT/PERMIT

This form is to be used for both reporting and permitting pits. Rule 903 describes when a Permit with prior approval, or a Report within 30 days, is required for pits. Submit required attachments and forms.

FORM SUBMITTED FOR:

☒ Pit Report

☐ Pit Permit

OGCC Operator Number: 100185

Name of Operator: Encana Oil & Gas (USA) Inc.

Address: 370 17th Street, Suite 1700

City: Denver State: CO Zip: 80202

Contact Name and Telephone:

Chris Hines

No: 970-285-2653

Fax:

Complete the  
Attachment Checklist

Oper OGCC

Detailed Site Plan	<input checked="" type="checkbox"/>	<input type="checkbox"/>
Topo Map w/ Pit Location	<input checked="" type="checkbox"/>	<input type="checkbox"/>
Water Analysis (Form 25)	<input type="checkbox"/>	<input type="checkbox"/>
Source Wells (Form 26)	<input type="checkbox"/>	<input type="checkbox"/>
Pit Design/Plan & Cross Sect	<input type="checkbox"/>	<input type="checkbox"/>
Design Calculations	<input type="checkbox"/>	<input type="checkbox"/>
Sensitive Area Determ.	<input type="checkbox"/>	<input type="checkbox"/>
Mud Program	<input type="checkbox"/>	<input type="checkbox"/>
Form 2A	<input type="checkbox"/>	<input type="checkbox"/>

API Number (of associated well): 335039 (Location ID)

OGCC Facility ID (of other associated facility):

Pit Location (QtrQtr, Sec, Twp, Rng, Meridian): NESE Sec. 20 T7S R95W (PI-20)

Latitude: 39.421566

Longitude: 108.011748

County: Garfield

Pit Use: ☒ Production ☐ Drilling (Attach mud program) ☐ Special Purpose (Describe Use):

Pit Type: ☒ Lined ☐ Unlined Surface Discharge Permit: ☐ Yes ☐ No

Offsite disposal of pit contents: ☐ Injection ☒ Commercial Pit/Facility Name: PI Pit/Facility No: 20

Attach Form 26 to identify Source Wells and Form 25 to provide Produced Water Analysis results.

Existing Site Conditions

Is the location in a "Sensitive Area?" ☐ Yes ☒ No Attach data used for determination.

Distance (in feet) to nearest surface water: -400 ground water: -250 water wells: -2500

LAND USE (or attach copy of Form 2A if previously submitted for associated well) Select one which best describes land use:

Crop Land: ☐ Irrigated ☐ Dry Land ☐ Improved Pasture ☐ Hay Meadow ☐ CRP

Non-Crop Land: ☒ Rangeland ☐ Timber ☐ Recreational ☐ Other (describe):

Subdivided: ☐ Industrial ☐ Commercial ☐ Residential

SOILS (or attach copy of Form 2A if previously submitted for associated well)

Soil map units from USNRCS survey: Sheet No: Soil Complex/Series No: 33

Soils Series Name: Ildefonso Stony Loam Horizon thickness (in inches): A: ; B: ; C:

Soils Series Name: Horizon thickness (in inches): A: ; B: ; C:

Attach detailed site plan and topo map with pit location.

Pit Design and Construction

Size of pit (feet): Length: -170 Width: -75 Depth: -12

Calculated pit volume (bbls): 22695 Daily inflow rate (bbls/day):

Daily disposal rates (attach calculations): Evaporation: bbls/day Percolation: bbls/day

Type of liner material: HDPE Thickness: 30 mil

Attach description of proposed design and construction (include sketches and calculations).

Method of treatment of produced water prior to discharge into pit (separator, heater treater, other): Mechanical Settling/Separating

Is pit fenced? ☒ Yes ☐ No Is pit netted? ☒ Yes ☐ No

I hereby certify that the statements made in this form are, to the best of my knowledge, true, correct, and complete.

Print Name: Heather Mitchell

Signed: Heather Mitchell

Title: Regulatory Analyst

Date:

OGCC Approved: [Signature] Title: FOR Greg Deranlean Date: 10/05/2011

CONDITIONS OF APPROVAL, IF ANY:

Pit permit submitted retroactively to establish pit facility ID# for closure purposes.

Form 27 to be submitted shortly.

FACILITY NUMBER: 425760

OGCC Supervisor



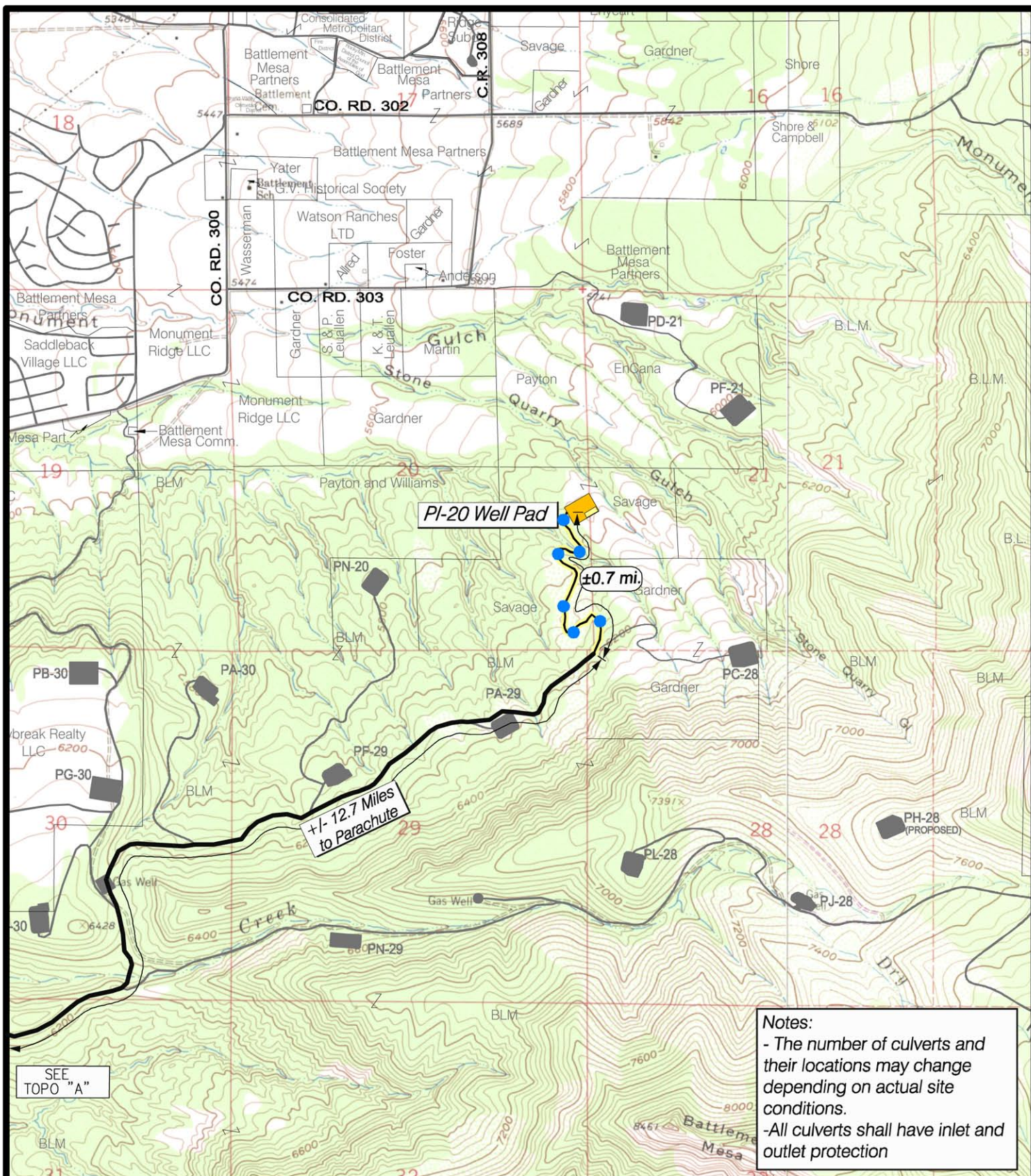

<p>(SCALE IN FEET)</p>	<h1>EnCana Oil &amp; Gas (USA) Inc.</h1>		<p><b>WASATCH SURVEYING</b> 906 Main Street Evanston, Wyoming 82930 Phone No. (307) 789-4545</p>		<p><b>—LEGEND—</b></p> <ul style="list-style-type: none"> <li>Existing Road</li> <li>Proposed Road</li> <li>Proposed Well Pad</li> <li>Proposed Culvert</li> </ul>	
	<h2>Well Pad PI-20-7-95</h2>		<p>DATE: December 11, 2007</p>		<p><b>Topo "B"</b></p>	
	<h3>Section 20, T7S, R95W, 6th P.M.</h3>		<p>SCALE: 1" = 2000'</p>		<p>SHEET 9</p>	
	<h3>Garfield County, Colorado</h3>		<p>PROJECT NO.: 07-04-117</p>		<p>OF 10</p>	



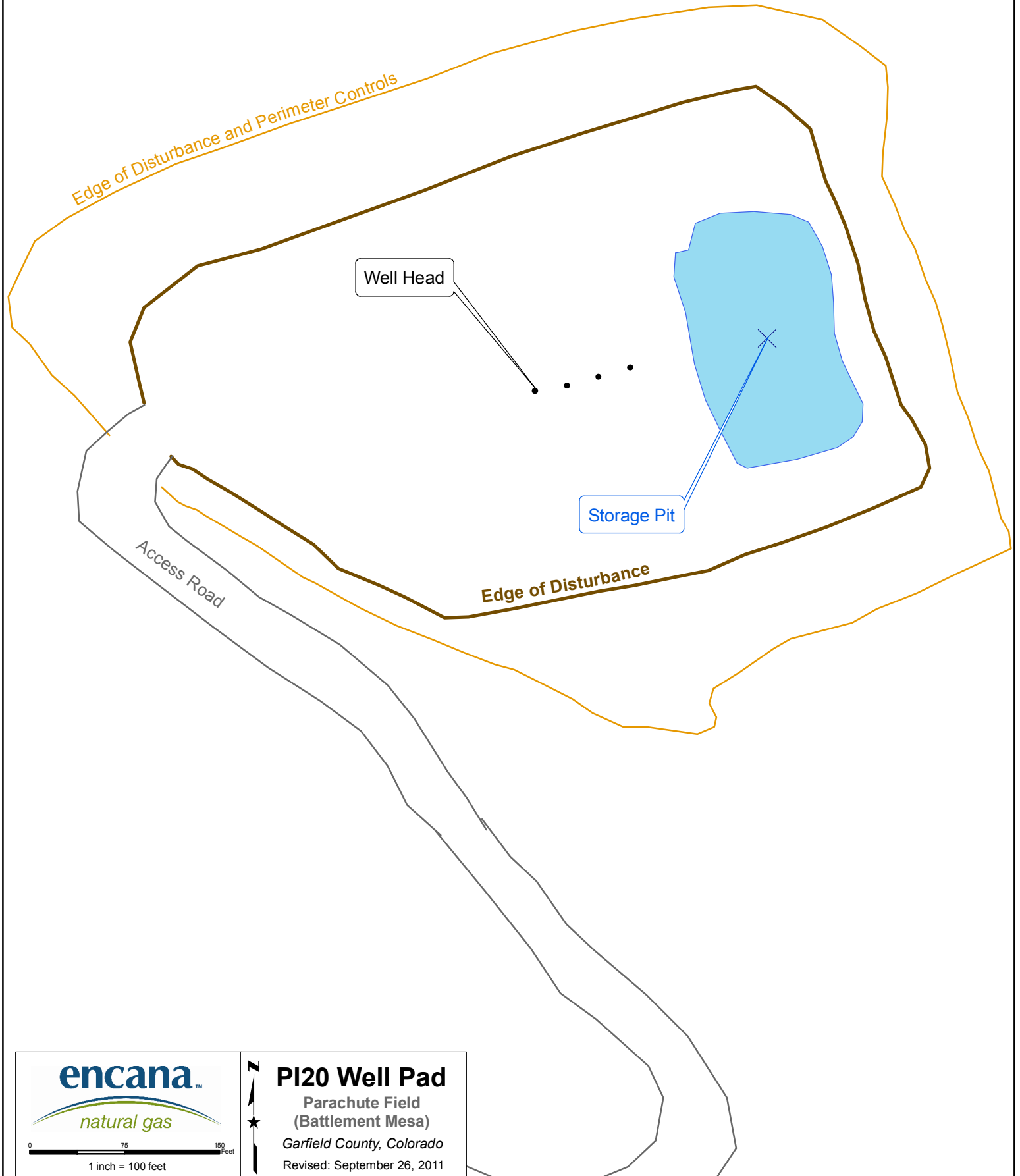

**encana**™



0 75 150 Feet

1 inch = 100 feet



## PI20 Well Pad

Parachute Field  
(Battlement Mesa)

Garfield County, Colorado

Revised: September 26, 2011

## FORM 15 (Earthen Pit Report/Permit) Narrative Attachment

---

### **SP PI-20 Pad – 335039(Location ID)**

Document Date – 09/23/2011

---

This pit report was prepared in support of closure activities on historic and unpermitted pit on the SP PI-20 pad. Encana has limited internal documentation on the original use and construction of the pit. The intent of this submittal is not to justify continued operation of the pit, but to provide a facility ID number to reference during all correspondence associated with pit closure site investigation and remediation activities.

#### **Is the location in a “Sensitive Area?”**

No, based on the distance to surface water and the depth to ground water, this location is not found in a sensitive area.

#### **Description of pit use:**

The pit on this well pad provided storage for treated water used in support of hydraulic fracturing operations. The pits were constructed on the cut-slope and were supplied filtered produced water via pipeline from the High Mesa Treatment Facility, located in the SENW of Section 36, T7S, R96W in Garfield County or transferred from flowback tanks after mechanical settling.