

VISIBLE IMPROVEMENTS
THIS MAP DOES NOT REPRESENT A BOUNDARY SURVEY

SECTION 18
TOWNSHIP 4 NORTH
RANGE 63 WEST

DATE: 06/08/2011

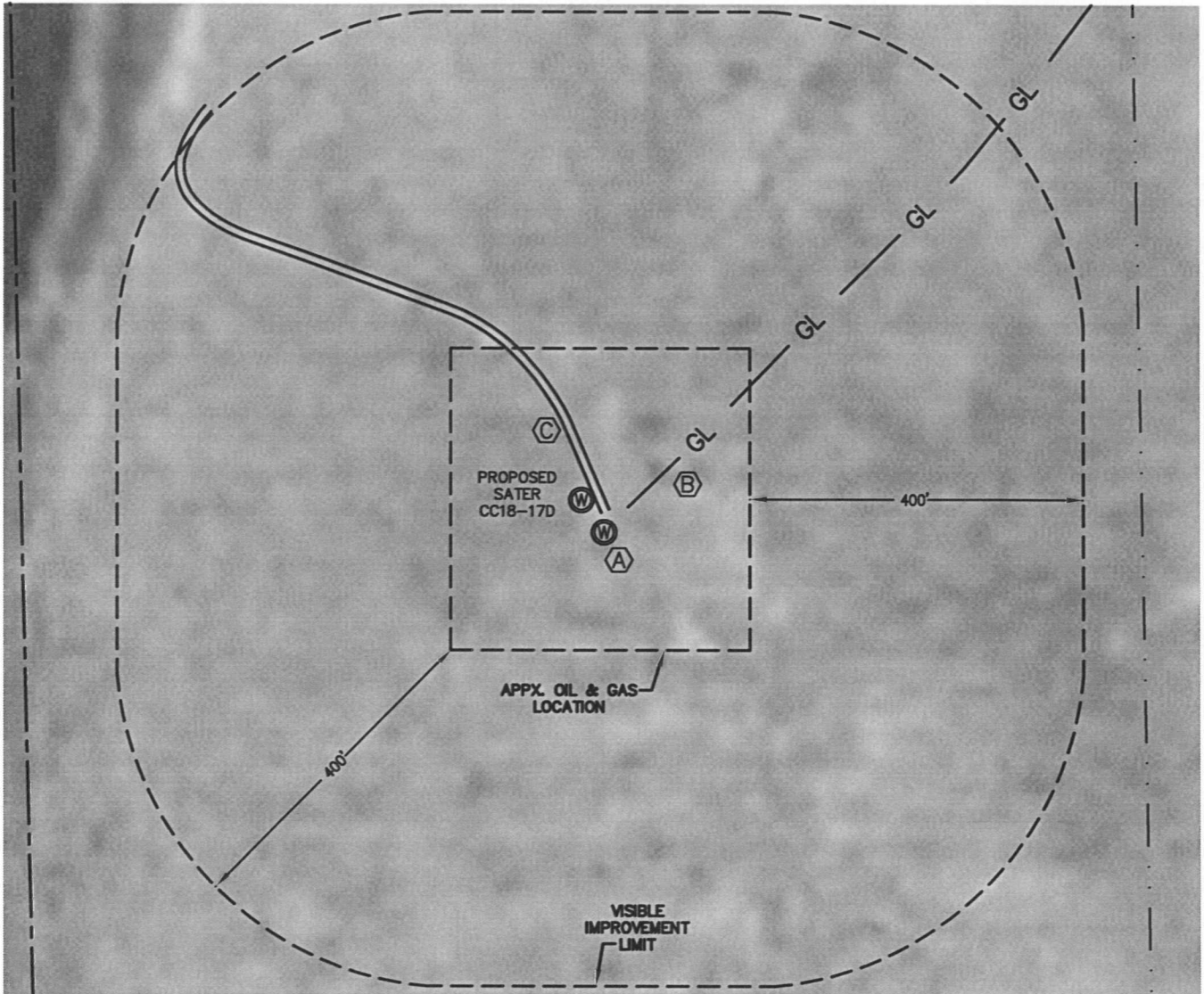

IMPROVEMENTS:

- Ⓐ EXISTING WATKINS CC18-7 - 47' SOUTHEAST
- Ⓑ BURIED GAS LINE - 57' EAST
- Ⓒ DIRT ROAD - 21' EAST

THE NEAREST OVERHEAD POWER LINE IS 1980'+/- NORTH.

NEW WELL DATA

ELEV = 4637', PDOP: 2.0
 SW¼NE¼ SEC 18
 1983' FNL, 2020' FEL
 LAT: N 40.31407
 LONG: W 104.47828
 NEAREST PROP LINE: 673' WEST
 NEAREST RAILROAD: MORE THAN ONE MILE AWAY
 NEAREST BUILDING: 2200'+/- NORTHWEST
 COUNTY ROAD NO. 46: 3700'+/- NORTHWEST

NOTE: The orientation of the oil & gas location as shown was determined by Noble Energy.

NOTICE: According to Colorado law you MUST commence any legal action based upon any defect in this W.L.C. within three years after you first discover such defect. In no event may any action based upon any defect in this W.L.C. be commenced more than ten years from this sold date of the certification shown hereon.

