

Anschutz East Platte 13-17H

Section 17 T4N R61W

Weld County, CO

Surface Location

NAD 1927 (NADCON CONUS) Colorado North 501
Ground Elevation: 4477.00 RIG @ 4499.00ft (TBD)
Northing Easting Latitude Longitude
361322.21 2353307.38 40° 19' 5.948 N 104° 13' 58.642 W

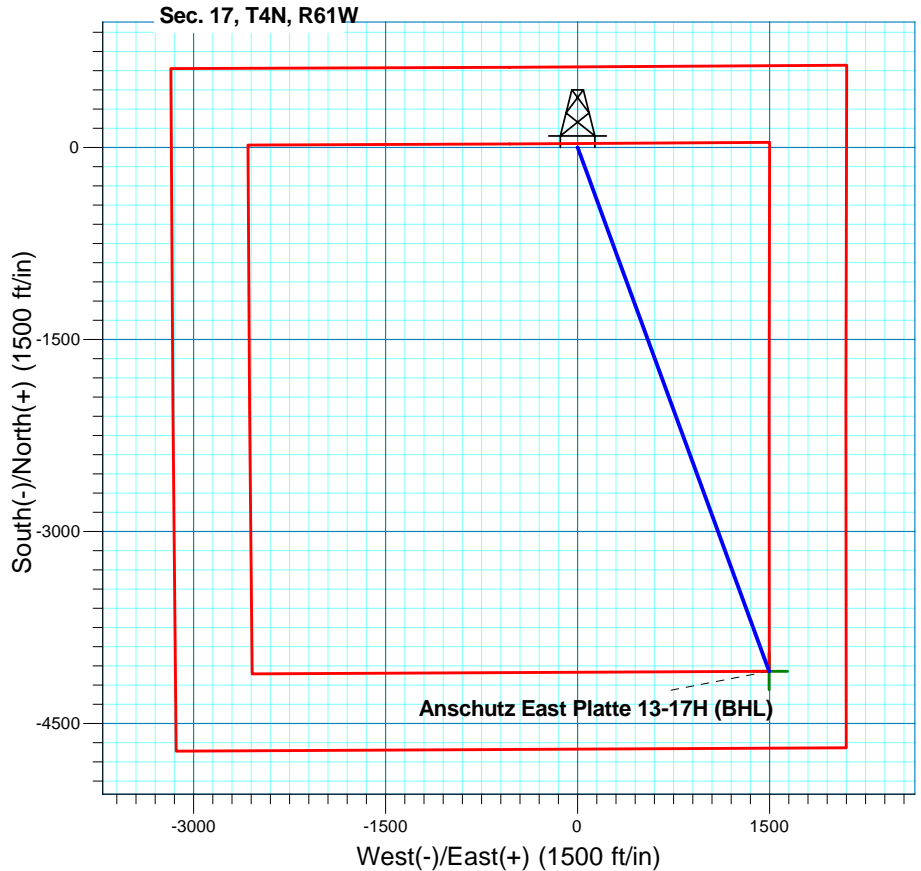
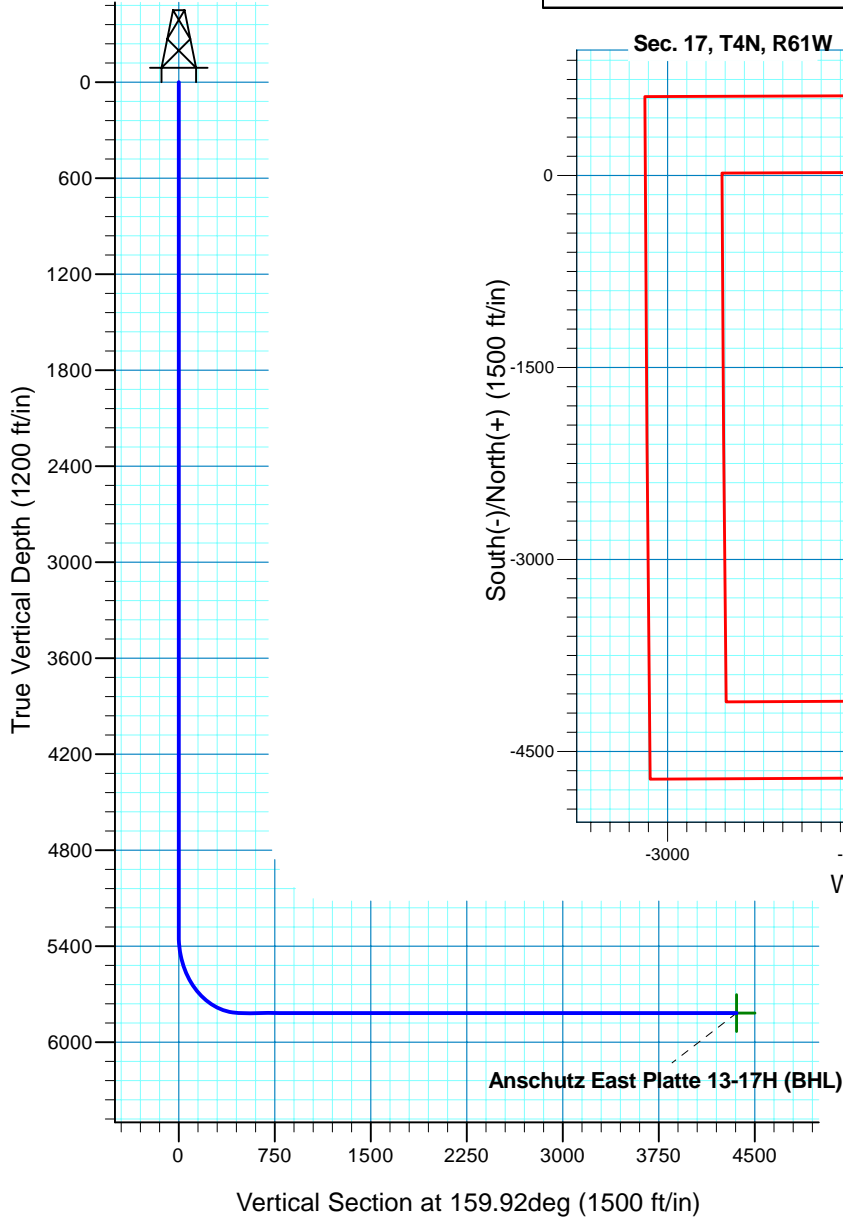

T M
Azimuths to True North
Magnetic North: 8.49°
Magnetic Field
Strength: 53141.2snT
Dip Angle: 67.07°
Date: 9/19/2011
Model: IGRF200510

Project: DJ - Hereford Ranch
Site: Anschutz East Platte 13-17H
Well: Anschutz East Platte 13-17H
Plan: APD Directional Plan

SECTION DETAILS

Sec	MD	Inc	Azi	TVD	+N/-S	+E/-W	DLeg	TFace	VSec	Target
1	0.00	0.00	0.00	0.00	0.00	0.00	0.00	0.00	0.00	
2	5339.53	0.00	0.00	5339.53	0.00	0.00	0.00	0.00	0.00	
3	6089.54	90.00	159.92	5817.00	-448.45	163.91	12.00	159.92	477.47	
4	9969.96	90.00	159.92	5817.00	-4093.06	1496.02	0.00	0.00	4357.89	Anschutz East Platte 13-17H (BHL)

TARGET DETAILS

Name	TVD	+N/-S	+E/-W	Northing	Easting	Latitude	Longitude	Shape
Anschutz East Platte 13-17H (BHL)	5817.00	-4093.06	1496.02	357250.95	2354861.72	40° 18' 25.499 N	104° 13' 39.331 W	Point

Denver Division- Colorado

DJ - Hereford Ranch

Anschutz East Platte 13-17H

Anschutz East Platte 13-17H

Original Wellbore

Plan: APD Directional Plan

Standard Planning Report

22 September, 2011

EOG Resources Inc

Planning Report

Database:	EDM	Local Co-ordinate Reference:	Site Anschutz East Platte 13-17H
Company:	Denver Division- Colorado	TVD Reference:	RIG @ 4499.00ft (TBD)
Project:	DJ - Hereford Ranch	MD Reference:	RIG @ 4499.00ft (TBD)
Site:	Anschutz East Platte 13-17H	North Reference:	True
Well:	Anschutz East Platte 13-17H	Survey Calculation Method:	Minimum Curvature
Wellbore:	Original Wellbore		
Design:	APD Directional Plan		

Project	DJ - Hereford Ranch, Weld County		
Map System:	US State Plane 1927 (Exact solution)	System Datum:	Mean Sea Level
Geo Datum:	NAD 1927 (NADCON CONUS)		
Map Zone:	Colorado North 501		

Site	Anschutz East Platte 13-17H		
Site Position:		Northing:	361,322.21 ft
From:	Lat/Long	Easting:	2,353,307.38 ft
Position Uncertainty:	0.00 ft	Slot Radius:	"
		Latitude:	40° 19' 5.948 N
		Longitude:	104° 13' 58.642 W
		Grid Convergence:	0.82 deg

Well	Anschutz East Platte 13-17H		
Well Position	+N/-S	0.00 ft	Northing:
	+E/-W	0.00 ft	Easting:
Position Uncertainty	0.00 ft		Wellhead Elevation:
			Latitude:
			Longitude:
			Ground Level:

Wellbore	Original Wellbore				
Magnetics	Model Name	Sample Date	Declination (deg)	Dip Angle (deg)	Field Strength (nT)
	IGRF200510	9/19/2011	8.49	67.07	53,141

Design	APD Directional Plan				
Audit Notes:					
Version:	Phase:	PROTOTYPE	Tie On Depth:	0.00	
Vertical Section:	Depth From (TVD) (ft)	+N/-S (ft)	+E/-W (ft)	Direction (deg)	
	0.00	0.00	0.00	159.92	

Plan Sections										
Measured Depth (ft)	Inclination (deg)	Azimuth (deg)	Vertical Depth (ft)	+N/-S (ft)	+E/-W (ft)	Dogleg Rate (?/100ft)	Build Rate (?/100ft)	Turn Rate (?/100ft)	TFO (deg)	Target
0.00	0.00	0.00	0.00	0.00	0.00	0.00	0.00	0.00	0.00	
5,339.53	0.00	0.00	5,339.53	0.00	0.00	0.00	0.00	0.00	0.00	
6,089.54	90.00	159.92	5,817.00	-448.45	163.91	12.00	12.00	0.00	159.92	
9,969.96	90.00	159.92	5,817.00	-4,093.06	1,496.02	0.00	0.00	0.00	0.00	Anschutz East Platt

EOG Resources Inc

Planning Report

Database:	EDM	Local Co-ordinate Reference:	Site Anschutz East Platte 13-17H
Company:	Denver Division- Colorado	TVD Reference:	RIG @ 4499.00ft (TBD)
Project:	DJ - Hereford Ranch	MD Reference:	RIG @ 4499.00ft (TBD)
Site:	Anschutz East Platte 13-17H	North Reference:	True
Well:	Anschutz East Platte 13-17H	Survey Calculation Method:	Minimum Curvature
Wellbore:	Original Wellbore		
Design:	APD Directional Plan		

Planned Survey									
Measured Depth (ft)	Inclination (deg)	Azimuth (deg)	Vertical Depth (ft)	+N/-S (ft)	+E/-W (ft)	Vertical Section (ft)	Dogleg Rate (?/100ft)	Build Rate (?/100ft)	Turn Rate (?/100ft)
0.00	0.00	0.00	0.00	0.00	0.00	0.00	0.00	0.00	0.00
100.00	0.00	0.00	100.00	0.00	0.00	0.00	0.00	0.00	0.00
200.00	0.00	0.00	200.00	0.00	0.00	0.00	0.00	0.00	0.00
300.00	0.00	0.00	300.00	0.00	0.00	0.00	0.00	0.00	0.00
400.00	0.00	0.00	400.00	0.00	0.00	0.00	0.00	0.00	0.00
500.00	0.00	0.00	500.00	0.00	0.00	0.00	0.00	0.00	0.00
600.00	0.00	0.00	600.00	0.00	0.00	0.00	0.00	0.00	0.00
700.00	0.00	0.00	700.00	0.00	0.00	0.00	0.00	0.00	0.00
800.00	0.00	0.00	800.00	0.00	0.00	0.00	0.00	0.00	0.00
9-5/8"									
900.00	0.00	0.00	900.00	0.00	0.00	0.00	0.00	0.00	0.00
1,000.00	0.00	0.00	1,000.00	0.00	0.00	0.00	0.00	0.00	0.00
1,100.00	0.00	0.00	1,100.00	0.00	0.00	0.00	0.00	0.00	0.00
1,200.00	0.00	0.00	1,200.00	0.00	0.00	0.00	0.00	0.00	0.00
1,300.00	0.00	0.00	1,300.00	0.00	0.00	0.00	0.00	0.00	0.00
1,400.00	0.00	0.00	1,400.00	0.00	0.00	0.00	0.00	0.00	0.00
1,500.00	0.00	0.00	1,500.00	0.00	0.00	0.00	0.00	0.00	0.00
1,600.00	0.00	0.00	1,600.00	0.00	0.00	0.00	0.00	0.00	0.00
1,700.00	0.00	0.00	1,700.00	0.00	0.00	0.00	0.00	0.00	0.00
1,800.00	0.00	0.00	1,800.00	0.00	0.00	0.00	0.00	0.00	0.00
1,900.00	0.00	0.00	1,900.00	0.00	0.00	0.00	0.00	0.00	0.00
2,000.00	0.00	0.00	2,000.00	0.00	0.00	0.00	0.00	0.00	0.00
2,100.00	0.00	0.00	2,100.00	0.00	0.00	0.00	0.00	0.00	0.00
2,200.00	0.00	0.00	2,200.00	0.00	0.00	0.00	0.00	0.00	0.00
2,300.00	0.00	0.00	2,300.00	0.00	0.00	0.00	0.00	0.00	0.00
2,400.00	0.00	0.00	2,400.00	0.00	0.00	0.00	0.00	0.00	0.00
2,500.00	0.00	0.00	2,500.00	0.00	0.00	0.00	0.00	0.00	0.00
2,600.00	0.00	0.00	2,600.00	0.00	0.00	0.00	0.00	0.00	0.00
2,700.00	0.00	0.00	2,700.00	0.00	0.00	0.00	0.00	0.00	0.00
2,800.00	0.00	0.00	2,800.00	0.00	0.00	0.00	0.00	0.00	0.00
2,900.00	0.00	0.00	2,900.00	0.00	0.00	0.00	0.00	0.00	0.00
3,000.00	0.00	0.00	3,000.00	0.00	0.00	0.00	0.00	0.00	0.00
3,100.00	0.00	0.00	3,100.00	0.00	0.00	0.00	0.00	0.00	0.00
3,200.00	0.00	0.00	3,200.00	0.00	0.00	0.00	0.00	0.00	0.00
3,300.00	0.00	0.00	3,300.00	0.00	0.00	0.00	0.00	0.00	0.00
3,400.00	0.00	0.00	3,400.00	0.00	0.00	0.00	0.00	0.00	0.00
3,500.00	0.00	0.00	3,500.00	0.00	0.00	0.00	0.00	0.00	0.00
3,600.00	0.00	0.00	3,600.00	0.00	0.00	0.00	0.00	0.00	0.00
3,700.00	0.00	0.00	3,700.00	0.00	0.00	0.00	0.00	0.00	0.00
3,800.00	0.00	0.00	3,800.00	0.00	0.00	0.00	0.00	0.00	0.00
3,900.00	0.00	0.00	3,900.00	0.00	0.00	0.00	0.00	0.00	0.00
4,000.00	0.00	0.00	4,000.00	0.00	0.00	0.00	0.00	0.00	0.00
4,100.00	0.00	0.00	4,100.00	0.00	0.00	0.00	0.00	0.00	0.00
4,200.00	0.00	0.00	4,200.00	0.00	0.00	0.00	0.00	0.00	0.00
4,300.00	0.00	0.00	4,300.00	0.00	0.00	0.00	0.00	0.00	0.00
4,400.00	0.00	0.00	4,400.00	0.00	0.00	0.00	0.00	0.00	0.00
4,500.00	0.00	0.00	4,500.00	0.00	0.00	0.00	0.00	0.00	0.00
4,600.00	0.00	0.00	4,600.00	0.00	0.00	0.00	0.00	0.00	0.00
4,700.00	0.00	0.00	4,700.00	0.00	0.00	0.00	0.00	0.00	0.00
4,800.00	0.00	0.00	4,800.00	0.00	0.00	0.00	0.00	0.00	0.00
4,900.00	0.00	0.00	4,900.00	0.00	0.00	0.00	0.00	0.00	0.00
5,000.00	0.00	0.00	5,000.00	0.00	0.00	0.00	0.00	0.00	0.00
5,100.00	0.00	0.00	5,100.00	0.00	0.00	0.00	0.00	0.00	0.00
5,200.00	0.00	0.00	5,200.00	0.00	0.00	0.00	0.00	0.00	0.00

EOG Resources Inc

Planning Report

Database:	EDM	Local Co-ordinate Reference:	Site Anschutz East Platte 13-17H
Company:	Denver Division- Colorado	TVD Reference:	RIG @ 4499.00ft (TBD)
Project:	DJ - Hereford Ranch	MD Reference:	RIG @ 4499.00ft (TBD)
Site:	Anschutz East Platte 13-17H	North Reference:	True
Well:	Anschutz East Platte 13-17H	Survey Calculation Method:	Minimum Curvature
Wellbore:	Original Wellbore		
Design:	APD Directional Plan		

Planned Survey									
Measured Depth (ft)	Inclination (deg)	Azimuth (deg)	Vertical Depth (ft)	+N/-S (ft)	+E/-W (ft)	Vertical Section (ft)	Dogleg Rate (?/100ft)	Build Rate (?/100ft)	Turn Rate (?/100ft)
5,300.00	0.00	0.00	5,300.00	0.00	0.00	0.00	0.00	0.00	0.00
5,339.53	0.00	0.00	5,339.53	0.00	0.00	0.00	0.00	0.00	0.00
5,400.00	7.26	159.92	5,399.84	-3.59	1.31	3.82	12.00	12.00	0.00
5,500.00	19.26	159.92	5,497.00	-25.09	9.17	26.71	12.00	12.00	0.00
5,600.00	31.26	159.92	5,587.27	-65.09	23.79	69.30	12.00	12.00	0.00
5,700.00	43.26	159.92	5,666.72	-121.84	44.53	129.73	12.00	12.00	0.00
5,800.00	55.26	159.92	5,731.87	-192.87	70.50	205.35	12.00	12.00	0.00
5,900.00	67.26	159.92	5,779.87	-275.07	100.54	292.87	12.00	12.00	0.00
6,000.00	79.26	159.92	5,808.63	-364.85	133.35	388.45	12.00	12.00	0.00
6,089.54	90.00	159.92	5,817.00	-448.45	163.91	477.47	12.00	12.00	0.00
7"									
6,100.00	90.00	159.92	5,817.00	-458.28	167.50	487.93	0.00	0.00	0.00
6,200.00	90.00	159.92	5,817.00	-552.20	201.83	587.93	0.00	0.00	0.00
6,300.00	90.00	159.92	5,817.00	-646.12	236.16	687.93	0.00	0.00	0.00
6,400.00	90.00	159.92	5,817.00	-740.05	270.49	787.93	0.00	0.00	0.00
6,500.00	90.00	159.92	5,817.00	-833.97	304.82	887.93	0.00	0.00	0.00
6,600.00	90.00	159.92	5,817.00	-927.89	339.15	987.93	0.00	0.00	0.00
6,700.00	90.00	159.92	5,817.00	-1,021.82	373.48	1,087.93	0.00	0.00	0.00
6,800.00	90.00	159.92	5,817.00	-1,115.74	407.80	1,187.93	0.00	0.00	0.00
6,900.00	90.00	159.92	5,817.00	-1,209.66	442.13	1,287.93	0.00	0.00	0.00
7,000.00	90.00	159.92	5,817.00	-1,303.59	476.46	1,387.93	0.00	0.00	0.00
7,100.00	90.00	159.92	5,817.00	-1,397.51	510.79	1,487.93	0.00	0.00	0.00
7,200.00	90.00	159.92	5,817.00	-1,491.43	545.12	1,587.93	0.00	0.00	0.00
7,300.00	90.00	159.92	5,817.00	-1,585.35	579.45	1,687.93	0.00	0.00	0.00
7,400.00	90.00	159.92	5,817.00	-1,679.28	613.78	1,787.93	0.00	0.00	0.00
7,500.00	90.00	159.92	5,817.00	-1,773.20	648.11	1,887.93	0.00	0.00	0.00
7,600.00	90.00	159.92	5,817.00	-1,867.12	682.44	1,987.93	0.00	0.00	0.00
7,700.00	90.00	159.92	5,817.00	-1,961.05	716.76	2,087.93	0.00	0.00	0.00
7,800.00	90.00	159.92	5,817.00	-2,054.97	751.09	2,187.93	0.00	0.00	0.00
7,900.00	90.00	159.92	5,817.00	-2,148.89	785.42	2,287.93	0.00	0.00	0.00
8,000.00	90.00	159.92	5,817.00	-2,242.81	819.75	2,387.93	0.00	0.00	0.00
8,100.00	90.00	159.92	5,817.00	-2,336.74	854.08	2,487.93	0.00	0.00	0.00
8,200.00	90.00	159.92	5,817.00	-2,430.66	888.41	2,587.93	0.00	0.00	0.00
8,300.00	90.00	159.92	5,817.00	-2,524.58	922.74	2,687.93	0.00	0.00	0.00
8,400.00	90.00	159.92	5,817.00	-2,618.51	957.07	2,787.93	0.00	0.00	0.00
8,500.00	90.00	159.92	5,817.00	-2,712.43	991.40	2,887.93	0.00	0.00	0.00
8,600.00	90.00	159.92	5,817.00	-2,806.35	1,025.73	2,987.93	0.00	0.00	0.00
8,700.00	90.00	159.92	5,817.00	-2,900.28	1,060.05	3,087.93	0.00	0.00	0.00
8,800.00	90.00	159.92	5,817.00	-2,994.20	1,094.38	3,187.93	0.00	0.00	0.00
8,900.00	90.00	159.92	5,817.00	-3,088.12	1,128.71	3,287.93	0.00	0.00	0.00
9,000.00	90.00	159.92	5,817.00	-3,182.04	1,163.04	3,387.93	0.00	0.00	0.00
9,100.00	90.00	159.92	5,817.00	-3,275.97	1,197.37	3,487.93	0.00	0.00	0.00
9,200.00	90.00	159.92	5,817.00	-3,369.89	1,231.70	3,587.93	0.00	0.00	0.00
9,300.00	90.00	159.92	5,817.00	-3,463.81	1,266.03	3,687.93	0.00	0.00	0.00
9,400.00	90.00	159.92	5,817.00	-3,557.74	1,300.36	3,787.93	0.00	0.00	0.00
9,500.00	90.00	159.92	5,817.00	-3,651.66	1,334.69	3,887.93	0.00	0.00	0.00
9,600.00	90.00	159.92	5,817.00	-3,745.58	1,369.01	3,987.93	0.00	0.00	0.00
9,700.00	90.00	159.92	5,817.00	-3,839.50	1,403.34	4,087.93	0.00	0.00	0.00
9,800.00	90.00	159.92	5,817.00	-3,933.43	1,437.67	4,187.93	0.00	0.00	0.00
9,900.00	90.00	159.92	5,817.00	-4,027.35	1,472.00	4,287.93	0.00	0.00	0.00
9,969.96	90.00	159.92	5,817.00	-4,093.06	1,496.02	4,357.89	0.00	0.00	0.00
4 1/2" - Anschutz East Platte 13-17H (BHL)									

EOG Resources Inc

Planning Report

Database:	EDM	Local Co-ordinate Reference:	Site Anschutz East Platte 13-17H
Company:	Denver Division- Colorado	TVD Reference:	RIG @ 4499.00ft (TBD)
Project:	DJ - Hereford Ranch	MD Reference:	RIG @ 4499.00ft (TBD)
Site:	Anschutz East Platte 13-17H	North Reference:	True
Well:	Anschutz East Platte 13-17H	Survey Calculation Method:	Minimum Curvature
Wellbore:	Original Wellbore		
Design:	APD Directional Plan		

Design Targets

Target Name

- hit/miss target	Dip Angle (deg)	Dip Dir. (deg)	TVD (ft)	+N/-S (ft)	+E/-W (ft)	Northing (ft)	Easting (ft)	Latitude	Longitude
- Shape									
Anschutz East Platte	0.00	0.00	5,817.00	-4,093.06	1,496.02	357,250.95	2,354,861.72	40° 18' 25.499 N	104° 13' 39.331 W
- plan hits target center									
- Point									

Casing Points

Measured Depth (ft)	Vertical Depth (ft)	Name	Casing Diameter (")	Hole Diameter (")
800.00	800.00	9-5/8"	9-5/8	13-1/2
6,089.54	5,817.00	7"	7	8-3/4
9,969.96	5,817.00	4 1/2"	4-1/2	6

Formations

Measured Depth (ft)	Vertical Depth (ft)	Name	Lithology	Dip (deg)	Dip Direction (deg)
5,795.00	5,729.00	Top of Niobrara		0.00	