

Loc ID # 335699

DOCUMENT #2216272

FORM 15 Rev 6/99

State of Colorado Oil and Gas Conservation Commission



1120 Lincoln Street, Suite 801, Denver, Colorado 80203 (303)894-2100 Fax: (303)894-2109

FOR OGCC USE ONLY RECEIVED 9/14/2011

EARTHEN PIT REPORT/PERMIT

This form is to be used for both reporting and permitting pits. Rule 903 describes when a Permit with prior approval, or a Report within 30 days, is required for pits. Submit required attachments and forms.

Complete the Attachment Checklist

FORM SUBMITTED FOR:

[X] Pit Report [ ] Pit Permit

Attachment Checklist table with columns for Detailed Site Plan, Topo Map, Water Analysis, etc.

OGCC Operator Number: 100185
Name of Operator: Encana Oil & Gas (USA) Inc.
Address: 370 17th Street, Suite 1700
City: Denver State: CO Zip: 80202

Contact Name and Telephone: Chris Hines
No: 970-285-2653
Fax:

API Number (of associated well): 335699 (Location ID) G09 596
Pit Location (QtrQtr, Sec, Twp, Rng, Meridian): SWNE Sec. 9 T5S R96W
Latitude: 39.631945 Longitude: 108.173530 County: Garfield
Pit Use: [X] Production [ ] Drilling [ ] Special Purpose
Pit Type: [X] Lined [ ] Unlined
Offsite disposal of pit contents: [ ] Injection [ ] Commercial
Attach Form 26 to identify Source Wells and Form 25 to provide Produced Water Analysis results.

Existing Site Conditions

EAST PIT calc.

Is the location in a "Sensilive Area?" [ ] Yes [X] No
Distance (in feet) to nearest surface water: ~541 ground water: ~40' water wells: ~1.2 miles
LAND USE (or attach copy of Form 2A if previously submitted for associated well) Select one which best describes land use:
Crop Land: [ ] Irrigated [ ] Dry Land [ ] Improved Pasture [ ] Hay Meadow [ ] CRP
Non-Crop Land: [X] Rangeland [ ] Timber [ ] Recreational [ ] Other (describe):
Subdivided: [ ] Industrial [ ] Commercial [ ] Residential
SOILS (or attach copy of Form 2A if previously submitted for associated well)
Soil map units form USNRCS survey: Sheet No: Soil Complex/Series No: 56
Soils Series Name: Parachute Irigul Rhone
Attach detailed site plan and topo map with pit location.

Pit Design and Construction

Size of pit (feet): Length: 200 Width: 39 Depth: 19
Calculated pit volume (bbls): 23603 Daily inflow rate (bbls/day):
Daily disposal rates (attach calculations): Evaporation: bbls/day Percolation: bbls/day
Type of liner material: HDPE Thickness: 30 mil
Attach description of proposed design and construction (include sketches and calculations).
Method of treatment of produced water prior to discharge into pit (separator, heater treater, other): Mechanical settling/separating
Is pit fenced? [X] Yes [ ] No Is pit netted? [X] Yes [ ] No

I hereby certify that the statements made in this form are, to the best of my knowledge, true, correct, and complete.

Print Name: Heather Mitchell Signed: [Signature]
Title: Regulatory Analyst Date: 09/01/2011

OGCC Approved: [Signature] Title: For Greg Derantean Date: 09/14/2011

CONDITIONS OF APPROVAL, IF ANY:
Pit report submitted retroactively to establish pit facility ID # for pit closure purposes.

FACILITY NUMBER: 425567

OGLA Supervisor

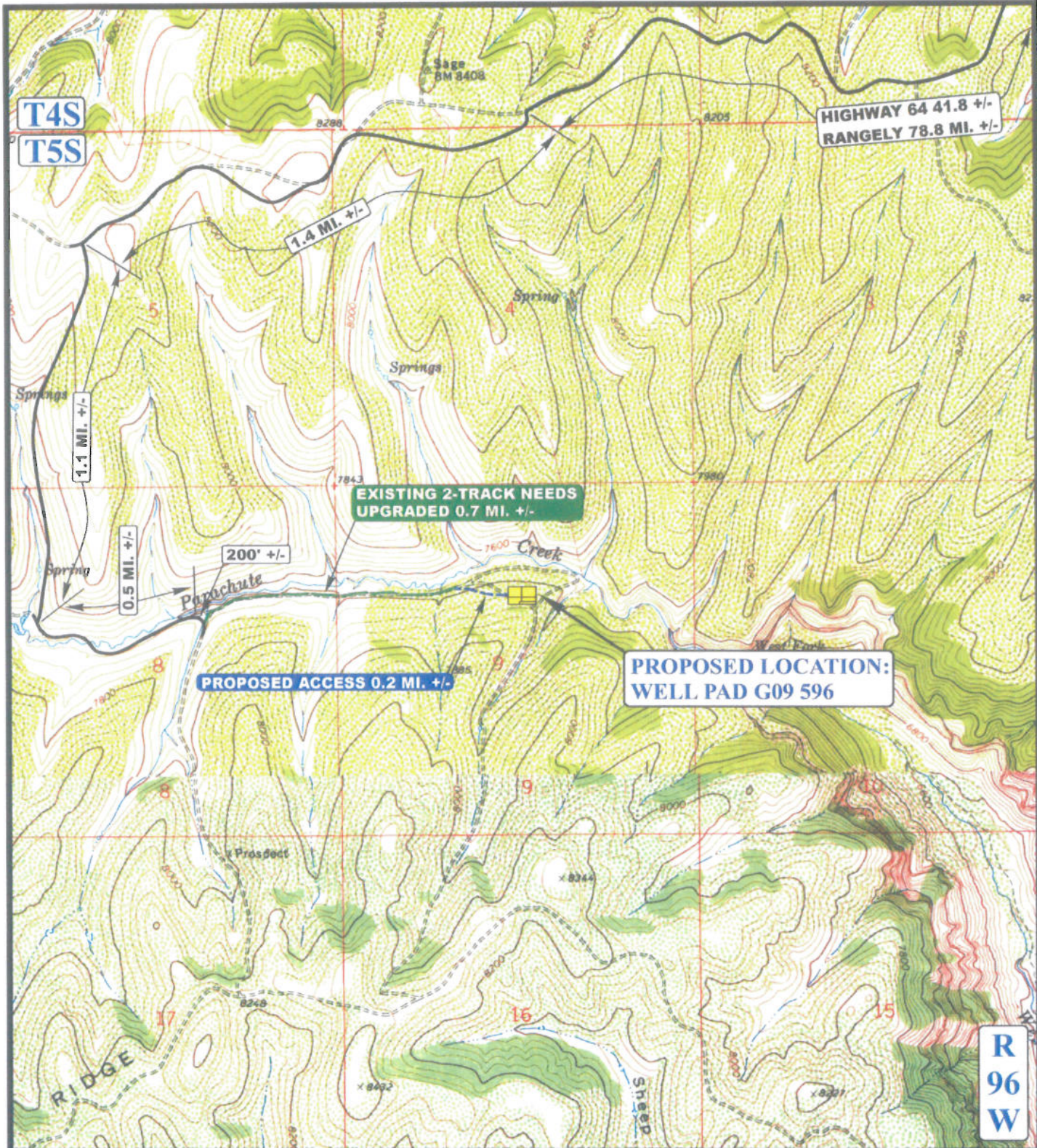

**LEGEND:**

- EXISTING ROAD
- PROPOSED ACCESS ROAD



**EnCana OIL & GAS (USA) INC.**

**WELL PAD G09 596**  
**SECTION 9, T5S, R96W, 6th P.M.**  
**SW 1/4 NE 1/4**



**Utah Engineering & Land Surveying**  
 85 South 200 East Vernal, Utah 84078  
 (435) 789-1017 \* FAG (435) 789-1813

**TOPOGRAPHIC** 07 20 06  
**MAP** MONTH DAY YEAR

SCALE: 1" = 2000' DRAWN BY: J.L.G. REVISED: 00-00-00



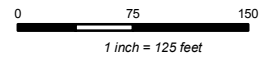

**G09 Well Pad**  
*Wildcat Field*  
**North Parachute Mountain**  
*Garfield County, Colorado*  
*Revised: September 5, 2011*

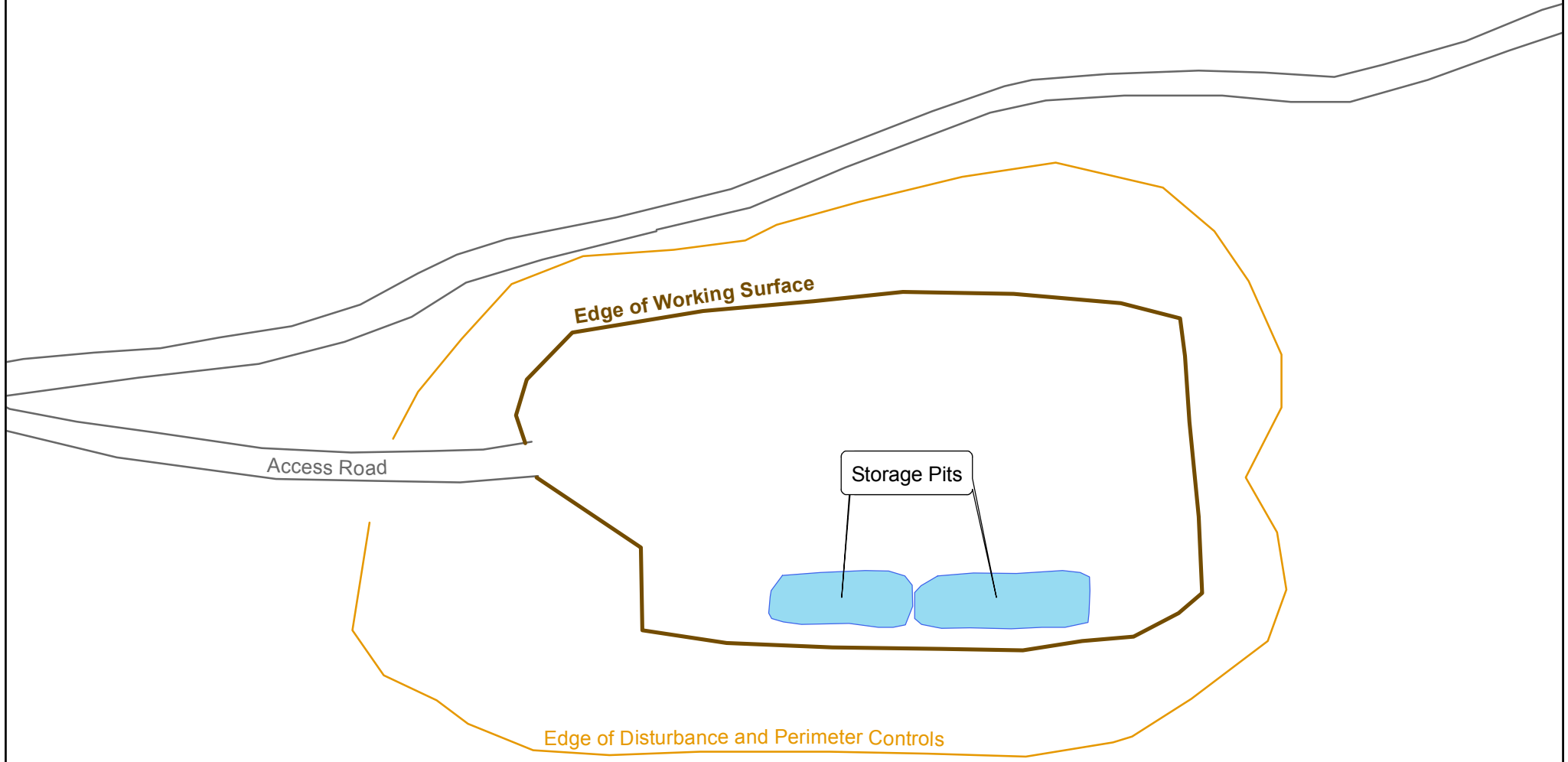

# FORM 15 (Earthen Pit Report/Permit) Narrative Attachment

---

## **NPM G09 596 Pad – 335699(Location ID)**

Document Date – 09/01/2011

---

This pit report was prepared in support of closure activities an historic and unpermitted pit on the G09 596 pad. This pit was transferred to Encana by Conoco Phillips effective 3/08/2010. Encana has limited internal documentation on the original use and construction of the pit. The intent of this submittal is not to justify continued operation of the pits, but to provide a facility ID number to reference during all correspondence associated with pit closure site investigation and remediation activities.

### **Is the location in a “Sensitive Area?”**

No, based on the distance to surface water and the depth to ground water, this location is not found in a sensitive area.

### **Description of pit use:**

The pit on G09 596 well pad provided storage for produced water.