

Loc # 335650

DOCUMENT #2216267

FORM 15 Rev 6/99

State of Colorado Oil and Gas Conservation Commission



1120 Lincoln Street, Suite 801, Denver, Colorado 80203 (303)894-2100 Fax: (303)894-2109

FOR OGCC USE ONLY RECEIVED 9/14/2011

EARTHEN PIT REPORT/PERMIT

This form is to be used for both reporting and permitting pits. Rule 903 describes when a Permit with prior approval, or a Report within 30 days, is required for pits. Submit required attachments and forms.

Complete the Attachment Checklist

FORM SUBMITTED FOR:

[X] Pit Report [] Pit Permit

Attachment Checklist table with columns for 'Detailed Site Plan', 'Topo Map w/ Pit Location', etc.

OGCC Operator Number: 100185
Name of Operator: Encana Oil & Gas (USA) Inc.
Address: 370 17th Street, Suite 1700
City: Denver State: CO Zip: 80202

Contact Name and Telephone: Chris Hines
No: 970-285-2653
Fax:

API Number (of associated well): 335650 (Location ID) OGCC Facility ID (of other associated facility): 335650
Pit Location (QtrQtr, Sec, Twp, Rng, Meridian): NWSE Sec. 25 T5S R96W - WF J25A 596
Latitude: 39.583848 Longitude: 108.114147 County: Garfield
Pit Use: [X] Production [] Drilling (Attach mud program) [] Special Purpose (Describe Use): Multi-well Pit
Pit Type: [X] Lined [] Unlined Surface Discharge Permit: [X] Yes [] No
Offsite disposal of pit contents: [] Injection [] Commercial Pit/Facility Name: N/A J25A WEST PIFacility No: N/A 596
Attach Form 28 to identify Source Wells and Form 25 to provide Produced Water Analysis results. WEST PIT

Existing Site Conditions

Is the location in a "Sensitive Area?" [] Yes [X] No Attach data used for determination.
Distance (in feet) to nearest surface water: ~370 ground water: ~40' water wells: ~510
LAND USE (or attach copy of Form 2A if previously submitted for associated well) Select one which best describes land use:
Crop Land: [] Irrigated [] Dry Land [] Improved Pasture [] Hay Meadow [] CRP
Non-Crop Land: [X] Rangeland [] Timber [] Recreational [] Other (describe):
Subdivided: [] Industrial [] Commercial [] Residential
SOILS (or attach copy of Form 2A if previously submitted for associated well)
Soil map units from USNRCS survey: Sheet No: Soil Complex/Series No: 46
Soils Series Name: Nihill Channery Loam Horizon thickness (in inches): A: ; B: ; C:
Soils Series Name: Horizon thickness (in inches): A: ; B: ; C:
Attach detailed site plan and topo map with pit location.

Pit Design and Construction

Size of pit (feet): Length: 256' Width: 34' Depth: 16'
Calculated pit volume (bbls): 21690 Daily inflow rate (bbls/day):
Daily disposal rates (attach calculations): Evaporation: bbls/day Percolation: bbls/day
Type of liner material: HDPE Thickness: 30 mil
Attach description of proposed design and construction (Include sketches and calculations).
Method of treatment of produced water prior to discharge into pit (separator, heater treater, other): Mechanical settling/separating
Is pit fenced? [X] Yes [] No Is pit netted? [X] Yes [] No

I hereby certify that the statements made in this form are, to the best of my knowledge, true, correct, and complete.
Print Name: Heather Mitchell Signed: [Signature]
Title: Regulatory Analyst Date: 09/06/2011

OGCC Approved: [Signature] Title: FOR Greg Doran-Dean Date: 09/19/2011

CONDITIONS OF APPROVAL, IF ANY:

Pit report submitted retroactively to establish pit facility ID # for pit closure purposes.

FACILITY NUMBER: 425560

OGLA Supervisor

ENCANA OIL & GAS (USA) INC.
 NORTH PARACHUTE RANCH RECYCLING WATER PROGRAM
 J25A WELL PAD
 S25 T5S R96W

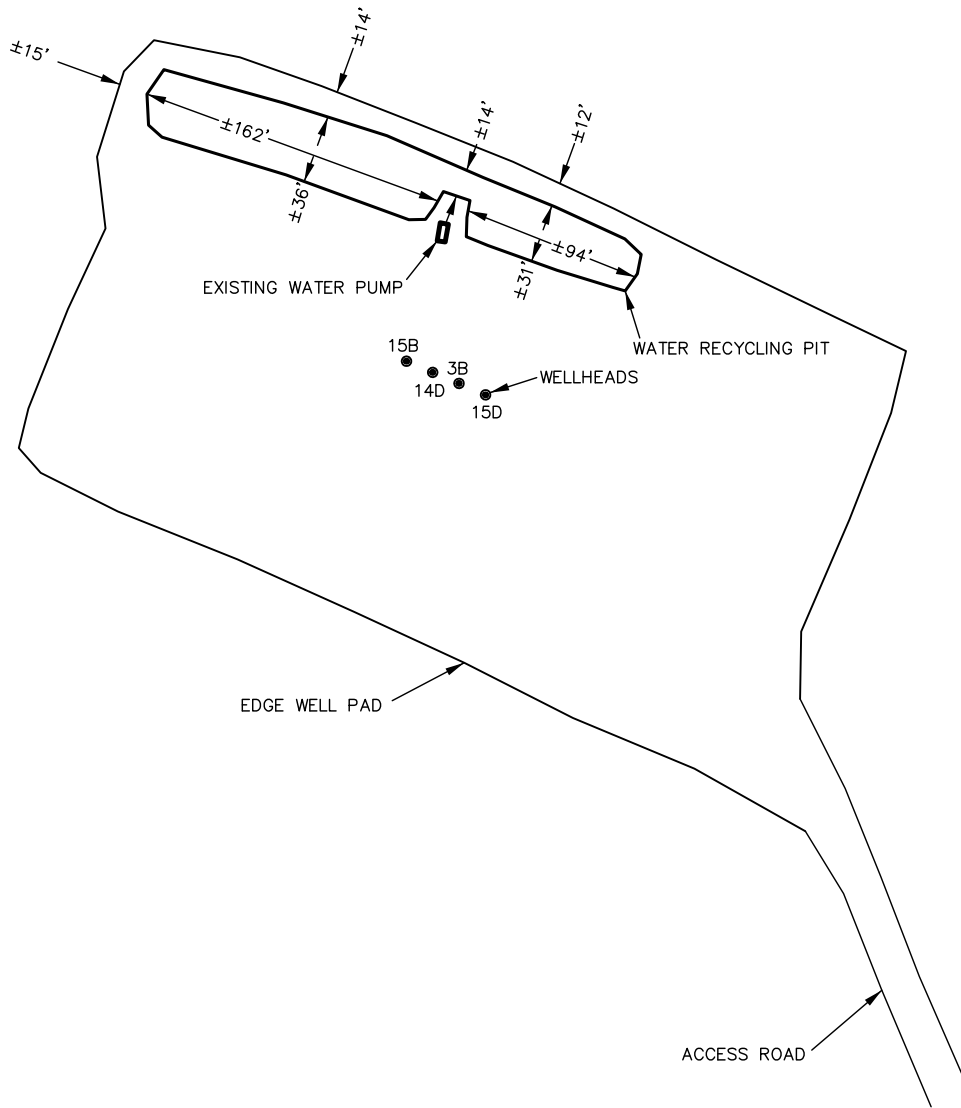

GENERAL NOTE:
 PUMP LOCATIONS (IF INDICATED) ARE NOT PERMANENT OR FINAL LOCATIONS. ALL WATER HANDLING PUMPS USED IN RECYCLING OPERATIONS ARE MOBILE TRAILER-MOUNTED UNITS WHICH MAY BE LOCATED ANYWHERE ALONG THE PERIMETER OF THE PIT IN QUESTION, AT A DISTANCE NO GREATER THAN 20 FEET FROM THE PIT BANK, AS OPERATIONS NECESSITATE.

Rev.: 7-31-08
 Date: 7-9-08
 Drawn By: JEV

UINTAH ENGINEERING & LAND SURVEYING
 832 North Crest Drive, Unit B Grand Junction, Colorado

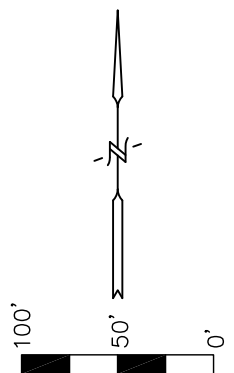

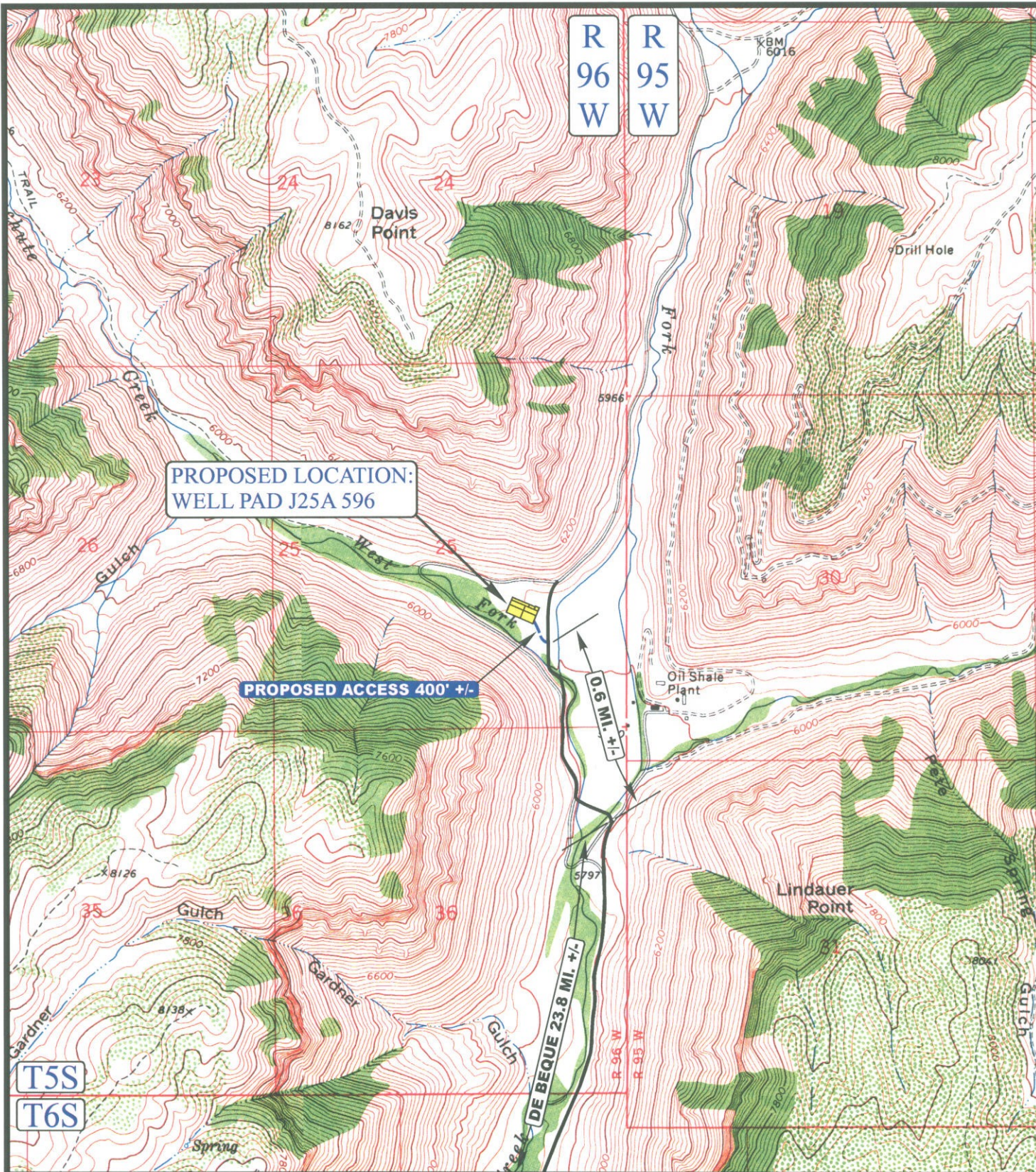

LEGEND:

- PROPOSED ACCESS ROAD
- EXISTING ROAD



EnCana OIL & GAS (USA) INC.

WELL PAD J25A 596
SECTION 25, T5S, R96W, 6th P.M.
NW 1/4 SE 1/4



Uintah Engineering & Land Surveying
 85 South 200 East Vernal, Utah 84078
 (435) 789-1017 * FAX (435) 789-1813

TOPOGRAPHIC MAP

11 29 05
 MONTH DAY YEAR

SCALE: 1" = 2000' DRAWN BY: J.L.G. REVISED: 00-00-00



FORM 15 (Earthen Pit Report/Permit) Narrative Attachment

WF J25A 596 Pad – 335650(Location ID)

Document Date – 09/06/2011

This pit report was prepared in support of closure activities on historic and unpermitted pit on the WF J25A 596 pad. Encana has limited internal documentation on the original use and construction of the pit. The intent of this submittal is not to justify continued operation of the pit, but to provide a facility ID number to reference during all correspondence associated with pit closure site investigation and remediation activities.

Is the location in a “Sensitive Area?”

No, based on the distance to surface water and the depth to ground water, this location is not found in a sensitive area.

Description of pit use:

The pits on this well pad provided storage for treated water used in support of hydraulic fracturing operations in Encana’s North Parachute Ranch. The pits were constructed on the cut-slope and were supplied filtered produced water via pipeline from the Middle Fork Treatment Facility, located in the SWSW of Section 30, T5S, R95W in Garfield County or transferred from a flowback tank after mechanical settling.

The North Parachute Properties use a centralized 3-phase gathering system for the collection of produced natural gas and associated fluids. With this centralization of the fluid separation and processing, these pits are likely to contain filter produced water from every well in the North Parachute Properties.