



KERR MCGEE OIL & GAS ONSHORE LP



Location: COLORADO Slot: SLOT#04 CANNON 2-3 (1543'FNL & 1668'FEL)
Field: WELD COUNTY (KERR MCGEE) Well: CANNON 2-3
Facility: SEC.03-T2N-R65W Wellbore: CANNON 2-3 PWB

Plot reference wellpath is CANNON 2-3 (REV-B.1) PWP	
True vertical depths are referenced to XTREME 12 (RKB)	Grid System: NAD83 / Lambert Colorado SP, Northern Zone (501), US feet
Measured depths are referenced to XTREME 12 (RKB)	North Reference: True north
XTREME 12 (RKB) to Mean Sea Level: 4859 feet	Scale: True distance
Mean Sea Level to Mud line (At Slot: SLOT#04 CANNON 2-3 (1543'FNL & 1668'FEL)): 0 feet	Depths are in feet
Coordinates are in feet referenced to Slot	Created by: doddanna on 9/9/2011

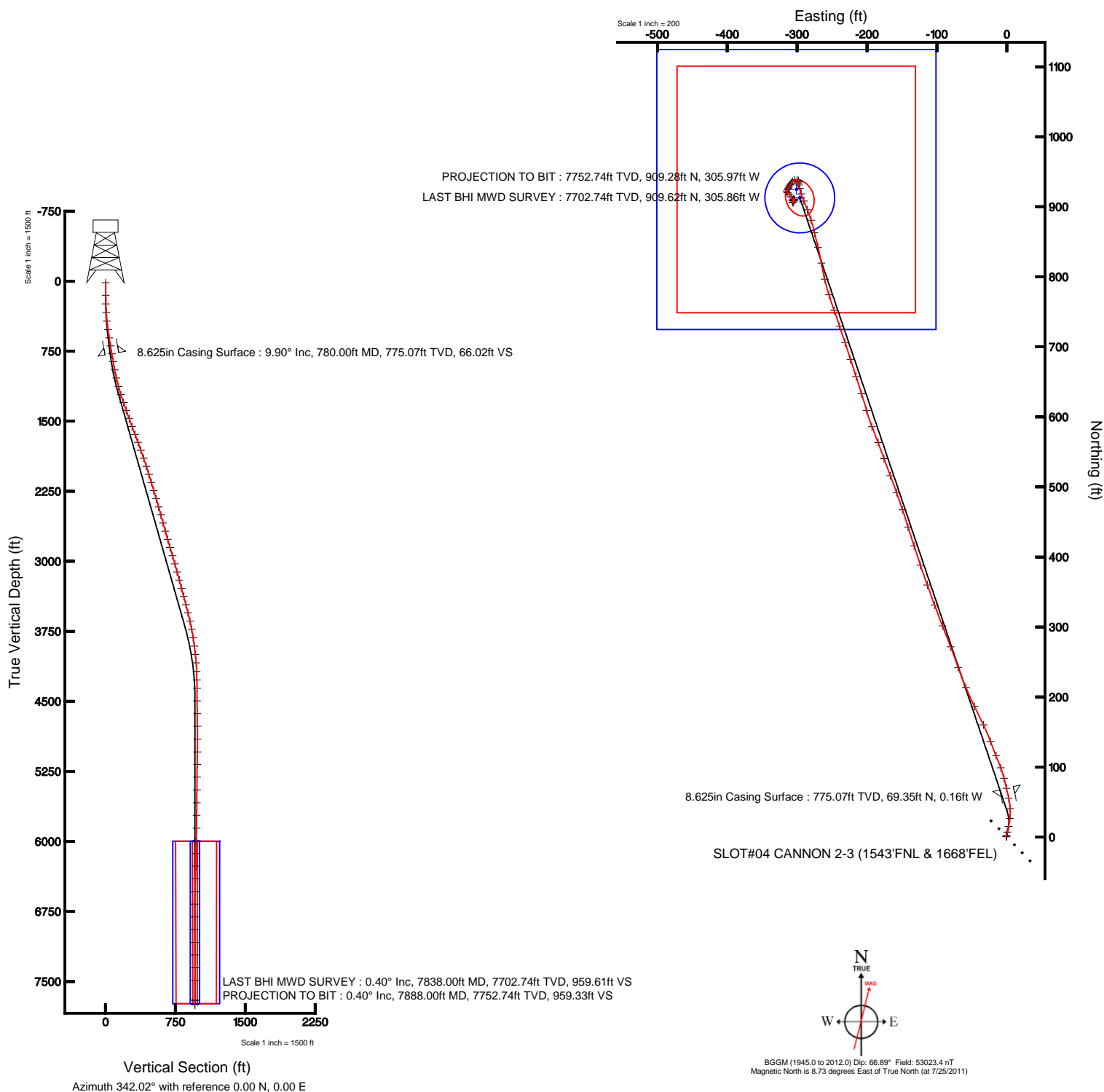



Actual Wellpath Report

CANNON 2-3 AWP

Page 1 of 4



REFERENCE WELLPATH IDENTIFICATION			
Operator	KERR MCGEE OIL & GAS ONSHORE LP	Slot	SLOT#04 CANNON 2-3 (1543'FNL & 1668'FEL)
Area	COLORADO	Well	CANNON 2-3
Field	WELD COUNTY (KERR MCGEE)	Wellbore	CANNON 2-3 AWB
Facility	SEC.03-T2N-R65W		

REPORT SETUP INFORMATION			
Projection System	NAD83 / Lambert Colorado SP, Northern Zone (501), US feet	Software System	WellArchitect® 3.0.0
North Reference	True	User	Doddanna
Scale	0.999958	Report Generated	9/9/2011 at 1:40:48 PM
Convergence at slot	0.55° East	Database/Source file	WA_Denver/CANNON_2-3_AWB.xml

WELLPATH LOCATION						
	Local coordinates		Grid coordinates		Geographic coordinates	
	North[ft]	East[ft]	Easting[US ft]	Northing[US ft]	Latitude	Longitude
Slot Location	34.28	-33.52	3238576.31	1306054.71	40°10'13.307"N	104°38'46.547"W
Facility Reference Pt			3238610.16	1306020.75	40°10'12.968"N	104°38'46.115"W
Field Reference Pt			3197771.84	1268891.29	40°04'09.600"N	104°47'36.000"W

WELLPATH DATUM			
Calculation method	Minimum curvature	XTREME 12 (RKB) to Facility Vertical Datum	4859.00ft
Horizontal Reference Pt	Slot	XTREME 12 (RKB) to Mean Sea Level	4859.00ft
Vertical Reference Pt	XTREME 12 (RKB)	XTREME 12 (RKB) to Mud Line at Slot (SLOT#04 CANNON 2-3 (1543'FNL & 1668'FEL))	4859.00ft
MD Reference Pt	XTREME 12 (RKB)	Section Origin	N 0.00, E 0.00 ft
Field Vertical Reference	Mean Sea Level	Section Azimuth	342.02°



Actual Wellpath Report

CANNON 2-3 AWP

Page 2 of 4



REFERENCE WELLPATH IDENTIFICATION			
Operator	KERR MCGEE OIL & GAS ONSHORE LP	Slot	SLOT#04 CANNON 2-3 (1543'FNL & 1668'FEL)
Area	COLORADO	Well	CANNON 2-3
Field	WELD COUNTY (KERR MCGEE)	Wellbore	CANNON 2-3 AWB
Facility	SEC.03-T2N-R65W		

WELLPATH DATA (75 stations) † = interpolated/extrapolated station								
MD [ft]	Inclination [°]	Azimuth [°]	TVD [ft]	Vert Sect [ft]	North [ft]	East [ft]	DLS [°/100ft]	Comments
0.00†	0.000	308.600	0.00	0.00	0.00	0.00	0.00	
15.00	0.000	308.600	15.00	0.00	0.00	0.00	0.00	
149.00	0.600	308.600	149.00	0.59	0.44	-0.55	0.45	
242.00	1.900	18.600	241.98	2.23	2.20	-0.44	1.92	
334.00	4.000	15.400	333.85	6.13	6.74	0.90	2.29	
427.00	6.400	11.900	426.46	13.34	14.94	2.83	2.60	
517.00	8.300	7.000	515.72	23.58	26.30	4.66	2.22	
608.00	9.500	356.800	605.63	36.79	40.32	5.04	2.17	
695.00	10.100	348.000	691.36	51.32	54.95	3.05	1.85	
867.00	9.700	345.600	860.80	80.79	83.74	-3.69	0.33	
956.00	10.700	339.200	948.40	96.52	98.72	-8.49	1.70	
1046.00	13.000	338.500	1036.47	114.97	115.95	-15.16	2.56	
1137.00	14.700	339.600	1124.82	136.73	136.30	-22.94	1.89	
1228.00	18.300	334.000	1212.07	162.42	159.97	-33.23	4.32	
1319.00	19.200	334.300	1298.24	191.39	186.30	-45.98	0.99	
1409.00	19.500	336.800	1383.15	221.02	213.44	-58.32	0.98	
1500.00	19.900	341.000	1468.83	251.63	242.04	-69.34	1.62	
1591.00	20.600	338.900	1554.21	283.10	271.62	-80.15	1.11	
1682.00	20.600	338.200	1639.39	315.06	301.42	-91.86	0.27	
1773.00	20.300	340.300	1724.66	346.81	331.15	-103.13	0.87	
1863.00	19.300	339.600	1809.33	377.28	359.79	-113.57	1.14	
1954.00	19.300	342.100	1895.22	407.34	388.20	-123.44	0.91	
2045.00	18.100	341.400	1981.42	436.52	415.90	-132.57	1.34	
2136.00	17.500	342.800	2068.06	464.33	442.37	-141.12	0.81	
2226.00	16.500	341.700	2154.13	490.64	467.43	-149.14	1.17	
2317.00	16.500	339.900	2241.38	516.48	491.84	-157.64	0.56	
2408.00	16.600	339.200	2328.61	542.38	516.13	-166.69	0.25	
2499.00	16.100	340.300	2415.93	567.97	540.16	-175.56	0.65	
2589.00	15.700	339.200	2502.49	592.61	563.29	-184.09	0.56	
2680.00	15.400	338.500	2590.16	616.97	586.04	-192.89	0.39	
2771.00	15.900	344.500	2677.79	641.48	609.30	-200.65	1.86	
2862.00	16.100	342.100	2765.26	666.55	633.32	-207.86	0.76	
2953.00	16.600	342.100	2852.58	692.17	657.69	-215.74	0.55	
3043.00	16.400	342.400	2938.88	717.73	682.04	-223.53	0.24	
3134.00	15.800	341.400	3026.31	742.96	706.02	-231.37	0.73	
3225.00	15.600	341.400	3113.91	767.59	729.36	-239.22	0.22	
3315.00	15.200	341.000	3200.68	791.49	751.99	-246.92	0.46	
3406.00	14.900	342.100	3288.56	815.11	774.40	-254.40	0.46	
3497.00	14.700	347.000	3376.54	838.32	796.79	-260.60	1.39	
3588.00	15.100	349.800	3464.48	861.56	819.70	-265.29	0.90	
3678.00	14.200	345.900	3551.56	884.19	841.95	-270.06	1.48	
3769.00	13.200	347.000	3639.97	905.68	862.90	-275.11	1.14	
3860.00	10.700	341.700	3728.99	924.48	881.04	-280.10	3.00	
3951.00	9.200	338.900	3818.62	940.19	895.85	-285.38	1.73	
4042.00	7.800	335.700	3908.62	953.60	908.27	-290.54	1.62	



Actual Wellpath Report

CANNON 2-3 AWP

Page 3 of 4



REFERENCE WELLPATH IDENTIFICATION			
Operator	KERR MCGEE OIL & GAS ONSHORE LP	Slot	SLOT#04 CANNON 2-3 (1543'FNL & 1668'FEL)
Area	COLORADO	Well	CANNON 2-3
Field	WELD COUNTY (KERR MCGEE)	Wellbore	CANNON 2-3 AWB
Facility	SEC.03-T2N-R65W		

WELLPATH DATA (75 stations)								
MD [ft]	Inclination [°]	Azimuth [°]	TVD [ft]	Vert Sect [ft]	North [ft]	East [ft]	DLS [°/100ft]	Comments
4132.00	6.400	348.400	3997.93	964.65	918.75	-294.06	2.33	
4223.00	4.000	340.300	4088.55	972.87	926.71	-296.15	2.75	
4314.00	2.100	335.700	4179.42	977.70	931.21	-297.90	2.10	
4405.00	1.400	355.800	4270.38	980.43	933.84	-298.67	1.01	
4495.00	0.700	41.500	4360.37	981.78	935.35	-298.39	1.16	
4631.00	0.500	18.300	4496.36	982.68	936.54	-297.65	0.23	
4767.00	0.800	315.300	4632.35	984.01	937.77	-298.13	0.53	
4903.00	1.100	284.800	4768.33	985.56	938.78	-300.06	0.42	
5040.00	1.800	257.700	4905.29	986.49	938.66	-303.44	0.70	
5176.00	1.900	219.000	5041.22	985.47	936.45	-306.94	0.90	
5312.00	0.700	191.200	5177.19	983.52	933.89	-308.52	0.97	
5448.00	1.000	218.700	5313.17	982.14	932.14	-309.43	0.37	
5585.00	1.100	219.000	5450.15	980.76	930.19	-311.00	0.07	
5721.00	0.900	193.300	5586.13	979.14	928.14	-312.07	0.36	
5857.00	0.800	212.000	5722.11	977.62	926.29	-312.82	0.22	
5993.00	0.900	211.200	5858.10	976.31	924.57	-313.87	0.07	
6129.00	1.100	208.500	5994.08	974.71	922.51	-315.05	0.15	
6265.00	1.600	118.400	6130.05	972.44	920.46	-314.00	1.43	
6401.00	1.700	143.700	6266.00	969.15	917.93	-311.14	0.54	
6537.00	2.000	152.600	6401.93	964.89	914.20	-308.85	0.30	
6673.00	1.700	166.200	6537.86	960.54	910.13	-307.28	0.39	
6809.00	1.400	176.800	6673.81	956.92	906.52	-306.70	0.30	
6945.00	1.200	39.700	6809.79	956.07	905.95	-305.70	1.78	
7081.00	1.000	15.400	6945.77	957.83	908.19	-304.48	0.37	
7218.00	0.500	351.900	7082.76	959.41	909.94	-304.24	0.42	
7354.00	0.400	345.500	7218.75	960.47	910.98	-304.45	0.08	
7490.00	0.300	243.500	7354.75	960.89	911.28	-304.88	0.40	
7626.00	0.300	207.400	7490.75	960.59	910.81	-305.37	0.14	
7838.00	0.400	198.600	7702.74	959.61	909.62	-305.86	0.05	LAST BHI MWD SURVEY
7888.00	0.400	198.600	7752.74	959.33	909.28	-305.97	0.00	PROJECTION TO BIT

HOLE & CASING SECTIONS - Ref Wellbore: CANNON 2-3 AWB Ref Wellpath: CANNON 2-3 AWP									
String/Diameter	Start MD [ft]	End MD [ft]	Interval [ft]	Start TVD [ft]	End TVD [ft]	Start N/S [ft]	Start E/W [ft]	End N/S [ft]	End E/W [ft]
12.25in Open Hole	15.00	780.00	765.00	15.00	775.07	0.00	0.00	69.35	-0.16
8.625in Casing Surface	15.00	780.00	765.00	15.00	775.07	0.00	0.00	69.35	-0.16
7.875in Open Hole	780.00	7888.00	7108.00	775.07	7752.74	69.35	-0.16	909.28	-305.97



Actual Wellpath Report

CANNON 2-3 AWP

Page 4 of 4



REFERENCE WELLPATH IDENTIFICATION			
Operator	KERR MCGEE OIL & GAS ONSHORE LP	Slot	SLOT#04 CANNON 2-3 (1543'FNL & 1668'FEL)
Area	COLORADO	Well	CANNON 2-3
Field	WELD COUNTY (KERR MCGEE)	Wellbore	CANNON 2-3 AWB
Facility	SEC.03-T2N-R65W		

TARGETS									
Name	MD [ft]	TVD [ft]	North [ft]	East [ft]	Grid East [US ft]	Grid North [US ft]	Latitude	Longitude	Shape
CANNON 2-3 GEO TARGET 50' TARGET (632'FNL & 1980'FEL REV-1)		6000.00	912.89	-296.24	3238271.31	1306964.66	40°10'22.328"N	104°38'50.363"W	circle
CANNON 2-3 LEGAL BOX (212'N, 188'S, 195'E, 205'W OF GEO TARGET)		6000.00	924.93	-301.22	3238266.21	1306976.65	40°10'22.447"N	104°38'50.427"W	square

WELLPATH COMPOSITION - Ref Wellbore: CANNON 2-3 AWB					Ref Wellpath: CANNON 2-3 AWP	
Start MD [ft]	End MD [ft]	Positional Uncertainty Model	Log Name/Comment		Wellbore	
15.00	695.00	NaviTrak (Standard)	BHI MWD NAVITRAK 12.25 <149-695>		CANNON 2-3 AWB	
695.00	7838.00	NaviTrak (Standard)	BHI MWD NAVITRAK 7.875 <867-7838>		CANNON 2-3 AWB	
7838.00	7888.00	Blind Drilling (std)	Projection to bit		CANNON 2-3 AWB	