

Synergy Resources

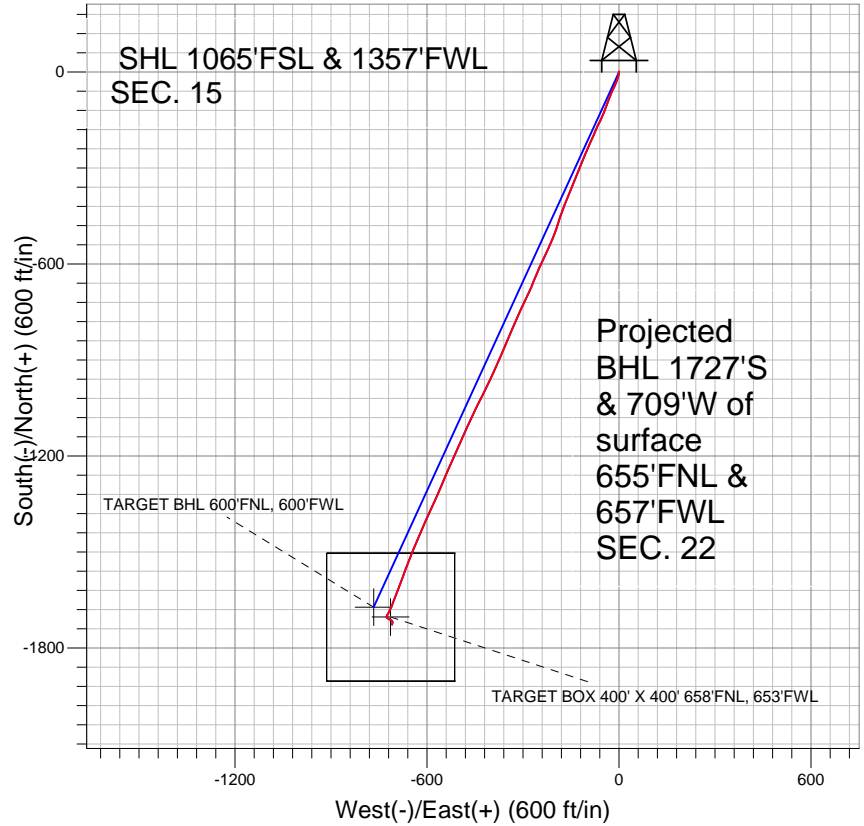

LEGEND

- RBF 11-22D, Wellbore #1, Plan #2 (8-31-10) V0
- Wellbore #1
- Survey #1

Final Survey Plot

Projected Final Survey -
7718'MD & 7326'TVD @ 1866' VS
1.7 deg Inc 192.3 deg AZ

Project: SEC.15-T6N-R67W
Site: RBF 24-15D Pad Sec.15-T6N-R67W
Well: RBF 11-22D
Plan: Wellbore #1



Directional

Synergy Resources

SEC.15-T6N-R67W

RBF 24-15D Pad Sec.15-T6N-R67W

RBF 11-22D

Wellbore #1

Survey: Survey #1

Standard Survey Report

30 November, 2010

Company:	Synergy Resources	Local Co-ordinate Reference:	Well RBF 11-22D
Project:	SEC.15-T6N-R67W	TVD Reference:	WELL @ 4793.0ft (Original Well Elev)
Site:	RBF 24-15D Pad Sec.15-T6N-R67W	MD Reference:	WELL @ 4793.0ft (Original Well Elev)
Well:	RBF 11-22D	North Reference:	True
Wellbore:	Wellbore #1	Survey Calculation Method:	Minimum Curvature
Design:	Wellbore #1	Database:	Landmark

Project	SEC.15-T6N-R67W, Weld County, Colorado		
Map System:	US State Plane 1983	System Datum:	Mean Sea Level
Geo Datum:	North American Datum 1983		Using Well Reference Point
Map Zone:	Colorado Northern Zone		Using geodetic scale factor

Site		RBF 24-15D Pad Sec.15-T6N-R67W			
Site Position:		Northing:	1,419,255.21 ft	Latitude:	40° 28' 57.446 N
From:	Lat/Long	Easting:	3,171,309.35 ft	Longitude:	104° 53' 2.951 W
Position Uncertainty:	0.0 ft	Slot Radius:	"	Grid Convergence:	0.40 °

Well	RBF 11-22D					
Well Position	+N/-S	0.0 ft	Northing:	1,419,235.17 ft	Latitude:	40° 28' 57.248 N
	+E/-W	0.0 ft	Easting:	3,171,309.76 ft	Longitude:	104° 53' 2.947 W
Position Uncertainty		0.0 ft	Wellhead Elevation:	ft	Ground Level:	4,780.0 ft

Wellbore	Wellbore #1				
Magnetics	Model Name	Sample Date	Declination (°)	Dip Angle (°)	Field Strength (nT)
	IGRF2010	11/23/2010	9.01	67.12	53,221

Design	Wellbore #1				
Audit Notes:					
Version:	1.0	Phase:	ACTUAL	Tie On Depth:	0.0
Vertical Section:	Depth From (TVD) (ft)	+N/-S (ft)	+E/-W (ft)	Direction (°)	
	0.0	0.0	0.0	202.33	

Survey Program		Date	11/30/2010		
From (ft)	To (ft)	Survey (Wellbore)	Tool Name	Description	
520.0	7,718.0	Survey #1 (Wellbore #1)	MWD	MWD - Standard	

Survey	Wellbore Data									
	Measured Depth (ft)	Inclination (°)	Azimuth (°)	Vertical Depth (ft)	+N/-S (ft)	+E/-W (ft)	Vertical Section (ft)	Dogleg Rate (°/100ft)	Build Rate (°/100ft)	Turn Rate (°/100ft)
Survey A	0.0	0.00	0.00	0.0	0.0	0.0	0.0	0.00	0.00	0.00
	520.0	0.10	348.70	520.0	0.4	-0.1	-0.4	0.02	0.02	0.00
	616.0	1.90	185.90	616.0	-1.1	-0.3	1.1	2.08	1.88	-169.58
	709.0	4.50	189.30	708.8	-6.2	-1.0	6.1	2.80	2.80	3.66
	803.0	6.10	194.80	802.4	-14.7	-2.9	14.7	1.78	1.70	5.85
	897.0	7.50	198.00	895.8	-25.3	-6.1	25.7	1.54	1.49	3.40
	991.0	9.70	203.40	988.7	-38.4	-11.1	39.8	2.49	2.34	5.74
	1,085.0	11.30	206.90	1,081.1	-53.9	-18.4	56.9	1.83	1.70	3.72
	1,178.0	12.40	203.00	1,172.1	-71.2	-26.4	75.9	1.46	1.18	-4.19
	1,272.0	14.40	197.60	1,263.6	-91.7	-33.9	97.7	2.51	2.13	-5.74
	1,364.0	15.80	202.40	1,352.4	-114.1	-42.2	121.6	2.04	1.52	5.22
	1,458.0	17.80	204.10	1,442.4	-139.1	-52.9	148.8	2.19	2.13	1.81
	1,552.0	18.40	205.50	1,531.7	-165.6	-65.1	177.9	0.79	0.64	1.49

Company:	Synergy Resources	Local Co-ordinate Reference:	Well RBF 11-22D
Project:	SEC.15-T6N-R67W	TVD Reference:	WELL @ 4793.0ft (Original Well Elev)
Site:	RBF 24-15D Pad Sec.15-T6N-R67W	MD Reference:	WELL @ 4793.0ft (Original Well Elev)
Well:	RBF 11-22D	North Reference:	True
Wellbore:	Wellbore #1	Survey Calculation Method:	Minimum Curvature
Design:	Wellbore #1	Database:	Landmark

Survey										
Measured Depth (ft)	Inclination (°)	Azimuth (°)	Vertical Depth (ft)	+N/-S (ft)	+E/-W (ft)	Vertical Section (ft)	Dogleg Rate (°/100ft)	Build Rate (°/100ft)	Turn Rate (°/100ft)	
1,646.0	21.20	202.30	1,620.2	-194.7	-78.0	209.8	3.19	2.98	-3.40	
1,739.0	23.20	205.20	1,706.3	-226.9	-92.2	244.9	2.45	2.15	3.12	
1,833.0	24.50	203.10	1,792.3	-261.5	-107.7	282.9	1.65	1.38	-2.23	
1,927.0	25.50	200.20	1,877.4	-298.5	-122.3	322.6	1.68	1.06	-3.09	
2,021.0	26.30	203.70	1,962.0	-336.5	-137.7	363.6	1.84	0.85	3.72	
2,115.0	26.20	202.00	2,046.3	-374.8	-153.8	405.2	0.81	-0.11	-1.81	
2,209.0	25.80	201.90	2,130.8	-413.1	-169.2	446.4	0.43	-0.43	-0.11	
2,302.0	26.90	198.00	2,214.1	-451.8	-183.3	487.6	2.20	1.18	-4.19	
2,396.0	27.10	198.80	2,297.9	-492.3	-196.8	530.2	0.44	0.21	0.85	
2,490.0	27.90	203.40	2,381.3	-532.8	-212.4	573.5	2.41	0.85	4.89	
2,584.0	28.60	205.30	2,464.1	-573.3	-230.7	618.0	1.21	0.74	2.02	
2,677.0	28.10	204.40	2,545.9	-613.4	-249.3	662.1	0.71	-0.54	-0.97	
2,771.0	26.60	201.90	2,629.4	-653.1	-266.3	705.3	2.01	-1.60	-2.66	
2,865.0	25.40	203.90	2,713.9	-691.0	-282.3	746.5	1.58	-1.28	2.13	
2,958.0	27.00	206.30	2,797.4	-728.2	-299.8	787.5	2.06	1.72	2.58	
3,052.0	25.80	204.60	2,881.6	-765.9	-317.7	829.2	1.51	-1.28	-1.81	
3,146.0	25.00	201.80	2,966.5	-803.0	-333.6	869.5	1.53	-0.85	-2.98	
3,239.0	25.60	203.20	3,050.6	-839.7	-348.8	909.3	0.91	0.65	1.51	
3,333.0	24.60	204.10	3,135.7	-876.2	-364.8	949.1	1.14	-1.06	0.96	
3,427.0	24.00	202.60	3,221.4	-911.7	-380.2	987.8	0.92	-0.64	-1.60	
3,521.0	22.70	205.00	3,307.7	-945.8	-395.2	1,025.0	1.71	-1.38	2.55	
3,615.0	22.90	206.80	3,394.3	-978.6	-411.1	1,061.4	0.77	0.21	1.91	
3,708.0	23.60	205.60	3,479.8	-1,011.5	-427.3	1,098.0	0.91	0.75	-1.29	
3,802.0	26.70	206.70	3,564.8	-1,047.4	-444.9	1,137.9	3.34	3.30	1.17	
3,896.0	29.60	205.30	3,647.7	-1,087.2	-464.3	1,182.1	3.16	3.09	-1.49	
3,989.0	30.30	204.20	3,728.3	-1,129.4	-483.8	1,228.5	0.96	0.75	-1.18	
4,083.0	30.50	203.30	3,809.4	-1,172.9	-502.9	1,276.1	0.53	0.21	-0.96	
4,177.0	30.30	204.00	3,890.4	-1,216.5	-522.0	1,323.6	0.43	-0.21	0.74	
4,270.0	28.20	203.40	3,971.6	-1,258.1	-540.3	1,369.0	2.28	-2.26	-0.65	
4,364.0	29.60	202.10	4,053.9	-1,300.0	-557.8	1,414.5	1.63	1.49	-1.38	
4,458.0	29.20	205.40	4,135.8	-1,342.2	-576.4	1,460.6	1.77	-0.43	3.51	
4,551.0	28.00	204.00	4,217.4	-1,382.7	-595.0	1,505.0	1.48	-1.29	-1.51	
4,645.0	27.30	204.00	4,300.7	-1,422.5	-612.7	1,548.6	0.74	-0.74	0.00	
4,739.0	24.50	203.10	4,385.2	-1,460.1	-629.2	1,589.7	3.01	-2.98	-0.96	
4,833.0	22.90	201.60	4,471.3	-1,495.1	-643.5	1,627.5	1.82	-1.70	-1.60	
4,927.0	20.10	202.10	4,558.8	-1,527.1	-656.4	1,661.9	2.99	-2.98	0.53	
5,021.0	19.10	200.30	4,647.3	-1,556.4	-667.8	1,693.4	1.24	-1.06	-1.91	
5,115.0	18.10	200.60	4,736.4	-1,584.5	-678.2	1,723.4	1.07	-1.06	0.32	
5,209.0	16.50	200.60	4,826.1	-1,610.7	-688.1	1,751.3	1.70	-1.70	0.00	
5,302.0	13.30	201.00	4,916.0	-1,633.1	-696.6	1,775.2	3.44	-3.44	0.43	
5,396.0	10.90	201.20	5,007.9	-1,651.4	-703.7	1,794.9	2.55	-2.55	0.21	
5,490.0	8.50	201.70	5,100.6	-1,666.2	-709.4	1,810.8	2.55	-2.55	0.53	
5,583.0	6.90	203.30	5,192.7	-1,677.7	-714.2	1,823.2	1.74	-1.72	1.72	
5,677.0	5.50	206.00	5,286.2	-1,686.9	-718.4	1,833.4	1.52	-1.49	2.87	
5,771.0	4.30	209.70	5,379.8	-1,694.0	-722.1	1,841.4	1.32	-1.28	3.94	
5,865.0	3.90	203.30	5,473.6	-1,700.0	-725.1	1,848.1	0.65	-0.43	-6.81	
5,959.0	1.90	164.50	5,567.5	-1,704.5	-726.0	1,852.5	2.87	-2.13	-41.28	
6,053.0	0.50	109.30	5,661.4	-1,706.1	-725.2	1,853.7	1.77	-1.49	-58.72	
6,241.0	1.30	117.60	5,849.4	-1,707.4	-722.5	1,853.9	0.43	0.43	4.41	
6,289.8	1.56	119.56	5,898.2	-1,708.0	-721.4	1,854.0	0.54	0.53	4.02	
TARGET BHL 600'FNL, 600'FWL										
6,428.0	2.30	122.70	6,036.3	-1,710.4	-717.5	1,854.7	0.54	0.54	2.27	
6,615.0	1.10	116.10	6,223.2	-1,713.2	-712.7	1,855.5	0.65	-0.64	-3.53	
6,802.0	0.50	124.50	6,410.2	-1,714.5	-710.4	1,855.8	0.33	-0.32	4.49	

Company:	Synergy Resources	Local Co-ordinate Reference:	Well RBF 11-22D
Project:	SEC.15-T6N-R67W	TVD Reference:	WELL @ 4793.0ft (Original Well Elev)
Site:	RBF 24-15D Pad Sec.15-T6N-R67W	MD Reference:	WELL @ 4793.0ft (Original Well Elev)
Well:	RBF 11-22D	North Reference:	True
Wellbore:	Wellbore #1	Survey Calculation Method:	Minimum Curvature
Design:	Wellbore #1	Database:	Landmark

Survey										
Measured Depth (ft)	Inclination (°)	Azimuth (°)	Vertical Depth (ft)	+N/-S (ft)	+E/-W (ft)	Vertical Section (ft)	Dogleg Rate (°/100ft)	Build Rate (°/100ft)	Turn Rate (°/100ft)	
6,990.0	0.30	185.50	6,598.2	-1,715.4	-709.8	1,856.5	0.23	-0.11	32.45	
7,091.7	0.34	163.93	6,699.9	-1,716.0	-709.7	1,856.9	0.12	0.04	-21.21	
TARGET BOX 400' X 400' 658'FNL, 653'FWL										
7,178.0	0.40	150.40	6,786.2	-1,716.5	-709.5	1,857.3	0.12	0.07	-15.68	
7,365.0	1.00	139.30	6,973.2	-1,718.3	-708.1	1,858.5	0.33	0.32	-5.94	
7,553.0	1.80	199.40	7,161.2	-1,722.3	-708.0	1,862.2	0.83	0.43	31.97	
7,674.0	1.70	192.30	7,282.1	-1,725.9	-709.0	1,865.8	0.20	-0.08	-5.87	
7,718.0	1.70	192.30	7,326.1	-1,727.1	-709.3	1,867.1	0.00	0.00	0.00	

Checked By: _____	Approved By: _____	Date: _____
-------------------	--------------------	-------------