

## True Oil Company

Well location, Breeze Unit 41-22, located as shown in Lot 1 of Section 22, T6N, R89W, 6th P.M., Routt County, Colorado.

### Basis of Elevation

Elevations are based on Static GPS observations, post processed. Elevation = 6524 NGVD 29.

### Basis of Bearing

Bearings are based on Static GPS observations of existing HARN points and post processed to provide NAD83 coordinates.

NAD 83 SHL

Latitude = N40°28'03.01936" (N40.467505 Degrees)

Longitude = W107°21'19.37925" (W107.355383 Degrees)

NAD 83 BHL

Latitude = N40°27'59.69443" (N40.466582 Degrees)

Longitude = W107°21'36.33201" (W107.360092 Degrees)

0' 1000' 2000' 3000'



Scale 1" = 1000 U.S. feet

## Surveyor's Statement

I, Peter Epp, a duly registered Professional Land Surveyor in the State of Colorado do hereby certify that the survey represented by this drawing was done by me or under my direct supervision and in accordance with the applicable standards of practice and to the best of my knowledge, information and belief and correct shows the location of Breeze Unit 41-22.

Peter Epp Colorado P.L.S. No. 14815

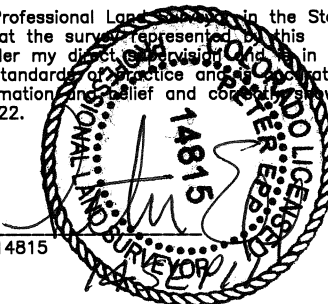

Observed PDOP of 1.5. Observations are in compliance with COGCC Rule No. 215. P. Epp operator.

## Explanation

○ — Denotes found GLO brass cap monument set in 1908 or 1910

└ — Denotes 90° symbol

● — Well Location

SHL — Denotes Surface Location of Hole

BHL — Denotes Intended Bottom Location of Hole

High Desert Plateau. No visible improvements within 400 foot radius of well site except as shown. Surface use is native pasture.

The word "certify" or "certification" as used herein is understood to be an expression of professional opinion by the surveyor, based upon his best knowledge, information, and belief. As such, it does not constitute a guarantee, nor a warranty, expressed or implied.



EPP & ASSOCIATES, INC.  
PROFESSIONAL LAND SURVEYORS

433 4th Avenue West  
P.O. Box 837  
Craig, CO 81625

Phone (970) 824-8236  
Fax (970) 824-5227

True Oil Company

Breeze Unit 41-22

Scale	Date	Drawing No.	Drawn By	Job No.
1" = 1000'	11aug11		P. Epp	10.109-02